

F.A. RTE. 1230	SECTION 03-00159-00-PV	COUNTY LAKE	TOTAL SHEETS 262	SHEET NO. 209
STA. 211+00	TO STA. 212+48.82			
FED. ROAD DIST. NO. 1 ILLINOIS		FED. AID PROJECT		
		CONTRACT: 85828		

BY	DATE
FINAL SURVEY	SURVEYED
NOTE BOOK NO.	TEMPLATED
	AREAS CHECKED

BY	DATE
ORIGINAL SURVEY	SURVEYED
NOTE BOOK NO.	TEMPLATED
	AREAS CHECKED

DATE: 7/11/2008 TIME: 2:20:24 PM

FILENAME: N:\PROJ15161\Design\Xsections\15161-mik-sheet.dgn

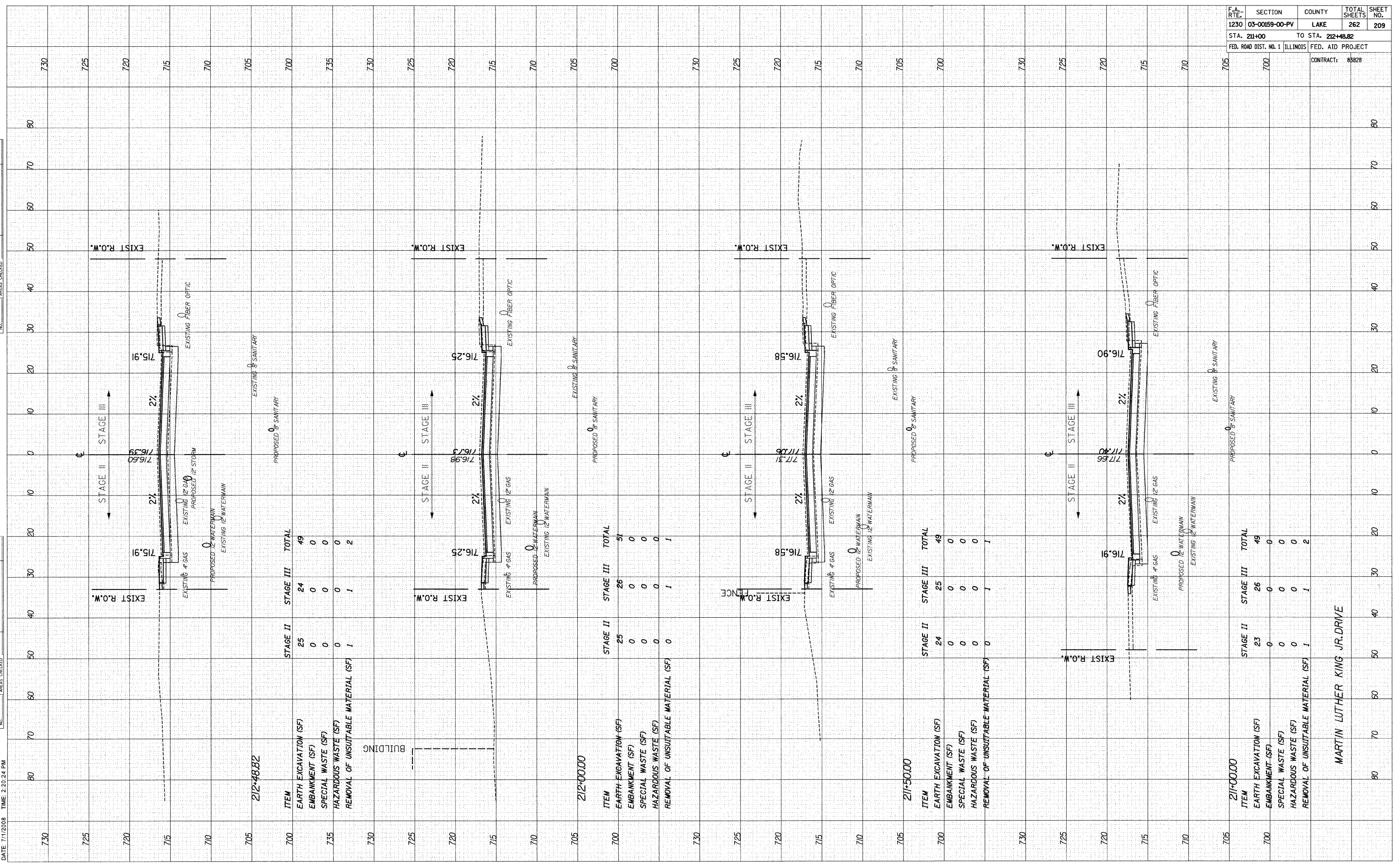

ITEM	STAGE II	STAGE III	TOTAL
EARTH EXCAVATION (SF)	25	24	49
EMBANKMENT (SF)	0	0	0
SPECIAL WASTE (SF)	0	0	0
HAZARDOUS WASTE (SF)	0	0	0
REMOVAL OF UNSUITABLE MATERIAL (SF)	1	1	2

212+48.82

ITEM	STAGE II	STAGE III	TOTAL
EARTH EXCAVATION (SF)	25	26	51
EMBANKMENT (SF)	0	0	0
SPECIAL WASTE (SF)	0	0	0
HAZARDOUS WASTE (SF)	0	0	0
REMOVAL OF UNSUITABLE MATERIAL (SF)	0	1	1

212+00.00

ITEM	STAGE II	STAGE III	TOTAL
EARTH EXCAVATION (SF)	24	25	49
EMBANKMENT (SF)	0	0	0
SPECIAL WASTE (SF)	0	0	0
HAZARDOUS WASTE (SF)	0	0	0
REMOVAL OF UNSUITABLE MATERIAL (SF)	0	1	1

211+50.00

ITEM	STAGE II	STAGE III	TOTAL
EARTH EXCAVATION (SF)	23	26	49
EMBANKMENT (SF)	0	0	0
SPECIAL WASTE (SF)	0	0	0
HAZARDOUS WASTE (SF)	0	0	0
REMOVAL OF UNSUITABLE MATERIAL (SF)	1	1	2

211+00.00

MARTIN LUTHER KING JR. DRIVE