

DATE: 7/11/2008 TIME: 3:58:40 PM

FILENAME: N:\PROJ\151611\Design\Xsections\151611-mk-sheet.dgn

ORIGINAL SURVEY	SURVEYED
NOTE BOOK NO.	TEMPLATED
	AREAS CHECKED
	AREAS CHECKED

BY	DATE

FINAL SURVEY	SURVEYED
NOTE BOOK NO.	TEMPLATED
	AREAS CHECKED
	AREAS CHECKED

BY	DATE

F.A. RTE. 1230	SECTION 03-00159-00-PV	COUNTY LAKE	TOTAL SHEETS 262	SHEET NO. 245
STA. 254+00	TO STA. 255+00			
FED. ROAD DIST. NO. 1 ILLINOIS		FED. AID PROJECT		
		CONTRACT: 85828		

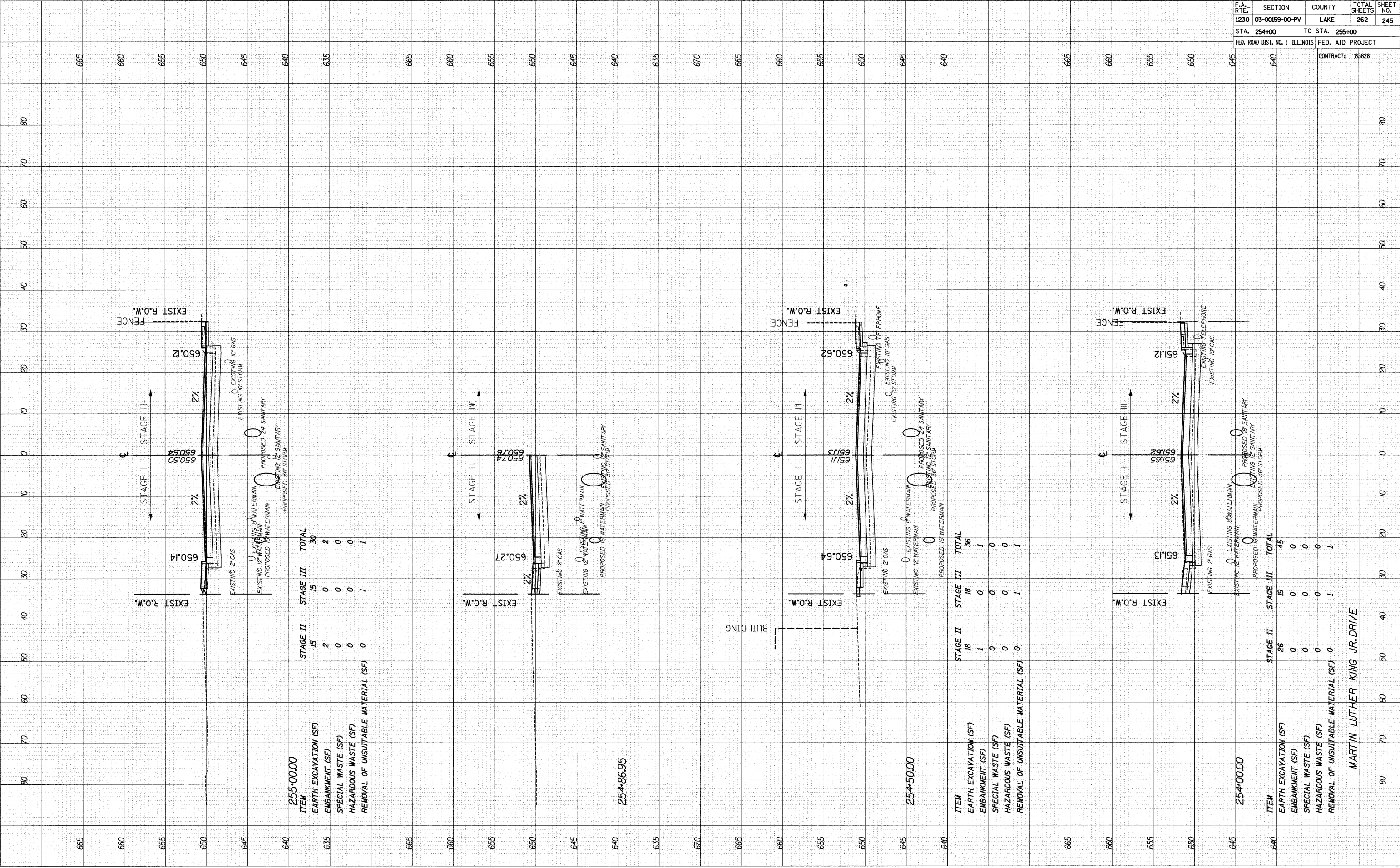

255+00.00	STAGE II	15	STAGE III	15	TOTAL	30
EARTH EXCAVATION (SF)		0		0		0
EMBANKMENT (SF)		0		0		0
SPECIAL WASTE (SF)		0		0		0
HAZARDOUS WASTE (SF)		0		0		0
REMOVAL OF UNSUITABLE MATERIAL (SF)		0		1		1

254+86.95	STAGE II	1	STAGE III	1	TOTAL	2
EARTH EXCAVATION (SF)		0		0		0
EMBANKMENT (SF)		0		0		0
SPECIAL WASTE (SF)		0		0		0
HAZARDOUS WASTE (SF)		0		0		0
REMOVAL OF UNSUITABLE MATERIAL (SF)		0		1		1

254+50.00	STAGE II	1	STAGE III	1	TOTAL	2
EARTH EXCAVATION (SF)		0		0		0
EMBANKMENT (SF)		0		0		0
SPECIAL WASTE (SF)		0		0		0
HAZARDOUS WASTE (SF)		0		0		0
REMOVAL OF UNSUITABLE MATERIAL (SF)		0		1		1

254+00.00	STAGE II	26	STAGE III	19	TOTAL	45
EARTH EXCAVATION (SF)		0		0		0
EMBANKMENT (SF)		0		0		0
SPECIAL WASTE (SF)		0		0		0
HAZARDOUS WASTE (SF)		0		0		0
REMOVAL OF UNSUITABLE MATERIAL (SF)		0		1		1

MARTIN LUTHER KING JR. DRIVE