

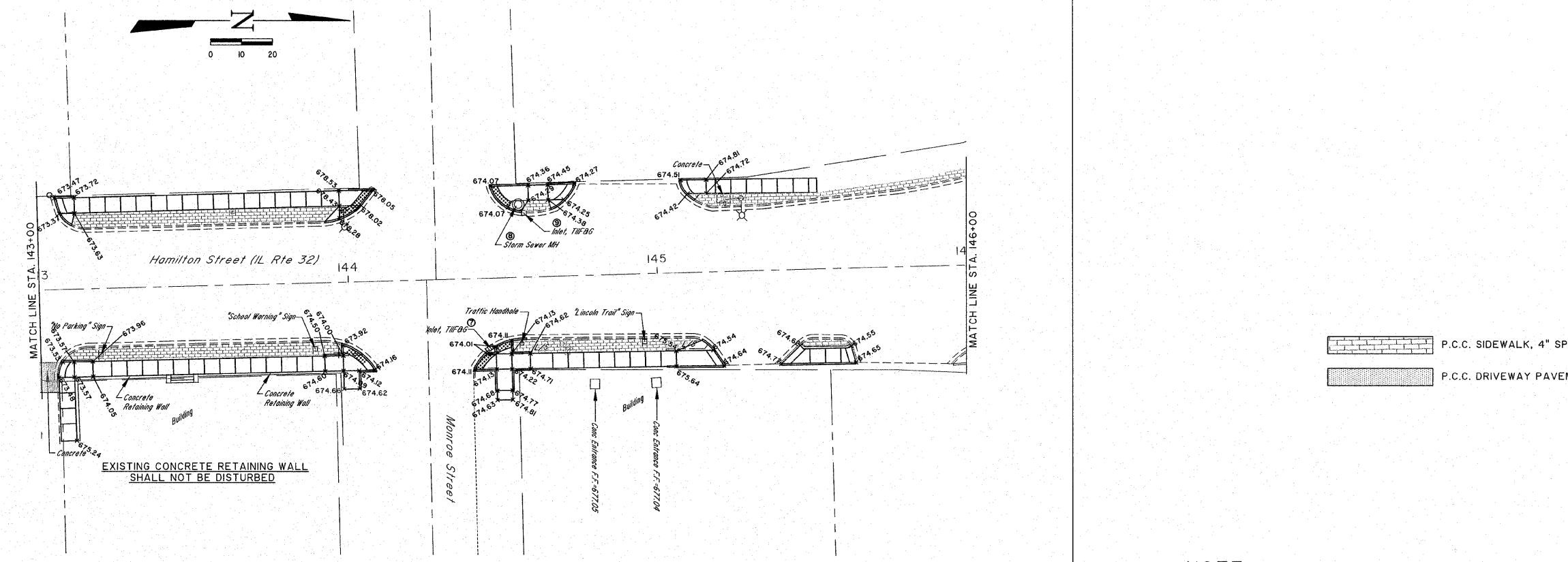

ROUTE NO.	SECTION	COUNTY	TOTAL SHEETS	SHEET NO.
S&A	06-00032-00-SW	MOULTRIE	24	12
FED. ROAD DIST. NO. 7	ILLINOIS	FED. AID PROJECT-		

CONTRACT #95561

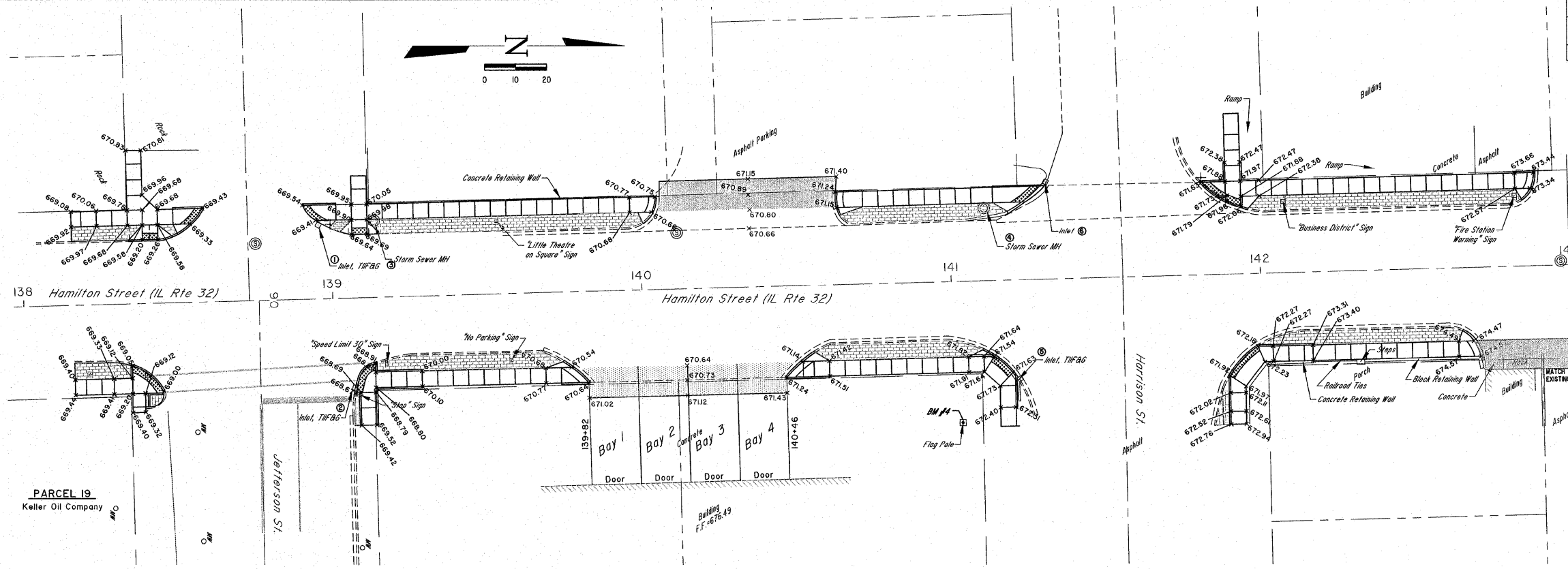
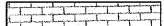

-  P.C.C. SIDEWALK, 4" SPECIAL (STENCILED)
-  P.C.C. DRIVEWAY PAVEMENT, 8"

NOTE

ALL ELEVATIONS ARE TO
EDGE OF PAVEMENT/ EDGE OF SIDEWALK
UNLESS OTHERWISE NOTED

M
L
E
N
G
I
N
G
I
N
G

MLANO & GRUNLOH ENGINEERS, LLC
84 WEST WASHINGTON
P.O. BOX 897
EFFINGHAM, ILLINOIS 62401
Phone: (217) 347-7262
(800) 677-2714
Fax #: (217) 342-3433
Web Address: www.mgengineers.com
Design Firm #: 184-00308

File name: S:\DWG\06\06244\dwg\Plans.dwg
Plot date: 9/6/07 at 13:45

SIDEWALK GRADING PLAN
HAMILTON STREET (ILL RTE 32)
SIDEWALK ENHANCEMENT
CITY OF SULLIVAN
MOULTRIE CO., ILLINOIS