

F.P. NO./E.	SECTION	COUNTY	TOTAL SHEETS	SHEET NO.
7533 9393	05-00025-00-TL 07-00025-01-WR	MADISON	127	74
STA.	TO STA.			
INTERSECTION WARPING DETAILS				

CONTRACT NO. 97352

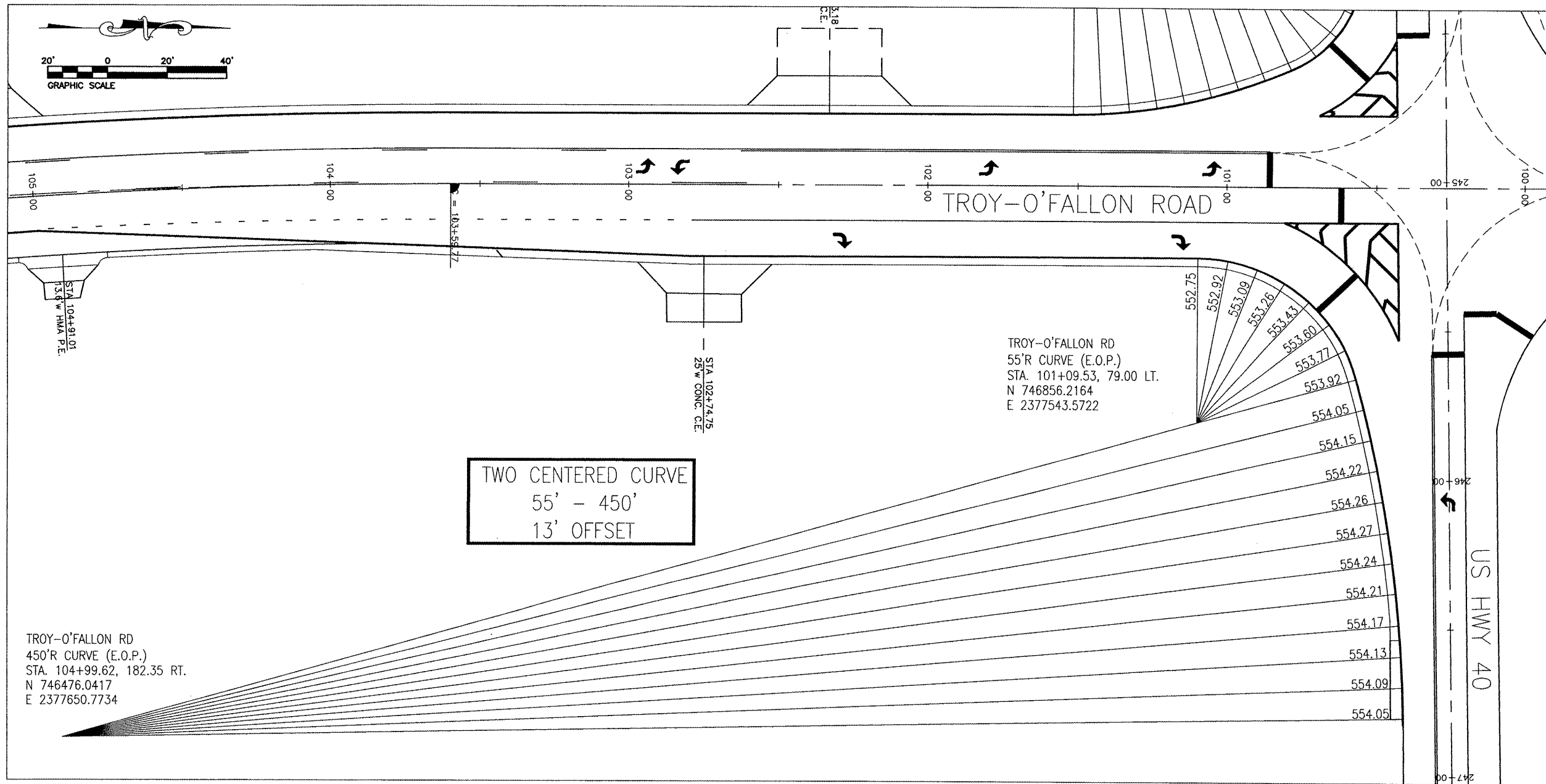

NOTE: ALL ELEVATIONS
ARE GIVEN AT THE
EDGE OF PAVEMENT

REVISIONS	NAME	DATE

INTERSECTION WARPING
DETAILS

US 40 & TROY-O'FALLON ROAD
IMPROVEMENTS
CITY OF TROY
MADISON COUNTY, ILLINOIS

PLANVIEW/INTERSECTION WARPING DETAILS/07/2008 - 5/16/08 - 5/16/08