

C = 10.2
F = 85.8

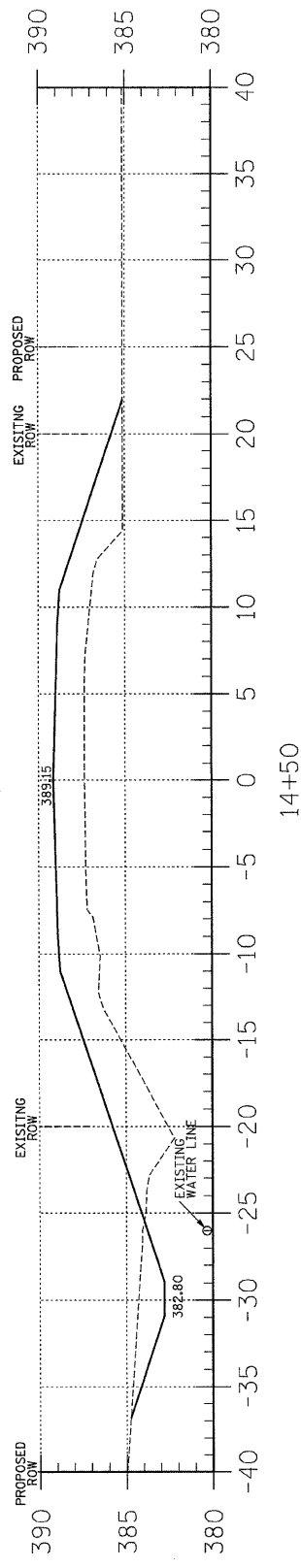

14+50

C = 9.0
F = 75.2

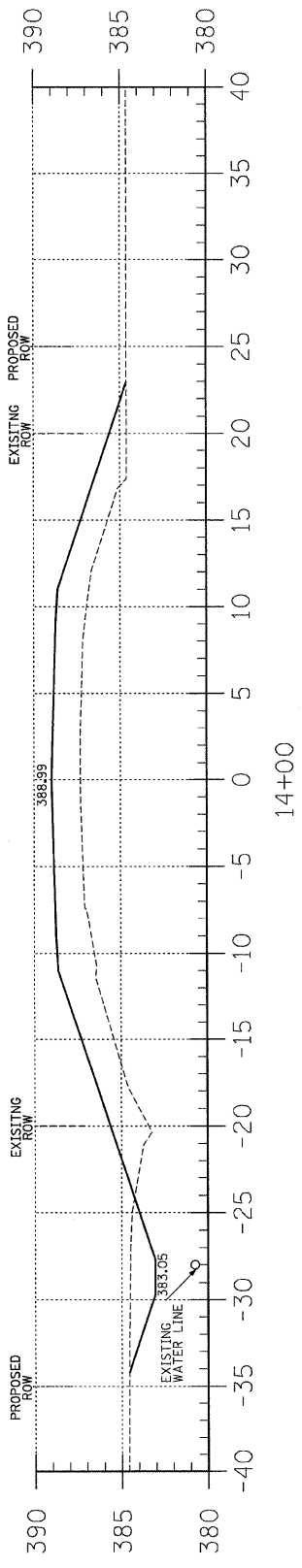

14+00

C = 8.9
F = 90.8

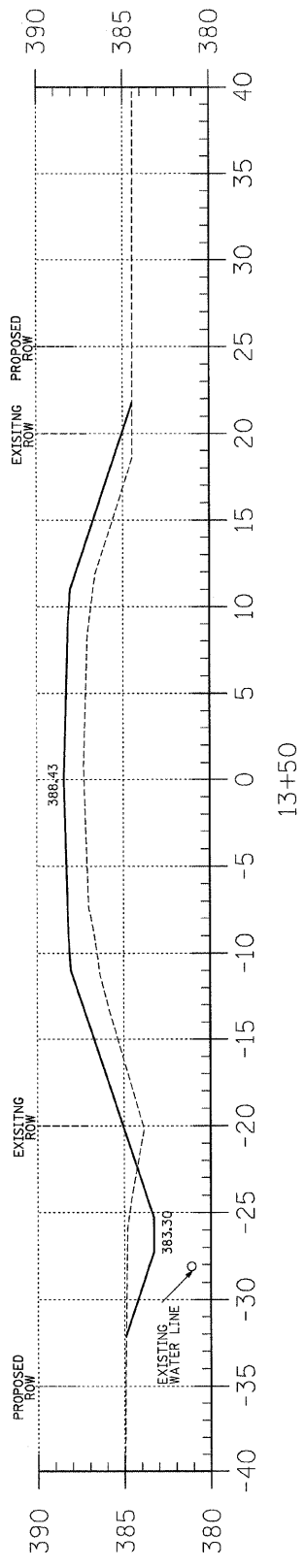

13+50

C = 6.3
F = 17.7

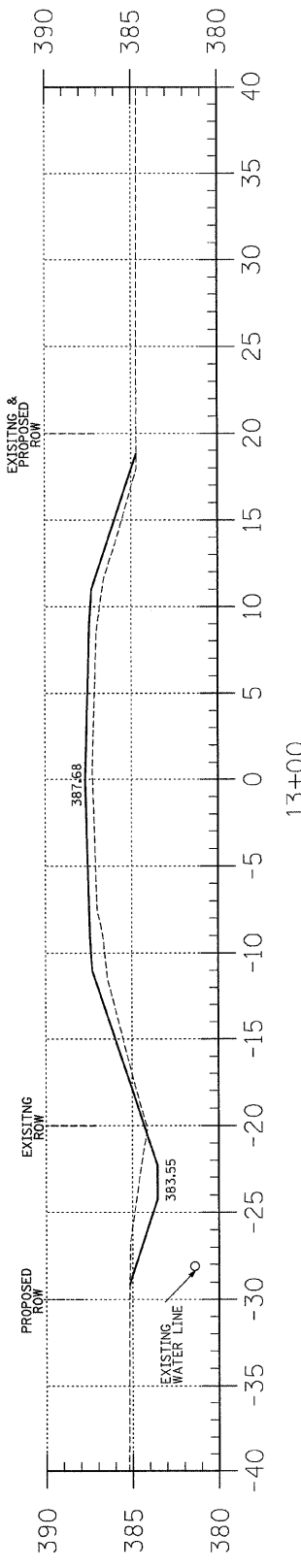

13+00

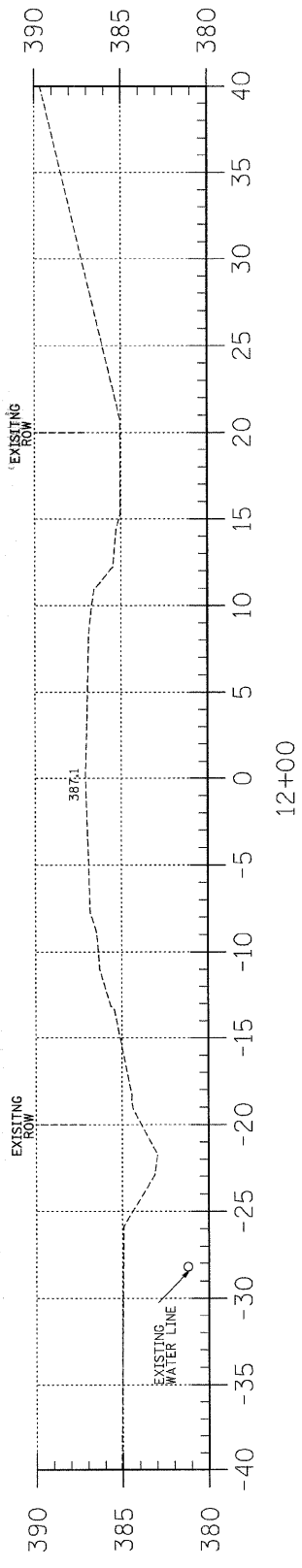

12+00

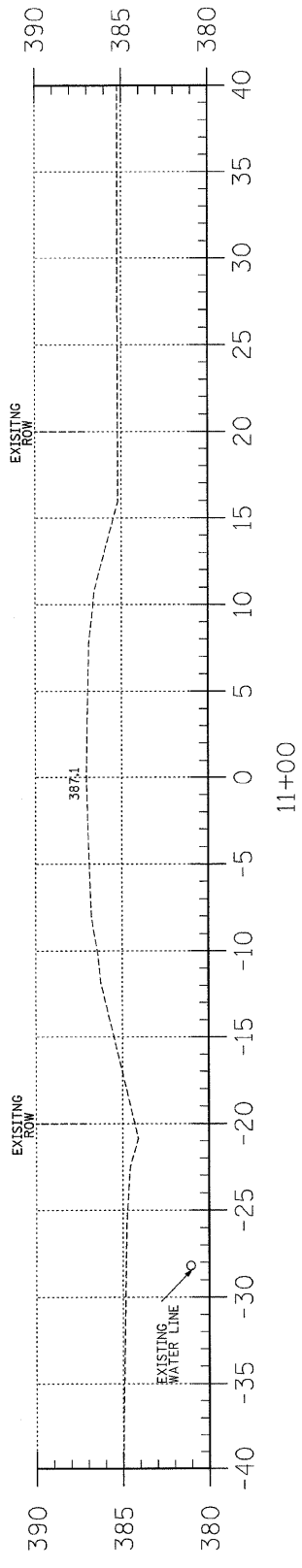

11+00

EARTHWORK SCHEDULE

LOCATION	EARTH EXCAVATION	CHANNEL EXCAVATION	ESTIMATED UNSUITABLE MATERIAL	SUITABLE MATERIAL ADJUSTED FOR SHRINKAGE	EMBANKMENT	EARTHWORK BALANCE WASTE (+) OR SHORTAGE (-)
	CUBIC YARD	CUBIC YARD	CUBIC YARD	CUBIC YARD	CUBIC YARD	CUBIC YARD
STA 10+00 TO 14+53.8	54.3	0.0	0.0	40.7	351.5	-310.8
STA 14+53.8 TO 15+05.3	0.0	199.3	99.6	74.8	0.0	74.8
STA 15+05.3 TO 20+00	42.3	0.0	0.0	31.7	399.7	-367.0
TOTAL	96.6	199.3	99.6	147.2	750.2	-603.0

TR	SECTION	COUNTY	TOTAL SHEETS	SHEET NO.
140	07-08135-00-8R	WHITE	19	9
FED. ROAD DIST. NO. 9 ILLINOIS		LICK CREEK		
PROJECT # BR05-193(36)		CONTRACT # 99323		

323 W. 3RD ST.
P.O. BOX 160
MT. CARMEL, IL 62863
PHONE: (618)-262-8651
FAX: (618)-263-3327

405 W. STATE ST.
SUITE 1
FRINGETON, IN 47670
PHONE: (812)-386-7611
FAX: (812)-385-2812



PROFESSIONAL DESIGN FIRM
LAND SURVEY &
PROFESSIONAL ENGINEERING CORPORATION
184-00087
(62-032435)(35-002769)



AARON M. MEFFORD
NAME
Aaron Mefford
SIGNATURE
6-23-08
DATE
11-30-09
EXPIRES

TOWNSHIP ROUTE 140
INDIAN CREEK TOWNSHIP
WHITE COUNTY, ILLINOIS

SHEET TITLE:
CROSS-SECTIONS
SCALE: 1" = 5'
BY: AMM
DATE: 9/08
REV:

9 OF 19 SHEETS
SHEET NO. 9