

PREPARED BY:  
**CEMCON, Ltd.**  
 Consulting Engineers, Land Surveyors & Planners  
 2800 White Oak Circle, Suite 100  
 Naperville, IL 60563-1200  
 Tel: 630.862.2100 Fax: 630.862.2199  
 E-Mail: [ced@cemcon.com](mailto:ced@cemcon.com) Website: [www.cemcon.com](http://www.cemcon.com)

F.A.U. RTE.	SECTION	COUNTY	TOTAL SHEETS	SHEET NO.
2845	3152WRS	COOK	195	97
STA.	TO STA.			
FED. ROAD DIST. NO.	ILLINOIS	FED. AID PROJECT		
			CONTRACT NO.	62742

**REMOVAL NOTES**

THE FOLLOWING EXISTING TRAFFIC SIGNAL EQUIPMENT SHALL BE REMOVED BY THE CONTRACTOR, SHALL REMAIN THE PROPERTY OF THE STATE AND SHALL BE DELIVERED BY THE CONTRACTOR TO THE STATE'S TRAFFIC SIGNAL MAINTENANCE CONTRACTOR'S MAIN FACILITY AS PER THE TRAFFIC SIGNAL SPECIFICATIONS.

- 1 EACH CONTROLLER AND CABINET (COMPLETE)

THE FOLLOWING ITEMS SHALL BE REMOVED BY THE CONTRACTOR AND SHALL BE DISPOSED OF BY THEM OUTSIDE THE RIGHT-OF-WAY AT THEIR EXPENSE. THE SALVAGE VALUE OF THE REMOVED EQUIPMENT SHALL BE REFLECTED IN THE CONTRACT BID PRICE.

- 2 EACH SIGNAL HEAD, 1-FACE, 3-SECTION
- 8 EACH SIGNAL HEAD, 1-FACE, 5-SECTION
- 2 EACH SIGNAL HEAD, 2-FACE, 5-SECTION
- 8 EACH TRAFFIC SIGNAL BACKPLATE
- 4 EACH PEDESTRIAN SIGNAL HEAD, 2-FACE
- 1 EACH REMOVE EXISTING STEEL MAST ARM AND POLE, 30 FOOT
- 2 EACH REMOVE EXISTING STEEL MAST ARM AND POLE, 24 FOOT
- 4 EACH REMOVE EXISTING PEDESTRIAN PUSH-BUTTON

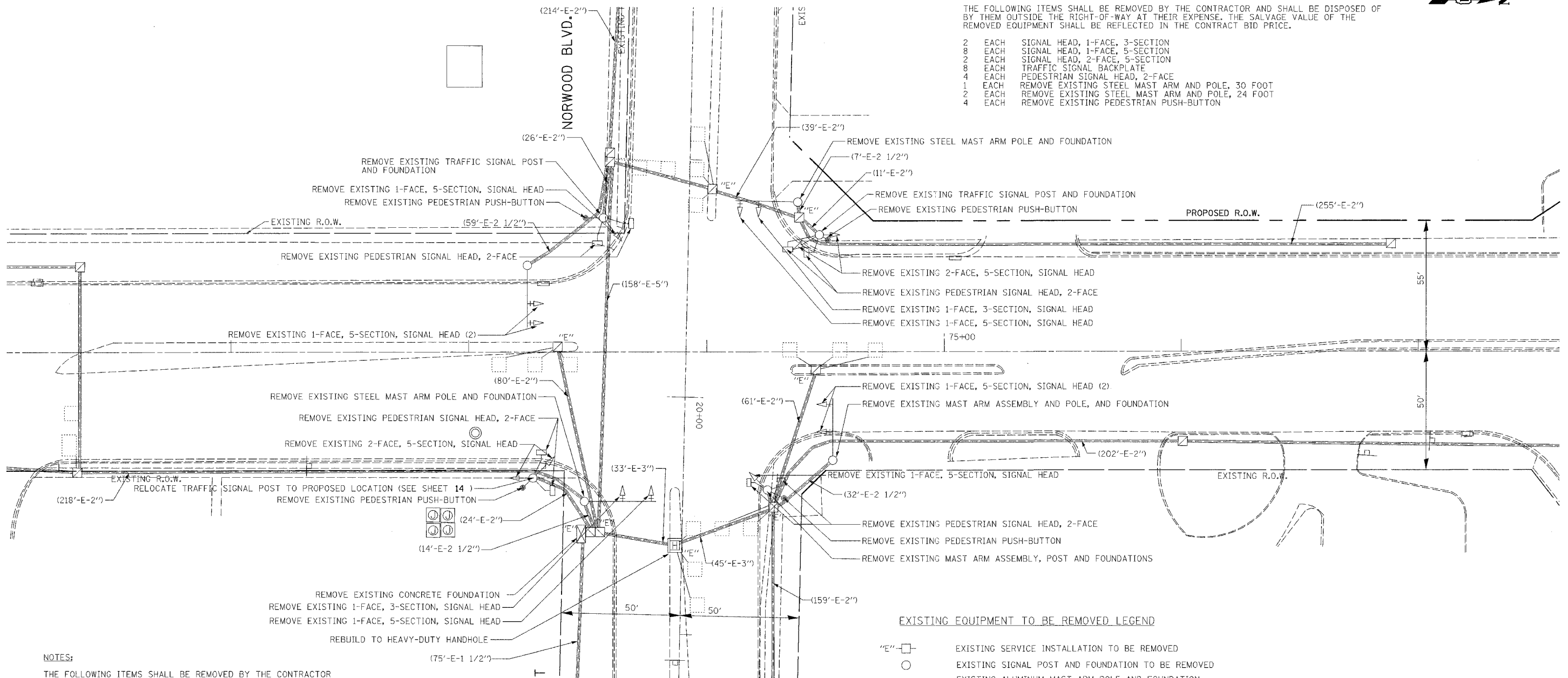
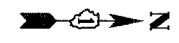

**NOTES:**

THE FOLLOWING ITEMS SHALL BE REMOVED BY THE CONTRACTOR AND RELOCATED TO PROPOSED LOCATIONS AS INDICATED ON PROPOSED TRAFFIC SIGNAL PLANS ON SHEET :

- 1 EACH RELOCATE EXISTING MAST ARM ASSEMBLY AND POLE
- 4 EACH RELOCATE EXISTING TRAFFIC SIGNAL POST

**RESTORATION OF WORK AREA**  
 RESTORATION OF TRAFFIC SIGNAL WORK AREA SHALL BE INCIDENTAL TO THE RELATED PAY ITEM SUCH AS FOUNDATION, CONDUIT, HANDHOLE, TRENCH AND BACKFILL, ETC., AND NO EXTRA COMPENSATION SHALL BE ALLOWED. ALL ROADWAY SURFACES SUCH AS SHOULDERS, MEDIANS, SIDEWALKS, PAVEMENT, ETC. SHALL BE REPLACED IN KIND. ALL DAMAGE TO MOWED LAWNS SHALL BE REPLACED WITH AN APPROVED SOD, AND ALL DAMAGE TO UNMOWED FIELDS SHALL BE SEEDED IN ACCORDANCE WITH STANDARD SPECIFICATIONS 252 AND 250 RESPECTIVELY.

**EXISTING EQUIPMENT TO BE REMOVED LEGEND**

- "E" - [Symbol] EXISTING SERVICE INSTALLATION TO BE REMOVED
- [Symbol] EXISTING SIGNAL POST AND FOUNDATION TO BE REMOVED
- [Symbol] EXISTING ALUMINUM MAST ARM POLE AND FOUNDATION TO BE REMOVED
- "E" - [Symbol] EXISTING CONTROLLER AND FOUNDATION TO BE REMOVED
- "E" - [Symbol] EXISTING HANDHOLE TO BE REMOVED
- "E" - [Symbol] EXISTING HEAVY DUTY HANDHOLE TO BE REMOVED
- [Symbol] EXISTING PEDESTRIAN SIGNAL HEAD TO BE REMOVED
- [Symbol] EXISTING PEDESTRIAN PUSH-BUTTON TO BE REMOVED
- [Symbol] PRIORITY VEHICLE DETECTOR TO BE REMOVED
- [Symbol] CONFIRMATION BEACON TO BE REMOVED
- [Symbol] EXISTING STEEL MAST ARM POLE AND FOUNDATION TO BE REMOVED
- [Symbol] EXISTING TRAFFIC SIGNAL HEAD WITH BACKPLATE TO BE REMOVED
- [Symbol] EXISTING TRAFFIC SIGNAL HEAD TO BE REMOVED

REVISIONS	
NAME	DATE

ILLINOIS DEPARTMENT OF TRANSPORTATION  
**TRAFFIC SIGNAL REMOVAL PLAN**  
**WESTERN AVENUE AT**  
**NORWOOD BLVD / 26TH STREET**  
 SCALE: VERT. 1" = 20'  
 HORIZ. 1" = 50'  
 DATE 5/17/2007  
 DRAWN BY JLA  
 DESIGNED BY KK/BPT  
 CHECKED BY JTL/BPT

**FOR UNDERGROUND UTILITY LOCATIONS, CALL J.U.L.I.E. TOLL FREE TEL. 1-800-892-0123**

PLOT DATE = 5/18/2007  
 PLOT SCALE = 1"=20'  
 USER NAME = JLA