

| ROUTE NO.           | SECTION        | COUNTY   | TOTAL SHEETS | SHEET NO. |
|---------------------|----------------|----------|--------------|-----------|
| C.H. 22             | 93-00085-00-BR | HANCOCK  | 11           | 7         |
| F.H.W.A. REG. NO. 4 |                | ILLINOIS | PROJECT      |           |

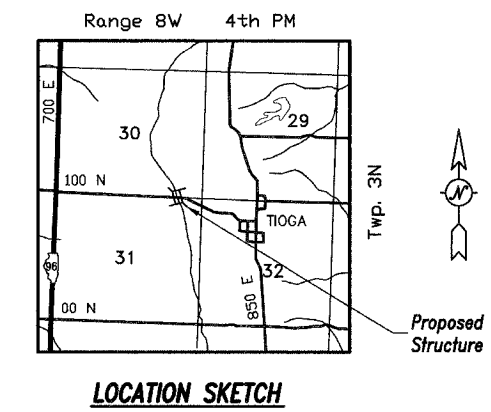
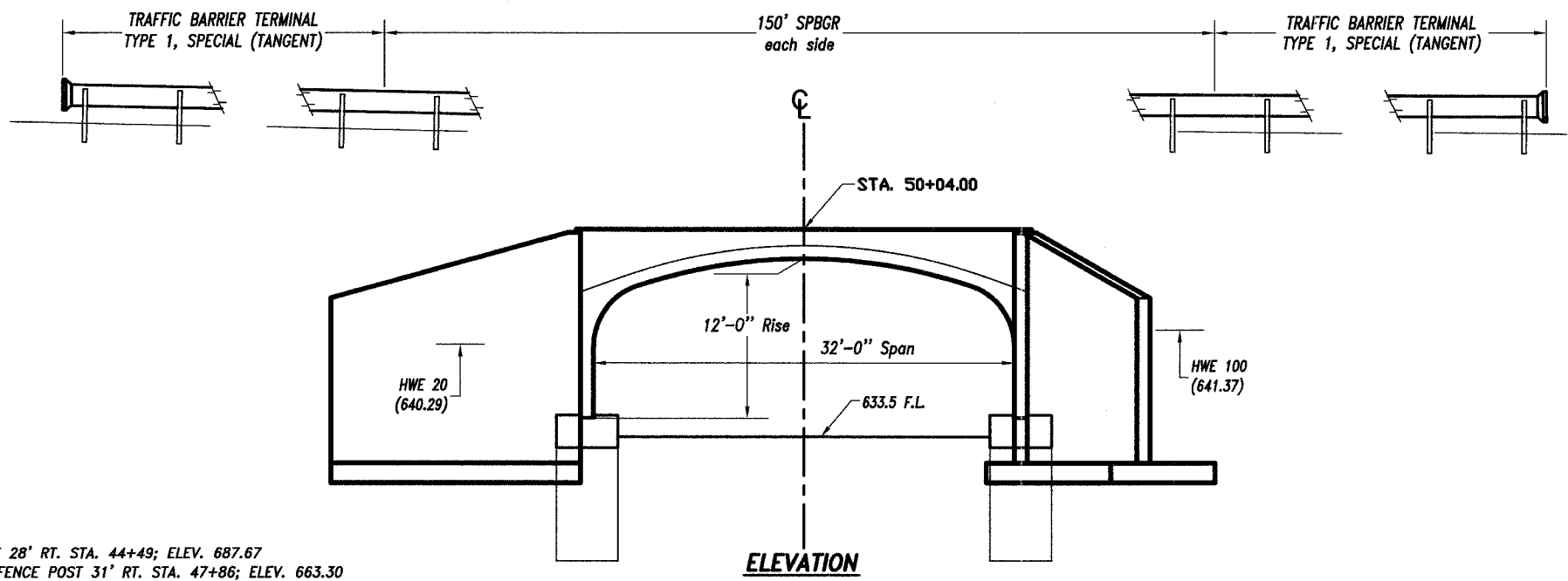

**PAUL E. SLY**  
 REGISTERED PROFESSIONAL ENGINEER OF ILLINOIS  
 ILLINOIS PROFESSIONAL NO. 062-043309  
 EXPIRES 11/30/07

- B.M. # 1: HORZ. SPIKE IN TREE 28' RT. STA. 44+49; ELEV. 687.67
- B.M. # 2: HORZ. LAG BOLT IN FENCE POST 31' RT. STA. 47+86; ELEV. 663.30
- B.M. # 3: HORZ. LAG BOLT IN FENCE POST 36' LT. STA. 51+16; ELEV. 649.95
- B.M. # 4: HORZ. LAG BOLT IN FENCE POST 74' LT. STA. 54+58; ELEV. 663.12
- B.M. # 5: HORZ. LAG BOLT IN FENCE POST 35' RT. STA. 59+03; ELEV. 690.37

**NOTE:**  
 ALL EXCAVATION AND BACKFILL FROM STA. 49+59 TO STA. 50+46 WILL BE CONSIDERED INCIDENTAL TO THREE SIDED PRECAST CONCRETE STRUCTURE.  
 REINFORCEMENT BARS SHALL CONFORM TO THE REQUIREMENTS OF ASTM A706 GRADE 60 (IL MODIFIED).

STATION 50+04.00  
 COUNTY HIGHWAY 22  
 SEC. 93-00085-00-BR BUILT 200\_  
 FA PROJ. BROS-067(76)  
 HANCOCK COUNTY  
 LOADING HS20  
 STR. NO. 034-3221

**LETTERING FOR NAME PLATE**  
 Locate Name Plate at Northeast Corner of Bridge (See Std. 515001)

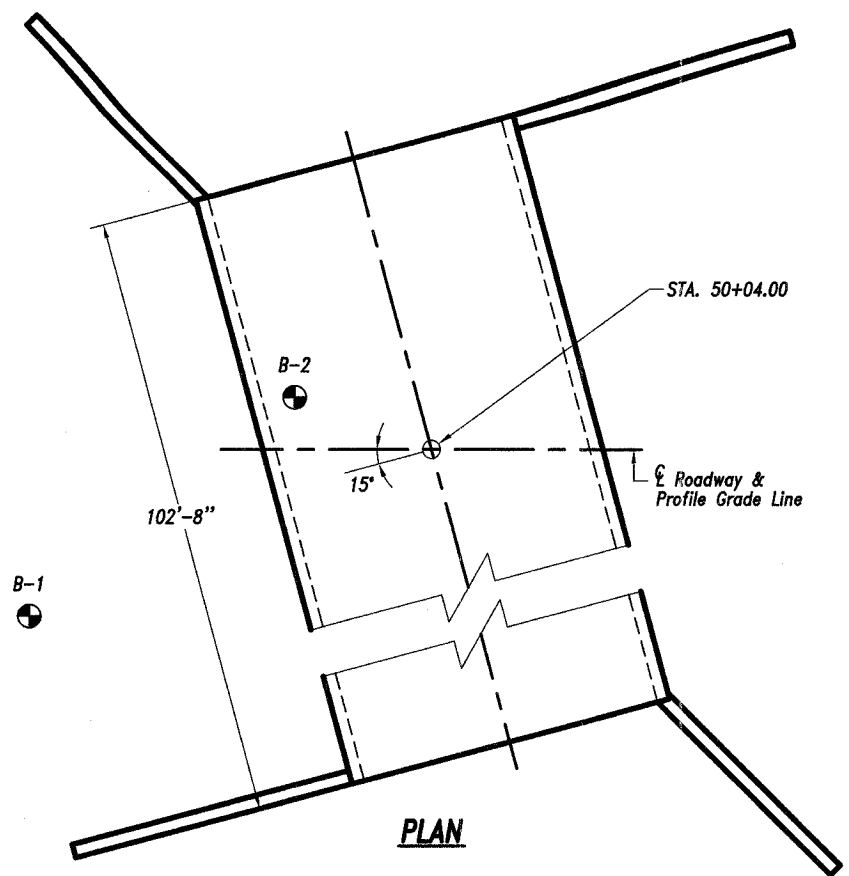

**SUMMARY OF QUANTITIES**

| ITEM   | UNIT  | QUANTITY |
|--|-------|----------|
| CONCRETE STRUCTURES                                | CU YD | 183.7    |
| CONTROLLED LOW STRENGTH MATERIAL                   | CU YD | 376.5    |
| REINFORCEMENT BARS, EPOXY COATED                   | POUND | 14,890   |
| * THREE SIDED PRECAST CONCRETE STRUCTURES 32'x12'  | FOOT  | 102.7    |
| STEEL PLATE BEAM GUARD RAIL, TYPE A                | FOOT  | 300      |
| TRAFFIC BARRIER TERMINAL TYPE 1, SPECIAL (TANGENT) | EACH  | 4        |
| NAME PLATES  | EACH  | 1        |

\* SEE SPECIAL PROVISIONS

**WATERWAY INFORMATION**

| Drainage Area = 1.27 Sq. Mi. |           | Low Grade Elev. = 660.73 |                              | At Sta. 49+82  |                         |                            |
|------------------------------|-----------|--------------------------|------------------------------|----------------|-------------------------|----------------------------|
| Flood                        | Freq. Yr. | Q C.F.S.                 | Opening Sq. Ft. Exist. Prop. | Natural H.W.E. | Head - Ft. Exist. Prop. | Headwater El. Exist. Prop. |
| Design                       | 20        | 800                      | 189 225                      | 640.29         | * *                     | * *                        |
| Base                         | 100       | 1223                     | 215 259                      | 641.37         | * *                     | * *                        |
| Overtopping                  |           |                          |                              |                |                         |                            |
| Max. Calc.                   | 500       |                          |                              |                |                         |                            |

\* Elevations Determined By Hancock County

**DESIGN SPECIFICATIONS**

2002 AASHTO & Interims as applicable HS 20-44 Loading.

**GENERAL PLAN & ELEVATION**  
  
**C. H. ROUTE 22**  
  
**SECTION 93-00085-00-BR**  
**HANCOCK COUNTY**  
**STATION 50+04.00**