

ROUTE NO.	SECTION	COUNTY	TOTAL SHEETS	SHEET NO.
C.H. 22	93-00085-00-BR	HANCOCK	11	9

PLAN, ELEVATION, SECTIONS AND DETAILS

SHEET 2 OF 3

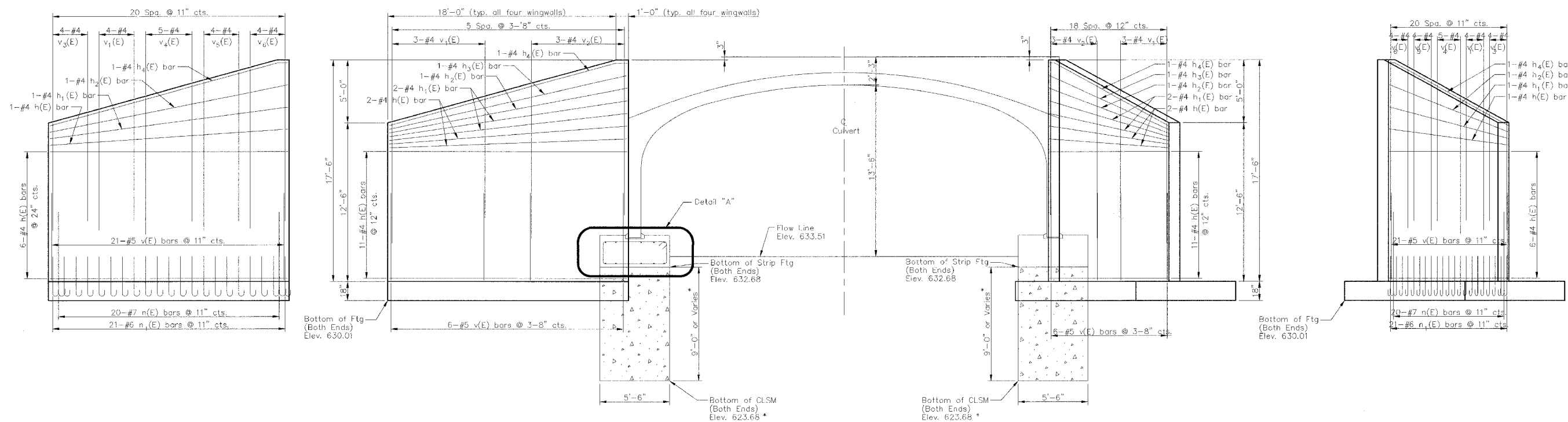

REINFORCEMENT
BACK FACE

REINFORCEMENT
FRONT FACE

HALF LONG
SECTION

HALF LONG
ELEVATION

REINFORCEMENT
FRONT FACE

REINFORCEMENT
BACK FACE

* Depth of Controlled Low-Strength Material (CLSM) varies.
It is dependent on achieving an allowable soil bearing pressure of 9,000 psf.
Local Agency will perform with consultation from IDOT.

DESIGNED	J.L.S.
CHECKED	C.S.B.
DRAWN	J.L.S.
CHECKED	C.S.B.

ELEVATION, SECTIONS AND DETAILS FOR CAST
IN PLACE WINGWALLS AND FOUNDATION
C.H. 22
SECTION 93-00085-00-BR
HANCOCK COUNTY
STATION 49+84

PSBA POEPPING, STONE, BACH & ASSOCIATES, INC.
ARCHITECTS ENGINEERS PLANNERS SURVEYORS
100 S. MAIN ST., P.O. BOX 705 • CHICAGO, IL 60606 • PHONE 312.223-4605
2503 WAIN ST., P.O. BOX 817 • KENOSHA, WI 53141 • PHONE 919.244.4770
www.psba.com email: psba@psba.com

Date :	JAN 2007
Project No. :	R-03-018
File No. :	R03018-2