

PLAN	SURVEYED	BY	DATE
	PLOTTED		
	NOTE BOOK		
	NO.		
	ALIGNED		
	CHECKED		
	FILE NAME		

PROFILE	SURVEYED	BY	DATE
	PLOTTED		
	GRADES CHECKED		
	NO.		
	STRUCTURE		
	NOTATIONS		

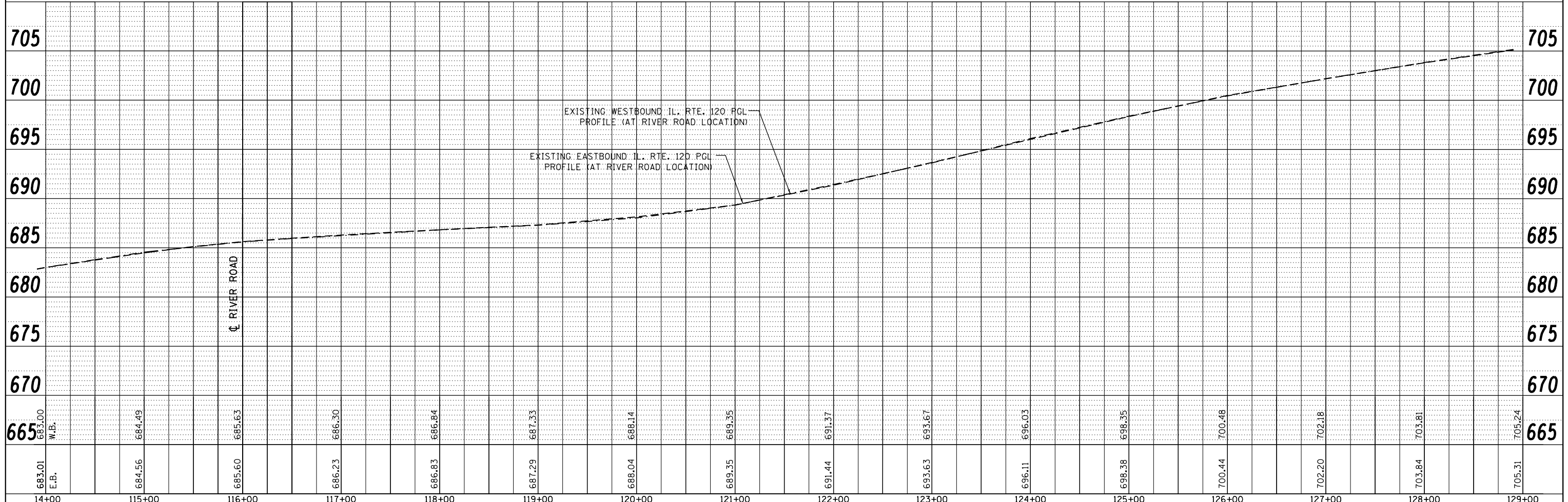
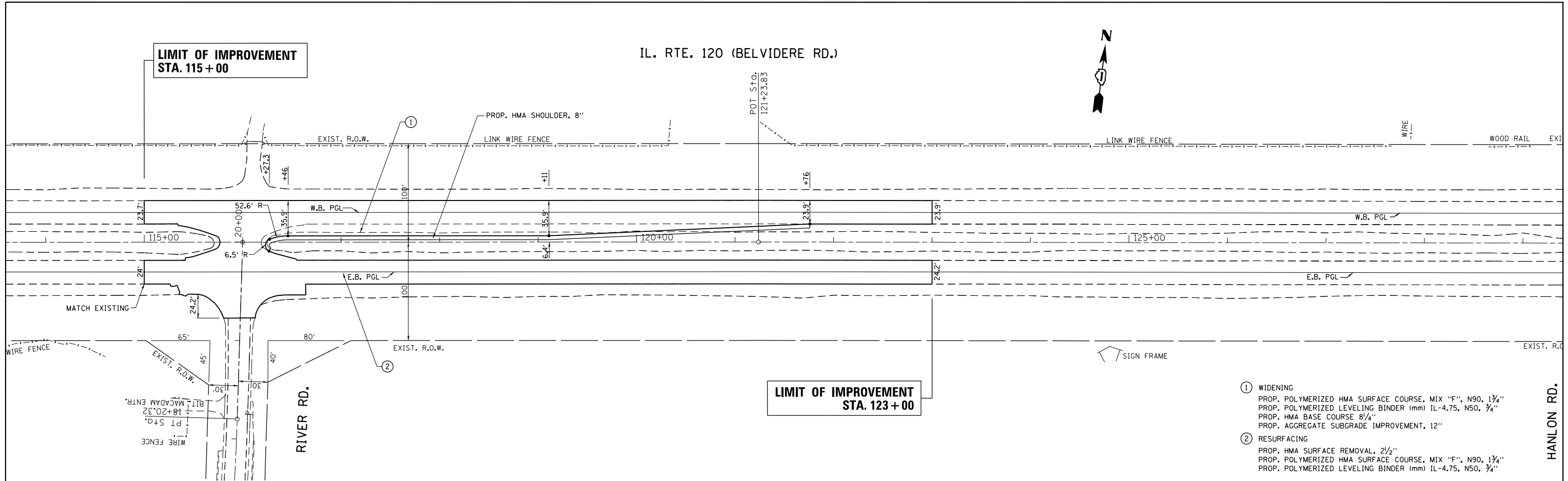

- ① WIDENING
 PROP. POLYMERIZED HMA SURFACE COURSE, MIX "F", N90, 1 3/4"
 PROP. POLYMERIZED LEVELING BINDER (mm) IL-4.75, N50, 3/4"
 PROP. HMA BASE COURSE 8/4"
 PROP. AGGREGATE SUBGRADE IMPROVEMENT, 12"
- ② RESURFACING
 PROP. HMA SURFACE REMOVAL, 2 1/2"
 PROP. POLYMERIZED HMA SURFACE COURSE, MIX "F", N90, 1 3/4"
 PROP. POLYMERIZED LEVELING BINDER (mm) IL-4.75, N50, 3/4"

FILE NAME =	USER NAME = pencepl	DESIGNED -	REVISED -	STATE OF ILLINOIS DEPARTMENT OF TRANSPORTATION	PLAN AND PROFILE ILLINOIS ROUTE 120 AT RIVER ROAD		F.A.P. RTE.	SECTION	COUNTY	TOTAL SHEETS	SHEET NO.
c:\pwork\pwork\pencepl\d0187990\F170309.sht-plnprf.dgn		DRAWN -	REVISED -		342	2011-220-N	LAKE	41	14		
PLOT SCALE = 100.0081' / in.		CHECKED -	REVISED -		CONTRACT NO. 60R59						
PLOT DATE = 6/29/2012		DATE -	REVISED -		ILLINOIS FED. AID PROJECT						