

LEGEND:

	TEMPORARY PAVEMENT		TYPE II BARRICADES OR DRUMS WITH STEADY BURNING LIGHTS @ 50 FT CENTERS ALONG ROADWAY TANGENTS, 25 FT CENTERS ALONG TAPERS, AND 12 FT CENTERS ALONG RADII		VERTICAL PANEL WITH STEADY BURNING LIGHT @ 50 FT CENTERS
	WORK ZONE		TYPE III BARRICADES WITH FLASHING LIGHTS		
	DIRECTION OF TRAFFIC				

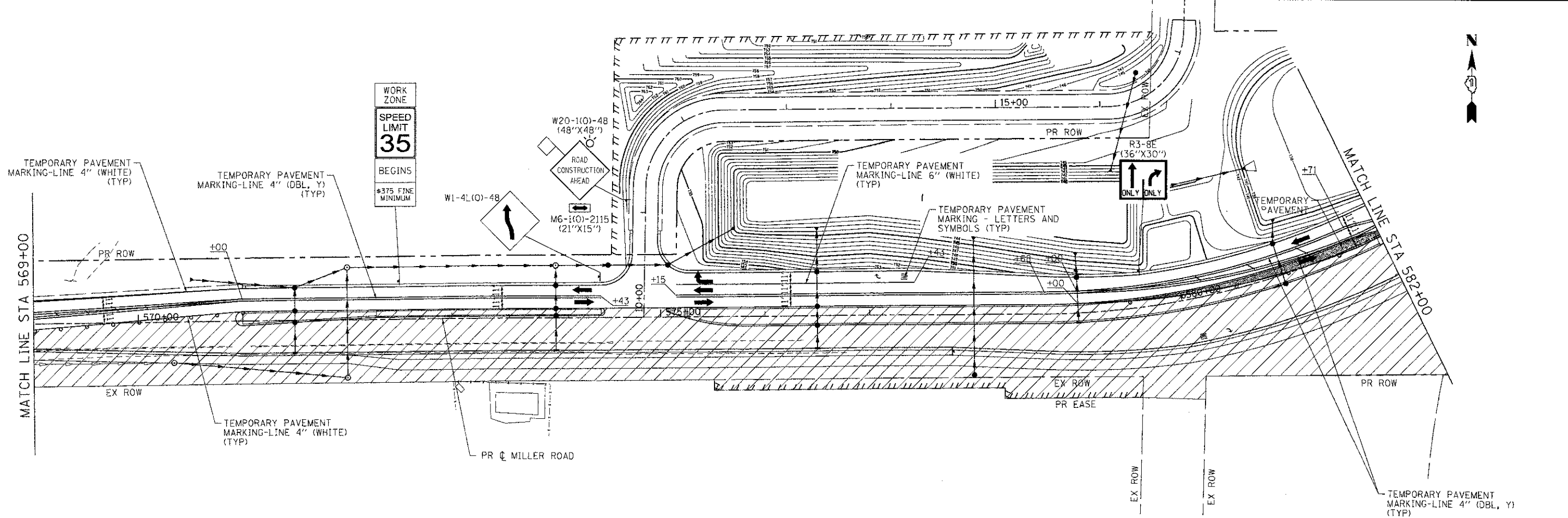

COMPANY NAME: HRGreen
 PROJECT CONTACT: jettana
 DATE PLOTTED: 7/23/2012 10:05:00 AM
 FILE NAME: 090071-mo12-04.dgn
 PLOT DRIVER: pofpht
 PEN TABLE: standard-trans.tbl

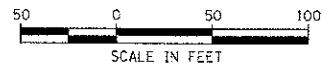
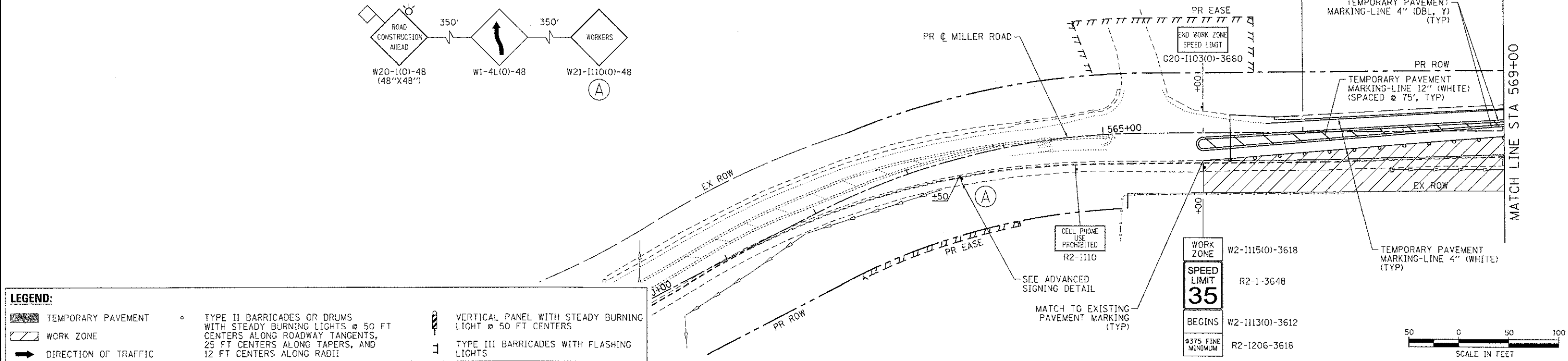

USER NAME = jettana	DESIGNED - JPA	REVISED -
FILE NAME = 090071-mo12-04.dgn	DRAWN - SVJ	REVISED -
PLOT SCALE = 1" = 50'	CHECKED - JLP	REVISED -
PLOT DATE = 7/23/2012	DATE - 7/23/12	REVISED -

**MCHENRY COUNTY
 DIVISION OF TRANSPORTATION**

**SUGGESTED MAINTENANCE OF TRAFFIC - STAGE 2
 CHARLES J. MILLER ROAD ROADWAY IMPROVEMENTS**

SCALE: 1" = 50' SHEET NO. 7 OF 14 SHEETS STA. TO STA.

F.A.U. RTE. 3860	SECTION 09-00372-00-PW	COUNTY MCHENRY	TOTAL SHEETS 252	SHEET NO. 41
FED. ROAD DIST. NO.		ILLINOIS FED. AID PROJECT		CONTRACT NO. 63633