

**LEGEND:**

	TEMPORARY PAVEMENT		TYPE II BARRICADES OR DRUMS WITH STEADY BURNING LIGHTS @ 50 FT CENTERS ALONG ROADWAY TANGENTS, 25 FT CENTERS ALONG TAPERS, AND 12 FT CENTERS ALONG RADII		VERTICAL PANEL WITH STEADY BURNING LIGHT @ 50 FT CENTERS
	WORK ZONE		DIRECTION OF TRAFFIC		TYPE III BARRICADES WITH FLASHING LIGHTS

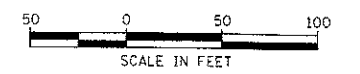
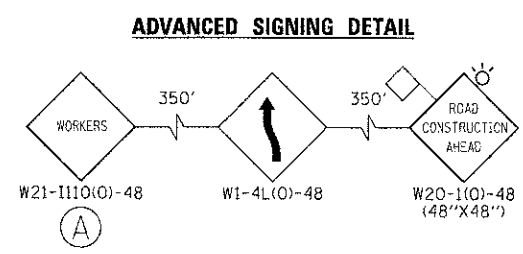
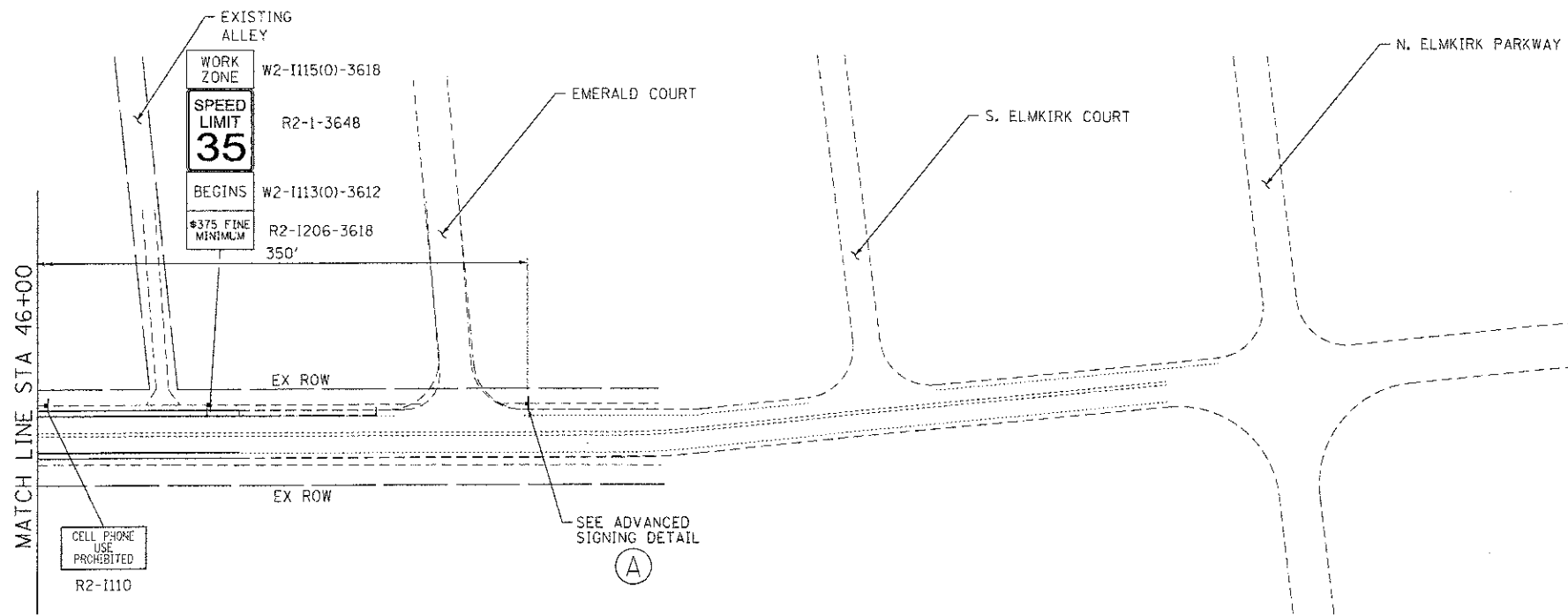

COMPANY NAME: HRGreen  
 PROJECT CONTACT: J. J. J. J.  
 CLIENT: MCHENRY COUNTY  
 DATE PLOTTED: 7/23/2012 10:17:13 AM  
 FILE NAME: 090071\_m02-10.dgn  
 PLOT NAME: pdf.plt  
 PEN TABLE: standard-trans.tbl

	HRGreen.com Illinois Professional Design Firm #184-01122	USER NAME = j. j. j. j.	DESIGNED - JPA	REVISED -
		FILE NAME = 090071_m02-10.dgn	DRAWN - SVJ	REVISED -
		PLOT SCALE = 1" = 50'	CHECKED - JLP	REVISED -
		PLOT DATE = 7/23/2012	DATE - 7/23/12	REVISED -

**MCHENRY COUNTY**  
**DIVISION OF TRANSPORTATION**

**SUGGESTED MAINTENANCE OF TRAFFIC - STAGE 2**  
**CHARLES J. MILLER ROAD ROADWAY IMPROVEMENTS**

SCALE: 1" = 50'    SHEET NO. 10 OF 14 SHEETS    STA.    TO STA.

F.A.U. RTE.	SECTION	COUNTY	TOTAL SHEETS	SHEET NO.
3860	09-00372-00-PW	MCHENRY	252	44
FED. ROAD DIST. NO.			ILLINOIS FED. AID PROJECT	
			CONTRACT NO. 63633	