

LEGEND:

	TEMPORARY PAVEMENT		TYPE II BARRICADES OR DRUMS WITH STEADY BURNING LIGHTS @ 50 FT CENTERS ALONG ROADWAY TANGENTS, 25 FT CENTERS ALONG TAPERS, AND 12 FT CENTERS ALONG RADII		VERTICAL PANEL WITH STEADY BURNING LIGHT @ 50 FT CENTERS
	WORK ZONE		DIRECTION OF TRAFFIC		TYPE III BARRICADES WITH FLASHING LIGHTS

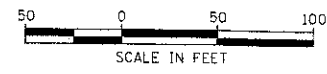
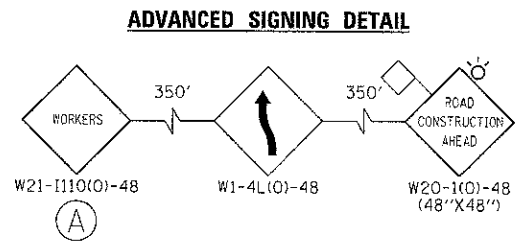
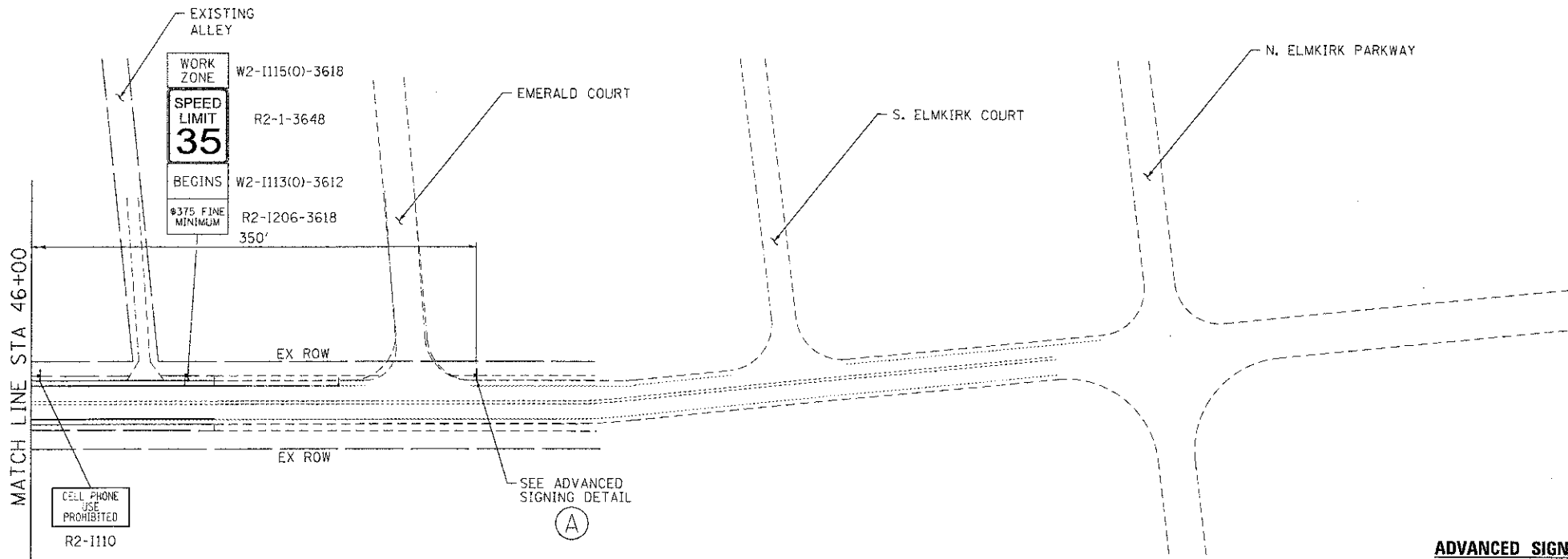

COMPANY NAME: HRGreen
 PROJECT CONTACT: jstano
 CLIENT: HRGreen.com
 DATE PLOTTED: 7/23/2012 11:17:46 AM
 FILE NAME: 090071-mot3-10.dgn
 PLOT DRIVER: pcf.cpl
 PEN TABLE: standard.ctb

	HRGreen.com 119016 Professional Design Firm #184-001322	USER NAME = jstano	DESIGNED - JPA	REVISED -
		FILE NAME = 090071-mot3-10.dgn	DRAWN - SVJ	REVISED -
		PLOT SCALE = 1" = 50'	CHECKED - JLP	REVISED -
		PLOT DATE = 7/23/2012	DATE - 7/23/12	REVISED -

**MCHENRY COUNTY
DIVISION OF TRANSPORTATION**

**SUGGESTED MAINTENANCE OF TRAFFIC - STAGE 3
RIVER ROAD ROADWAY IMPROVEMENTS**

SCALE: 1" = 50' SHEET NO. 14 OF 14 SHEETS STA. TO STA.

F.A.J. RTE. 3660	SECTION 09-00372-00-PW	COUNTY MCHENRY	TOTAL SHEETS 252	SHEET NO. 48
CONTRACT NO. 63633				
FED. ROAD DIST. NO. ILLINOIS FED. AID PROJECT				