

DATE	
BY	
REVISIONS	
NO.	
DATE	
BY	
REVISIONS	
NO.	
DATE	
BY	
REVISIONS	
NO.	
DATE	
BY	
REVISIONS	
NO.	
DATE	
BY	
REVISIONS	
NO.	

DATE	
BY	
REVISIONS	
NO.	
DATE	
BY	
REVISIONS	
NO.	
DATE	
BY	
REVISIONS	
NO.	
DATE	
BY	
REVISIONS	
NO.	

7/23/2012 11:16:57 AM
 090071-pw-04.dgn
 pw
 090071-pw-04.dgn

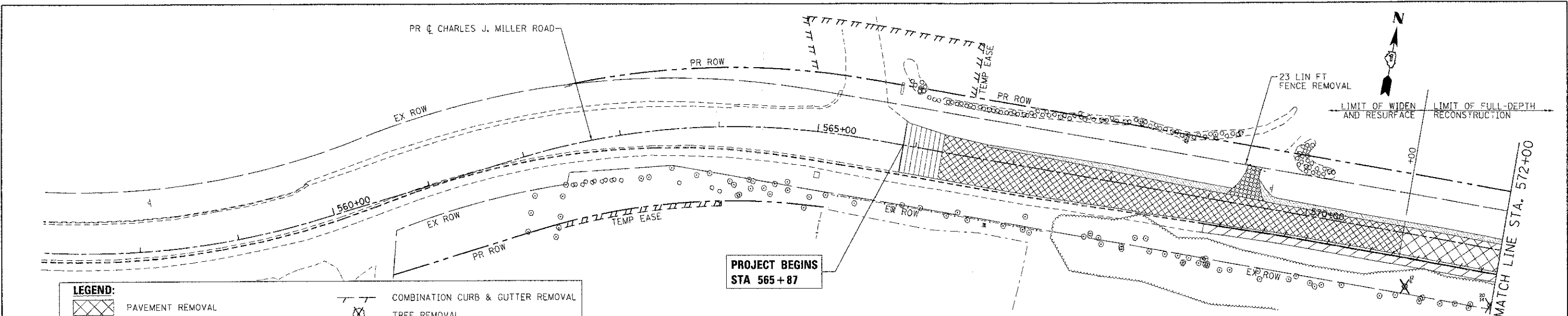

LEGEND:

	PAVEMENT REMOVAL		COMBINATION CURB & GUTTER REMOVAL
	PAVED SHOULDER REMOVAL		TREE REMOVAL
	AGGREGATE SHOULDER REMOVAL (PAID FOR AS REMOVAL AND DISPOSAL OF UNSUITABLE MATERIAL)		DRIVEWAY PAVEMENT REMOVAL
	HOT-MIX ASPHALT SURFACE REMOVAL - 2"		SIDEWALK REMOVAL
			HOT-MIX ASPHALT SURFACE REMOVAL - BUTT JOINT

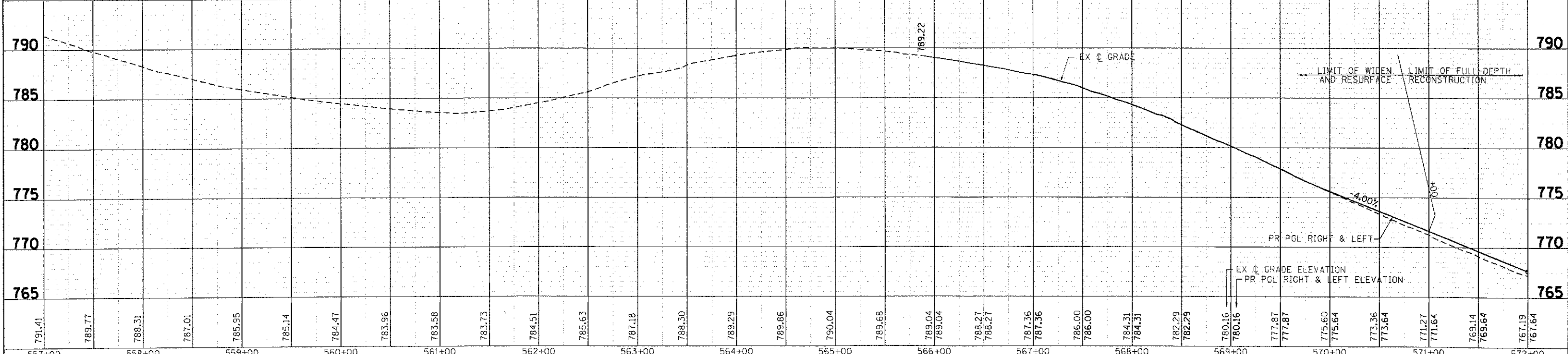
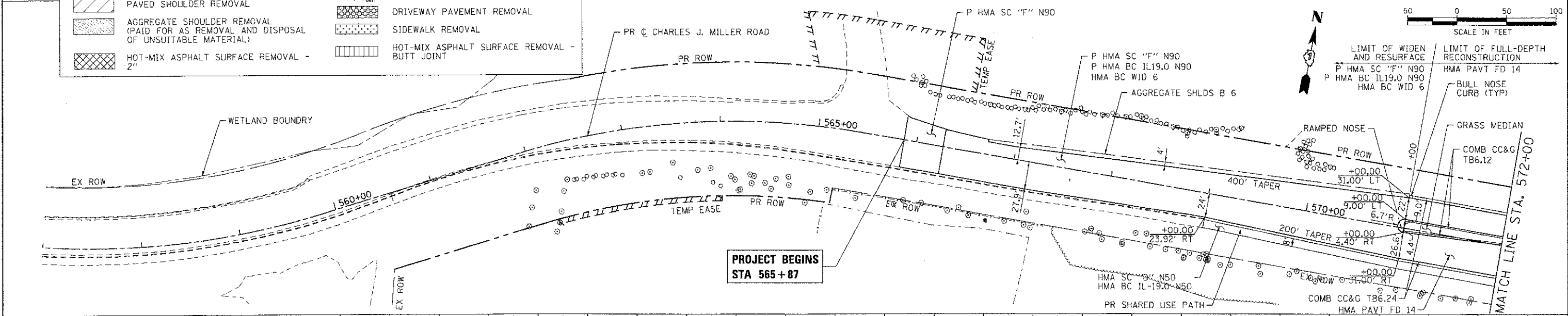

791.41	789.77	788.31	787.01	785.95	785.14	784.47	783.96	783.58	783.73	784.51	785.63	787.18	788.30	789.29	789.66	790.04	789.68	789.04	789.04	788.27	788.27	787.36	787.36	786.00	786.00	784.31	784.31	782.29	782.29	780.16	780.16	777.87	777.87	775.60	775.60	773.36	773.36	771.27	771.27	769.14	769.14	767.19	767.19
557+00	558+00	559+00	560+00	561+00	562+00	563+00	564+00	565+00	566+00	567+00	568+00	569+00	570+00	571+00	572+00																												

HRGreen
 HRGreen.com
 Illinois Professional Design Firm
 #184-091322

USER NAME = jortane	DESIGNED -	REVISED -
	DRAWN -	REVISED -
PLOT SCALE = 1" = 50'	CHECKED -	REVISED -
PLOT DATE = 7/23/2012	DATE -	REVISED -

**MCHENRY COUNTY
 DIVISION OF TRANSPORTATION**

**ROADWAY PLAN AND PROFILE - CHARLES J. MILLER ROAD
 CHARLES J. MILLER ROAD ROADWAY IMPROVEMENTS**

SCALE: 1" = 50' SHEET NO. 1 OF 7 SHEETS STA. 563+00 TO STA. 572+00

F.A.J. RTE. 3860	SECTION 09-00372-00-PW	COUNTY MCHENRY	TOTAL SHEETS 252	SHEET NO. 49
CONTRACT NO. ILLINOIS FED. AID PROJECT 63633				