

PROJECT BEGINS
STA. 565+87

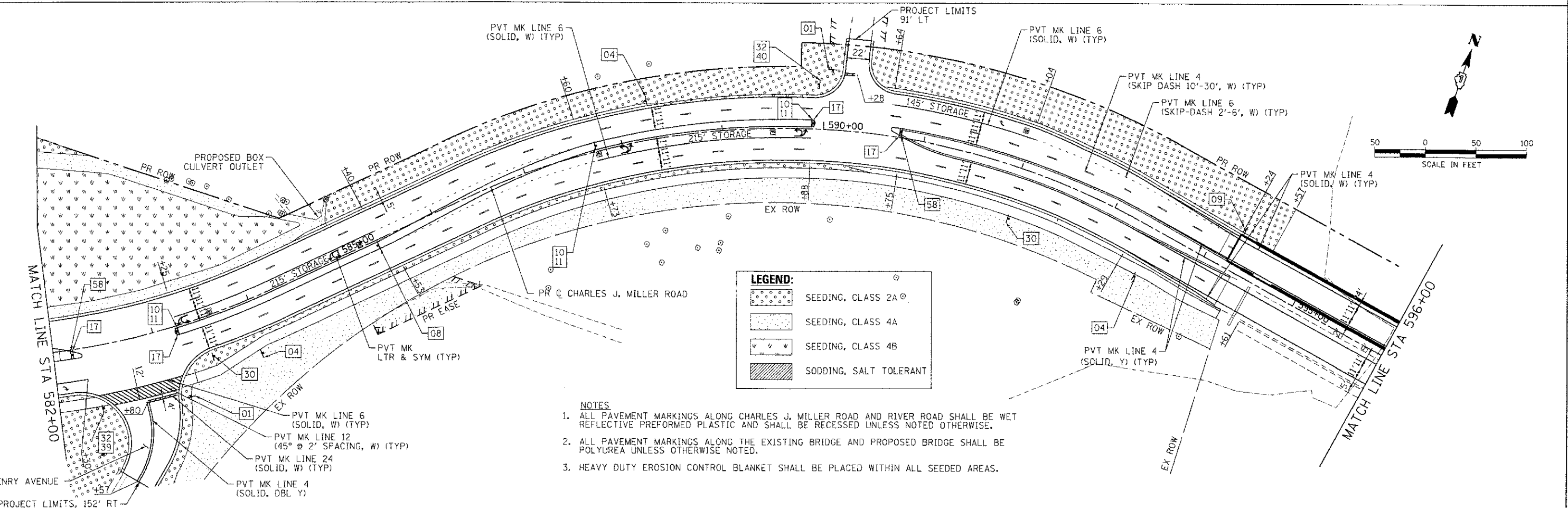
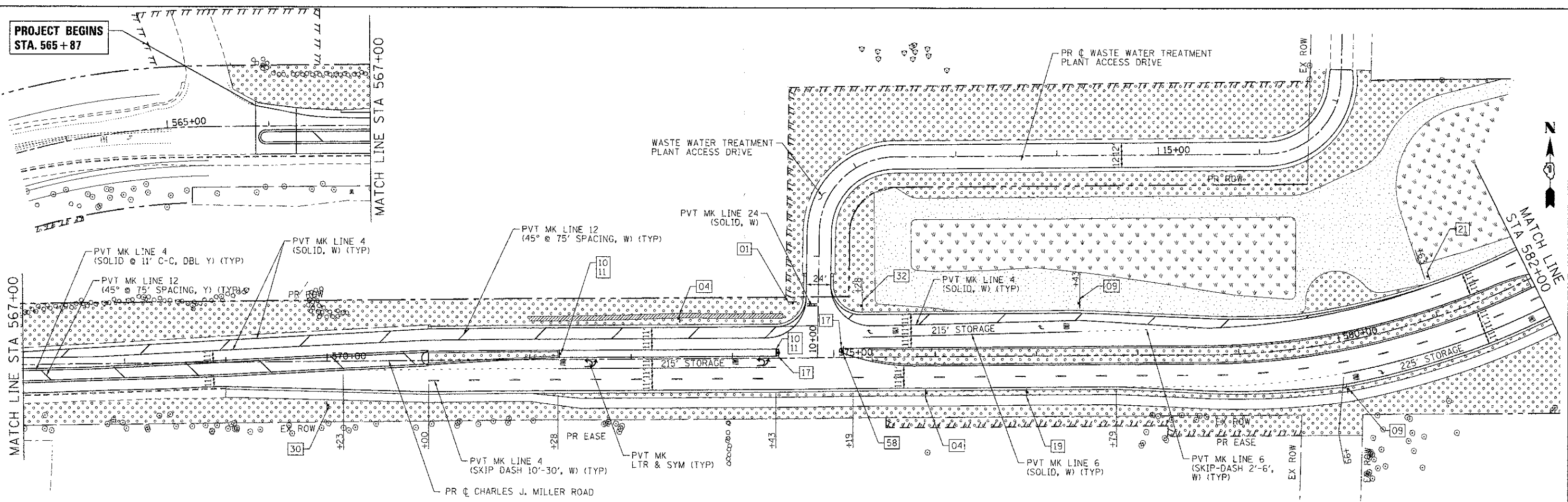

LEGEND:

	SEEDING, CLASS 2A
	SEEDING, CLASS 4A
	SEEDING, CLASS 4B
	SODDING, SALT TOLERANT

- NOTES**
1. ALL PAVEMENT MARKINGS ALONG CHARLES J. MILLER ROAD AND RIVER ROAD SHALL BE WET REFLECTIVE PREFORMED PLASTIC AND SHALL BE RECESSED UNLESS NOTED OTHERWISE.
 2. ALL PAVEMENT MARKINGS ALONG THE EXISTING BRIDGE AND PROPOSED BRIDGE SHALL BE POLYUREA UNLESS OTHERWISE NOTED.
 3. HEAVY DUTY EROSION CONTROL BLANKET SHALL BE PLACED WITHIN ALL SEEDED AREAS.

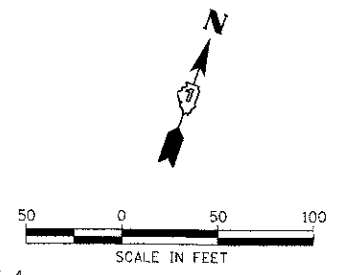

COMPANY NAME: HRGreen.com
 CLIENT CONTACT: jattena
 DATE PLOTTED: 7/23/2012 10:28:48 AM
 FILE NAME: 090071-pm-03.dgn
 PLOT DRIVER: pdfplot
 PEN TABLE: standard-frames.tbl

HRGreen.com
 Illinois Professional Design Firm
 © 194-001322

USER NAME = jattena	DESIGNED - JPA	REVISED -
FILE NAME = 090071-pm-03.dgn	DRAWN - SVJ	REVISED -
PLOT SCALE = 1" = 50'	CHECKED - JLP	REVISED -
PLOT DATE = 7/23/2012	DATE - 7/23/12	REVISED -

**MCHENRY COUNTY
 DIVISION OF TRANSPORTATION**

**PAVEMENT MARKING, SIGNING, AND LANDSCAPING PLAN
 CHARLES J. MILLER ROAD ROADWAY IMPROVEMENTS**

SCALE: 1" = 50' SHEET NO. 1 OF 5 SHEETS STA. 567+00 TO STA. 596+00

F.A.J. R.T.E.	SECTION	COUNTY	TOTAL SHEETS	SHEET NO.
3860	09-00372-00-PW	MCHENRY	252	91
CONTRACT NO. 63633				
FED. ROAD DIST. NO. ILLINOIS FED. AID PROJECT				