

SECTION A-A

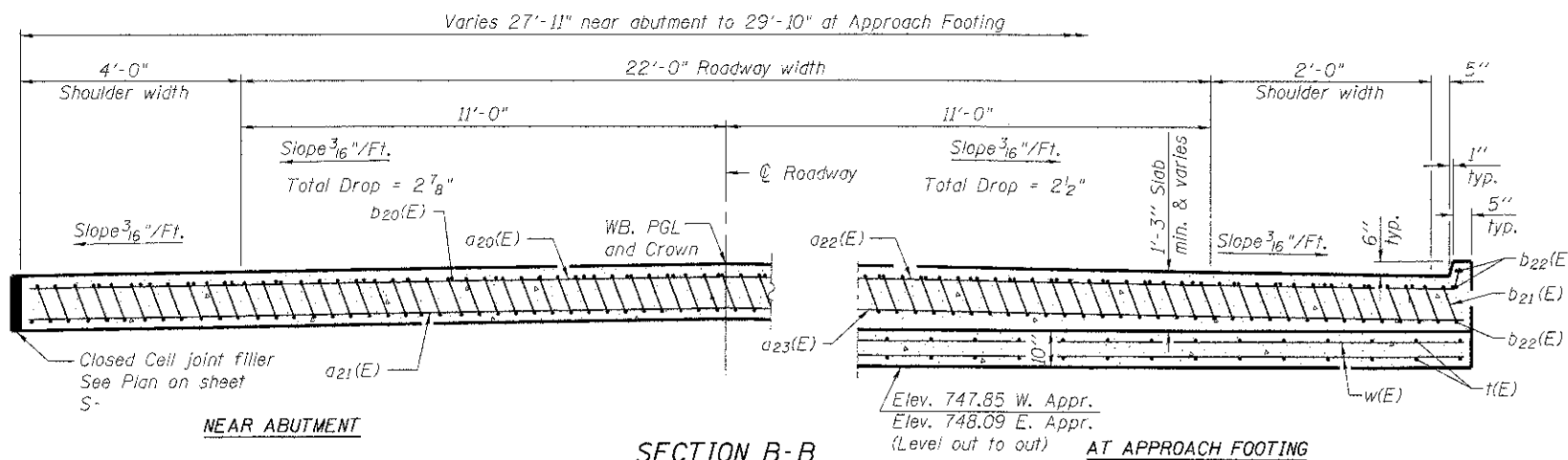

SECTION B-B
(See Plan for dimensions not shown)

* Tilt #9 b₁(E) bars as required to maintain clearance.
 *** Cost included with Concrete Superstructure.

Notes:
 See sheet S-16 of S-41 for Detail A.
 Approach slab shall be paid for as Concrete Superstructure.
 Approach footing concrete shall be paid for as Concrete Structures.
 Reinforcement shall be paid for as Reinforcement Bars, Epoxy Coated.
 The approach footing maximum applied service bearing pressure (Q_{max}) = 2.0 ksf.
 For bar splicer details, see sheet S-34 of S-41.
 Cost of excavation for approach footing included with Concrete Structures.
 For Porous Granular Embankment (Special) and drainage treatment details, see sheet S-3 of S-41.
 See Roadway Details and Cross Sections for Subgrade and Embankment Construction including:
 1) Benching Detail for Embankment Widening
 2) Removal of Unsuitable Materials.

**TWO APPROACHES
BILL OF MATERIAL**

Bar	No.	Size	Length	Shape
a ₂₀ (E)	22	#4	27'-7"	—
a ₂₁ (E)	40	#5	27'-7"	—
a ₂₂ (E)	28	#4	30'-3"	—
a ₂₃ (E)	50	#5	29'-6"	—
b ₂₀ (E)	46	#4	29'-8"	—
b ₂₁ (E)	134	#9	29'-9"	—
b ₂₂ (E)	12	#4	15'-8"	—
t (E)	58	#4	9'-8"	—
w (E)	80	#5	29'-6"	—
Concrete Superstructure			Cu. Yd.	88.4
Concrete Structures			Cu. Yd.	18.4
Reinforcement Bars, Epoxy Coated			Pound	21,090
Protective Coat			Sq. Yd.	221
Bridge Deck Grooving			Sq. Yd.	174

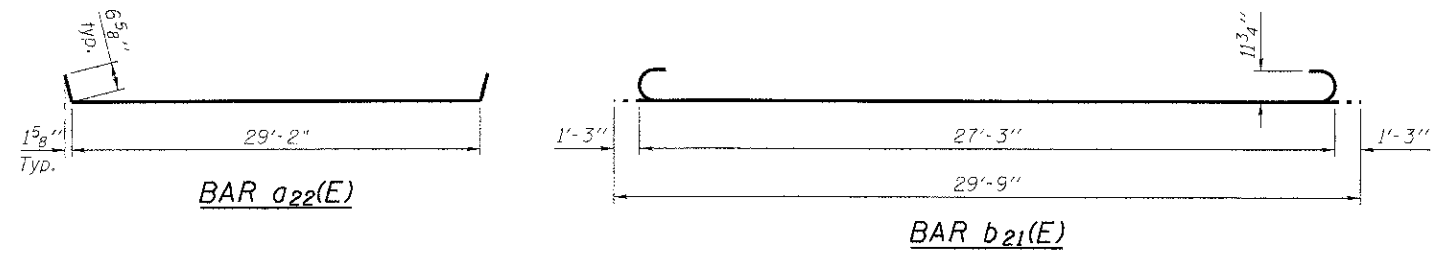

DESIGNED	SSM
CHECKED	RGD
DRAWN	WJH
CHECKED	RGD

BA-0 11-1-09

**BRIDGE APPROACH SLAB DETAILS
STRUCTURE NO. 056-3190**



WB CHARLES J. MILLER ROAD BRIDGE		DATE: 7/23/12	
SHEET NO. S-17	F.A.U. RTE. 3860	SECTION 09-00372-00-PW	COUNTY McHENRY
S-41 SHEETS	CONTRACT NO. 63633		TOTAL SHEETS 140
FED. ROAD DIST. NO. 1 ILLINOIS FED. AID PROJECT			