

FINAL	DATE
SURVEYED	BY
PLOTTED	
NOTE BOOK	
AREAS CHECKED	

ORIGINAL	DATE
SURVEYED	BY
PLOTTED	
NOTE BOOK	
AREAS CHECKED	

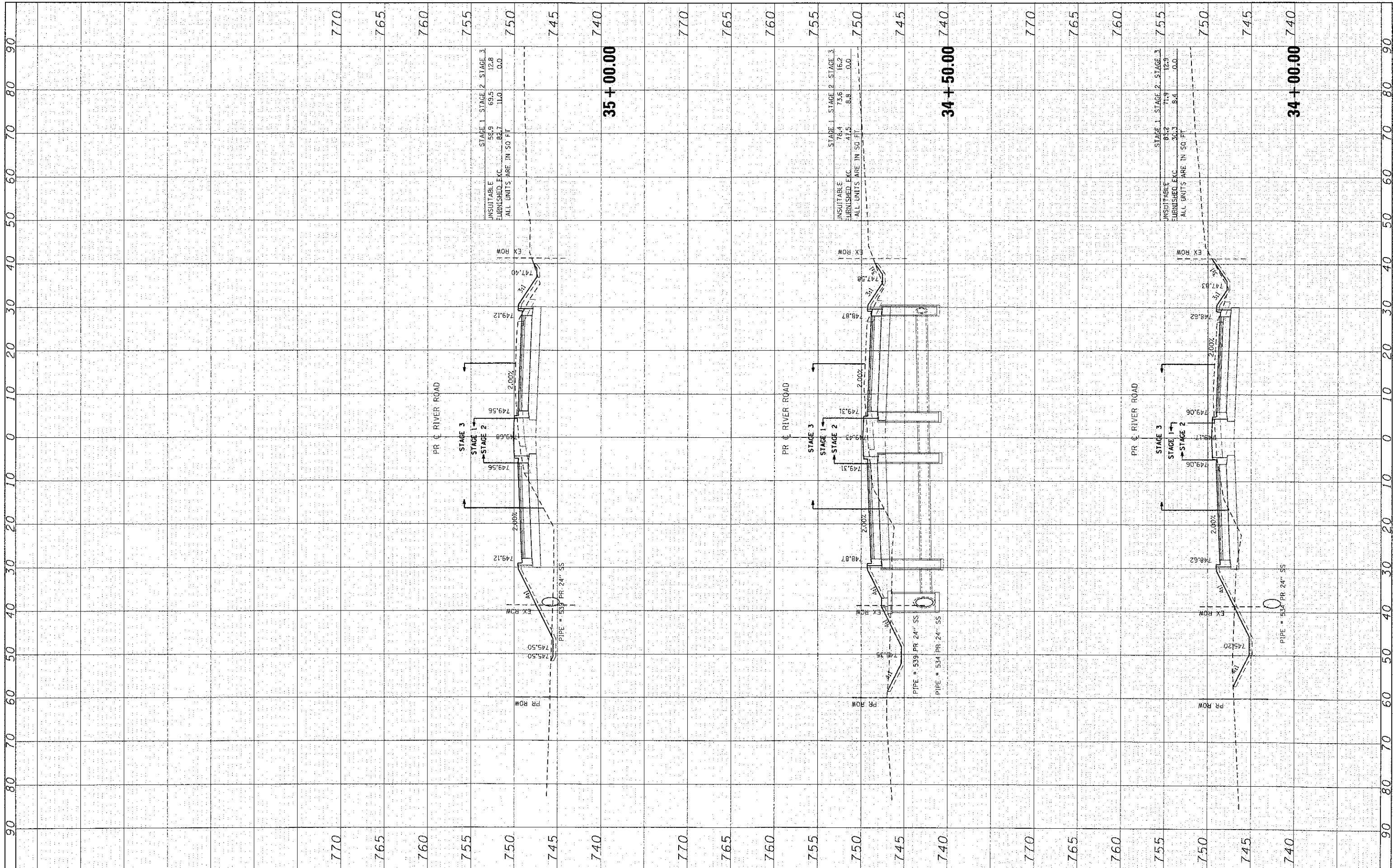

USER NAME = jatlona	DESIGNED - CMH	REVISED -
PLLOT SCALE = 1" = 10'	DRAWN - SVJ	REVISED -
PLLOT DATE = 7/23/2012	CHECKED - JLP	REVISED -
	DATE - 5/29/12	REVISED -

**STATE OF ILLINOIS
DEPARTMENT OF TRANSPORTATION**

**PROPOSED CROSS SECTIONS
RIVER ROAD**

SCALE: 1" = 10' SHEET NO. 53 OF 62 SHEETS STA. 34+00.00 TO STA. 35+00.00

F.A. RTE. 3860	SECTION 09-00372-00-PW	COUNTY MCHENRY	TOTAL SHEETS 252	SHEET NO. 243
CONTRACT NO. ILLINOIS FED. AID PROJECT 63633				