

F.A. RTE.	SECTION	COUNTY	TOTAL SHEETS	SHEET NO.
VAR 33-J	REPLACEMENT FY 2018	VARIOUS	32	1
ILLINOIS			CONTRACT NO. 66H68	

STATE OF ILLINOIS
DEPARTMENT OF TRANSPORTATION

**PROPOSED
HIGHWAY PLANS**

**VARIOUS ROUTES
SECTION D3-J REPLACEMENT FY 2018
PROJECT HSIP-J711(634)
GUARDRAIL END SECTION REPLACEMENT
DEKALB AND KENDALL COUNTIES**

C-93-003-18

INDEX OF SHEETS		INDEX OF SHEETS	
SHEET NO.	DESCRIPTION	SHEET NO.	DESCRIPTION
1	COVER SHEET	22	LOC 12, 047-1071
2	GENERAL NOTES	23	LOC 14, 047-1071
3-4	SUMMARY OF QUANTITIES	24	LOC 16, 047-1071
5-6	COUNTY LOCATION MAPS	25	LOC 18, 047-1071
7-8	SCHEDULE OF QUANTITIES	26	LOC 19, 047-1071
9-10	LOC 1, 019-0026	27-28	LOC 20, 047-1071
11	LOC 2, 019-003	29	LOC 21, 047-1071
12	LOC 4, 019-2549	30	LOC 23, 047-1071
13	LOC 5, 019-1064	31	LOC 24, 047-1071
14	LOC 6, 019-11072	32	DISTRICT DETAILS
15-19	LOC 7, 047-0006		
20-21	LOC 10, 047-0053		

HIGHWAY STANDARDS

STD. NO.	TITLE
000001-06	STANDARD SYMBOLS, ABBREVIATIONS AND PATTERNS
001001-02	AREAS OF REINFORCEMENT BARS
001006-	DECIMAL OF AN INCH AND OF A FOOT
606001-07	CONCRETE CURB TYPE B AND COMBINATION CURB AND CUTTER
630001-12	STEEL PLATE BEAM GUARDRAIL
630101-10	STRONG POST GUARDRAIL ATTACHED TO CULVERT
630106-02	LONG-SPAN GUARDRAIL OVER CULVERTS
630301-08	SHOULDER WIDENING FOR TYPE 1 (SPECIAL) GUARDRAIL TERMINALS
631011-10	TRAFFIC BARRIER TERMINAL, TYPE 2
631031-15	TRAFFIC BARRIER TERMINAL, TYPE 6
635001-02	DELINEATORS
701001-02	OFF-ROAD OPERATIONS, 2L, 2W, MORE THAN 15' (4.5m) AWAY
701006-05	OFF-ROAD OPERATIONS, 2L, 2W, 15' (4.5m) TO 24' (600m) FROM PAVEMENT EDGE
701011-04	OFF-ROAD OPERATIONS, 2L, 2W, DAY ONLY
701010-05	OFF-ROAD OPERATIONS, MULTILANE, 15' (4.5m) TO 24' (600m) FROM PAVEMENT EDGE
701106-02	OFF-ROAD OPERATIONS, MULTILANE, MORE THAN 15' (4.5m) AWAY
701201-04	LANE CLOSURE, 2L, 2W, DAY ONLY, FOR SPEEDS = 45 MPH
701301-04	LANE CLOSURE, 2L, 2W, SHORT TIME OPERATIONS
701326-04	LANE CLOSURE, 2L, 2W, PAVEMENT WIDENING, FOR SPEEDS = 45 MPH
701501-06	URBAN LANE CLOSURE, 2L, 2W, UNDIVIDED
701601-09	URBAN LANE CLOSURE, MULTILANE, 1W OR 2W WITH NONTRAVERSABLE MEDIAN
701901-07	TRAFFIC CONTROL DEVICES
725001-01	OBJECT AND TERMINAL MARKERS
782006	GUARDRAIL AND BARRIER WALL REFLECTOR MOUNTING DETAILS

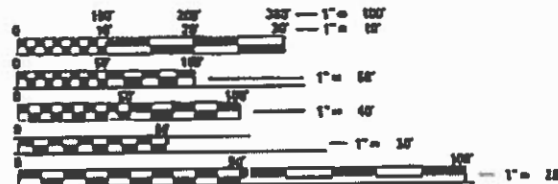

FULL SIZE PLANS HAVE BEEN PREPARED USING STANDARD ENGINEERING SCALES. REDUCED SIZED PLANS WILL NOT CONFORM TO STANDARD SCALES. IN MAKING MEASUREMENTS ON REDUCED PLANS, THE ABOVE SCALES MAY BE USED.

J.U.L.I.E.
JOINT UTILITY LOCATION INFORMATION FOR EXCAVATION
1-800-892-0123
OR 811

PROJECT ENGINEER JOE KANNEL, P.E.
UNIT CHIEF MARC BUDZYNSKI, P.E.
DISTRICT 3 NO. (815) 434-6131
CONTRACT NO. 66H68

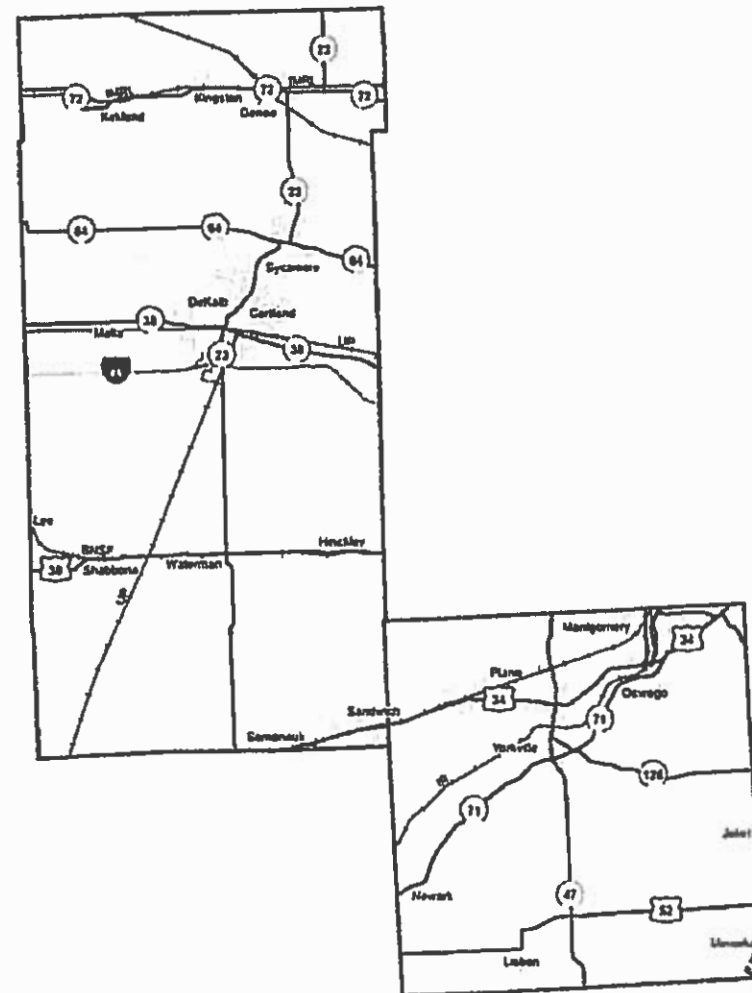

PROFESSIONAL ENGINEER'S SIGN & SEAL
Joe Kannel
EXPIRES: 11/30/19

STATE OF ILLINOIS
DEPARTMENT OF TRANSPORTATION
DIVISION OF HIGHWAYS
SUBMITTED: 4-3-18
K. Marshall REGIONAL ENGINEER
Marc Budzynski ENGINEER OF DESIGN AND ENVIRONMENT
Joe Kannel DIRECTOR OF HIGHWAYS PROJECT IMPLEMENTATION

PRINTED BY THE AUTHORITY
OF THE STATE OF ILLINOIS

GENERAL NOTES

1. FOR STABILIZATION, ALL TYPE III BARRICADES WILL REQUIRE A MINIMUM OF FOUR SAND BAGS PER BARRICADE.
2. SEEDING WILL NOT BE PERMITTED AT ANY TIME WHEN THE GROUND IS FROZEN, WET, OR IN AN UNTILLABLE CONDITION. LOCATIONS TO BE SEEDED WILL BE DETERMINED BY THE ENGINEER.
3. ABANDONED UNDERGROUND UTILITIES THAT CONFLICT WITH CONSTRUCTION SHALL BE DISPOSED OF OUTSIDE THE LIMITS OF THE RIGHT OF WAY ACCORDING TO ARTICLE 202.03 OF THE STANDARD SPECIFICATIONS AND AS DIRECTED BY THE ENGINEER. THIS WORK WILL NOT BE PAID FOR SEPARATELY, BUT WILL BE INCLUDED IN THE COST OF EARTH EXCAVATION.
4. ANY REFERENCE TO A STANDARD IN THESE PLANS SHALL BE INTERPRETED TO MEAN THE EDITION AS INDICATED BY THE SUBNUMBER SHOWN IN THE LIST OF STANDARDS OR THE COPY INCLUDED IN THESE PLANS.
5. THE CONTRACTOR'S ATTENTION IS DIRECTED TO THE PRESENCE OF DEPARTMENT-OWNED UNDERGROUND ELECTRICAL CABLE WITHIN THE LIMITS OF THE PROPOSED IMPROVEMENT. THE CONTRACTOR SHALL REQUEST THE ILLINOIS DEPARTMENT OF TRANSPORTATION IN OTTAWA (815-434-8417) TO LOCATE THE UNDERGROUND FACILITIES, PROVIDING A MINIMUM OF 72 HOURS NOTICE. THE DEPARTMENT IS NOT A MEMBER OF THE JOINT UTILITY LOCATING INFORMATION FOR EXCAVATORS (JULIE) SYSTEM.
6. ALL DAMAGE TO DEPARTMENT OWNED UNDERGROUND FACILITIES, CAUSED BY THE CONTRACTOR SHALL BE REPAIRED TO THE SATISFACTION OF THE DEPARTMENT AT THE CONTRACTOR'S EXPENSE. THIS SHALL INCLUDE ALL TEMPORARY REPAIRS REQUIRED TO KEEP THE FACILITY OPERATIONAL WHILE MATERIAL IS BEING OBTAINED TO MAKE PERMANENT REPAIRS. SPLICING OF ELECTRIC CABLE WILL NOT BE ALLOWED. ELECTRIC CABLE SHALL BE REPLACED FROM POLE TO POLE OR CONTROLLER.
7. NON-MEMBERS OF JULIE KNOWN TO BE WITHIN THE LIMITS OF THE IMPROVEMENT AREA: ILLINOIS DEPARTMENT OF TRANSPORTATION. SEE LOCATION 10.
8. THE FINISHED EARTHWORK SHALL HAVE A VEGETATION SUSTAINING SOIL COVERING THE TOP FOUR INCHES (100 MILLIMETERS) IN AREAS TO BE SEEDED OR SOODED. THE VEGETATION SUSTAINING SOIL REQUIRED WILL NOT BE PAID FOR SEPARATELY BUT WILL BE INCLUDED IN THE COST OF FURNISHED EXCAVATION.
9. ALL EXCAVATED MATERIAL, WHICH INCLUDES DIGGING OR GRADING OF ANY SOIL OR FILL MATERIAL, WITH THE EXCEPTION OF AGGREGATE FILLS, MUST BE INCORPORATED WITHIN THE IDOT RIGHT OF WAY DUE TO ENVIRONMENTAL DOCUMENTATION REQUIREMENTS.
10. THERE ARE SEVERAL AREAS THROUGHOUT THE PROJECT WHERE THERE IS EXISTING HMA SHOULDER WHERE CURB AND GUTTER IS TO BE PLACED. REMOVAL OF THE HMA SHOULDER SHALL NOT BE PAID FOR SEPARATELY, BUT SHALL BE INCLUDED IN THE COST OF THE SPBGR.
11. GUARDRAIL POSTS THAT NEED TO BE DRIVEN THROUGH EXISTING HMA SHOULDER OR CONCRETE SHOULDER SHALL NOT BE PAID FOR SEPARATELY, BUT SHALL BE INCLUDED IN THE COST OF SPBGR.
12. DETAILED LOCATION INFORMATION AVAILABLE FROM DISTRICT UPON REQUEST.

ABBREVIATIONS

SPBGR TY A 6' = STEEL PLATE BEAM GUARDRAIL, TYPE A, 6 FOOT POSTS
 SPBGR TY A 9' = STEEL PLATE BEAM GUARDRAIL, TYPE A, 9 FOOT POSTS
 SPBGR ATTACH TO STR = STEEL PLATE BEAM GUARDRAIL ATTACHED TO STRUCTURE
 LSG OV CUL = LONG-SPAN GUARDRAIL OVER CULVERT
 TBT T2 = TRAFFIC BARRIER TERMINAL, TYPE 2
 TBT T6 = TRAFFIC BARRIER TERMINAL, TYPE 6
 TBT T6A = TRAFFIC BARRIER TERMINAL, TYPE 6A
 TBT T1 (SPL) TAN = TRAFFIC BARRIER TERMINAL, TYPE 1 (SPECIAL) TANGENT
 TBT T1 (SPL) FL = TRAFFIC BARRIER TERMINAL, TYPE 1 (SPECIAL) FLARED
 TBT T1 = TRAFFIC BARRIER TERMINAL, TYPE 1
 N.I.C. = NOT IN CONTRACT
 L.O.N. = LENGTH OF NEED
 EOTW = EDGE OF TRAVELED WAY
 EOS = EDGE OF SHOULDER
 L = DISTANCE FROM EDGE OF TRAVELED WAY TO BARRIER

STATE OF ILLINOIS
 DEPARTMENT OF TRANSPORTATION
 DISTRICT THREE
 AS BUILT INFORMATION

 SUPERVISING CONSTRUCTION FIELD ENGINEER

 RESIDENT ENGINEER / TECHNICIAN

START & END DATES
 OF CONSTRUCTION: _____

INSPECTORS: _____

STATE OF ILLINOIS
 DEPARTMENT OF TRANSPORTATION
 DISTRICT THREE

PREPARED BY: *Dr. Basil*
 DISTRICT STUDIES & PLANS ENGINEER

DATE: 4-3-18

EXAMINED BY: *Thade Vidyanayake*
 DISTRICT CONSTRUCTION ENGINEER

Michael A. Short
 DISTRICT MATERIALS ENGINEER

Paul Hayes
 DISTRICT OPERATIONS ENGINEER

I:\011\2017\006-30\CA01\Transportation\001\CAD_Shts\0366H6B-sh1-GeneralNotes-D.dgn
 4/27/2018 3:30:16 PM

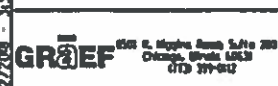

USER NAME = 1488	DESIGNED -	REVISED -
PLOT DRIVER = pdfNCLAY[P3]sw-plt-fg	DRAWN -	REVISED -
PEN TABLE = 2017006-30.tbl	CHECKED -	REVISED -
PLOT SCALE = 24.8888 1/16"	DATE = 03/27/18	REVISED -

STATE OF ILLINOIS
 DEPARTMENT OF TRANSPORTATION

GUARDRAIL END SECTION REPLACEMENT
 GENERAL NOTES

SCALE: 1"=40' SHEET OF SHEETS STA. TO STA.

P.A. RITE VAR.	SECTION	COUNTY	TOTAL SHEETS	SHEET NO.
	D3-J REPLACEMENT 2018	VARIOUS	32	2
CONTRACT NO. 66H68				
ILLINOIS FED. AID PROJECT				

CODE NO.	ITEM DESCRIPTION	UNIT	TOTAL QUANTITY	0021 SAFETY	
				90% FED. 10% STATE	90% FED. 10% STATE
				DEKALB COUNTY	KENDALL COUNTY
20100110	TREE REMOVAL (6 TO 15 UNITS DIAMETER)	UNIT	48		48
20400800	FURNISHED EXCAVATION	CU YD	4,101	721	3,380
25000210	SEEDING CLASS 2A	ACRE	3.9	1.6	2.3
25000400	NITROGEN FERTILIZER NUTRIENT	POUND	359	146	213
25000500	PHOSPHOROUS FERTILIZER NUTRIENT	POUND	359	146	213
25000600	POTASSIUM FERTILIZER NUTRIENT	POUND	359	146	213
25100635	HEAVY DUTY EROSION CONTROL BLANKET	SQ YD	19,051	7,795	11,256
28000400	PERIMETER EROSION BARRIER	FOOT	4,176	1,330	2,846
60600605	CONCRETE CURB, TYPE B	FOOT	135	75	60
63000001	STEEL PLATE BEAM GUARDRAIL, TYPE A, 6 FOOT POSTS	FOOT	1,012.5	1,012.5	
63000003	STEEL PLATE BEAM GUARDRAIL, TYPE A, 9 FOOT POSTS	FOOT	6,712.5	762.5	5,950.0
63000350	LONG-SPAN GUARDRAIL OVER CULVERT, 12 FT 6 IN SPAN	FOOT	637.5	150.0	487.5
63000360	LONG-SPAN GUARDRAIL OVER CULVERT, 18 FT 9 IN SPAN	FOOT	175.0	87.5	87.5
63100085	TRAFFIC BARRIER TERMINAL, TYPE 6	EACH	13	5	8

14

CODE NO.	ITEM DESCRIPTION	UNIT	TOTAL QUANTITY	0021 SAFETY	
				90% FED. 10% STATE	90% FED. 10% STATE
				DEKALB COUNTY	KENDALL COUNTY
63100167	TRAFFIC BARRIER TERMINAL, TYPE 1 (SPECIAL) TANGENT	EACH	59	17	42
63200310	GUARDRAIL REMOVAL	FOOT	9,112	2,705	6,407
67100100	MOBILIZATION	LSUM	1	0.3	0.7
70100450	TRAFFIC CONTROL AND PROTECTION, STANDARD 701201	LSUM	1	0.3	0.7
70100500	TRAFFIC CONTROL AND PROTECTION, STANDARD 701326	LSUM	1	0.3	0.7
70102620	TRAFFIC CONTROL AND PROTECTION, STANDARD 701501	LSUM	1	0.3	0.7
70102631	TRAFFIC CONTROL AND PROTECTION, STANDARD 701601	EACH	1		1
72501000	TERMINAL MARKER - DIRECT APPLIED	EACH	59	17	42
7820005	GUARDRAIL REFLECTORS, TYPE A	EACH	169	50	119
X0325667	WEED CONTROL MOWING STRIP (SPECIAL)	SQ YD	3,809	963	2,846

10

X:\WORK\2017\06-30\CAD\Transportation\dgm\CAD_Shts\D366H68-sht-LocMap-01.dgn 4/2/2018 3:33:23 PM

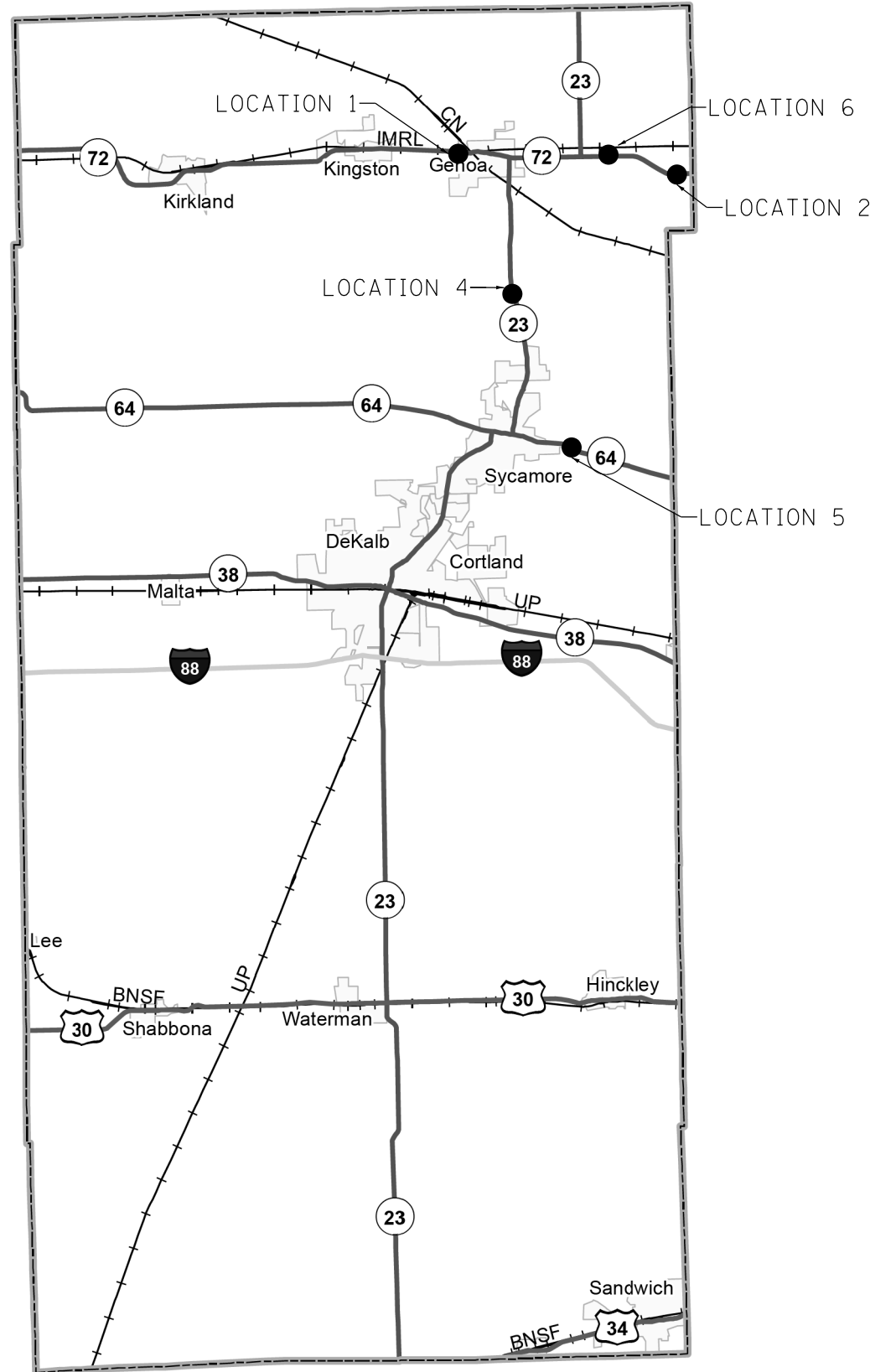

Location	Structure No
1	019-0026-003
	019-0026-004
	019-0026-005
	019-0026-006
	019-0026-007
2	019-0026-008
	019-0033-033
	019-0033-034
4	019-0033-035
	019-0033-036
	019-2549-001
	019-2549-002
5	019-2549-003
	019-2549-004
	019-il064-18
	019-il064-21
6	019-il064-19
	019-il064-20
	019-il072-049
	019-il072-050
	019-il072-051
	019-il072-052

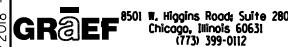

USER NAME = 1908	DESIGNED -	REVISED -
PLOT DRIVER = pdfNOLAYERSbw.pltcf	DRAWN -	REVISED -
PEN TABLE = 20173006-30.tbl	CHECKED -	REVISED -
PLOT SCALE = 24.0000' / ft.	DATE - 03/27/18	REVISED -

**STATE OF ILLINOIS
DEPARTMENT OF TRANSPORTATION**

LOCATION MAP - DEKALB COUNTY

SHEET 1 OF 2 SHEETS STA. TO STA.

F.A. - RTE.	SECTION	COUNTY	TOTAL SHEETS	SHEET NO.
VAR.	D3-J REPLACEMENT 2018	VARIOUS	32	5
CONTRACT NO. 66H68				
ILLINOIS FED. AID PROJECT				

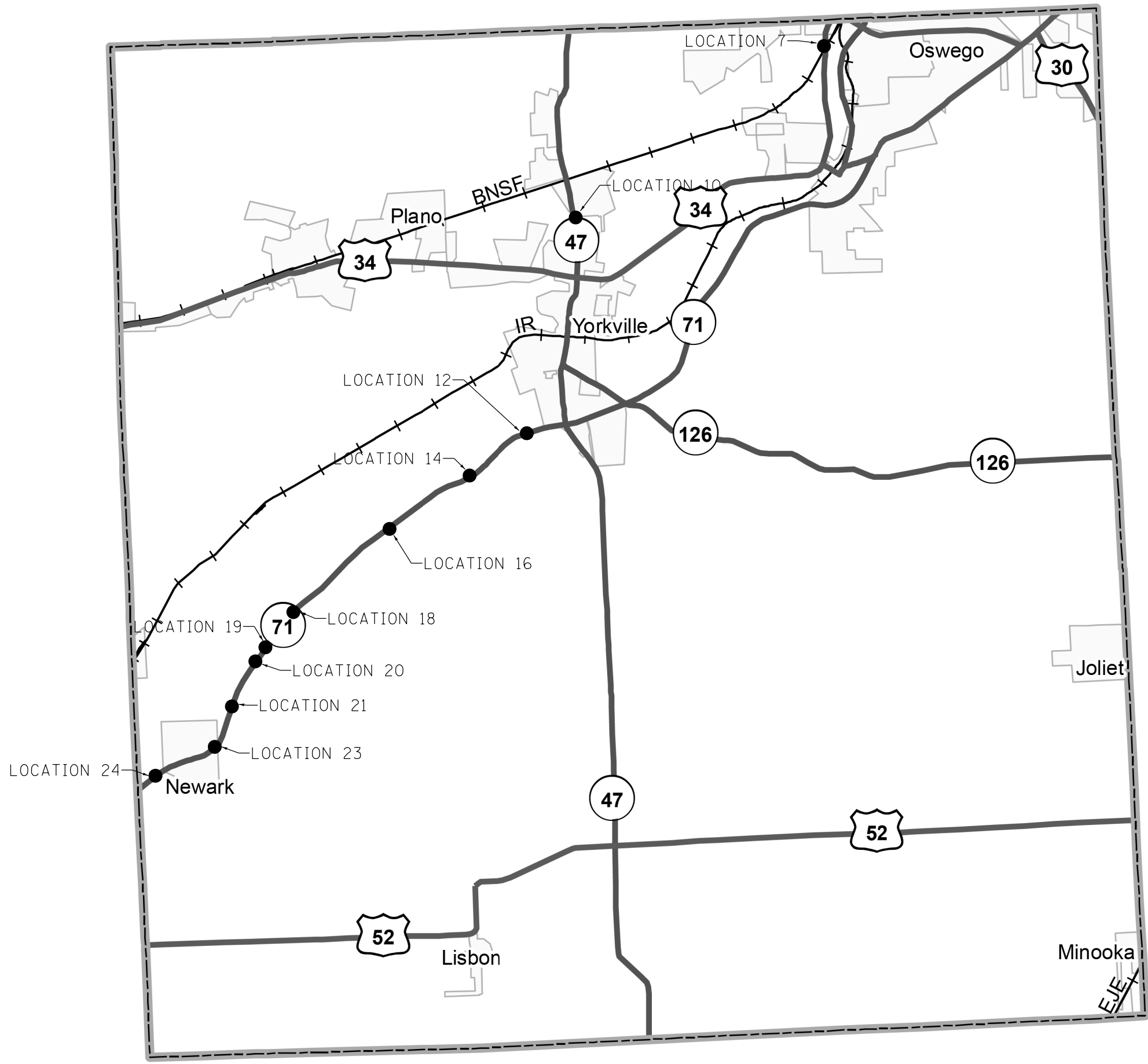

Location	Structure No	
7	047-0006-001	
	047-0006-002	
	047-0006-003	
	047-0006-004	
	047-0006-005	
	047-0006-006	
	047-0006-007	
	047-0006-008	
10	047-0053-001	
	047-0053-002	
	047-0053-003	
	047-0053-004	
	047-0053-005	
	047-0053-006	
	047-0053-007	
	047-0053-008	
12	047-il071-011	
	047-il071-012	
	047-il071-013	
	047-il071-014	
14	047-il071-019	
	047-il071-020	
	047-il071-021	
16	047-il071-022	
	047-il071-027	
	047-il071-028	
	047-il071-029	
	047-il071-030	
	047-il071-039	
	18	047-il071-040
		047-il071-041
		047-il071-042
	19	047-il071-043
047-il071-044		
20	047-il071-045	
	047-il071-046	
	047-il071-047	
	047-il071-048	
21	047-il071-051	
	047-il071-049	
	047-il071-053	
	047-il071-052	
	047-il071-057	
23	047-il071-058	
	047-il071-059	
	047-il071-060	
24	047-il071-061	
	047-il071-062	
	047-il071-063	
	047-il071-064	
	047-il071-064	
	047-il071-064	

X:\OH\2017\20173006-30\CAD\Transportation\Map\CAD_Shts\0366H68-sht-LocMap-02.dgn
 4/2/2018 3:33:33 PM

GR&EF 8501 W. Higgins Road Suite 280
 Chicago, Illinois 60631
 (773) 399-0112

USER NAME = 1908	DESIGNED -	REVISED -
PLOT DRIVER = pdfNOLAYERSbw.pltcf	DRAWN -	REVISED -
PEN TABLE = 20173006-30.tbl	CHECKED -	REVISED -
PLOT SCALE = 24.0000' / ft.	DATE - 03/27/18	REVISED -

STATE OF ILLINOIS
 DEPARTMENT OF TRANSPORTATION

LOCATION MAP - KENDALL COUNTY

#SCALE8 SHEET 2 OF 2 SHEETS STA. TO STA.

F.A.-RTE.	SECTION	COUNTY	TOTAL SHEETS	SHEET NO.
VAR.	D3-J REPLACEMENT 2018	VARIOUS	32	6
			CONTRACT NO. 66H68	
ILLINOIS FED. AID PROJECT				

KENDALL COUNTY GUARDRAIL WORK																									
LOCATION NUMBER	ID NUMBER	ROUTE	STR. NUMBER	DIRECTION	LONGITUDE	LATITUDE	GUARDRAIL REMOVAL (FOOT)	SPBGR TA 9' POSTS (FOOT)	LSG 12' 6" SPAN (FOOT)	LSG 18' 9" SPAN (FOOT)	TERM MARK DIRECT APPL (EACH)	GUARDRAIL MKR TY A (EACH)	TBT, TY1 SPL TAN (EACH)	TBT, TYPE 6 (EACH)	FURN EX (CU YD)	CURB TY B (FOOT)	SEEDING CL 2A (ACRE)	NITROGEN FERT. NUT. (POUND)	PHOSPHORUS FERT. NUT. (POUND)	POTASSIUM FERT. NUT. (POUND)	HD EROS CONT BLKT (SQ YD)	PERIMETER EROSION BARRIER (FOOT)	WEED CONT. STRIP MOWING (SQ YD)	TREE REMOVAL (6 TO 15 UNITS DIA) (UNITS)	
7	047-0006-001	IL 31	047-0006	SB	-88.355562	41.717821	436	550			1	6	1										200	48	
	047-0006-004	IL 31	047-0006	SB	-88.355539	41.716605								1									29		
	047-0006-002	IL 31	047-0006	NB	-88.355240	41.717766	302	37.5			1	5	1										208		
	047-0006-003	IL 31	047-0006	NB	-88.355287	41.716957																			
	047-0006-005	IL 31	047-0006	SB	-88.355540	41.715618																			
	047-0006-007	IL 31	047-0006	SB	-88.355563	41.713856	654	575				8	1												
	047-0006-006	IL 31	047-0006	NB	-88.355286	41.715934																			
	047-0006-008	IL 31	047-0006	NB	-88.355304	41.713819	775	887.5				9	1												
10	047-0053-001	IL 47	047-0053	NB	-88.442167	41.670891	228	62.5			1	4	1										50	600	
	047-0053-002	IL 47	047-0053	NB	-88.442494	41.671462																	50		
	047-0053-003	IL 47	047-0053	NB	-88.442717	41.67181																	50		
	047-0053-004	IL 47	047-0053	NB	-88.44288	41.672108	120				1	4	1										50		
	047-0053-005	IL 47	047-0053	SB	-88.443222	41.672367	222	62.5			1	4	1										50		
	047-0053-006	IL 47	047-0053	SB	-88.442889	41.671796																			50
	047-0053-007	IL 47	047-0053	SB	-88.442689	41.671469	78					4	1												
	047-0053-008	IL 47	047-0053	SB	-88.442578	41.671278																			
12	047-1071-011	IL 71	N/A	WB	-88.470514	41.613881	130	125	37.5		1	4	1										88	1114	
	047-1071-012	IL 71	N/A	WB	-88.470185	41.614118																	88		
	047-1071-013	IL 71	N/A	EB	-88.470149	41.613973	130	112.5	37.5		1	4	1												
	047-1071-014	IL 71	N/A	EB	-88.470484	41.613731																			
14	047-1071-019	IL 71	N/A	WB	-88.478571	41.608141	128	187.5	37.5		1	4	1										108	1114	
	047-1071-022	IL 71	N/A	WB	-88.478929	41.607932																	100		
	047-1071-020	IL 71	N/A	EB	-88.478475	41.608045	142	162.5	37.5		1	4	1												
	047-1071-021	IL 71	N/A	EB	-88.478874	41.607801																			
16	047-1071-027	IL 71	N/A	WB	-88.509909	41.59393	128	125	37.5		1	4	1										88	1114	
	047-1071-028	IL 71	N/A	WB	-88.509525	41.594133																	88		
	047-1071-029	IL 71	N/A	EB	-88.509526	41.59398	128	125	37.5		1	4	1												
	047-1071-030	IL 71	N/A	EB	-88.509905	41.59378																			
18	047-1071-039	IL 71	N/A	WB	-88.552299	41.564253	228	212.5	37.5		1	4	1										117	1114	
	047-1071-040	IL 71	N/A	WB	-88.552803	41.563754																	108		
	047-1071-041	IL 71	N/A	EB	-88.552641	41.563703	303	187.5	37.5		1	5	1												
	047-1071-042	IL 71	N/A	EB	-88.55197	41.564372																			
19	047-1071-043	IL 71	N/A	WB	-88.554019	41.562539	251	200	37.5		1	4	1										113	630	
	047-1071-044	IL 71	N/A	WB	-88.554569	41.561982																			
	047-1071-045	IL 71	N/A	WB	-88.556763	41.559817	598	575			1	7	1												
	047-1071-047	IL 71	N/A	WB	-88.558053	41.558525																			
20	047-1071-046	IL 71	N/A	EB	-88.556547	41.559815	624	675			1	7	1										258	1114	
	047-1071-048	IL 71	N/A	EB	-88.557902	41.558469																			
	047-1071-053	IL 71	N/A	WB	-88.565220	41.549240																			
	047-1071-054	IL 71	N/A	WB	-88.565400	41.548890	260	125	37.5		1	8	1												
21	047-1071-051	IL 71	N/A	EB	-88.565114	41.549107																	96	1114	
	047-1071-052	IL 71	N/A	EB	-88.565291	41.548776																			
	047-1071-057	IL 71	N/A	EB	-88.570305	41.538597	140	256.25		43.75	1	4	1												
	047-1071-058	IL 71	N/A	EB	-88.570005	41.538597																			
23	047-1071-059	IL 71	N/A	WB	-88.57016	41.538993	140	118.75		43.75	1	4	1										133	1114	
	047-1071-060	IL 71	N/A	WB	-88.570462	41.538652																	88		
	047-1071-061	IL 71	N/A	WB	-88.586539	41.532967	132	112.5	37.5		1	4	1												
	047-1071-062	IL 71	N/A	WB	-88.58611	41.533111																			
24	047-1071-063	IL 71	N/A	EB	-88.58615	41.532954	130	175	37.5		1	4	1										88	1114	
	047-1071-064	IL 71	N/A	EB	-88.586571	41.532823																	104		
COUNTY TOTALS							6407	5950	487.5	87.5	42	119	42	8	3380	60	2.3	213	213	213	11256	2140	2846	48	

DEKALB COUNTY GUARDRAIL WORK																								
LOCATION NUMBER	ID NUMBER	ROUTE	STR. NUMBER	DIRECTION	LONGITUDE	LATITUDE	GUARDRAIL REMOVAL (FOOT)	SPBGR TA 6' POSTS (FOOT)	SPBGR TA 9' POSTS (FOOT)	LSG 12' 6" SPAN (FOOT)	LSG 18' 9" SPAN (FOOT)	TERM MARK DIRECT APPL (EACH)	GUARDRAIL MKR TY A (EACH)	TBT, TY1 SPL TAN (EACH)	TBT, TYPE 6 (EACH)	FURN EX (CU YD)	CURB TY B (FOOT)	SEEDING CL 2A (ACRE)	NITROGEN FERT. NUT. (POUND)	PHOSPHORUS FERT. NUT. (POUND)	POTASSIUM FERT. NUT. (POUND)	HD EROS CONT BLKT (SQ YD)	PERIMETER EROSION BARRIER (FOOT)	WEED CONT. STRIP MOWING (SQ YD)
1	019-0026-003	IL 72	019-0026	EB	-88.704791	42.097798	117	12.5				1	4	1	1		15						80	21
	019-0026-004	IL 72	019-0026	EB	-88.70437	42.097794						1		1									80	21
	019-0026-005	IL 72	019-0026	WB	-88.70432	42.097929	130	12.5				1	4	1									80	21
	019-0026-006	IL 72	019-0026	WB	-88.704788	42.097901										1							160	179
	019-0026-001	IL 72	019-0026	EB	-88.707760	42.097994	560	487.5				1	7	1								4163	160	183
	019-0026-002	IL 72	019-0026	EB	-88.705670	42.097819										1							15	
	019-0026-007	IL 72	019-0026	WB	-88.705699	42.097906	545	500				1	7	1									15	
	019-0026-008	IL 72	019-0026	WB	-88.707678	42.098084							1		1									
2	019-0033-033	IL 72	019-0033	EB	-88.598577	42.088193	80						4		1	112	15	0.1	5	5	5	290	50	33
	019-0033-034	IL 72	019-0033	EB	-88.597919	42.088182						1		1										
4	019-2549-001	IL 23	019-2549	NB	-88.684099	42.046037	230		112.5		43.75		4	1									160	88
	019-2549-002	IL 23	019-2549	NB	-88.684172	42.046658						1		1									160	88
	019-2549-003	IL 23	019-2549	SB	-88.684374	42.046763	231		150		43.75		4	1		89		0.2	21	21	21	1114	160	88
	019-2549-004	IL 23	019-2549	SB	-88.684299	42.046137						1		1										
5	019-1064-019	IL 64	N/A	WB	-88.630450	41.977180			125				1	1										
	019-1064-018	IL 64	N/A	WB	-88.629830	41.977036	308			75			8	1		306		0.2	21	21	21	1114	160	175
	019-1064-021	IL 64	N/A	EB	-88.630573	41.977117						1		1										
	019-1064-020	IL 64	N/A	EB	-88.63004	41.97699						1		1										
6	019-1072-049	IL 72	N/A	EB	-88.642573	42.095474	254		125		37.5		4	1									160	88
	019-1072-051	IL 72	N/A	EB	-88.641651	42.095469						1		1									160	88
	019-1072-050	IL 72	N/A	WB	-88.642397	42.095588	250		125		37.5		4	1		93		0.2	21	21	21	1114	160	88
	019-1072-052	IL 72	N/A	WB	-88.641486	42.095587						1		1										
COUNTY TOTALS							2705	1012.5	762.5	150.0	87.5	17	50	17	5	721	75	1.6	146	146	146	7795	1330	963

FILE # 17/5/2018

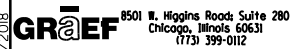

USER NAME = ferguson	DESIGNED -	REVISED -
PLOT DRIVER = #PLTs	DRAWN -	REVISED -
PEN TABLE = #PEN#	CHECKED -	REVISED -
PLOT SCALE = 40.0000' / in.	DATE - 03/27/18	REVISED -

STATE OF ILLINOIS
DEPARTMENT OF TRANSPORTATION

GUARDRAIL END SECTION REPLACEMENT
SCHEDULE OF QUANTITIES

SCALE: 1"=40' SHEET 2 OF 2 SHEETS STA. TO STA.

F.A. -- RTE.	SECTION	COUNTY	TOTAL SHEETS	SHEET NO.
VAR.	D3-J REPLACEMENT 2018	VARIOUS	32	8
CONTRACT NO. 66H68			ILLINOIS FED. AID PROJECT	

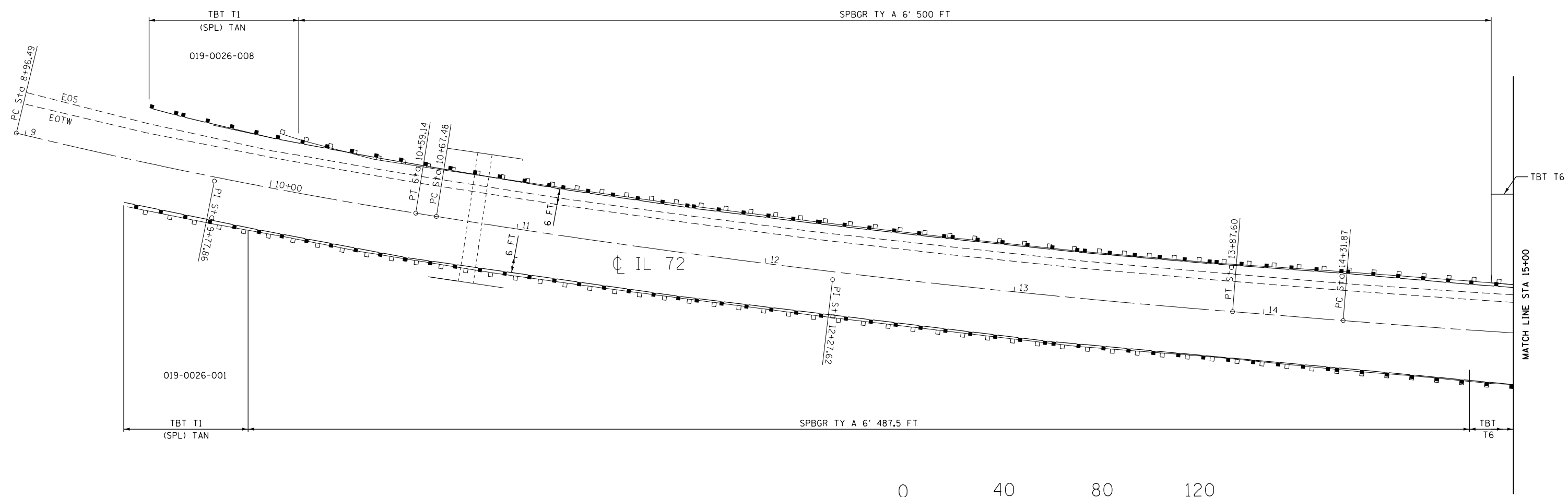

X:\04\2017\201706-30\CAD\Transportation\CAD_Shts\0366H68-sht-Location#01.dgn
 4/22/2018 10:35:51 PM



USER NAME = 1908	DESIGNED -	REVISED -
PLOT DRIVER = pdfNOLAYERSbw.pltcf	DRAWN -	REVISED -
PEN TABLE = 20173006-30.tbl	CHECKED -	REVISED -
PLOT SCALE = 480.0000' / ft.	DATE - 03/27/18	REVISED -

STATE OF ILLINOIS
DEPARTMENT OF TRANSPORTATION

GUARDRAIL END SECTION REPLACEMENT 019-0026 (LOCATION 1)			
SCALE: 1"=40'	SHEET 1	OF 2 SHEETS	STA. TO STA.

F.A.-RTE.	SECTION	COUNTY	TOTAL SHEETS	SHEET NO.
VAR.	D3-J REPLACEMENT 2018	VARIOUS	32	9
CONTRACT NO. 66H68				
ILLINOIS FED. AID PROJECT				

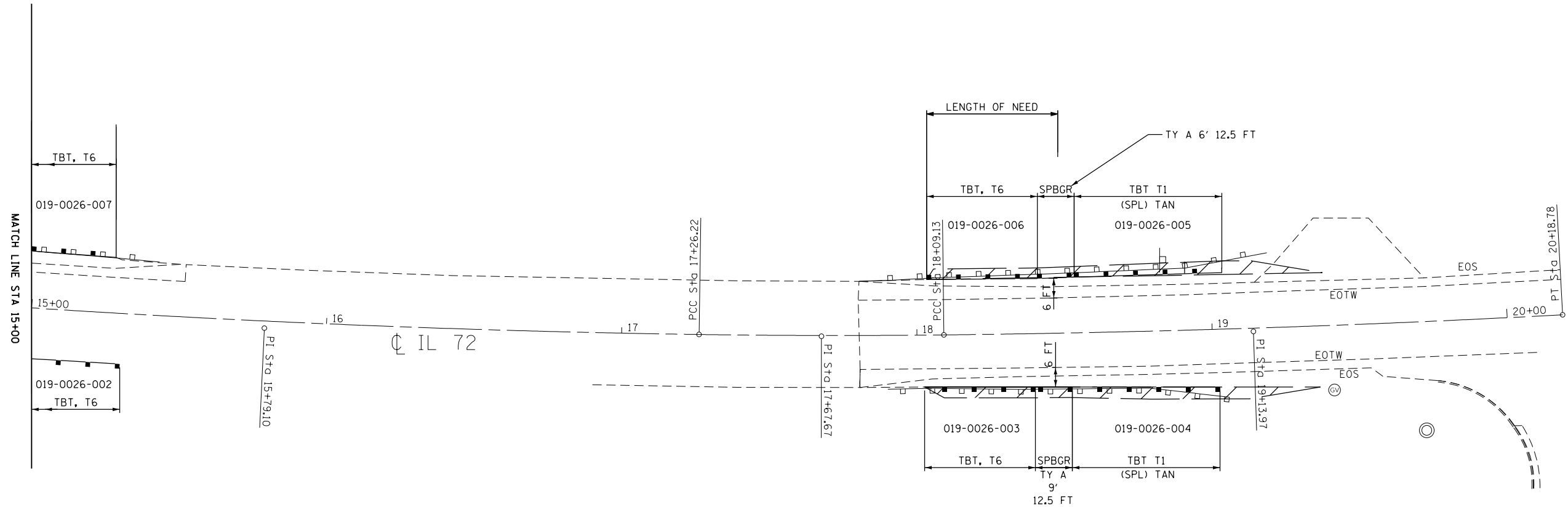

X:\01\2017\06-30\CAD\Transportation\dgm\CAD_Shts\0366468-sht-Location#01-2 REVISED.dgn
 4/22/2018 - 3:33:52 PM



USER NAME = 1908	DESIGNED -	REVISED -
PLOT DRIVER = pdfNOLAYERSbw.pltcfp	DRAWN -	REVISED -
PEN TABLE = 20173006-30.tbl	CHECKED -	REVISED -
PLOT SCALE = 480.0000' / ft.	DATE - 03/27/18	REVISED -

STATE OF ILLINOIS
DEPARTMENT OF TRANSPORTATION

GUARDRAIL END SECTION REPLACEMENT 019-0026 (LOCATION 1)			
SCALE: 1"=40'	SHEET 2	OF 2 SHEETS	STA. TO STA.

F.A.-RTE.	SECTION	COUNTY	TOTAL SHEETS	SHEET NO.
VAR.	D3-J REPLACEMENT 2018	VARIOUS	32	10
CONTRACT NO. 66H68				
ILLINOIS FED. AID PROJECT				

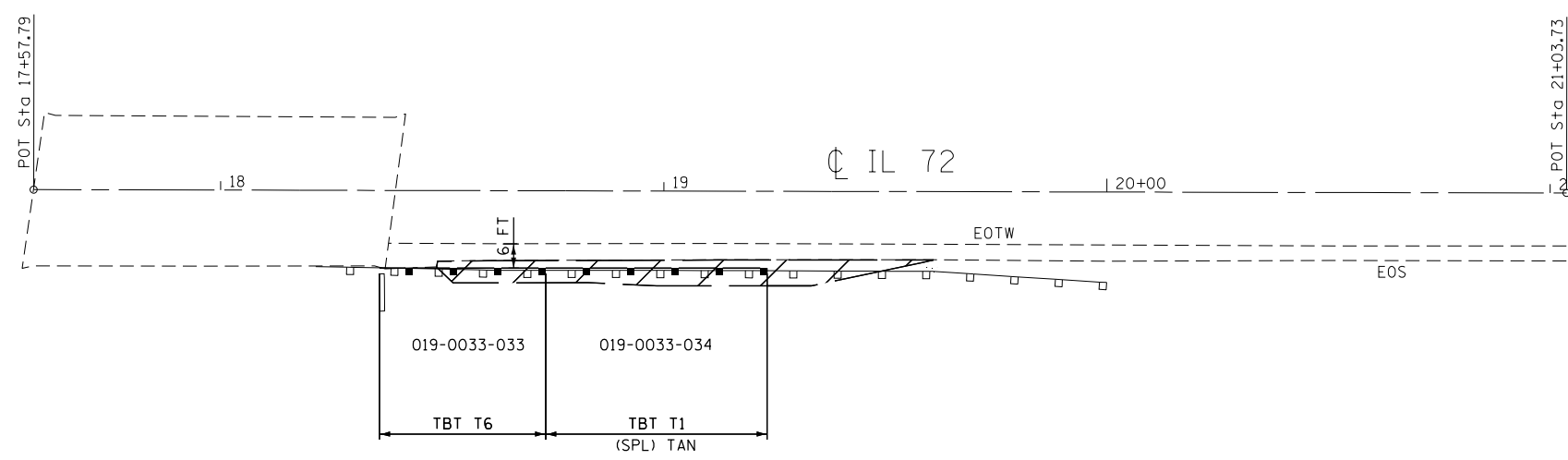

X:\04\2017\201706-30\CAD\Transportation\dgm\CAD_Shts\D366H68-sht-Location#02.dgn
 4/22/2018 3:33:53 PM



USER NAME = 1908	DESIGNED -	REVISED -
PLOT DRIVER = pdfNQLAYERSbw.pltcfq	DRAWN -	REVISED -
PEN TABLE = 20173006-30.tbl	CHECKED -	REVISED -
PLOT SCALE = 480.0000' / ft.	DATE - 03/27/18	REVISED -

STATE OF ILLINOIS
DEPARTMENT OF TRANSPORTATION

GUARDRAIL END SECTION REPLACEMENT
019-003 (LOCATION 2)

SCALE: 1"=40' SHEET OF SHEETS STA. TO STA.

F.A. -- RTE.	SECTION	COUNTY	TOTAL SHEETS	SHEET NO.
VAR.	D3-J REPLACEMENT 2018	VARIOUS	32	11
ILLINOIS FED. AID PROJECT			CONTRACT NO. 66H68	



EXIST. CURVE LOC*04-1
 PI STA. = 39+79.97
 $\Delta = 1^\circ 22' 15''$ (RT)
 $D = 0^\circ 49' 07''$
 $R = 6,998.41'$
 $T = 83.72'$
 $L = 167.43'$
 $E = 0.50'$
 $e = \text{-----}$
 T.R. = -----
 S.E. RUN = -----
 P.C. STA. = 38+96.25
 P.T. STA. = 40+63.68

EXIST. CURVE LOC*04-2
 PI STA. = 41+77.55
 $\Delta = 2^\circ 43' 04''$ (RT)
 $D = 1^\circ 11' 37''$
 $R = 4,800.00'$
 $T = 113.87'$
 $L = 227.69'$
 $E = 1.35'$
 $e = \text{-----}$
 T.R. = -----
 S.E. RUN = -----
 P.C. STA. = 40+63.68
 P.T. STA. = 42+91.38

EXIST. CURVE LOC*04-3
 PI STA. = 43+32.06
 $\Delta = 0^\circ 03' 12''$ (RT)
 $D = 0^\circ 03' 56''$
 $R = 87,474.86'$
 $T = 40.68'$
 $L = 81.37'$
 $E = 0.01'$
 $e = \text{-----}$
 T.R. = -----
 S.E. RUN = -----
 P.C. STA. = 42+91.38
 P.T. STA. = 43+72.75

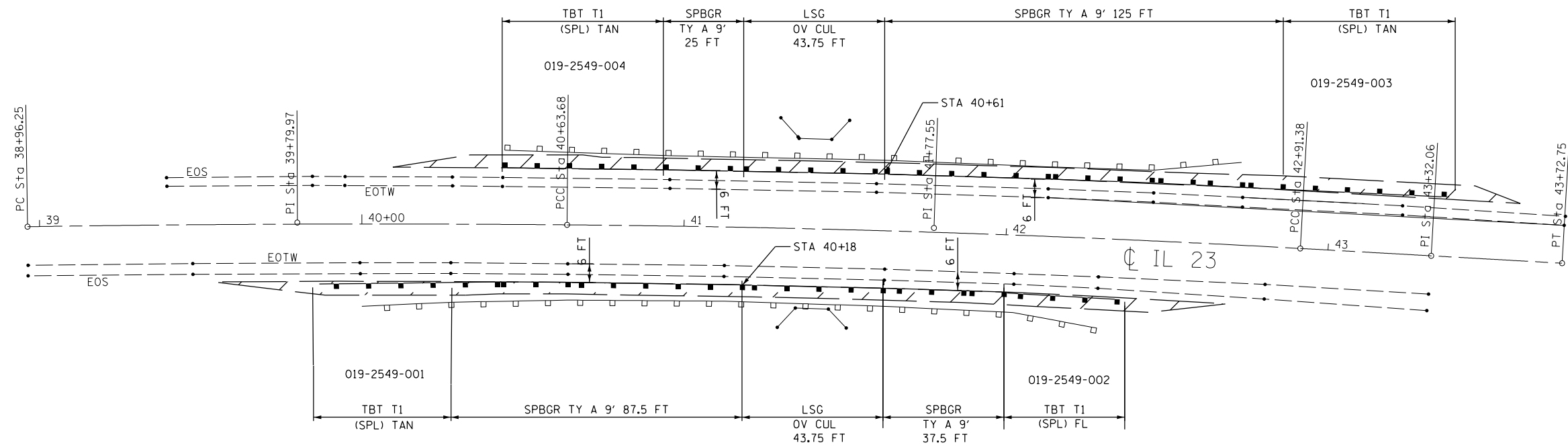

FILE# 7/5/2018

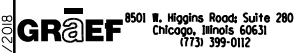

USER NAME = fergusonso	DESIGNED -	REVISED -
PLOT DRIVER = #PLTs	DRAWN -	REVISED -
PEN TABLE = #PEN#	CHECKED -	REVISED -
PLOT SCALE = 40.0000' / in.	DATE - 03/27/18	REVISED -

STATE OF ILLINOIS
 DEPARTMENT OF TRANSPORTATION

GUARDRAIL END SECTION REPLACEMENT
 019-2549 (LOCATION 4)

SCALE: 1"=40' SHEET OF SHEETS STA. TO STA.

F.A.-RTE.	SECTION	COUNTY	TOTAL SHEETS	SHEET NO.
VAR. 03-J REPLACEMENT 2018	VARIOUS	VARIOUS	32	12
CONTRACT NO. 66H68				
ILLINOIS FED. AID PROJECT				

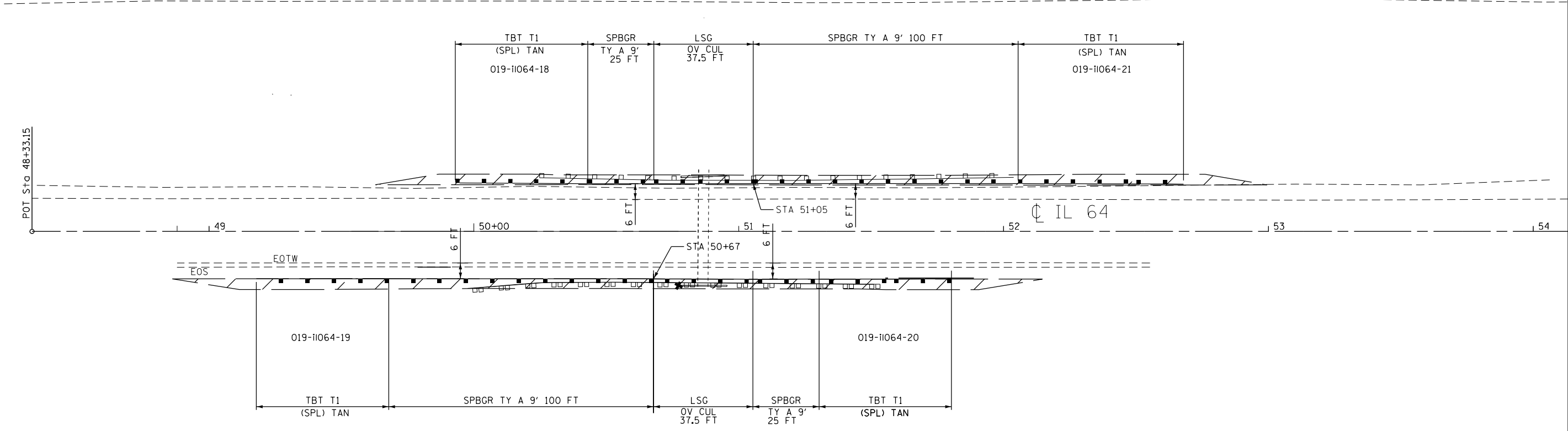

X:\0\N\2017\2017006-30\CAD\Transportation\dgn\CAD_Shts\0366H68-sht-Location\05REVISED.dgn
 5/10/2018 4:45:03 PM



USER NAME = 1908	DESIGNED -	REVISED -
PLOT DRIVER = pdfNQLAYERSbw.pltcfp	DRAWN -	REVISED -
PEN TABLE = 20173006-30.tbl	CHECKED -	REVISED -
PLOT SCALE = 480.0000' / ft.	DATE - 03/27/18	REVISED -

STATE OF ILLINOIS
DEPARTMENT OF TRANSPORTATION

GUARDRAIL END SECTION REPLACEMENT 019-11064 (LOCATION 5)			
SCALE: 1"=40'	SHEET	OF	SHEETS
	STA.	TO	STA.

F.A.-RTE.	SECTION	COUNTY	TOTAL SHEETS	SHEET NO.
VAR.	D3-J REPLACEMENT 2018	VARIOUS	32	13
CONTRACT NO. 66H68				
<small>ILLINOIS FED. AID PROJECT</small>				

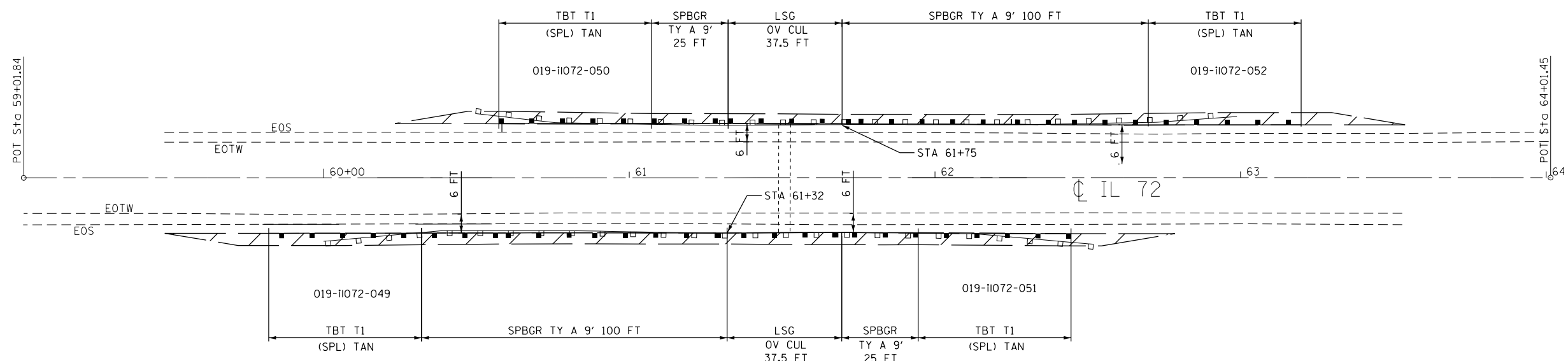

X:\0\A\2017\201706-30\CAD\Transportation\dgm\CAD_Shts\0366H68-sht-Location\06REVISED.dgn
4/22/2018 3:33:57 PM



USER NAME = 1908	DESIGNED -	REVISED -
PLOT DRIVER = pdfNOLAYERSbw.pltcfp	DRAWN -	REVISED -
PEN TABLE = 20173006-30.tbl	CHECKED -	REVISED -
PLOT SCALE = 480.0000' / ft.	DATE - 03/27/18	REVISED -

**STATE OF ILLINOIS
DEPARTMENT OF TRANSPORTATION**

**GUARDRAIL END SECTION REPLACEMENT
019-11072 (LOCATION 6)**

SCALE: 1"=40' SHEET OF SHEETS STA. TO STA.

F.A. - RTE.	SECTION	COUNTY	TOTAL SHEETS	SHEET NO.
VAR.	D3-J REPLACEMENT 2018	VARIOUS	32	14
ILLINOIS FED. AID PROJECT			CONTRACT NO. 66H68	

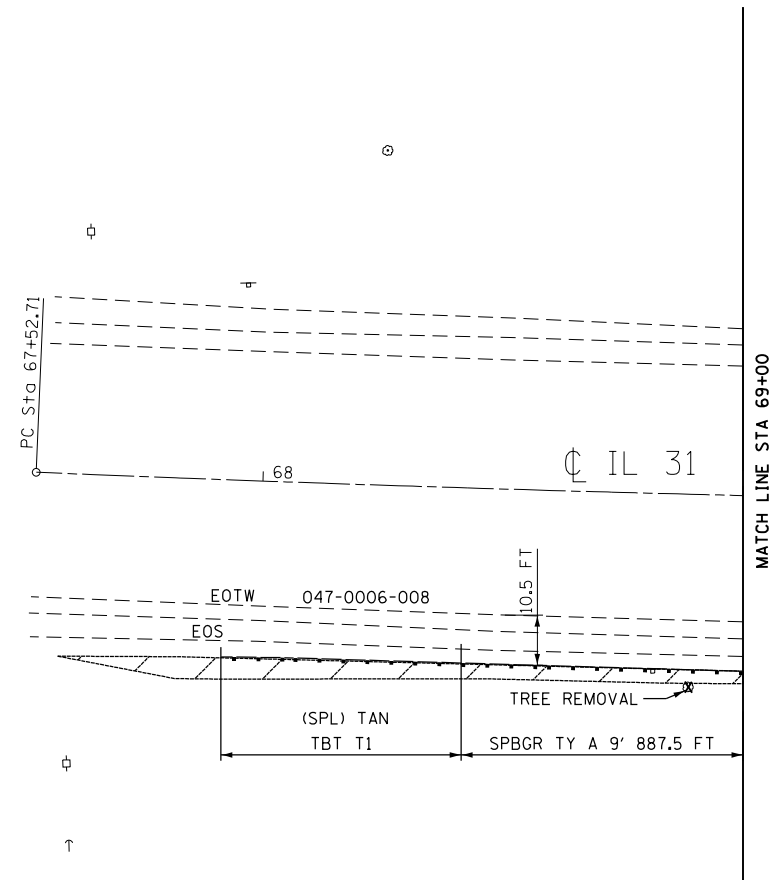

\$FILE#
 \$DATE#

GRAEF 8501 W. Higgins Road, Suite 280
 Chicago, Illinois 60631
 (773) 399-0112

USER NAME = \$USER#	DESIGNED -	REVISED -
PLOT DRIVER = \$PLT#	DRAWN -	REVISED -
PEN TABLE = \$PEN#	CHECKED -	REVISED -
PLOT SCALE = \$SCALE#	DATE - 03/27/18	REVISED -

**STATE OF ILLINOIS
 DEPARTMENT OF TRANSPORTATION**

**GUARDRAIL END SECTION REPLACEMENT
 047-0006 (LOCATION 7)**

SCALE: 1"=40' SHEET 1 OF 5 SHEETS STA. TO STA.

F.A.-RTE.	SECTION	COUNTY	TOTAL SHEETS	SHEET NO.
VAR.	D3-J REPLACEMENT 2018	VARIOUS	32	15
CONTRACT NO. 66H68			ILLINOIS FED. AID PROJECT	

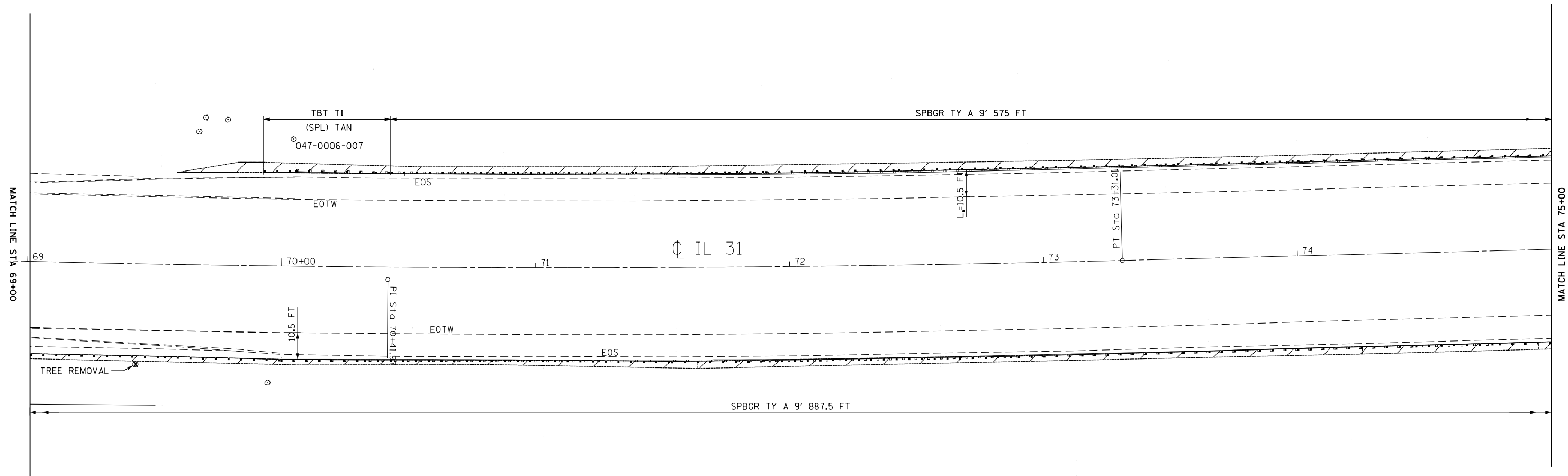
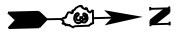

X:\04\2017\2017006-30\CAD\Transportation\CAD_Shts\0366468-sht-Location#07-.dgn
 5/10/2018 4:45:03 PM



USER NAME = 1908	DESIGNED -	REVISED -
PLOT DRIVER = pdfNQLAYERSbw.pltcfq	DRAWN -	REVISED -
PEN TABLE = 20173006-30.tbl	CHECKED -	REVISED -
PLOT SCALE = 480.0271' / ft.	DATE - 03/27/18	REVISED -

STATE OF ILLINOIS
DEPARTMENT OF TRANSPORTATION

GUARDRAIL END SECTION REPLACEMENT 047-0006 (LOCATION 7)			
SCALE: 1"=40'	SHEET 2	OF 5 SHEETS	STA. TO STA.

F.A. RTÉ.	SECTION	COUNTY	TOTAL SHEETS	SHEET NO.
VAR.	D3-J REPLACEMENT 2018	VARIOUS	32	16
CONTRACT NO. 66H68			ILLINOIS FED. AID PROJECT	

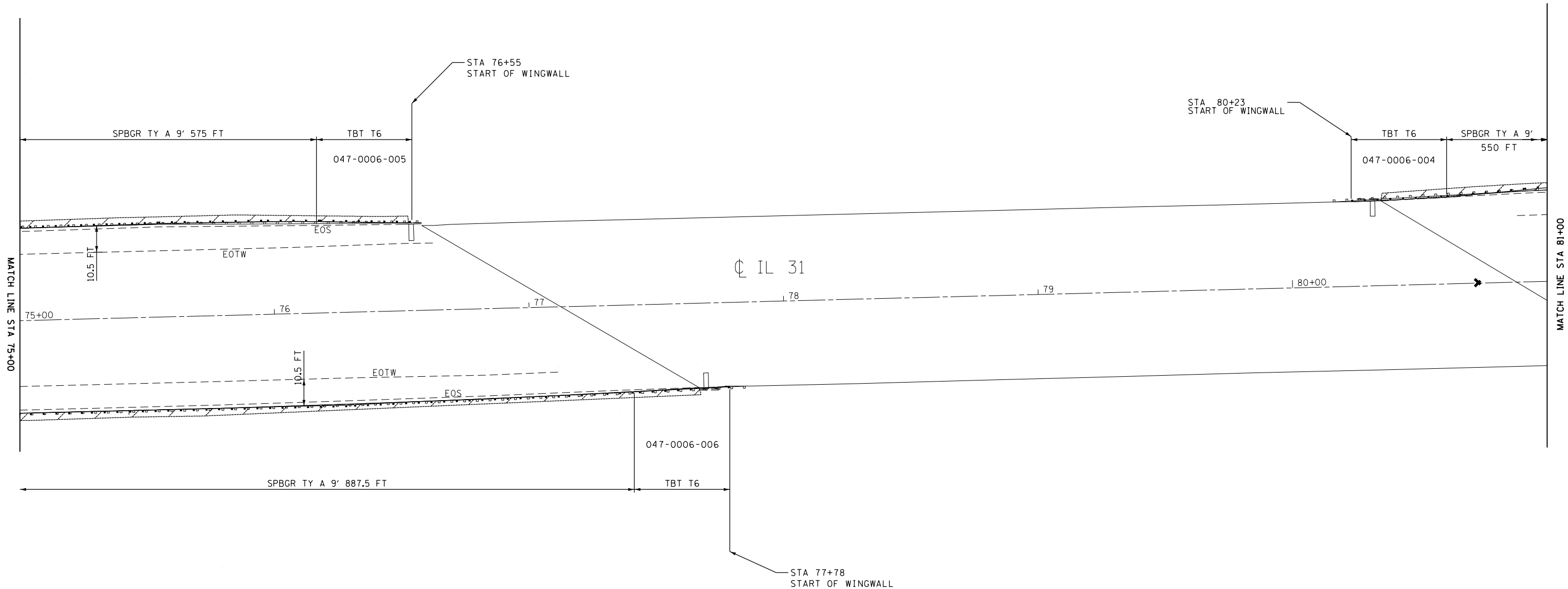
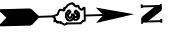

X:\04\2017\20173006-30\CAD\Transportation\dgn\CAD_Shts\0366H68-sht-Location#07-2.dgn
 5/10/2018 4:45:50 PM



USER NAME = 1908	DESIGNED -	REVISED -
PLOT DRIVER = pdfNCLAYERSbw.pltcf	DRAWN -	REVISED -
PEN TABLE = 20173006-30.tbl	CHECKED -	REVISED -
PLOT SCALE = 480.0000' / ft.	DATE - 03/27/18	REVISED -

STATE OF ILLINOIS
DEPARTMENT OF TRANSPORTATION

GUARDRAIL END SECTION REPLACEMENT 047-0006 (LOCATION 7)			
SCALE: 1"=40'	SHEET 3	OF 5 SHEETS	STA. TO STA.

F.A. - RTE.	SECTION	COUNTY	TOTAL SHEETS	SHEET NO.
VAR.	D3-J REPLACEMENT 2018	VARIOUS	32	17
CONTRACT NO. 66H68				
ILLINOIS FED. AID PROJECT				

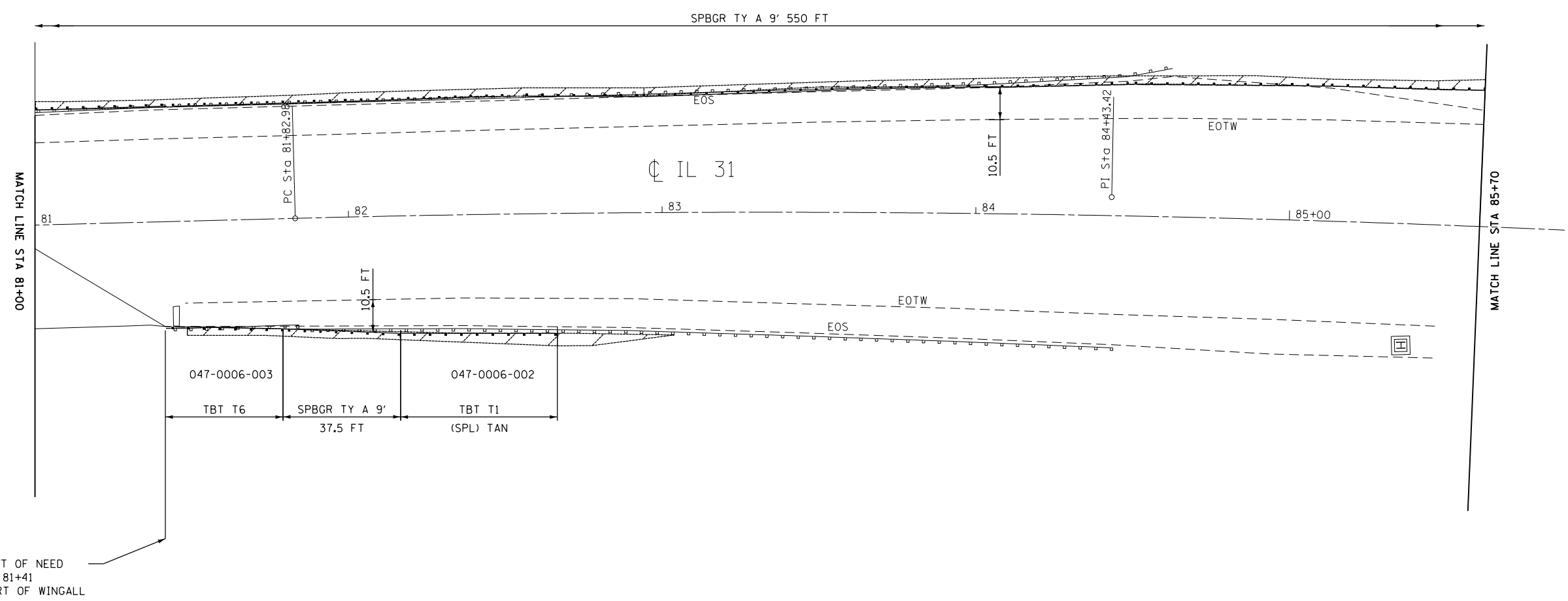

X:\ON\2017\2017006-30\CAD\Transportation\dgn\CAD_Shts\0366H68-sht-Location#07-3.dgn
5/10/2018 4:45:08 PM

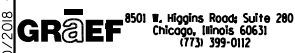

USER NAME = 1908	DESIGNED -	REVISED -
PLOT DRIVER = pdfNQLAYERSbw.pltcfq	DRAWN -	REVISED -
PEN TABLE = 20173006-30.tbl	CHECKED -	REVISED -
PLOT SCALE = 480.0271' / ft.	DATE - 03/27/18	REVISED -

**STATE OF ILLINOIS
DEPARTMENT OF TRANSPORTATION**

GUARDRAIL END SECTION REPLACEMENT 047-0006 (LOCATION 7)			
SCALE: 1"=40'	SHEET 4	OF 5 SHEETS	STA. TO STA.

F.A. - RTE.	SECTION	COUNTY	TOTAL SHEETS	SHEET NO.
VAR.	D3-J REPLACEMENT 2018	VARIOUS	32	18
CONTRACT NO. 66H68				
ILLINOIS FED. AID PROJECT				

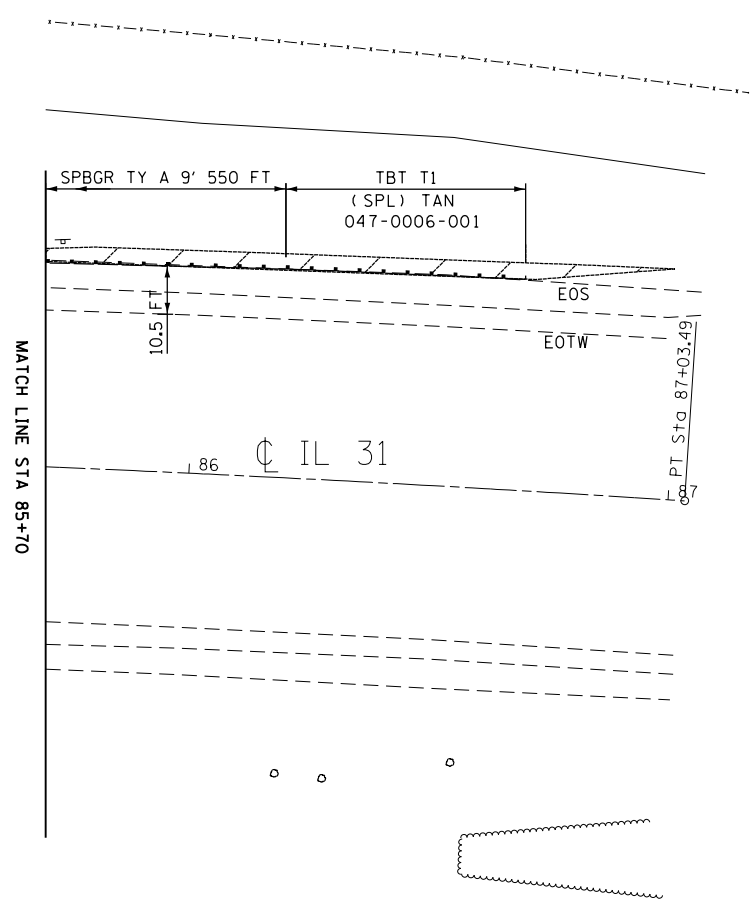

\$FILE#
 \$DATE#
GRAEF 8501 W. Higgins Road, Suite 280
 Chicago, Illinois 60631
 (773) 399-0112

USER NAME = \$USER#	DESIGNED -	REVISED -
PLOT DRIVER = \$PLT#	DRAWN -	REVISED -
PEN TABLE = \$PEN#	CHECKED -	REVISED -
PLOT SCALE = \$SCALE#	DATE - 03/27/18	REVISED -

STATE OF ILLINOIS
DEPARTMENT OF TRANSPORTATION

GUARDRAIL END SECTION REPLACEMENT			
047-0006 (LOCATION 7)			
SCALE: 1"=40'	SHEET 5	OF 5 SHEETS	STA. TO STA.

F.A.-RTE.	SECTION	COUNTY	TOTAL SHEETS	SHEET NO.
VAR.	D3-J REPLACEMENT 2018	VARIOUS	32	19
CONTRACT NO. 66H68				
ILLINOIS FED. AID PROJECT				

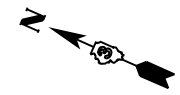

EXIST. CURVE LOC*10-1
 PI STA. = 100+30.81
 $\Delta = 4^{\circ} 10' 41''$ (LT)
 $D = 1^{\circ} 38' 20''$
 $R = 3,495.76'$
 $T = 127.51'$
 $L = 254.91'$
 $E = 2.32'$
 $e = \text{-----}$
 $T.R. = \text{-----}$
 $S.E. RUN = \text{-----}$
 P.C. STA. = 99+03.30
 P.T. STA. = 101+58.21

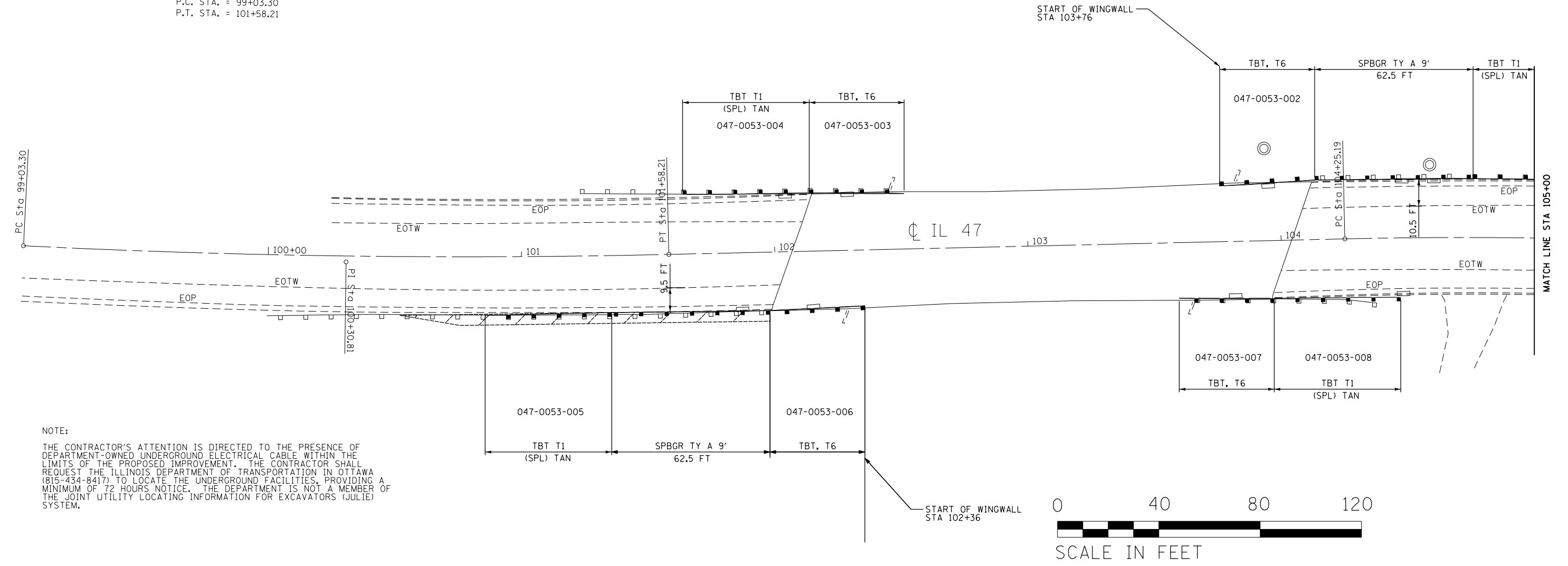

NOTE:

THE CONTRACTOR'S ATTENTION IS DIRECTED TO THE PRESENCE OF DEPARTMENT-OWNED UNDERGROUND ELECTRICAL CABLE WITHIN THE LIMITS OF THE PROPOSED IMPROVEMENT. THE CONTRACTOR SHALL REQUEST THE ILLINOIS DEPARTMENT OF TRANSPORTATION IN OTTAWA (815-434-8417) TO LOCATE THE UNDERGROUND FACILITIES, PROVIDING A MINIMUM OF 72 HOURS NOTICE. THE DEPARTMENT IS NOT A MEMBER OF THE JOINT UTILITY LOCATING INFORMATION FOR EXCAVATORS (JULIE) SYSTEM.



X:\WORK\2017\201706-30\CAD\Transportation\dgm\CAD_Shts\0366H68-sht-Location*10-1.dgn 4/22/2018 3:54:04 PM

	USER NAME = 1908	DESIGNED -	REVISED -	STATE OF ILLINOIS DEPARTMENT OF TRANSPORTATION	GUARDRAIL END SECTION REPLACEMENT 047-0053 (LOCATION 10)			F.A.- RTE.	SECTION	COUNTY	TOTAL SHEETS	SHEET NO.
	PLOT DRIVER = pdfNOLAYERSbw.pltcf	DRAWN -	REVISED -		SCALE: 1"=40'	SHEET 1	OF 2	SHEETS	STA.	TO STA.	VAR. D3-J REPLACEMENT 2018	VARIOUS
	PEN TABLE = 20173006-30.tbl	CHECKED -	REVISED -					ILLINOIS FED. AID PROJECT		CONTRACT NO. 66H68		
	PLOT SCALE = 480.0000' / ft.	DATE = 03/27/18	REVISED -									



EXIST. CURVE LOC#10-2
 PI STA. = 105+68.32
 $\Delta = 8^{\circ} 08' 21''$ (RT)
 $D = 2^{\circ} 50' 53''$
 $R = 2,011.70'$
 $T = 143.13'$
 $L = 285.77'$
 $E = 5.09'$
 $e = \text{-----}$
 $T.R. = \text{-----}$
 $S.E. \text{ RUN} = \text{-----}$
 $P.C. \text{ STA.} = 104+25.19$
 $P.T. \text{ STA.} = 107+10.97$

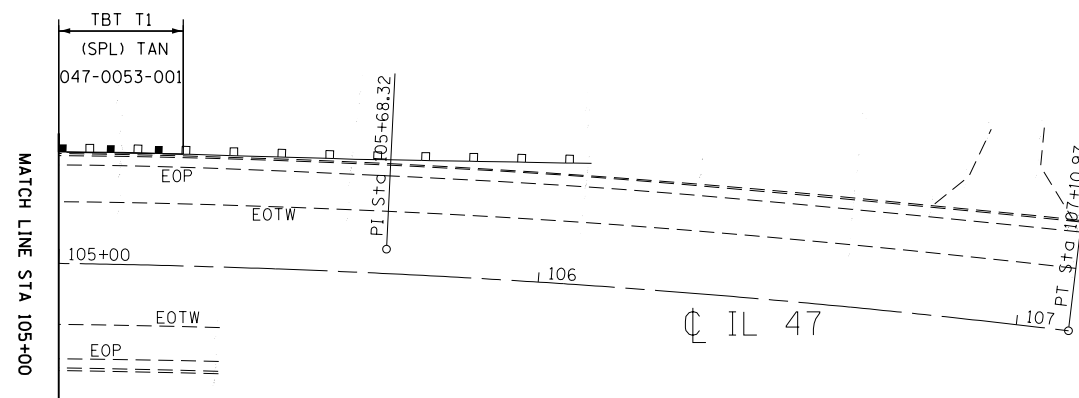

NOTE:

THE CONTRACTOR'S ATTENTION IS DIRECTED TO THE PRESENCE OF DEPARTMENT-OWNED UNDERGROUND ELECTRICAL CABLE WITHIN THE LIMITS OF THE PROPOSED IMPROVEMENT. THE CONTRACTOR SHALL REQUEST THE ILLINOIS DEPARTMENT OF TRANSPORTATION IN OTTAWA (815-434-8417) TO LOCATE THE UNDERGROUND FACILITIES, PROVIDING A MINIMUM OF 72 HOURS NOTICE. THE DEPARTMENT IS NOT A MEMBER OF THE JOINT UTILITY LOCATING INFORMATION FOR EXCAVATORS (JULIE) SYSTEM.



X:\04\2017\201706-30\CAD\Transportation\dgm\5hrs\0366468-shr-Location#10-2.dgn 4/22/2018 3:34:53 PM

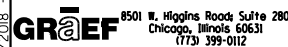

USER NAME = 1908	DESIGNED -	REVISED -
PLOT DRIVER = pdfNQLAYERSbw.pltcf	DRAWN -	REVISED -
PEN TABLE = 20173006-30.tbl	CHECKED -	REVISED -
PLOT SCALE = 480.0000' / ft.	DATE - 03/27/18	REVISED -

**STATE OF ILLINOIS
 DEPARTMENT OF TRANSPORTATION**

**GUARDRAIL END SECTION REPLACEMENT
 047-0053 (LOCATION 10)**

SCALE: 1"=40' SHEET 2 OF 2 SHEETS STA. TO STA.

F.A. - RTE.	SECTION	COUNTY	TOTAL SHEETS	SHEET NO.
VAR.	D3-J REPLACEMENT 2018	VARIOUS	32	21
			CONTRACT NO. 66H68	
ILLINOIS FED. AID PROJECT				

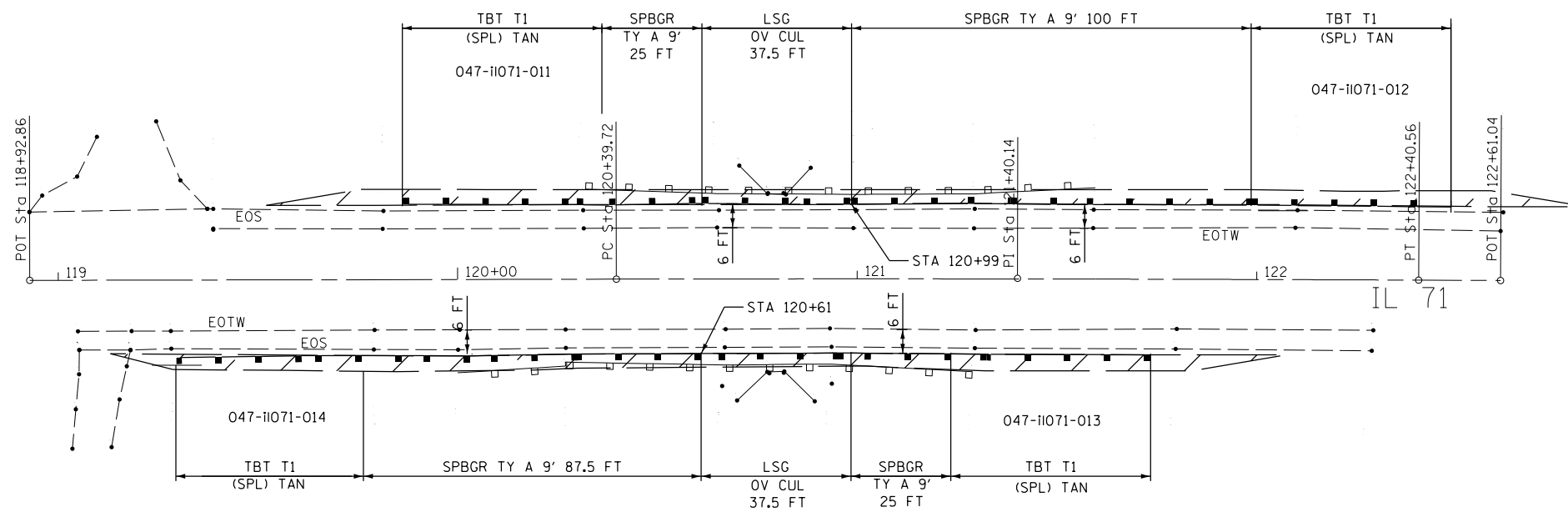
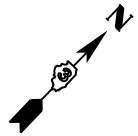

FILES 7/3/2018

GRAEF 8501 N. Higgins Road, Suite 280
Chicago, Illinois 60631
(773) 399-0112

USER NAME = ferguson	DESIGNED -	REVISED -
PLOT DRIVER = \$PLT\$	DRAWN -	REVISED -
PEN TABLE = \$PEN\$	CHECKED -	REVISED -
PLOT SCALE = 40.0499' / in.	DATE - 03/27/18	REVISED -

**STATE OF ILLINOIS
DEPARTMENT OF TRANSPORTATION**

**GUARDRAIL END SECTION REPLACEMENT
047-II071 (LOCATION 12)**

SCALE: 1"=40' SHEET OF SHEETS STA. TO STA.

F.A.-- RTE.	SECTION	COUNTY	TOTAL SHEETS	SHEET NO.
VAR.	D3-J REPLACEMENT 2018	VARIOUS	32	22
CONTRACT NO. 66H68				
ILLINOIS FED. AID PROJECT				

PI STA. = 140+71.73
 Δ = 3° 02' 17" (LT)
 D = 0° 51' 16"
 R = 6,705.33'
 T = 177.81'
 L = 355.53'
 E = 2.36'
 P.C. STA. = 138+93.93
 P.T. STA. = 142+49.46

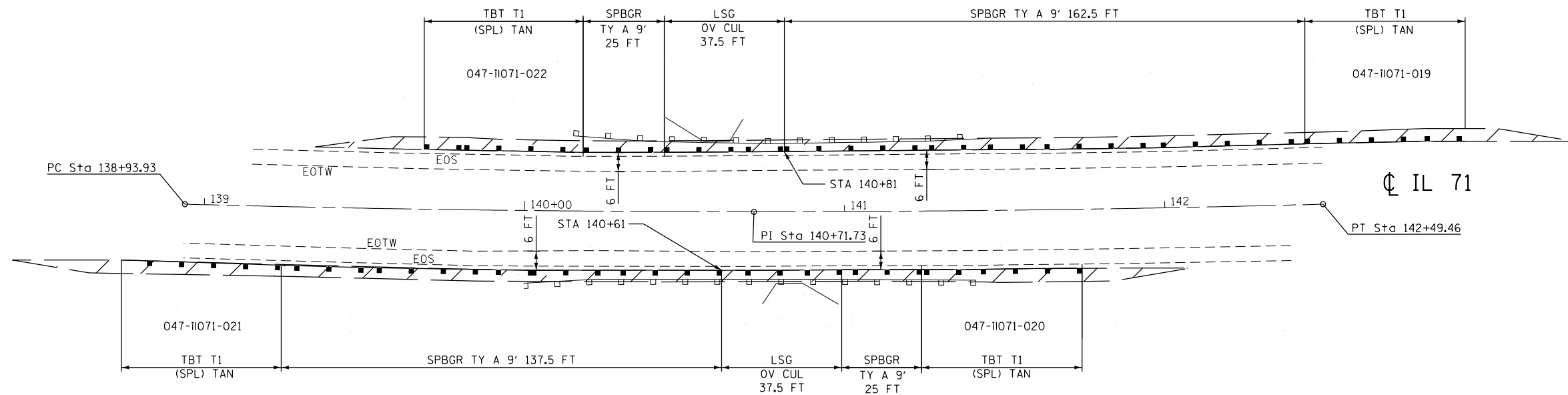
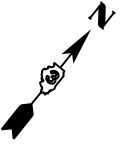

X:\04\2017\07\06-30\CAD\Transportation\dgm\CAD_Shts\0366H68-sht-Location#14.dgn
 4/22/2018 - 3:54:07 PM

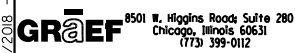

USER NAME = 1908	DESIGNED -	REVISED -
PLOT DRIVER = pdfNQLAYERSbw.pltcf	DRAWN -	REVISED -
PEN TABLE = 20173006-30.tbl	CHECKED -	REVISED -
PLOT SCALE = 480.0000' / ft.	DATE - 03/27/18	REVISED -

**STATE OF ILLINOIS
 DEPARTMENT OF TRANSPORTATION**

GUARDRAIL END SECTION REPLACEMENT 047-ii071 (LOCATION 14)			
SCALE: 1"=40'	SHEET	OF	SHEETS
	STA.	TO	STA.

F.A. - RTE.	SECTION	COUNTY	TOTAL SHEETS	SHEET NO.
VAR.	D3-J REPLACEMENT 2018	VARIOUS	32	23
CONTRACT NO. 66H68			ILLINOIS FED. AID PROJECT	

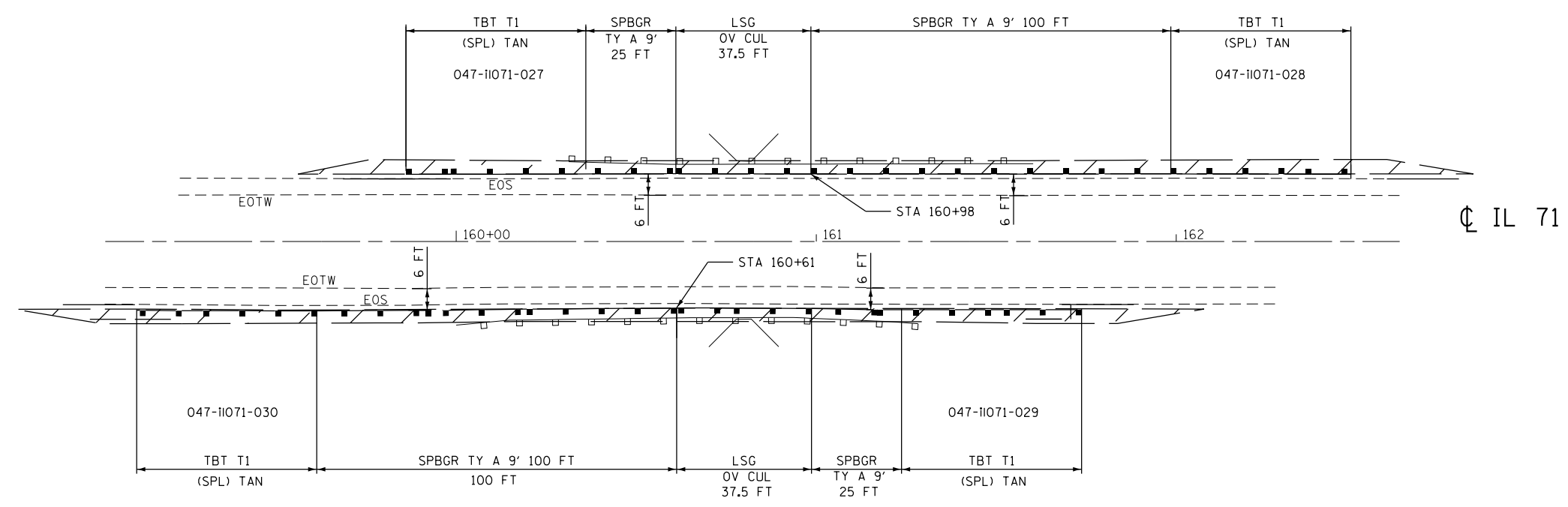
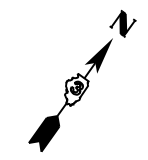

CL IL 71



X:\04\2017\201706-30\CAD\Transportation\dgm\CAD_Shts\D366H68-sht-Location#16.dgn 4/22/2018 3:34:08 PM

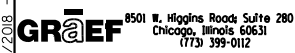

USER NAME = 1908	DESIGNED -	REVISED -
PLOT DRIVER = pdfNOLAYERSbw.pltcf	DRAWN -	REVISED -
PEN TABLE = 20173006-30.tbl	CHECKED -	REVISED -
PLOT SCALE = 480.0000' / ft.	DATE - 03/27/18	REVISED -

**STATE OF ILLINOIS
DEPARTMENT OF TRANSPORTATION**

GUARDRAIL END SECTION REPLACEMENT			
047-11071 (LOCATION 16)			
SCALE: 1"=40'	SHEET	OF	SHEETS
	STA.	TO	STA.

F.A. - RTE.	SECTION	COUNTY	TOTAL SHEETS	SHEET NO.
VAR.	D3-J REPLACEMENT 2018	VARIOUS	32	24
CONTRACT NO. 66H68				
ILLINOIS FED. AID PROJECT				

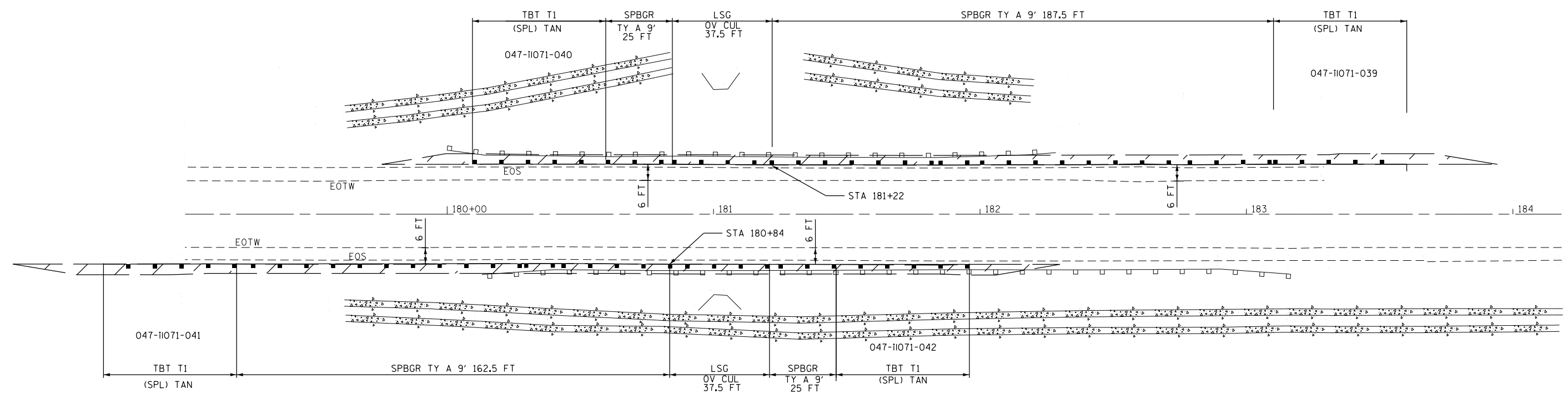
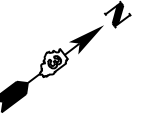

IL 71

X:\04\2017\07\006-30\CAD\Transportation\dgm\CAD_Shts\0366H68-sht-Location#18.dgn
 4/22/2018 3:35:40 PM



USER NAME = 1908	DESIGNED -	REVISED -
PLOT DRIVER = pdfNOLAYERSbw.pltcf	DRAWN -	REVISED -
PEN TABLE = 20173006-30.tbl	CHECKED -	REVISED -
PLOT SCALE = 480.0000' / ft.	DATE - 03/27/18	REVISED -

STATE OF ILLINOIS
DEPARTMENT OF TRANSPORTATION

GUARDRAIL END SECTION REPLACEMENT 047-11071 (LOCATION 18)			
SCALE: 1"=40'	SHEET	OF SHEETS	STA. TO STA.

F.A.-RTE.	SECTION	COUNTY	TOTAL SHEETS	SHEET NO.
VAR.	D3-J REPLACEMENT 2018	VARIOUS	32	25
ILLINOIS FED. AID PROJECT CONTRACT NO. 66H68				

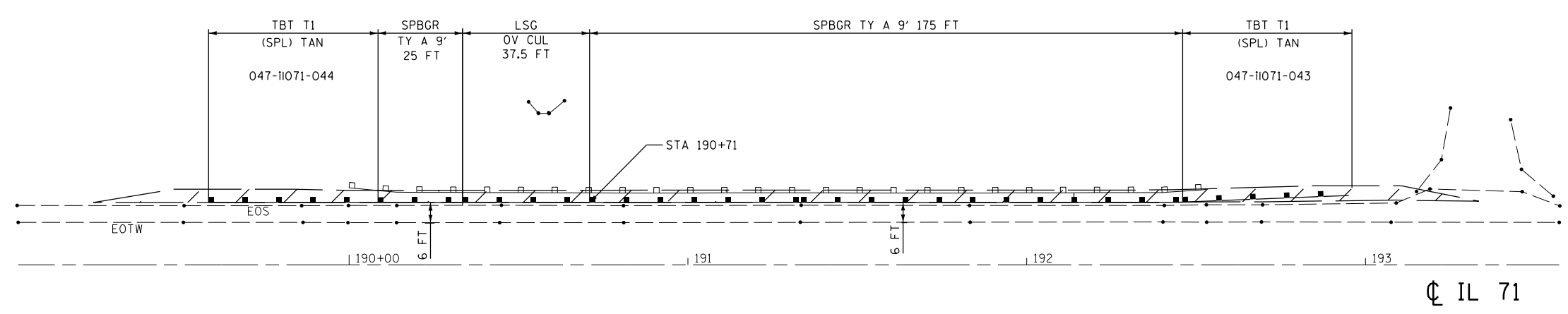
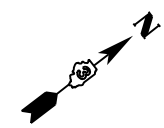

GRAEF 8501 W. Higgins Road, Suite 280
Chicago, Illinois 60631
(773) 399-0112

USER NAME = fergusonso	DESIGNED -	REVISED -
PLOT DRIVER = \$PLT\$	DRAWN -	REVISED -
PEN TABLE = \$PEN\$	CHECKED -	REVISED -
PLOT SCALE = 40.0130' / in.	DATE - 03/27/18	REVISED -

**STATE OF ILLINOIS
DEPARTMENT OF TRANSPORTATION**

**GUARDRAIL END SECTION REPLACEMENT
047-i1071 (LOCATION 19)**

SCALE: 1"=40' SHEET OF SHEETS STA. TO STA.

F.A. -- RTE.	SECTION	COUNTY	TOTAL SHEETS	SHEET NO.
VAR.	D3-J REPLACEMENT 2018	VARIOUS	32	26
CONTRACT NO. 66H68			ILLINOIS FED. AID PROJECT	

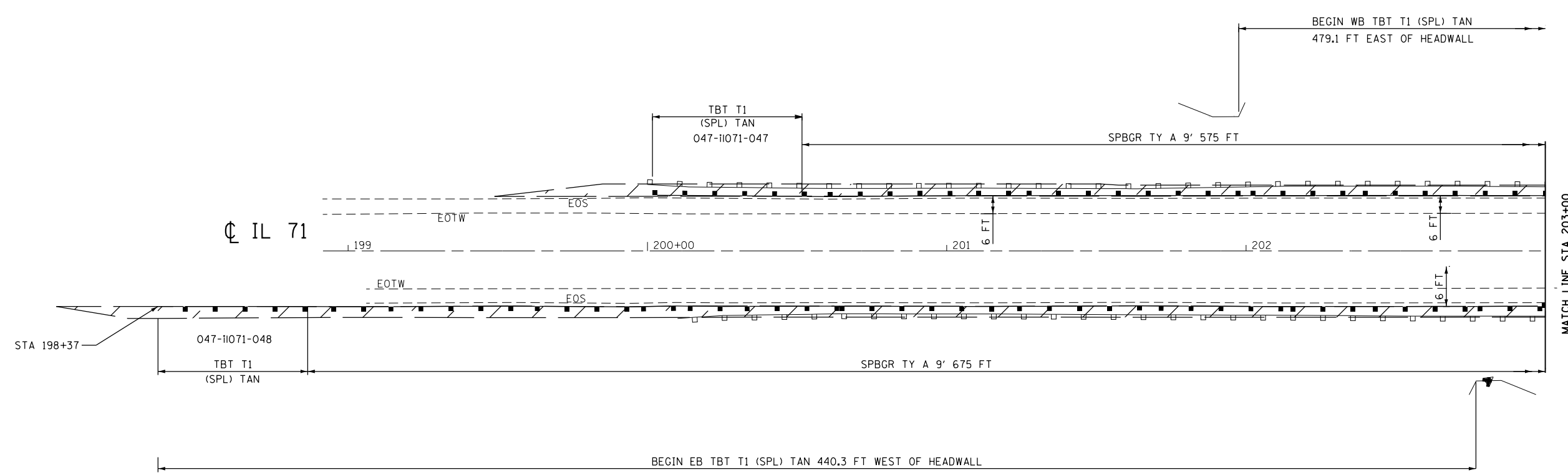
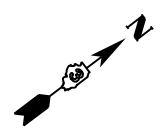

X:\04\2017\2017006-30\CAD\Transportation\dgm\CAD_Shts\D366H68-sht-Location#20-.dgn 4/22/2018 3:34:42 PM



USER NAME = 1908	DESIGNED -	REVISED -
PLOT DRIVER = pdfNQLAYERSbw.pltcf	DRAWN -	REVISED -
PEN TABLE = 20173006-30.tbl	CHECKED -	REVISED -
PLOT SCALE = 480.0000' / ft.	DATE - 03/27/18	REVISED -

**STATE OF ILLINOIS
DEPARTMENT OF TRANSPORTATION**

GUARDRAIL END SECTION REPLACEMENT			
047-11071 (LOCATION 20)			
SCALE: 1"=40'	SHEET 1	OF 2 SHEETS	STA. TO STA.

F.A. - RTE.	SECTION	COUNTY	TOTAL SHEETS	SHEET NO.
VAR.	D3-J REPLACEMENT 2018	VARIOUS	32	27
CONTRACT NO. 66H68				
ILLINOIS FED. AID PROJECT				

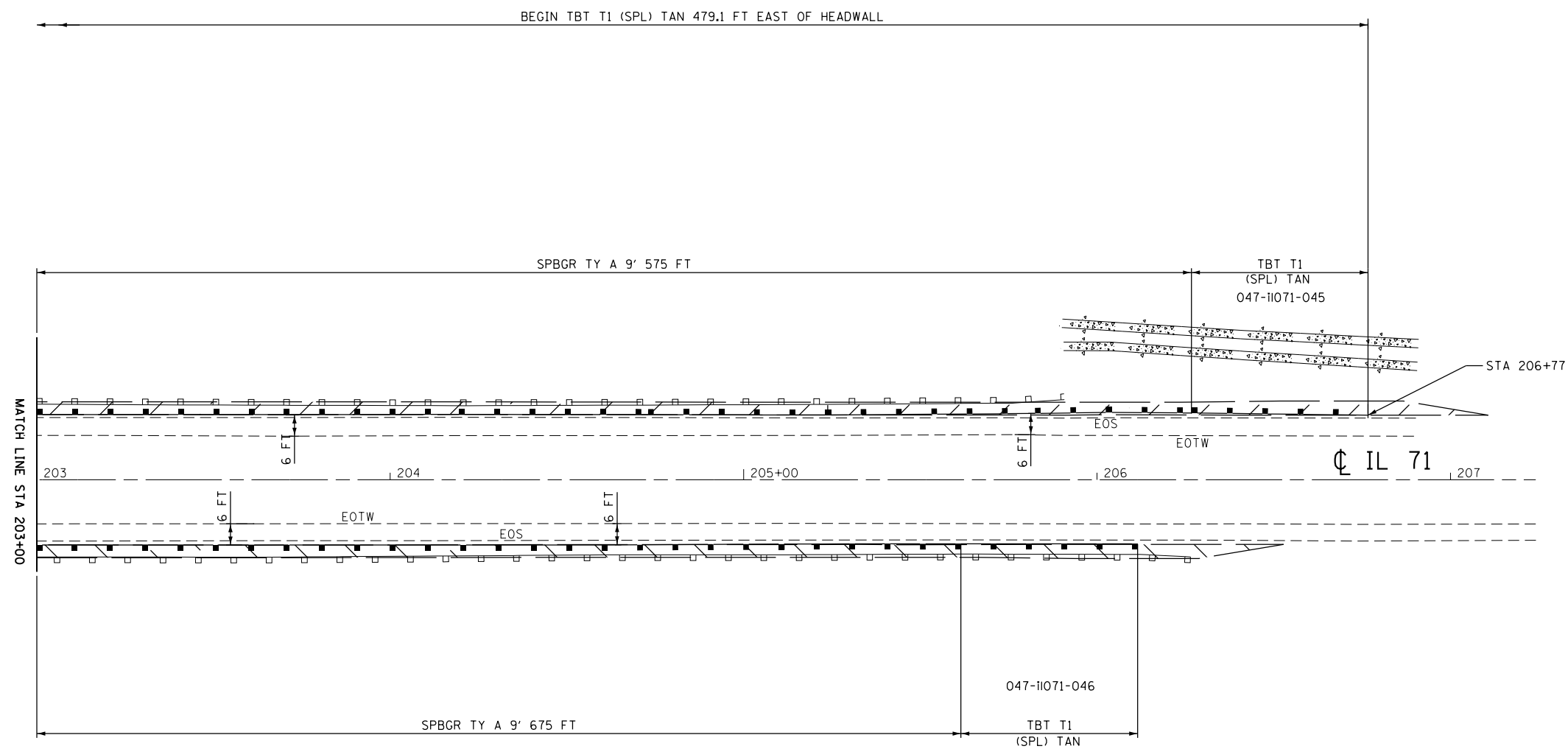
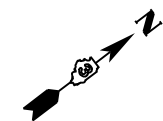

X:\04\2017\07\06-30\CAD\Transportation\dgn\CAD_Shts\0366H68-sht-Location#20-2.dgn
4/22/2018 3:34:13 PM

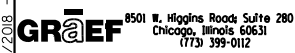

USER NAME = 1908	DESIGNED -	REVISED -
PLOT DRIVER = pdfNOLAYERSbw.pltcfp	DRAWN -	REVISED -
PEN TABLE = 20173006-30.tbl	CHECKED -	REVISED -
PLOT SCALE = 480.0000' / ft.	DATE - 03/27/18	REVISED -

**STATE OF ILLINOIS
DEPARTMENT OF TRANSPORTATION**

GUARDRAIL END SECTION REPLACEMENT 047-11071 (LOCATION 20)			
SCALE: 1"=40'	SHEET 2	OF 2 SHEETS	STA. TO STA.

F.A. - RTE.	SECTION	COUNTY	TOTAL SHEETS	SHEET NO.
VAR.	D3-J REPLACEMENT 2018	VARIOUS	32	28
CONTRACT NO. 66H68			ILLINOIS FED. AID PROJECT	

PI STA. = 211+55.06
 Δ = 3° 15' 03" (RT)
 D = 0° 22' 18"
 R = 15,413.04'
 T = 437.35'
 L = 874.47'
 E = 6.20'
 P.C. STA. = 207+17.71
 P.T. STA. = 215+92.18

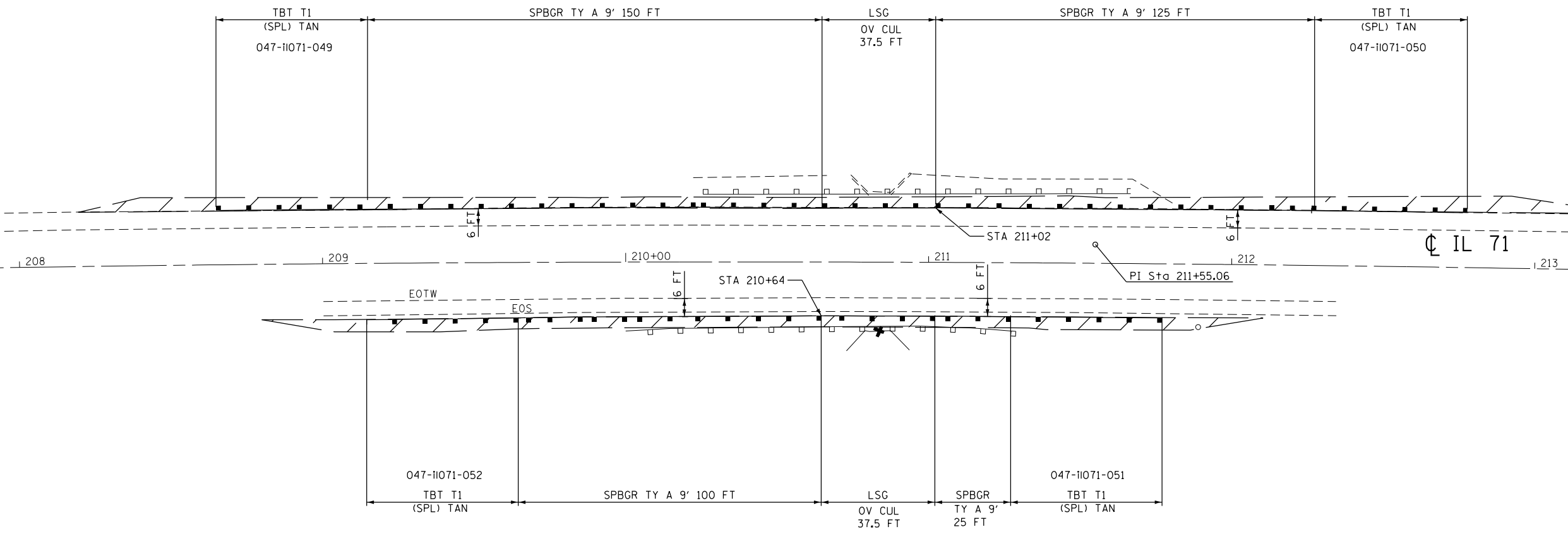

X:\04\2017\20173006-30\CAD\Transportation\CAD_Shts\0366H68-sht-Location#2.dgn
 5/10/2018 4:43:50 PM



USER NAME = 1908	DESIGNED -	REVISED -
PLOT DRIVER = pdfNQLAYERSbw.pltcfp	DRAWN -	REVISED -
PEN TABLE = 20173006-30.tbl	CHECKED -	REVISED -
PLOT SCALE = 480.0000' / ft.	DATE - 03/27/18	REVISED -

STATE OF ILLINOIS
DEPARTMENT OF TRANSPORTATION

GUARDRAIL END SECTION REPLACEMENT 047-11071 (LOCATION 21)			
SCALE: 1"=40'	SHEET	OF	SHEETS
	STA.	TO	STA.

F.A. - RTE.	SECTION	COUNTY	TOTAL SHEETS	SHEET NO.
VAR.	D3-J REPLACEMENT 2018	VARIOUS	32	29
CONTRACT NO. 66H68				
ILLINOIS FED. AID PROJECT				

PI STA. = 230+70.01
 Δ = 5° 41' 39" (LT)
 D = 1° 37' 02"
 R = 3,543.00'
 T = 176.20'
 L = 352.11'
 E = 4.38'
 P.C. STA. = 228+93.80
 P.T. STA. = 232+45.92

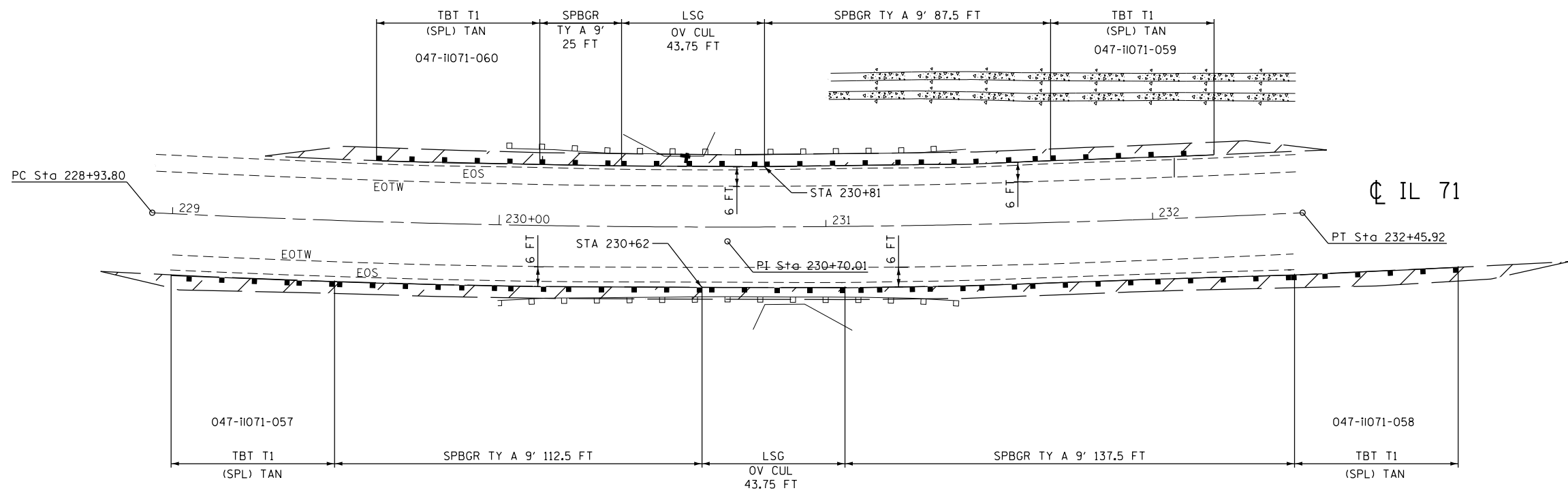
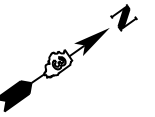

X:\04\2017\2017006-30\CAD\Transportation\CAD_Shts\0366H68-sht-Location#23.dgn
 4/22/2018 3:34:45 PM

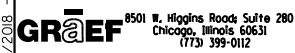

USER NAME = 1908	DESIGNED -	REVISED -
PLOT DRIVER = pdfNQLAYERSbw.pltcf	DRAWN -	REVISED -
PEN TABLE = 20173006-30.tbl	CHECKED -	REVISED -
PLOT SCALE = 480.0000' / ft.	DATE - 03/27/18	REVISED -

**STATE OF ILLINOIS
 DEPARTMENT OF TRANSPORTATION**

GUARDRAIL END SECTION REPLACEMENT 047-11071 (LOCATION 23)			
SCALE: 1"=40'	SHEET	OF	SHEETS
	STA.		TO STA.

F.A. - RTE.	SECTION	COUNTY	TOTAL SHEETS	SHEET NO.
VAR. D3-J REPLACEMENT 2018			32	30
CONTRACT NO. 66H68				
<small>ILLINOIS FED. AID PROJECT</small>				

PI STA. = 240+78.24
 $\Delta = 2^\circ 23' 54''$ (RT)
 $D = 0^\circ 40' 49''$
 $R = 8,423.05'$
 $T = 176.31'$
 $L = 352.57'$
 $E = 1.85'$
 P.C. STA. = 239+01.93
 P.T. STA. = 242+54.50

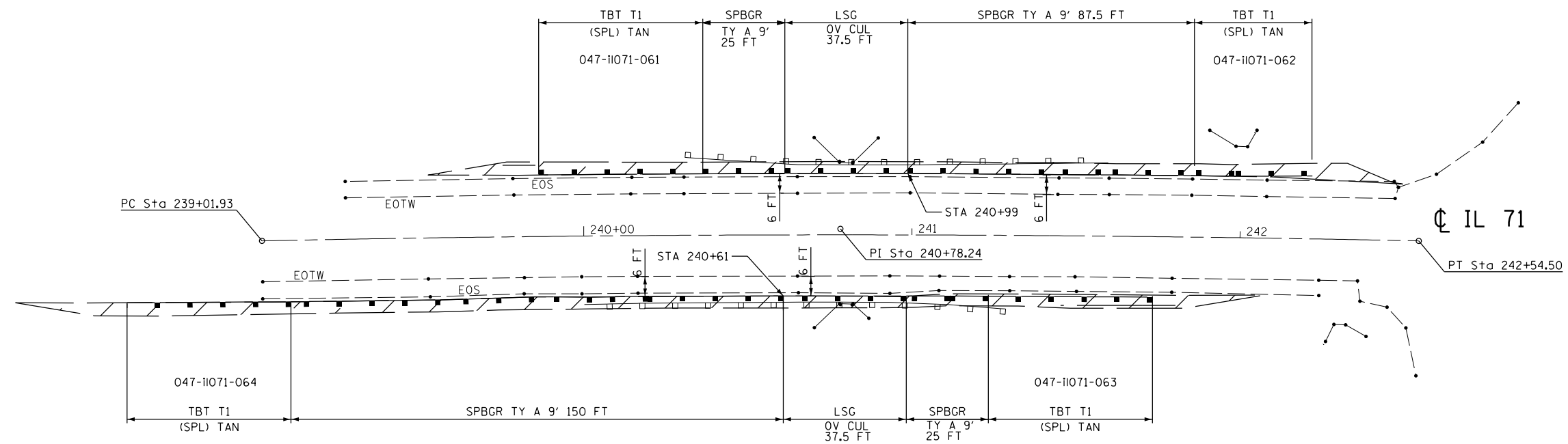

FILE# 7/5/2018

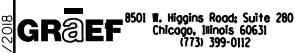

USER NAME = ferguson	DESIGNED -	REVISED -
PLOT DRIVER = #PLTs	DRAWN -	REVISED -
PEN TABLE = #PEN#	CHECKED -	REVISED -
PLOT SCALE = 40.0000' / in.	DATE - 03/27/18	REVISED -

STATE OF ILLINOIS
DEPARTMENT OF TRANSPORTATION

GUARDRAIL END SECTION REPLACEMENT			
047-11071 (LOCATION 24)			
SCALE: 1"=40'	SHEET	OF	SHEETS
	STA.		TO STA.

F.A.-RTE.	SECTION	COUNTY	TOTAL SHEETS	SHEET NO.
VAR.	D3-J REPLACEMENT 2018	VARIOUS	32	31
CONTRACT NO. 66H68				
ILLINOIS FED. AID PROJECT				

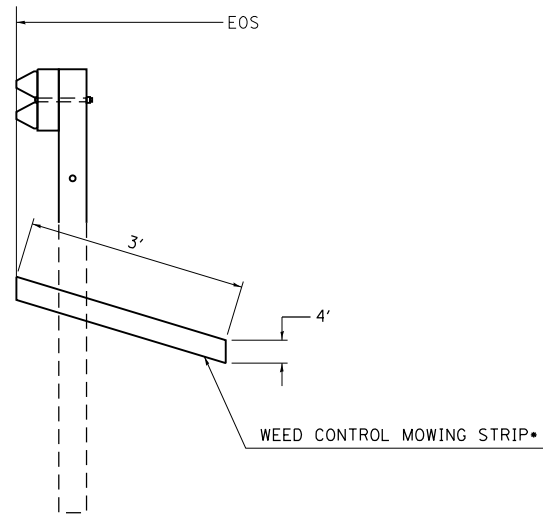

• PLACE WEED CONTROL MOWING STRIP UNDER ALL PROPOSED GUARDRAIL AND SECTIONS. TAPER WEED CONTROL MOWING STRIP AT THE SAME RATE AS THE TBT, TYPE I (SP) SO THAT WEED CONTROL MOWING STRIP IS BEHIND GUARDRAIL AT ALL TIMES.

WEED CONTROL MOWING STRIP (SPECIAL)

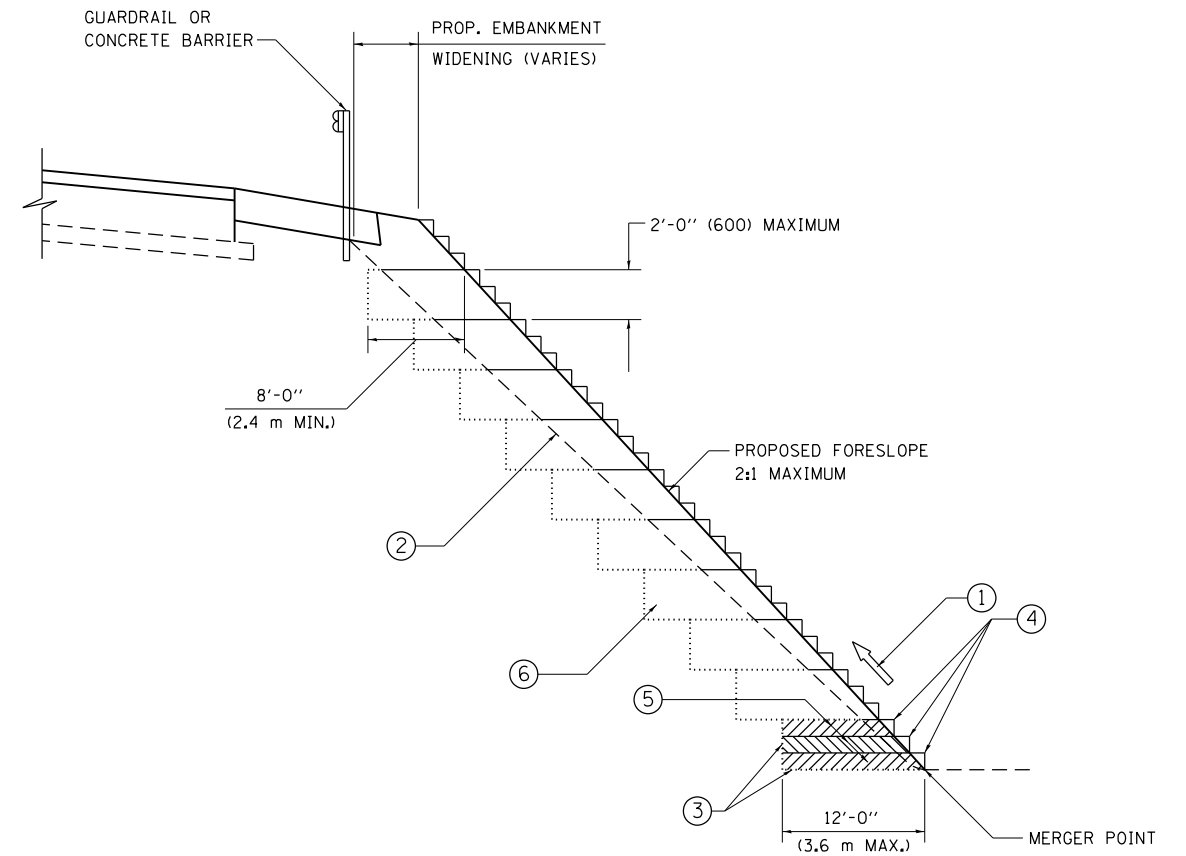

TYPICAL BENCHING DETAIL FOR EMBANKMENT

NOTES:

- ① CONSTRUCT SUCCEEDING BENCH CUTS AND EMBANKMENT PLACEMENT AND COMPACTION FROM BOTTOM TO TOP IN STAIRSTEP FASHION.
- ② EXISTING FORESLOPE PREPARED IN ACCORDANCE WITH ARTICLE 205.03 OF THE STANDARD SPECIFICATIONS.
- ③ BENCH CUT EXISTING SLOPE TYPICAL FOR EACH STEP.
- ④ TRIM TO FINAL SLOPE.
- ⑤ EQUAL 8-INCH (200) LIFTS OF EMBANKMENT COMPACTED IN ACCORDANCE WITH ARTICLE 205.05 OF THE STANDARD SPECIFICATIONS.
- ⑥ EXCAVATION OF BENCH CUTS WITHIN EXISTING EMBANKMENT WILL BE INCLUDED IN THE COST OF FURNISHED EXCAVATION. THIS WORK WILL INCLUDE ALL LABOR AND MATERIAL, NO ADDITIONAL COMPENSATION WILL BE ALLOWED.
- ⑦ SLOPES SHALL BE BENCHED ACCORDING TO THIS DETAIL WHEN THE SLOPE IS STEEPER THAN 1:4 AND THE HEIGHT IS GREATER THAN 5' (1.5 m).

ALL DIMENSIONS ARE IN INCHES (MILLIMETERS) UNLESS OTHERWISE SHOWN.

X:\04\2017\2017006-30\CAD\Transportation\dgm\CAD_Shts\0366468-sht-Derrollis.dgn 4/22/2018 - 3:54:17 PM

GR&EF 8501 W. Higgins Road, Suite 280
Chicago, Illinois 60631
(773) 399-0112

USER NAME = 1908	DESIGNED -	REVISED -
PLOT DRIVER = pdfNQLAYERSbw.pltcfq	DRAWN -	REVISED -
PEN TABLE = 20173006-30.tbl	CHECKED -	REVISED -
PLOT SCALE = 24.0000' / ft.	DATE - 03/27/18	REVISED -

**STATE OF ILLINOIS
DEPARTMENT OF TRANSPORTATION**

**GUARDRAIL END SECTION REPLACEMENT
BENCHING DETAIL FOR EMBANKMENT WIDENING**

SCALE: #5/8"=1'-0" SHEET #D35 OF #D035 SHEETS STA. TO STA.

F.A.-RTE.	SECTION	COUNTY	TOTAL SHEETS	SHEET NO.
VAR.	D3-J REPLACEMENT 2018	VARIOUS	32	32
BD-51			CONTRACT NO. 66H68	
ILLINOIS FED. AID PROJECT				