

FOR INDEX OF SHEETS SEE SHEET 2

ROUTE	SECTION	COUNTY	TOTAL SHEETS	SHEET NUMBER
FAP 326	2006-014 CRC-PP	KANE	17	1

IMPROVEMENT IS LOCATED IN THE VILLAGE OF SUGAR GROVE

STATE OF ILLINOIS  
DEPARTMENT OF TRANSPORTATION  
DIVISION OF HIGHWAYS  
DISTRICT ONE  
**PROPOSED HIGHWAY PLANS**

CONTRACT 60B38  
D-91-328-06

**TRAFFIC DATA:**

IL 47:  
GALENA BLVD TO BLISS RD  
SPEED LIMIT = 45 MPH  
2002 ADT = 19,700

BLISS RD. TO SEAVEY RD  
SPEED LIMIT = 55 MPH  
2002 ADT = 14,000

FAP ROUTE 326: IL 47  
GALENA BLVD. TO SOUTH OF I-88  
SECTION: 2006-014 CRC-PP  
BITUMINOUS CLASS D PATCHING OF CRC PAVEMENT  
KANE COUNTY  
C-91-328-06

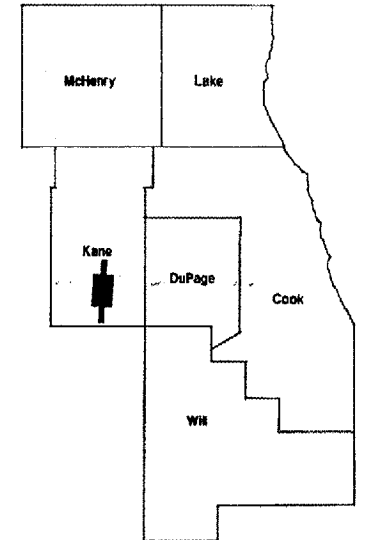

LOCATION OF IMPROVEMENT INDICATED THUS:

NORTHBOUND IMPROVEMENT  
ENDS STA. 212+91 = CL SEAVEY

SOUTHBOUND IMPROVEMENT  
BEGINS STA 0+00 = CL SEAVEY RD

**OMISSIONS: NORTHBOUND**  
STA. 134+79 TO STA. 212+91  
**OMISSIONS: SOUTHBOUND**  
STA. 0+00 TO STA. 78+29

**OMISSION NORTHBOUND:**  
STA 0+00 TO STA. 35+62  
**OMISSION SOUTHBOUND:**  
STA 207+48 TO STA. 213+54

SOUTHBOUND IMPROVEMENT  
ENDS STA. 213+54 = CL GALENA

NORTHBOUND IMPROVEMENT  
BEGINS STA 0+00 = CL GALENA BLVD

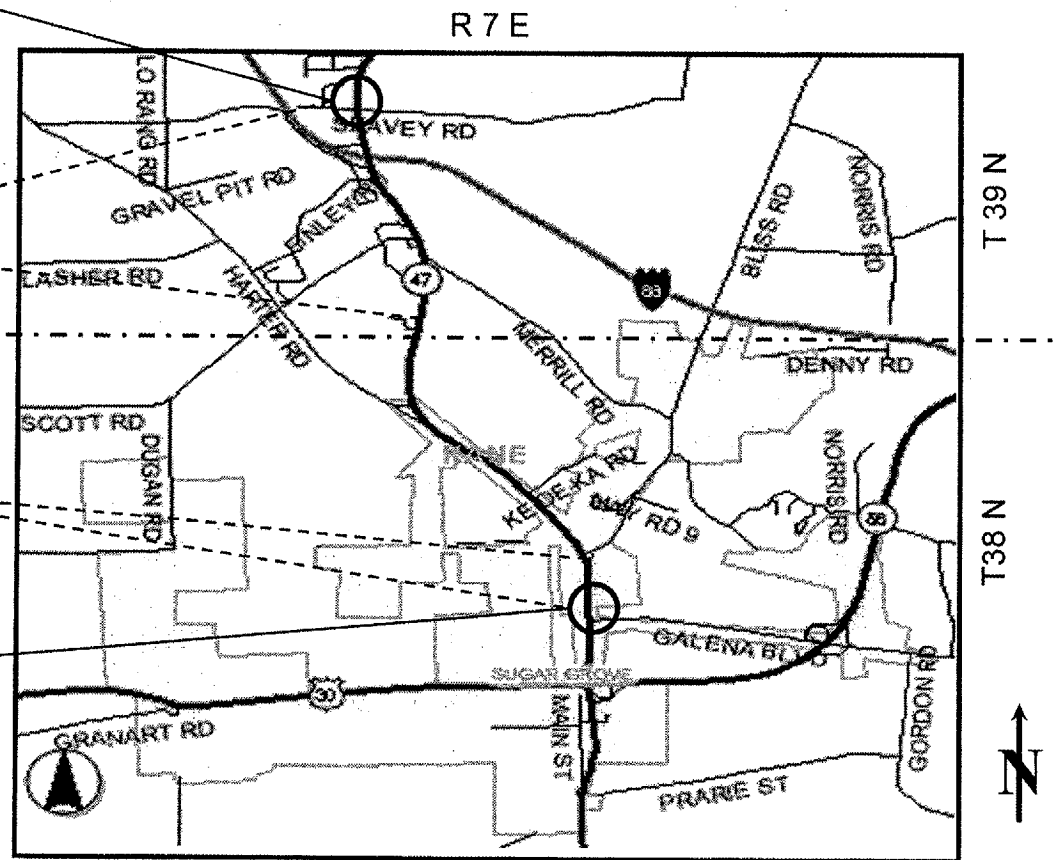

SUGAR GROVE TOWNSHIP

GROSS LENGTH OF IMPROVEMENT = 21,255 FEET = 4.03 MILES  
NET LENGTH OF IMPROVEMENT = 13,101 FEET = 2.48 MILES

STATE OF ILLINOIS  
DEPARTMENT OF TRANSPORTATION  
DIVISION OF HIGHWAYS  
SUBMITTED: *July 6, 2006*  
*Diane M. O'Keefe*  
DEPUTY DIRECTOR OF HIGHWAYS, REGION ENGINEER  
*August 18, 2006*  
*Mike Stone*  
ENGINEER OF DESIGN AND ENVIRONMENT  
*August 18, 2006*  
*Milton R. Sees, P.E.*  
DIRECTOR, DIVISION OF HIGHWAYS

PRINTED BY THE AUTHORITY  
OF THE STATE OF ILLINOIS

J.U.L.I.E.: JOINT UTILITY LOCATION  
INFORMATION FOR EXCAVATION  
(800) 892-0123

DISTRICT ONE - DESIGN - PLAN PREPARATION ENGINEER:  
KEN ENG / ROBERT BORO (847) 705-4178

CONTRACT 60B38

ROUTE	SECTION	COUNTY	TOTAL SHEETS	SHEET NUMBER
FAP 326	2006-014 CRC-PP	KANE	17	2

CONTRACT NO. 60B38

**INDEX OF SHEETS**

**STATE STANDARDS**

<u>SHEET NO.</u>	<u>DESCRIPTION</u>	<u>STANDARDS</u>	<u>DESCRIPTION</u>
1	TITLE SHEET	442201-01	CLASS D PATCHES
2	INDEX OF SHEETS STATE STANDARDS	701422-01	LANE CLOSURE, MULTILANE, FOR SPEEDS $\geq$ 45 MPH TO 55 MPH
3	GENERAL NOTES	701426-02	LANE CLOSURE, MULTILANE, INTERMITTENT OR MOVING OPERATION, FOR SPEEDS $\geq$ 45 MPH
4	SUMMARY OF QUANTITIES	701701-04	URBAN LANE CLOSURE, MULTILANE INTERSECTION
5-6	TYPICAL CROSS SECTIONS	702001-06	TRAFFIC CONTROL DEVICES
7-10	PATCHING SCHEDULES	780001-01	TYPICAL PAVEMENT MARKINGS
11	DISTRICT ONE TYPICAL PAVEMENT MARKINGS		
12	TRAFFIC CONTROL AND PROTECTION FOR SIDE ROADS, INTERSECTIONS AND DRIVEWAYS		
13	TYPICAL APPLICATIONS RAISED REFLECTIVE PAVEMENT MARKERS (SNOW-PLOW RESISTANT)		
14	TRAFFIC CONTROL AND PROTECTION AT TURN BAYS (TO REMAIN OPEN TO TRAFFIC)		
15-17	EXISTING TRAFFIC SIGNAL LOOP DETECTOR PLANS		

ILLINOIS DEPARTMENT OF TRANSPORTATION

INDEX OF SHEETS  
STATE STANDARDS

ROUTE	SECTION	COUNTY	TOTAL SHEETS	SHEET NUMBER
FAP 326	2006-014 CRC-PP	KANE	17	3

**GENERAL NOTES**

**CONTRACT NO. 60B38**

BEFORE STARTING ANY EXCAVATION, THE CONTRACTOR SHALL CALL J.U.L.I.E. AT 800-892-0123 FOR FIELD LOCATIONS OF BURIED ELECTRIC, TELEPHONE AND GAS UTILITIES (48 HOURS NOTIFICATION IS REQUIRED).

THE CONTRACTOR WILL NOT BE ALLOWED TO SET UP A YARD OR FIELD OFFICE ON STATE PROPERTY WITHOUT WRITTEN PERMISSION FROM THE DEPARTMENT.

IT SHALL BE THE CONTRACTOR'S RESPONSIBILITY TO VERIFY ALL DIMENSIONS AND CONDITIONS EXISTING IN THE FIELD PRIOR TO CONSTRUCTION AND ORDERING OF MATERIALS.

THE CONTRACTOR SHALL CONTACT THE DISTRICT ONE TRAFFIC CONTROL SUPERVISOR AT (847) 705-4470 A MINIMUM OF 72 HOURS IN ADVANCE OF BEGINNING WORK.

THE CONTRACTOR SHALL BE REQUIRED TO PROVIDE ACCESS TO ABUTTING PROPERTY AT ALL TIMES DURING THE CONSTRUCTION OF THIS PROJECT.

DO NOT SCALE PLANS FOR CONSTRUCTION DIMENSIONS.

THE CONTRACTOR SHALL COORDINATE CONSTRUCTION ACTIVITIES WITH UTILITY COMPANIES.

BEFORE BEGINNING WORK, THE CONTRACTOR SHALL RETAIN AND RECORD (FOR FUTURE REFERENCE), ALL EXISTING PAVEMENT MARKING LINES AND RAISED REFLECTIVE PAVEMENT MARKERS IN ORDER THAT THESE LOCATIONS CAN BE RE-ESTABLISHED FOR STRIPING. EXACT LOCATIONS OF ALL STRIPING SHALL BE AS DIRECTED BY THE ENGINEER.

THESE PLANS HAVE BEEN PREPARED FROM NOTES RECEIVED FROM FIELD MAINTENANCE ENGINEERS.

THE ENGINEER SHALL CONTACT RICHARD TOLLEFSON AT THE ST. CHARLES MAINTENANCE YARD, (630) 584-4360, REGARDING PATCHING LOCATIONS.

THE ENGINEER SHALL OBTAIN APPROVAL FROM THE DISTRICT ONE BUREAU CHIEF OF MAINTENANCE FOR ANY PROPOSED REVISIONS IN THE SCHEDULED PAVEMENT PATCHING LOCATIONS.

THE ENGINEER SHALL CONTACT DON CHIARUGI, TRAFFIC FIELD ENGINEER, AT (847) 741-9857 A MINIMUM OF TWO (2) WEEKS PRIOR TO PLACEMENT OF PERMANENT PAVEMENT MARKINGS.

ALL DAMAGE TO EXISTING PAVEMENT MARKINGS OR RRPMS OUTSIDE THE REMOVAL LINES SHOWN ON THE PLANS SHALL BE REPLACED AT THE CONTRACTORS EXPENSE.

DOUBLE LANE MARKERS ARE TO BE USED AS SHOWN ON THE DISTRICT ONE DETAIL FOR "TYPICAL APPLICATION OF RAISED REFLECTIVE PAVEMENT MARKERS (SNOW PLOW RESISTANT)" SHOWN IN THE PLANS.

**MIXTURE REQUIREMENTS**

CLASS D PATCH	MIXTURE TYPE	AC/PG TYPE	MAX RAP %	AIR VOIDS (%)
TOP 2"	BITUMINOUS CONCRETE SURFACE COURSE, SUPERPAVE, MIX "D", N70, 2"	PG 64-22	10%	4% @ 70 GYR
BOTTOM 6"	BITUMINOUS CONCRETE BINDER COURSE, SUPERPAVE, IL-19, N70, 6"	PG 64-22	15%	4% @ 70 GYR

ILLINOIS DEPARTMENT OF TRANSPORTATION

**GENERAL NOTES**

ROUTE	SECTION	COUNTY	TOTAL SHEETS	SHEET NUMBER
FAP 326	2006-014 CRC-PP	KANE	17	4

CONTRACT NO. 60B38

SUMMARY OF QUANTITIES				CONSTRUCTION TYPE CODE		
CODE NO	ITEM	UNIT	TOTAL QUANTITIES	URBAN 100% STATE 1000		
44201737	CLASS D PATCHES, TYPE I, 8 INCH	SQ YD	23.2	23.2		
44201741	CLASS D PATCHES, TYPE II, 8 INCH	SQ YD	728.0	728.0		
44201745	CLASS D PATCHES, TYPE III, 8 INCH	SQ YD	1012	1012		
44201747	CLASS D PATCHES, TYPE IV, 8 INCH	SQ YD	994.0	994.0		
67000400	ENGINEER'S FIELD OFFICE, TYPE A	CAL MO	2	2		
67100100	MOBILIZATION	L SUM	1	1		
70100320	TRAFFIC CONTROL & PROTECTION, STANDARD 701422	L SUM	1	1		
70102635	TRAFFIC CONTROL & PROTECTION, STANDARD 701701	L SUM	1	1		
* 78008210	POLYUREA PAVEMENT MARKING TYPE I - LINE 4"	FOOT	10000	10000		
* 78100100	RAISED REFLECTIVE PAVEMENT MARKER	EACH	100	100		
X0322467	TEMPORARY INFORMATION SIGNING FOR LANE CLOSURE	SQ FT	96	96		
<i>* SPECIALTY ITEMS</i>						

ILLINOIS DEPARTMENT OF  
TRANSPORTATION  
  
SUMMARY OF QUANTITIES

ROUTE	SECTION	COUNTY	TOTAL SHEETS	SHEET NUMBER
FAP 326	2006-014 CRC-PP	KANE	17	5

**CONTRACT 60B38**

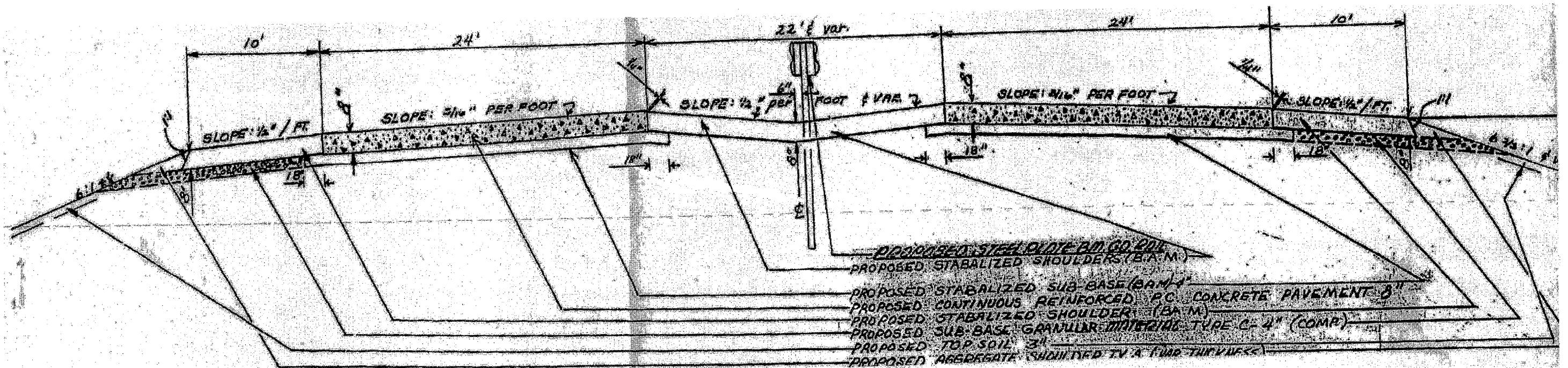

**IL ROUTE 47:  
FROM GALENA BLVD. TO BLISS RD.**

**FOR INFORMATION ONLY**

ILLINOIS DEPARTMENT OF TRANSPORTATION  
**TYPICAL SECTION**

ROUTE	SECTION	COUNTY	TOTAL SHEETS	SHEET NUMBER
FAP 326	2006-014 CRC-PP	KANE	17	6

**CONTRACT 60B38**

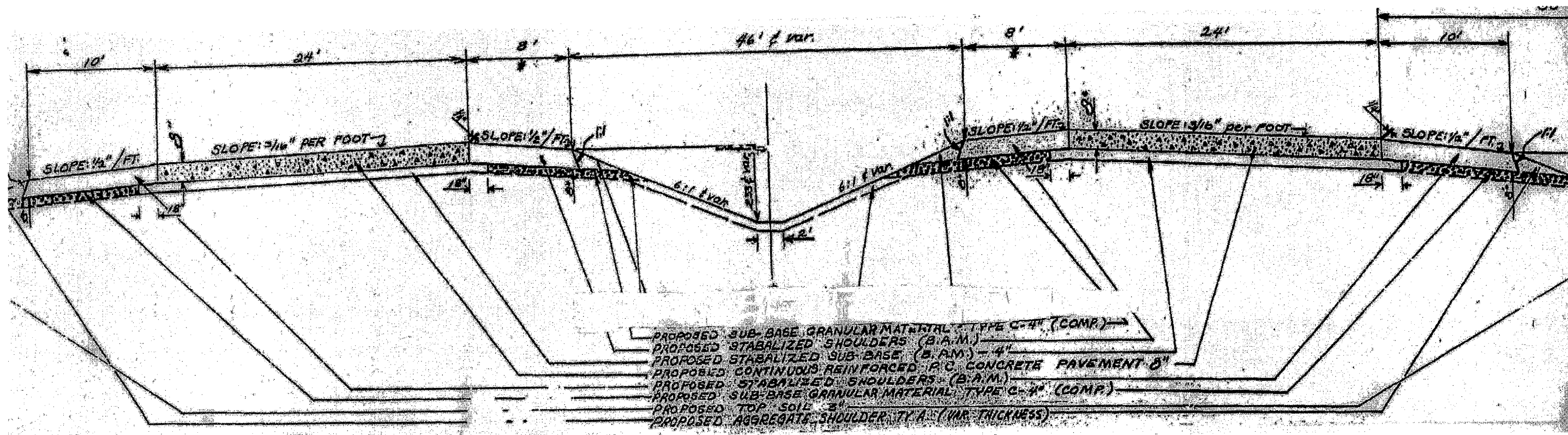

**IL ROUTE 47:  
FROM BLISS RD. TO NORTH OF I-88**

**FOR INFORMATION ONLY**

ILLINOIS DEPARTMENT OF TRANSPORTATION  
**TYPICAL SECTION**

ROUTE	SECTION	COUNTY	TOTAL SHEETS	SHEET NUMBER
FAP 326	2006-014 CRC-PP	KANE	17	7

**CLASS D: PAVEMENT PATCHING SCHEDULE**

Northbound ILLINOIS ROUTE 47  
GALENA BLVD. TO NORTH OF I-88 BRIDGE (SEAVEY RD.)

PATCH LOCATION NUMBER	STATION	LANE 1			LANE 2		
		SIZE (L X W)	AREA (SQ. YD.)	TYPE	SIZE (L X W)	AREA (SQ. YD.)	TYPE
	0+00	GALENA BLVD.-START OF OMISSION/LIMITS					
	23+95	CENTERLINE-BLISS RD.					
	35+62	START OF CRC PAVEMENT-END OF OMISSION					
1	36+74				5 x 12	6.7	II
2	37+74	5 x 12	6.7	II			
3	38+09				20 x 6	13.3	II
4	38+78				15 x 6	10.0	II
5	40+46				15 x 6	10.0	II
6	41+91				29 x 6	19.3	III
7	45+29	15 x 12	20.0	III			
8	46+59				25 x 6	16.7	III
9	48+39				15 x 12	20.0	III
10	48+62				30 x 6	20.0	III
11	49+32				18 x 6	12.0	II
12	49+98				38 x 6	25.3	IV
	52+16	CENTERLINE-KEDEKA RD.					
13	53+11				10 x 6	6.7	II
14	53+55				34 x 6	22.7	III
15	54+22				22 x 6	14.7	II
16	55+29				56 x 6	37.3	IV
17	56+02				18 x 6	12.0	II
18	56+78				50 x 6	33.3	IV
19	57+95				34 x 6	22.7	III
20	60+22				12 x 12	16.0	III
21	68+67				12 x 12	16.0	III
22	71+48				20 x 12	26.7	IV
23	73+12				11 x 6	7.3	II
24	73+43				8 x 6	5.3	II
25	76+32				10 x 6	6.7	II
26	78+87				25 x 6	16.7	III
27	79+37				10 x 6	6.7	II
28	79+52				10 x 6	6.7	II
29	80+18				22 x 12	29.3	IV
30	81+17				15 x 12	20.0	III
	81+49	CENTERLINE-S. ENTRANCE WAUBONSEE DR.					
31	81+82				12 x 6	8.0	II
32	82+10				8 x 6	5.3	II

**CLASS D: PAVEMENT PATCHING SCHEDULE**

Northbound ILLINOIS ROUTE 47  
GALENA BLVD. TO NORTH OF I-88 BRIDGE (SEAVEY RD.)

CONTRACT 60B38

PATCH LOCATION NUMBER	STATION	LANE 1			LANE 2		
		SIZE (L X W)	AREA (SQ. YD.)	TYPE	SIZE (L X W)	AREA (SQ. YD.)	TYPE
33	82+52				42 x 6	28.0	IV
34	83+03	13 x 12	17.3	III	13 x 12	17.3	III
35	83+24	16 x 12	21.3	III			
36	83+45				21 x 12	28.0	IV
37	83+54	10 x 6	6.7	II			
38	83+95				18 x 12	24.0	III
39	84+19				18 x 6	12.0	II
40	84+66				12 x 6	8.0	II
41	85+88				50 x 6	33.3	IV
42	86+76				8 x 6	5.3	II
43	87+52				9 x 6	6.0	II
44	88+69				20 x 6	13.3	II
45	89+37				14 x 12	18.7	III
46	89+95	10 x 12	13.3	II			
47	90+50				34 x 6	22.7	III
48	91+25	12 x 12	16.0	III			
49	91+42	29 x 12	38.7	IV			
50	92+11				8 x 6	5.3	II
51	92+55	11 x 12	14.7	II	11 x 12	14.7	II
52	92+71				7 x 6	4.7	I
53	92+78	12 x 12	16.0	III			
54	93+08	27 x 12	36.0	IV			
55	94+10	19 x 12	25.3	IV			
56	94+34				21 x 6	14.0	II
57	94+37	43 x 12	57.3	IV			
58	94+71				21 x 6	14.0	II
59	95+79	19 x 12	25.3	IV			
60	96+85				21 x 6	14.0	II
61	97+62	11 x 12	14.7	II	11 x 12	14.7	II
62	98+05	39 x 12	52.0	IV			
63	98+35				5 x 12	6.7	II
	100+10	CENTERLINE-HARTER RD.					
64	101+23	16 x 12	21.3	III			
65	103+33	11 x 6	7.3	II			
66	104+64	18 x 12	24.0	III			
67	106+40	12 x 12	16.0	III			
68	106+67	12 x 12	16.0	III			

ILLINOIS DEPARTMENT OF TRANSPORTATION

**PAVEMENT PATCHING SCHEDULE**

<b>ROUTE</b> FAP 326	<b>SECTION</b> 2006-014 CRC-PP	<b>COUNTY</b> KANE	<b>TOTAL SHEETS</b> 17	<b>SHEET NUMBER</b> 8
-------------------------	-----------------------------------	-----------------------	---------------------------	--------------------------

**CLASS D: PAVEMENT PATCHING SCHEDULE**  
**Northbound ILLINOIS ROUTE 47**  
**GALENA BLVD. TO NORTH OF I-88 BRIDGE (SEAVEY RD.)**

**CONTRACT 60B38**

PATCH LOCATION NUMBER	STATION	LANE 1			LANE 2		
		SIZE (L X W)	AREA (SQ. YD.)	TYPE	SIZE (L X W)	AREA (SQ. YD.)	TYPE
69	106+72				12 x 12	16.0	III
70	108+69	13 x 12	17.3	III			
71	109+41	8 x 6	5.3	II			
72	109+61	14 x 6	9.3	II			
73	110+40	20 x 12	26.7	IV			
74	114+95	7 x 6	4.7	I			
75	115+70				16 x 12	21.3	III
76	116+11				8 x 6	5.3	II
77	117+08	10 x 6	6.7	II			
78	122+78	20 x 12	26.7	IV			
79	125+92	15 x 12	20.0	III			
	127+49	CENTERLINE-NORTH ENTRANCE-WAUBONSEE COLLEGE					
80	128+67				6 x 12	8.0	II
	134+79	END OF CRC PAVEMENT-START OF OMISSION					
194+17 - 195+83	I-88 BRIDGE						
	212+91	CENTER LINE SEAVEY RD. - END OF OMISSION					

ILLINOIS DEPARTMENT OF TRANSPORTATION  
**PAVEMENT PATCHING SCHEDULE**



ROUTE	SECTION	COUNTY	TOTAL SHEETS	SHEET NUMBER
FAP 326	2006-014 CRC-PP	KANE	17	9

**CLASS D: PAVEMENT PATCHING SCHEDULE**

Southbound ILLINOIS ROUTE 47  
NORTH OF I-88 BRIDGE (SEAVEY RD. ) TO NORTH OF GALENA BLVD.

PATCH LOCATION NUMBER	STATION	LANE 1			LANE 2		
		SIZE (L X W)	AREA (SQ. YD.)	TYPE	SIZE (L X W)	AREA (SQ. YD.)	TYPE
*	78+29	START OF CRC PAVEMENT-END OF OMISSION					
227	80+13	13 x 12	17.3	III			
228	81+44				15 x 6	10.0 II	
229	82+06				12 x 12	16.0 III	
230	83+90				10 x 6	6.7 II	
231	87+95	22 x 12	29.3	IV			
232	88+49	8 x 6	5.3	II			
233	89+50	12 x 12	16.0	III			
234	98+15				12 x 12	16.0 III	
235	102+09				12 x 12	16.0 III	
236	107+96	47 x 6	31.3	IV			
237	108+01				8 x 6	5.3 II	
238	108+60	23 x 6	15.3	III	23 x 6	15.3 III	
239	108+93				12 x 6	8.0 II	
240	109+08				30 x 12	40.0 IV	
241	111+04				50 x 12	66.7 IV	
242	111+70	22 x 12	29.3	IV	17 x 12	22.7 III	
243	112+19	20 x 6	13.3	II			
244	112+96				40 x 6	26.7 IV	
	113+29	CENTERLINE-HARTER RD.					
245	115+64	25 x 6	16.7	III			
246	116+54				18 x 12	24.0 III	
247	117+68				11 x 12	14.7 II	
248	118+80				6 x 12	8.0 II	
249	119+49				33 x 12	44.0 IV	
250	119+86	19 x 6	12.7	II			
251	120+13				7 x 6	4.7 I	
252	121+18				8 x 6	5.3 II	
253	122+13	31 x 6	20.7	III			
254	122+36	11 x 6	7.3	II			
255	124+92				9 x 6	6.0 II	
256	125+69	20 x 6	13.3	II			
257	128+33				10 x 6	6.7 II	
258	128+55				14 x 12	18.7 III	
259	130+37				11 x 6	7.3 II	
260	131+54	7 x 6	4.7	I			
	132+65	CENTERLINE-WAUBONSEE RD.					

\* 0+00 CENTERLINE SEAVEY RD. - START OF OMISSION  
16+86 - 18+52 I-88 BRIDGE  
26+22 CENTERLINE FINLEY RD.

**CLASS D: PAVEMENT PATCHING SCHEDULE**

CONTRACT 60B38

Southbound ILLINOIS ROUTE 47  
NORTH OF I-88 BRIDGE (SEAVEY RD. ) TO NORTH OF GALENA BLVD.

PATCH LOCATION NUMBER	STATION	LANE 1			LANE 2		
		SIZE (L X W)	AREA (SQ. YD.)	TYPE	SIZE (L X W)	AREA (SQ. YD.)	TYPE
261	132+67				16 x 12	21.3	III
262	134+38				12 x 6	8.0	II
263	137+25				13 x 12	17.3	III
264	137+81	15 x 6	10.0	II	15 x 6	10.0	II
265	138+94	34 x 6	22.7	III	34 x 6	22.7	III
266	139+40				10 x 6	6.7	II
267	140+12				17 x 6	11.3	II
268	142+67	15 x 12	20.0	III			
269	143+13	42 x 12	56.0	IV			
270	143+61				15 x 6	10.0	II
271	144+06	29 x 12	38.7	IV			
272	144+12				12 x 6	8.0	II
273	145+63				13 x 6	8.7	II
274	148+86				8 x 6	5.3	II
275	152+56	15 x 12	20.0	III			
276	154+06	10 x 12	13.3	II	10 x 12	13.3	II
277	154+69				10 x 12	13.3	II
278	156+17				7 x 6	4.7	I
	161+59	CENTERLINE-KEDEKA RD.					
279	164+91				16 x 12	21.3	III
280	171+05				11 x 12	14.7	II
281	171+21				35 x 6	23.3	III
282	172+41				10 x 6	6.7	II
283	176+86	19 x 12	25.3	IV			
284	177+52	14 x 12	18.7	III			
285	182+88				15 x 6	10.0	II
286	183+79				12 x 6	8.0	II
287	184+48				15 x 6	10.0	II
	189+59	CENTERLINE-WHEELER RD.					
288	191+31	11 x 12	14.7	II			
289	192+98				13 x 12	17.3	III
290	194+13	24 x 12	32.0	IV			
291	196+43				12 x 12	16.0	III
292	196+60				10 x 12	13.3	II
293	197+70				14 x 12	18.7	III
294	197+90				14 x 12	18.7	III
295	198+57				34 x 12	45.3	IV

ILLINOIS DEPARTMENT OF TRANSPORTATION  
**PAVEMENT PATCHING SCHEDULE**

ROUTE	SECTION	COUNTY	TOTAL SHEETS	SHEET NUMBER
FAP 326	2006-014 CRC-PP	KANE	17	10

**CLASS D: PAVEMENT PATCHING SCHEDULE**

Southbound ILLINOIS ROUTE 47  
NORTH OF I-88 BRIDGE (SEAVEY RD. ) TO NORTH OF GALENA BLVD.

**CONTRACT 60B38**

PATCH LOCATION NUMBER	STATION	LANE 1			LANE 2		
		SIZE (L X W)	AREA (SQ. YD.)	TYPE	SIZE (L X W)	AREA (SQ. YD.)	TYPE
296	198+76	10 x 12	13.3	II			
297	198+93	12 x 6	8.0	II			
298	199+23				12 x 6	8.0	II
299	200+13	18 x 12	24.0	III			
	200+91	CENTERLINE-W. PARK AVE.					
300	204+86	6 x 12	8.0	II	6 x 12	8.0	II
	207+40	END OF CRC PAVEMENT-START OF OMISSION					
	213+54	CENTERLINE-GALENA BLVD-END OF OMISSION/LIMITS					

F.A. #	SECTION	COUNTY	TOTAL SHEETS	SHEET NO.
300	*	KANE	17	11
STA.	TO STA.			
FED. ROAD DIST. NO.	ILLINOIS	FED. AID PROJECT		

#2006-014 CRC-PP

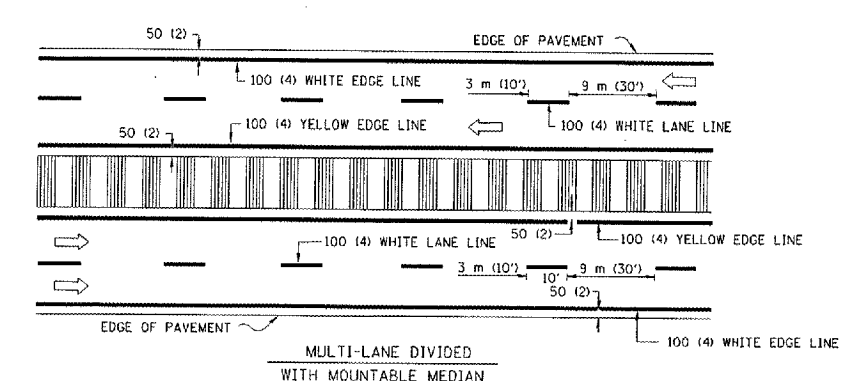
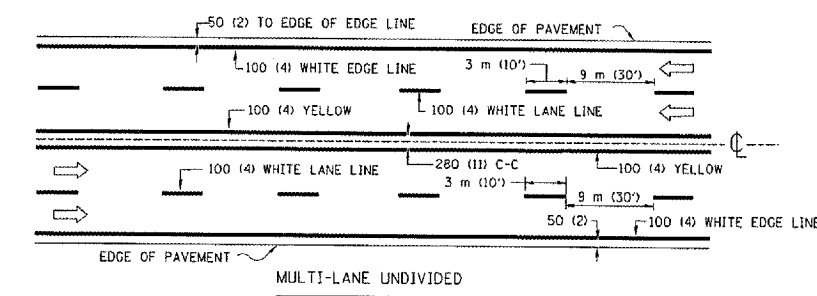
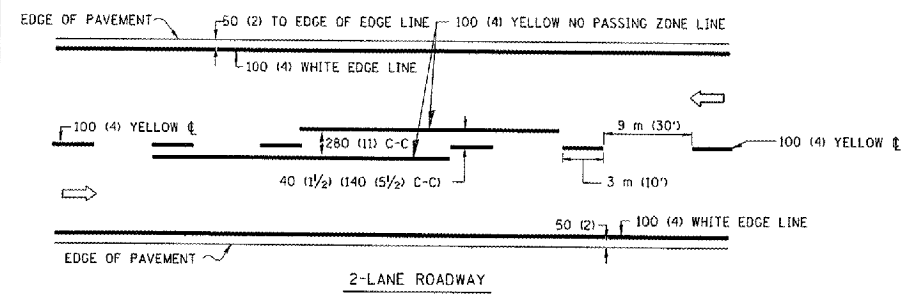

NOTE: MEDIANS WITH BARRIER CURB DO NOT REQUIRE AN EDGE LINE

TYPICAL LANE AND EDGE LINE MARKING

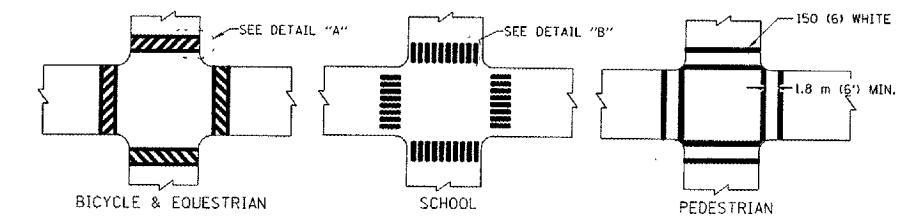

TYPICAL CROSSWALK MARKING

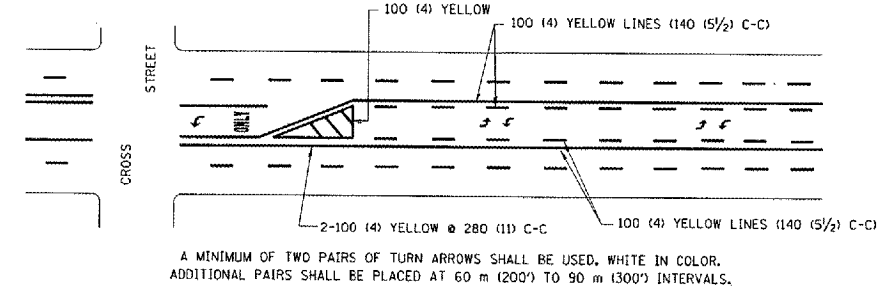
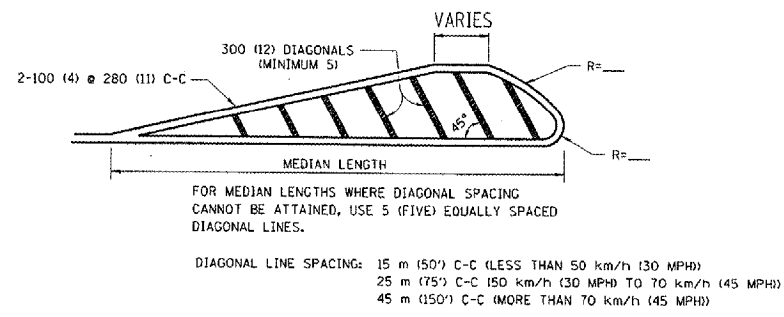
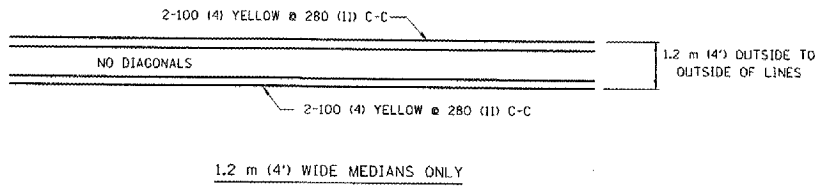

TYPICAL PAINTED MEDIAN MARKING

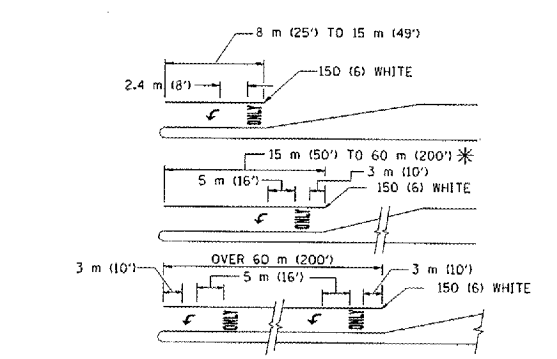

FULL SIZE LETTERS 2.4 m (8') AND ARROWS SHALL BE USED.  
 \* TURN LANES IN EXCESS OF 120 m (400') IN LENGTH MAY HAVE AN ADDITIONAL SET OF ARROW - "ONLY" INSTALLED MIDWAY BETWEEN THE OTHER TWO SETS OF ARROW - "ONLY".

TYPICAL LEFT (OR RIGHT) TURN LANE

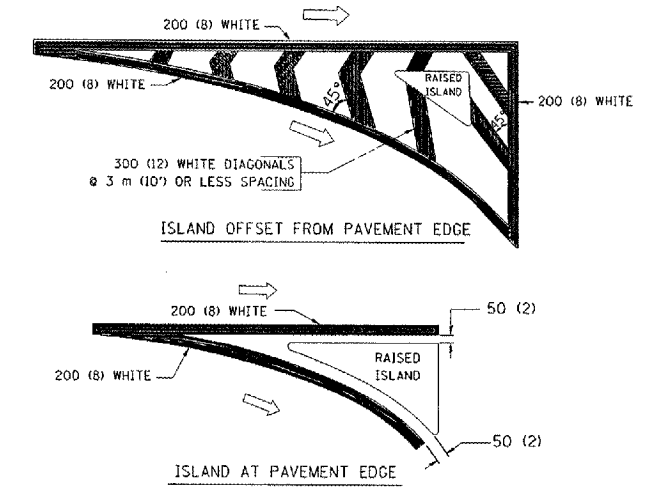

TYPICAL ISLAND MARKING

TYPE OF MARKING	WIDTH OF LINE	PATTERN	COLOR	SPACING / REMARKS
CENTERLINE ON 2 LANE PAVEMENT	100 (4)	SKIP-DASH	YELLOW	3 m (10') LINE WITH 9 m (30') SPACE
CENTERLINE ON MULTI-LANE UNDIVIDED PAVEMENT	2 @ 100 (4)	SOLID	YELLOW	280 (11) C-C
NO PASSING ZONE LINES: FOR ONE DIRECTION FOR BOTH DIRECTIONS	100 (4) 2 @ 100 (4)	SOLID SOLID	YELLOW YELLOW	140 (5 1/2) C-C FROM SKIP-DASH CENTERLINE 280 (11) C-C OMIT SKIP-DASH CENTERLINE BETWEEN
LANE LINES	100 (4) 125 (5) ON FREEWAYS	SKIP-DASH SKIP-DASH	WHITE WHITE	3 m (10') LINE WITH 9 m (30') SPACE
DOTTED LINES (EXTENSIONS OF CENTER, LANE OR TURN LANE MARKINGS)	SAME AS LINE BEING EXTENDED	SKIP-DASH	SAME AS LINE BEING EXTENDED	600 (2') LINE WITH 1.8 m (6') SPACE
EDGE LINES	100 (4)	SOLID	YELLOW-LEFT WHITE-RIGHT	OUTLINE MOUNTABLE MEDIANS IN YELLOW; EDGE LINES ARE NOT USED NEXT TO BARRIER CURB
TURN LANE MARKINGS	150 (6) LINE; FULL SIZE LETTERS & SYMBOLS (2.4 m (8'))	SOLID	WHITE	SEE TYPICAL TURN LANE MARKING DETAIL
TWO WAY LEFT TURN MARKING	2 @ 100 (4) EACH DIRECTION 2.4 m (8') LEFT ARROW	SKIP-DASH AND SOLID IN PAIRS	YELLOW WHITE	3 m (10') LINE WITH 9 m (30') SPACE FOR SKIP-DASH; 140 (5 1/2) C-C BETWEEN SOLID LINE AND SKIP-DASH LINE SEE TYPICAL TWO-WAY LEFT TURN MARKING DETAIL
CROSSWALK LINES (PEDESTRIAN) A. DIAGONALS (BIKE & EQUESTRIAN) B. LONGITUDINAL BARS (SCHOOL)	2 @ 150 (6) 300 (12) @ 45° 300 (12) @ 90°	SOLID SOLID SOLID	WHITE WHITE WHITE	NOT LESS THAN 1.8 m (6') APART 600 (2') APART 600 (2') APART SEE TYPICAL CROSSWALK MARKING DETAILS.
STOP LINES	600 (24)	SOLID	WHITE	PLACE 1.2 m (4') IN ADVANCE OF AND PARALLEL TO CROSSWALK, IF PRESENT. OTHERWISE, PLACE AT DESIRED STOPPING POINT, PARALLEL TO CROSSROAD CENTERLINE, WHERE POSSIBLE
PAINTED MEDIANS	2 @ 100 (4) WITH 300 (12) DIAGONALS @ 45° NO DIAGONALS USED FOR 1.2 m (4') WIDE MEDIANS	SOLID	YELLOW: TWO WAY TRAFFIC WHITE: ONE WAY TRAFFIC	280 (11) C-C FOR THE DOUBLE LINE SEE TYPICAL PAINTED MEDIAN MARKING.
GORE MARKING AND CHANNELIZING LINES	200 (8) WITH 300 (12) DIAGONALS @ 45°	SOLID	WHITE	DIAGONALS: 4.5 m (15') C-C (LESS THAN 50 km/h (30 MPH)) 6 m (20') C-C (50 km/h (30 MPH) TO 70 km/h (45 MPH)) 9 m (30') C-C (OVER 70 km/h (45 MPH))
RAILROAD CROSSING	600 (24) TRANSVERSE LINES; "RR" IS 1.8 m (6') LETTERS; 400 (16) LINE FOR "X"	SOLID	WHITE	SEE STATE STANDARD 780001 AREA OF: "R"=0.33m <sup>2</sup> (3.6 SQ. FT.) EACH "X"=5.0 m <sup>2</sup> (54.0 SQ. FT.)
SHOULDER DIAGONALS	300 (12) @ 45°	SOLID	WHITE - RIGHT YELLOW - LEFT	15 m (50') C-C (LESS THAN 50 km/h (30 MPH)) 25 m (75') C-C (50 km/h (30 MPH) TO 70 km/h (45 MPH)) 45 m (150') C-C (OVER 70 km/h (45 MPH))

FOR FURTHER DETAILS ON PAVEMENT MARKING REFER TO STANDARD SPECIFICATIONS FOR ROAD AND BRIDGE CONSTRUCTION AND STATE STANDARD 780001.

All dimensions are in millimeters (inches) unless otherwise shown.

REVISIONS	
NAME	DATE
EVERS	03-19-90
T. RAMMACHER	10-27-94
ALEX HOUSEH	10-09-96
ALEX HOUSEH	10-17-96
T. RAMMACHER	01-06-00

ILLINOIS DEPARTMENT OF TRANSPORTATION  
 DISTRICT ONE  
 TYPICAL PAVEMENT MARKINGS

SCALE: NONE  
 DATE 10/18/2002  
 DRAWN BY CADD  
 CHECKED BY  
 TC-13

REVISION DATE: 01/06/00

F.A. P. RTE.	SECTION	COUNTY	TOTAL SHEETS	SHEET NO.
326	*	KANE	17	12
STA.	TO STA.			
FED. ROAD DIST. NO. 1	ILLINOIS	FED. AID PROJECT		

\*2006-014 CRC-PP

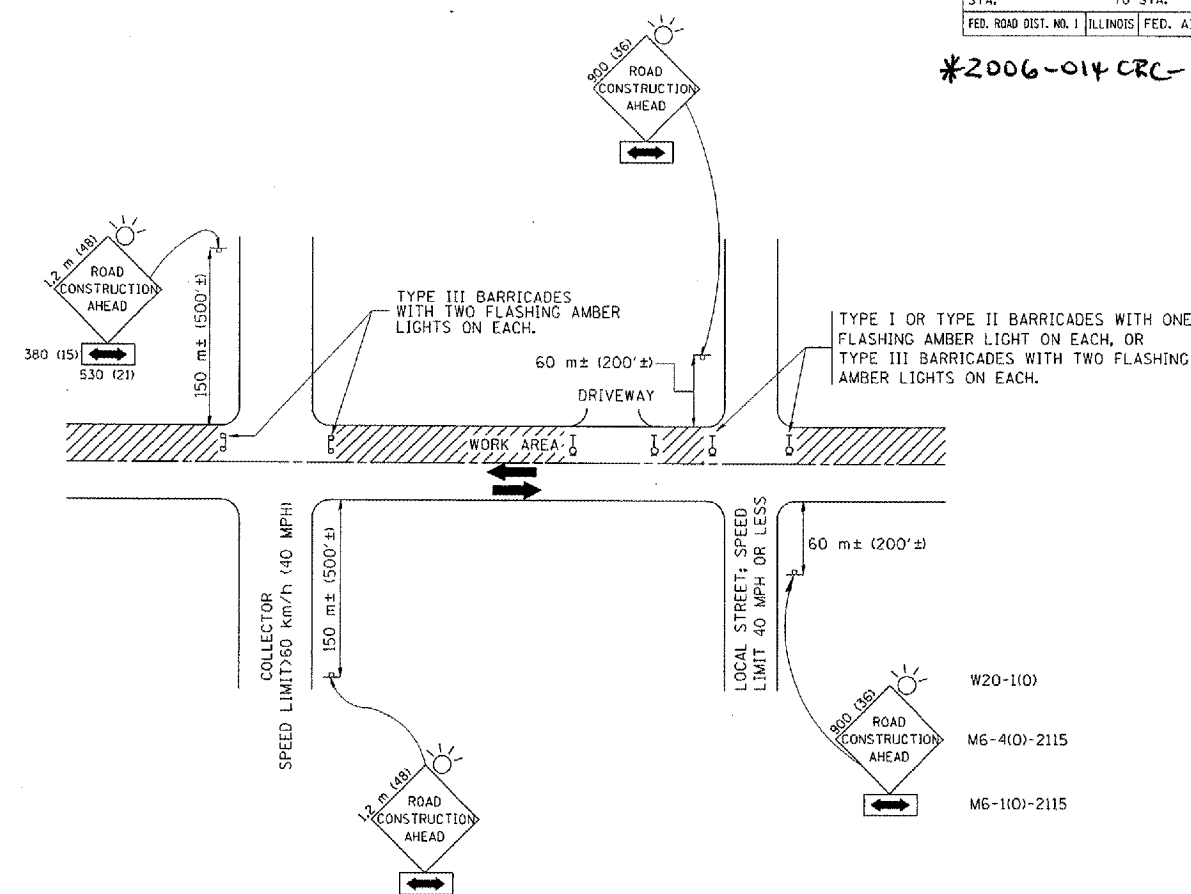

### TRAFFIC CONTROL AND PROTECTION FOR SIDE ROADS, INTERSECTIONS, AND DRIVEWAYS

#### NOTES:

##### A. FOR NO LANE RESTRICTION ON THE SIDE ROAD OR DRIVEWAYS

- SIDE ROAD WITH A SPEED LIMIT OF 60 km/h (40 MPH) OR LESS AS SHOWN ON THE DRAWING AND AS DIRECTED BY THE ENGINEER:
  - ONE **ROAD CONSTRUCTION AHEAD** SIGN 900x900 (36x36) WITH A FLASHER AND FLAG MOUNTED ON IT APPROXIMATELY 60 m (200') IN ADVANCE OF THE MAIN ROUTE.
  - THE CLOSED PORTION OF THE MAIN ROUTE SHALL BE PROTECTED BY BLOCKING WITH TYPE I, TYPE II OR TYPE III BARRICADES, 1/3 OF THE CROSS SECTION OF THE CLOSED PORTION.
- SIDE ROAD WITH A SPEED LIMIT GREATER THAN 60 km/h (40 MPH) AS SHOWN ON THE DRAWING AND AS DIRECTED BY THE ENGINEER:
  - ONE **ROAD CONSTRUCTION AHEAD** SIGN 1.2 m x 1.2 m (48x48) WITH A FLASHER MOUNTED ON IT APPROXIMATELY 150 m (500') IN ADVANCE OF THE MAIN ROUTE.
  - THE CLOSED PORTION OF THE MAIN ROUTE SHALL BE PROTECTED BY BLOCKING WITH TYPE III BARRICADES, 1/2 OF THE CROSS SECTION OF THE CLOSED PORTION.
- WHEN THE SIDE ROAD LIES BETWEEN THE BEGINNING OF THE MAINLINE SIGNING AND THE WORK ZONE, A SINGLE HEADED ARROW (M6-1) SHALL BE USED IN LIEU OF THE DOUBLE HEADED ARROW (M6-4).

##### B. FOR A LANE CLOSURE ON A SIDE ROAD OR DRIVEWAY:

USE APPLICABLE PORTIONS OF THE TYPICAL APPLICATION OF TRAFFIC CONTROL DEVICES (STD. 70150), STD. 701606 OR THE APPROPRIATE STANDARD. THE SPACING OF SIGNS AND BARRICADES SHALL BE ADJUSTED FOR FIELD CONDITIONS AS DIRECTED BY THE ENGINEER. THE DIRECTIONAL ARROW SHALL BE COVERED OR REMOVED WHEN NO LONGER CONSISTENT WITH THE SIDE ROAD LANE CLOSURE.

C. ADVANCE WARNING SIGNS ARE TO BE OMITTED ON DRIVEWAY UNLESS OTHERWISE NOTED.

D. THE TRAFFIC CONTROL AND PROTECTION FOR SIDE ROADS, INTERSECTIONS, AND DRIVEWAYS SHALL BE INCIDENTAL TO THE COST OF SPECIFIED TRAFFIC CONTROL STANDARDS OR ITEMS.

REVISIONS		
NAME	DATE	
LHA	6/89	
T. RAMMACHER	03/08/94	
J. OBERLE	10/18/95	
A. HOUSEH	03/06/96	
A. HOUSEH	10/15/96	
T. RAMMACHER	01/06/00	

ILLINOIS DEPARTMENT OF TRANSPORTATION  
**TRAFFIC CONTROL AND PROTECTION  
 FOR  
 SIDE ROADS, INTERSECTIONS, AND  
 DRIVEWAYS**

SCALE: VERT.  
 HORIZ.  
 DATE 10/18/2002

DRAWN BY  
 CHECKED BY  
 TC-10

P	SECTION	COUNTY	TOTAL SHEETS	SHEET NO.
326	*	KANE	17	13
STA.	TO STA.			
FED. ROAD DIST. NO.	ILLINOIS	FED. AID PROJECT		

#2006-014 CRC-PP

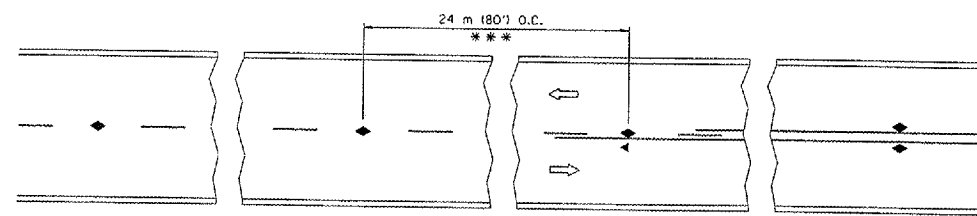

\*\*\* REDUCE TO 12 m (40') O.C. ON CURVES WITH POSTED OR ADVISORY SPEED 70 km/h (45 M.P.H.) OR LESS.

TWO-LANE/TWO-WAY

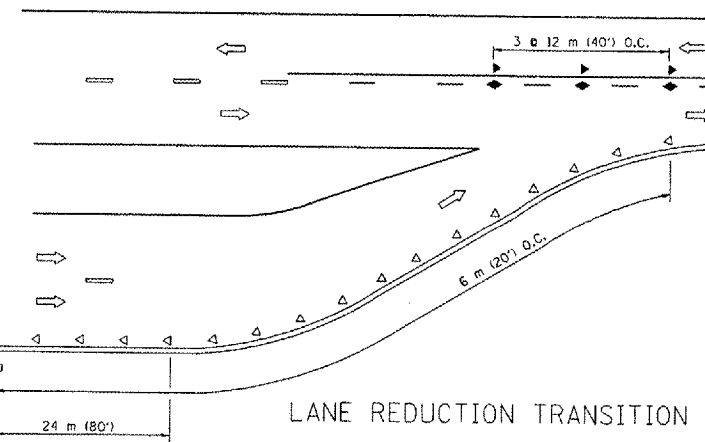

LANE REDUCTION TRANSITION

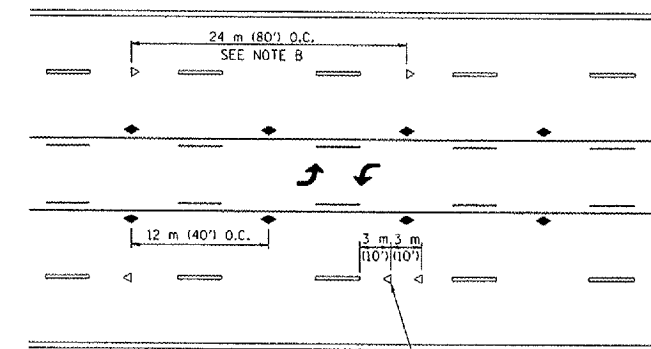

TWO-WAY LEFT TURN

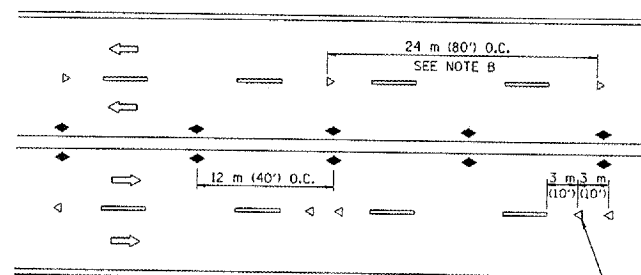

MULTI-LANE/UNDIVIDED

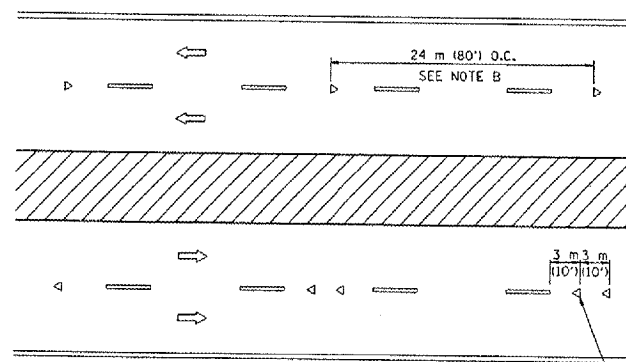

MULTI-LANE/DIVIDED

GENERAL NOTES

1. MARKERS USED WITH DASHED LINES SHALL BE CENTERED IN THE GAP BETWEEN SEGMENTS.
2. MARKERS USED ADJACENT TO SOLID LINES SHALL BE OFFSET 50 TO 75 (2 TO 3) TOWARD TRAFFIC AS SHOWN.
3. MARKERS THROUGH TANGENTS LESS THAN 150 m (500') IN LENGTH BETWEEN CURVES SHALL BE INSTALLED AT THE LESSER OF THE TWO CURVE SPACINGS.

SYMBOLS

- YELLOW STRIPE
- WHITE STRIPE
- ◀ ONE-WAY AMBER MARKER
- ◁ ONE-WAY CRYSTAL MARKER (W/O)
- ◆ TWO-WAY AMBER MARKER

LANE MARKER NOTES

- B. REDUCE TO 12 m (40') O.C. ON CURVES WHERE ADVISORY SPEEDS ARE 20 km/h (10 M.P.H.) LOWER THAN POSTED SPEEDS.
- A. USE DOUBLE LANE LINE MARKERS SPACED AS SHOWN.

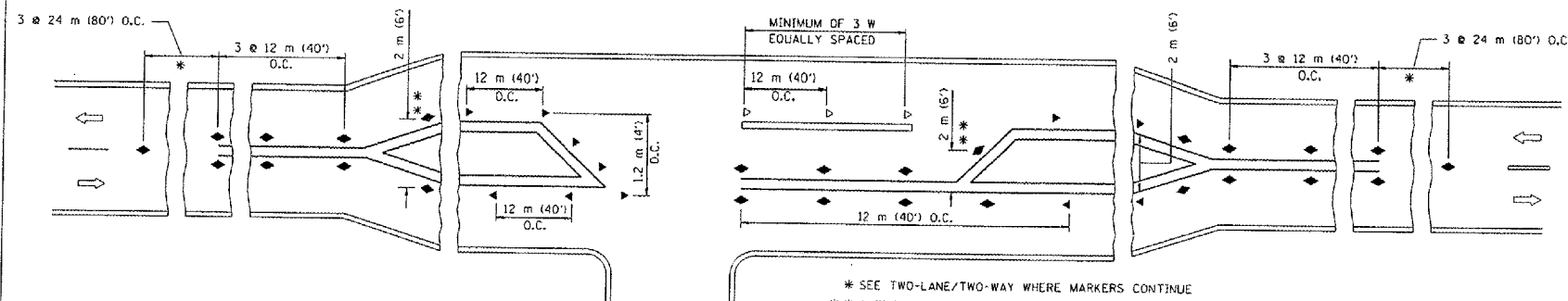

\* SEE TWO-LANE/TWO-WAY WHERE MARKERS CONTINUE  
 \*\* WHERE THE MEDIAN WIDTH IS 2 m (6') OR LESS USE TWO-WAY MARKERS.

LEFT TURN

All dimensions are in millimeters (inches) unless otherwise shown.

ILLINOIS DEPARTMENT OF TRANSPORTATION  
 TYPICAL APPLICATIONS  
 RAISED REFLECTIVE PAVEMENT MARKERS  
 (SNOW-PLOW RESISTANT)

REVISIONS	
NAME	DATE
T. RAMMACHER	09-19-94
T. RAMMACHER	03-12-99
T. RAMMACHER	01-06-00

SCALE: NONE  
 DATE: 10/18/2002  
 DRAWN BY CADD  
 CHECKED BY TC-11

FILE #	SECTION	COUNTY	TOTAL SHEETS	SHEET NO.
326	*	KANE 17	14	
STA.	TO STA.			
FED. ROAD DIST. NO.	BLANKS	FED. AID PROJECT		



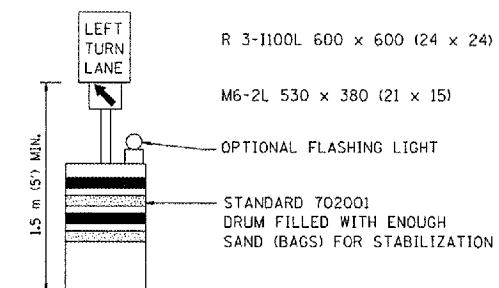
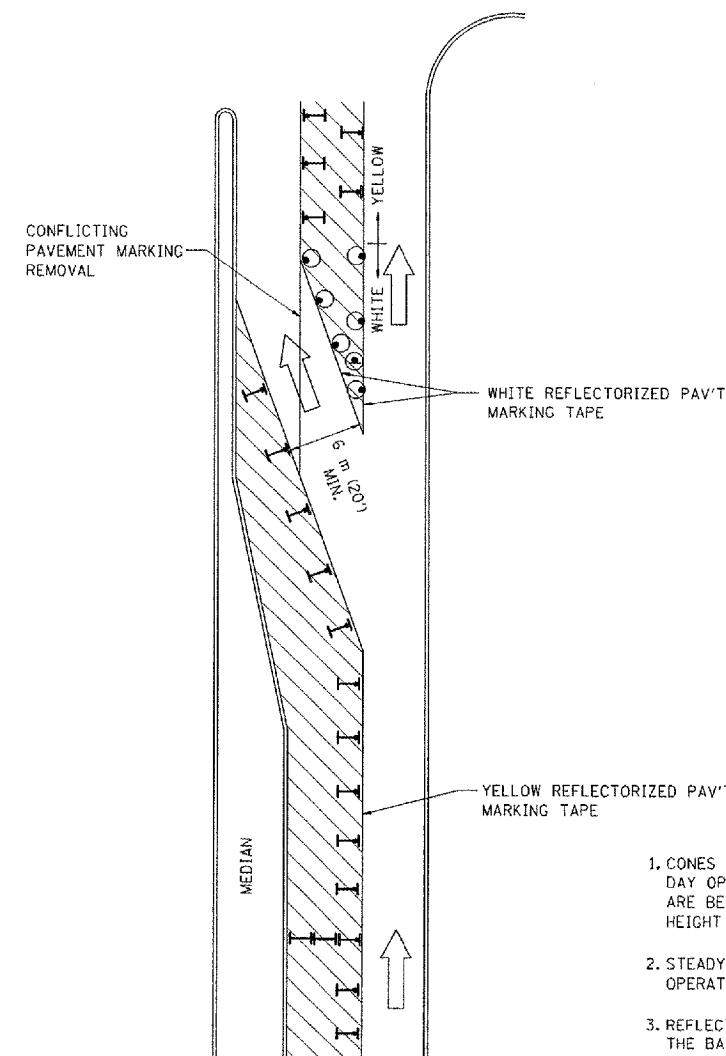

\*2006-014CRC-PP

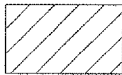
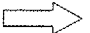
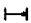

GENERAL NOTES

1. CONES MAY BE SUBSTITUTED FOR BARRICADES OR DRUMS AT HALF THE SPACING DURING DAY OPERATIONS. CONES SHALL BE A MINIMUM OF 710 (28) IN HEIGHT. WHEN CONES ARE BEING USED, THE "LEFT TURN LANE" SIGN MAY BE SKID MOUNTED AT A MINIMUM HEIGHT OF 1.5 m (5').
2. STEADY BURNING LIGHTS WILL NOT BE REQUIRED ON BARRICADES OR DRUMS FOR DAY OPERATIONS. ALL LIGHTS SHALL BE MONODIRECTIONAL.
3. REFLECTORIZED TEMPORARY PAVEMENT MARKING TAPE SHALL BE PLACED THROUGHOUT THE BARRICADED AREA OF EACH TURN BAY WHERE THE CLOSURE TIME IS GREATER THAN FOURTEEN DAYS.
4. THIS APPLICATION ALSO APPLIES WHEN WORK IS BEING PERFORMED IN THE RIGHT LANE(S) AND THE RIGHT TURN BAY IS TO REMAIN OPEN. UNDER THIS CONDITION, "RIGHT TURN LANE" R3-100 600 x 600 (24 x 24) AND M6-2R 530 x 380 (21 x 15) SHALL BE USED.
5. THESE CONTROLS SHALL SUPPLEMENT MAINLINE TRAFFIC CONTROL FOR LANE CLOSURES.
6. LONGITUDINAL DIMENSIONS MAY BE ADJUSTED TO FIT FIELD CONDITIONS.
7. FORM BT 725 IS REQUIRED.
8. TRAFFIC CONTROL AND PROTECTION AT TURN BAYS (TO REMAIN OPEN TO TRAFFIC) SHALL BE INCLUDED IN THE COST SPECIFIED TRAFFIC CONTROL STANDARDS OR ITEMS.

LEGEND

-  WORK AREA
-  LANE OPEN TO TRAFFIC
-  TYPE I OR II BARRICADE WITH STEADY BURN LIGHT
-  DRUM WITH STEADY BURN LIGHT
-  DRUM WITH SIGN (WITH OPTIONAL FLASHING LIGHT) SEE DETAIL
-  TYPE I OR II CHECK BARRICADE WITH FLASHING LIGHT

All dimensions are in millimeters (inches) unless otherwise shown.

ILLINOIS DEPARTMENT OF TRANSPORTATION  
TRAFFIC CONTROL AND PROTECTION  
AT TURN BAYS  
(TO REMAIN OPEN TO TRAFFIC)

REVISIONS	
NAME	DATE
T. RAMMACHER	09/08/94
A. HOUSEH	11/07/95
A. HOUSEH	10/12/96
T. RAMMACHER	01/06/00

SCALE: NONE  
DATE: 10/18/2002

DRAWN BY  
CHECKED BY: LHA  
TC-14

REVISION DATE: 01/06/00

F.A.R. RTE.	SECTION	COUNTY	TOTAL SHEETS	SHEET NO.
326	*	KANE	17	15
STA.	TO STA.			
FED. ROAD DIST. NO.	ILLINOIS FED. AID PROJECT			

#2006-014 CRC-PP

RESTORATION OF WORK AREA. RESTORATION OF THE TRAFFIC SIGNAL WORK AREA SHALL BE INCIDENTAL TO THE RELATED PAY ITEM SUCH AS FOUNDATION, CONDUIT, HANDHOLE, TRENCH AND BACKFILL, ETC., AND NO EXTRA COMPENSATION SHALL BE ALLOWED. ALL ROADWAY SURFACES SUCH AS SHOULDERS, MEDIAN, SIDEWALKS, PAVEMENT, ETC. SHALL BE REPLACED IN KIND. ALL DAMAGE TO MOWED LAWNS SHALL BE REPLACED WITH AN APPROVED SOD, AND ALL DAMAGE TO UNMOWED FIELDS SHALL BE SEEDED IN ACCORDANCE WITH STANDARD SPECIFICATIONS 252 AND 250 RESPECTIVELY.

NOTE:  
THE EXISTING AND/OR PROPOSED TRAFFIC SIGNAL EQUIPMENT SHALL BE REPAINTED IN (DULL) MATTE BLACK PAINT IN ACCORDANCE WITH SECTION 851 OF THE STANDARD SPECIFICATIONS. THIS SHALL INCLUDE THE SIGNAL HOUSINGS, SIGNAL POSTS (INCLUDING BRIGHT ALUMINUM POSTS AND MAST ARMS) AND BRACKETS.

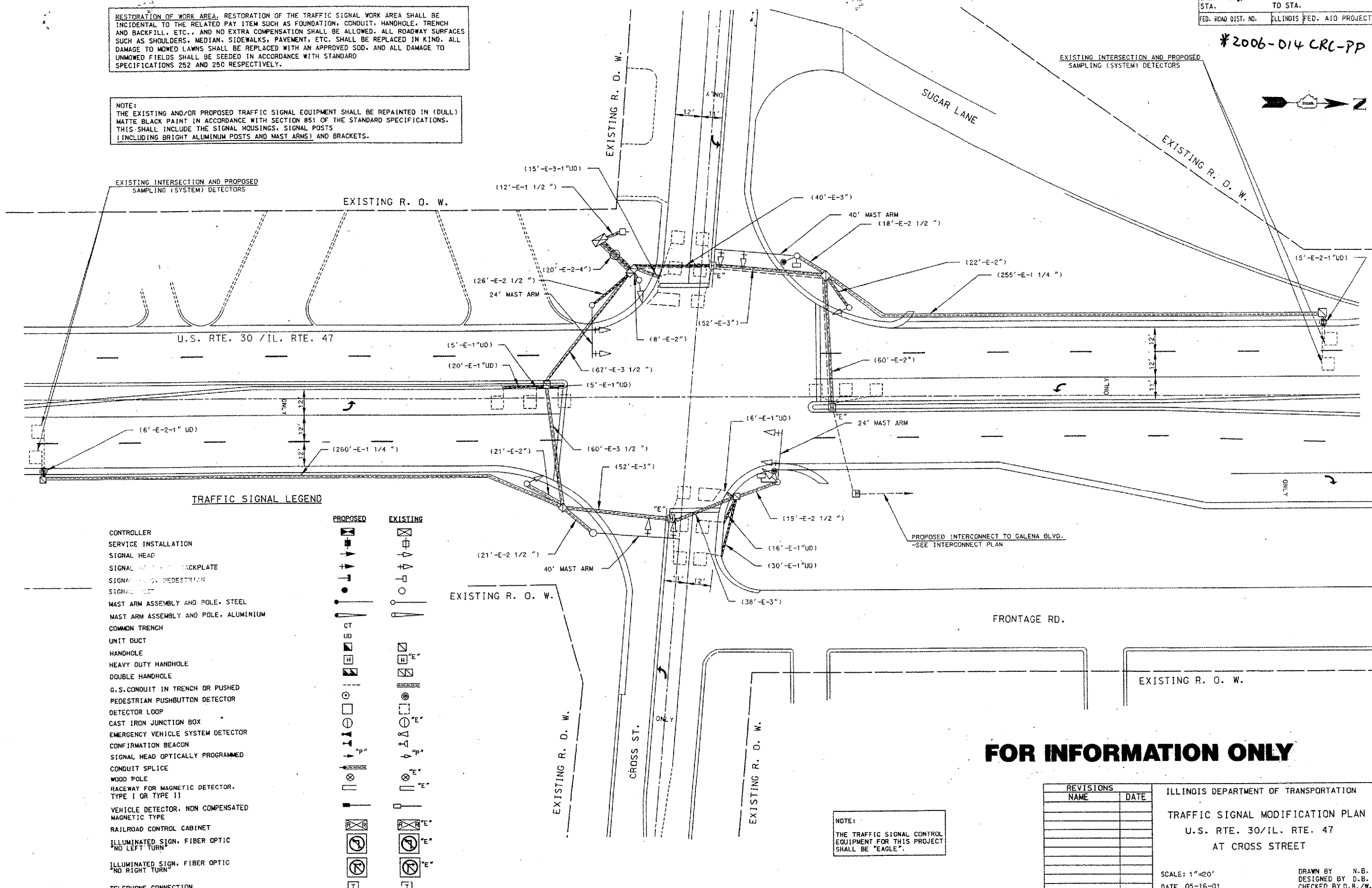

**TRAFFIC SIGNAL LEGEND**

	PROPOSED	EXISTING
CONTROLLER	[Symbol]	[Symbol]
SERVICE INSTALLATION	[Symbol]	[Symbol]
SIGNAL HEAD	[Symbol]	[Symbol]
SIGNAL HEAD BACKPLATE	[Symbol]	[Symbol]
SIGNAL HEAD PEDESTRIAN	[Symbol]	[Symbol]
SIGNAL POST	[Symbol]	[Symbol]
MAST ARM ASSEMBLY AND POLE, STEEL	[Symbol]	[Symbol]
MAST ARM ASSEMBLY AND POLE, ALUMINIUM	[Symbol]	[Symbol]
COMMON TRENCH	[Symbol]	[Symbol]
UNIT DUCT	[Symbol]	[Symbol]
HANDHOLE	[Symbol]	[Symbol]
HEAVY DUTY HANDHOLE	[Symbol]	[Symbol]
DOUBLE HANDHOLE	[Symbol]	[Symbol]
G.S. CONDUIT IN TRENCH OR PUSHED	[Symbol]	[Symbol]
PEDESTRIAN PUSHBUTTON DETECTOR	[Symbol]	[Symbol]
DETECTOR LOOP	[Symbol]	[Symbol]
CAST IRON JUNCTION BOX	[Symbol]	[Symbol]
EMERGENCY VEHICLE SYSTEM DETECTOR	[Symbol]	[Symbol]
CONFIRMATION BEACON	[Symbol]	[Symbol]
SIGNAL HEAD OPTICALLY PROGRAMMED	[Symbol]	[Symbol]
CONDUIT SPLICE	[Symbol]	[Symbol]
WOOD POLE	[Symbol]	[Symbol]
RACEWAY FOR MAGNETIC DETECTOR, TYPE I OR TYPE II	[Symbol]	[Symbol]
VEHICLE DETECTOR, NON COMPENSATED MAGNETIC TYPE	[Symbol]	[Symbol]
RAILROAD CONTROL CABINET	[Symbol]	[Symbol]
ILLUMINATED SIGN, FIBER OPTIC "NO LEFT TURN"	[Symbol]	[Symbol]
ILLUMINATED SIGN, FIBER OPTIC "NO RIGHT TURN"	[Symbol]	[Symbol]
TELEPHONE CONNECTION	[Symbol]	[Symbol]

**FOR INFORMATION ONLY**

REVISIONS	
NAME	DATE

ILLINOIS DEPARTMENT OF TRANSPORTATION  
**TRAFFIC SIGNAL MODIFICATION PLAN**  
 U.S. RTE. 30/IL. RTE. 47  
 AT CROSS STREET

SCALE: 1"=20'  
 DATE 05-16-01

DRAWN BY N.B.  
 DESIGNED BY D.B.  
 CHECKED BY D.B./W.M.

NOTE:  
THE TRAFFIC SIGNAL CONTROL EQUIPMENT FOR THIS PROJECT SHALL BE "EAGLE".

F.A.P. RTE.	SECTION	COUNTY	TOTAL SHEET SHEETS NO.
326	*	KANE	17 16
STA.	TO STA.		
FED. ROAD DIST. NO.	ILLINOIS	FED. AID PROJECT	

#2006-014 LRC-PP

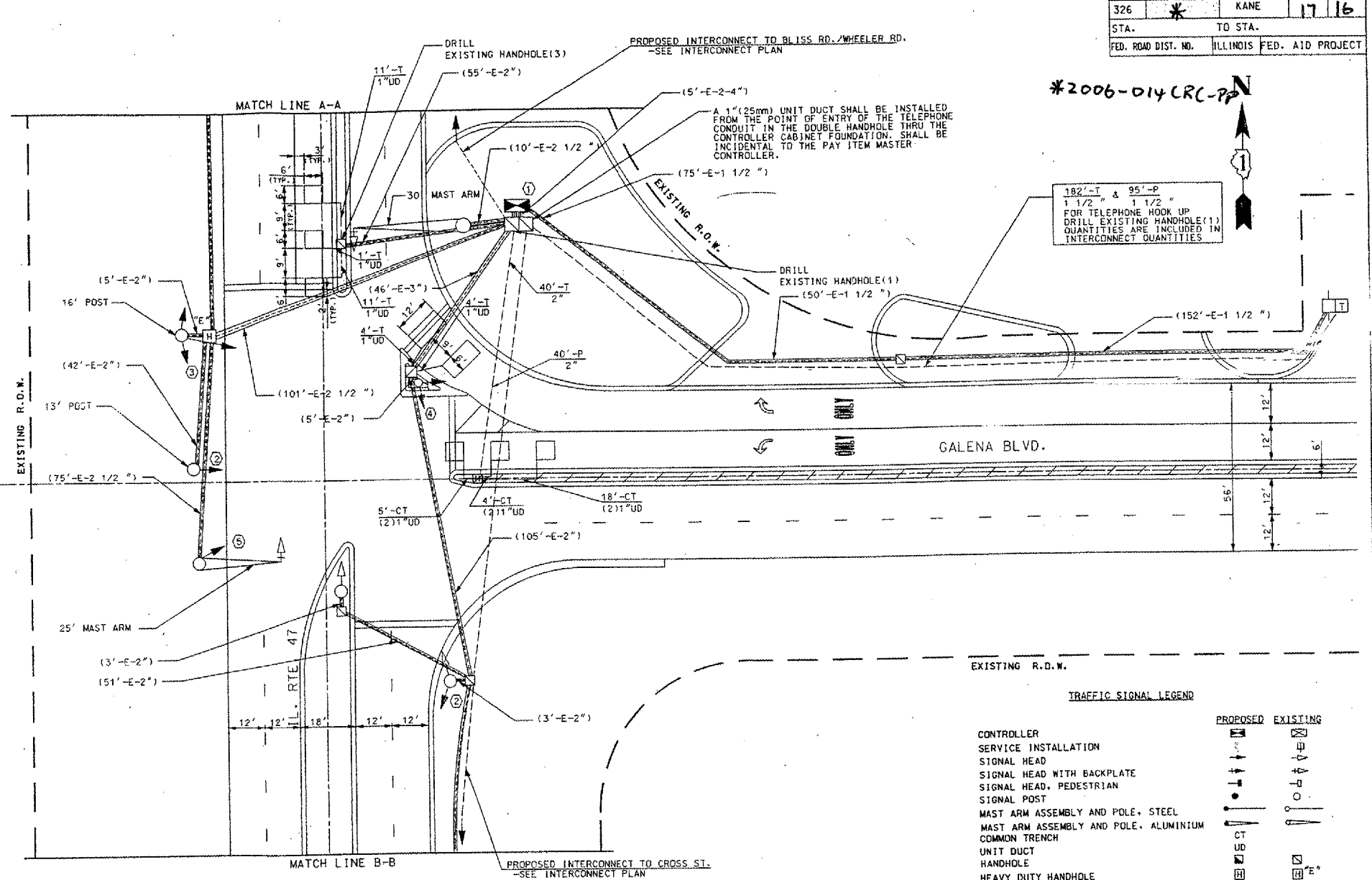
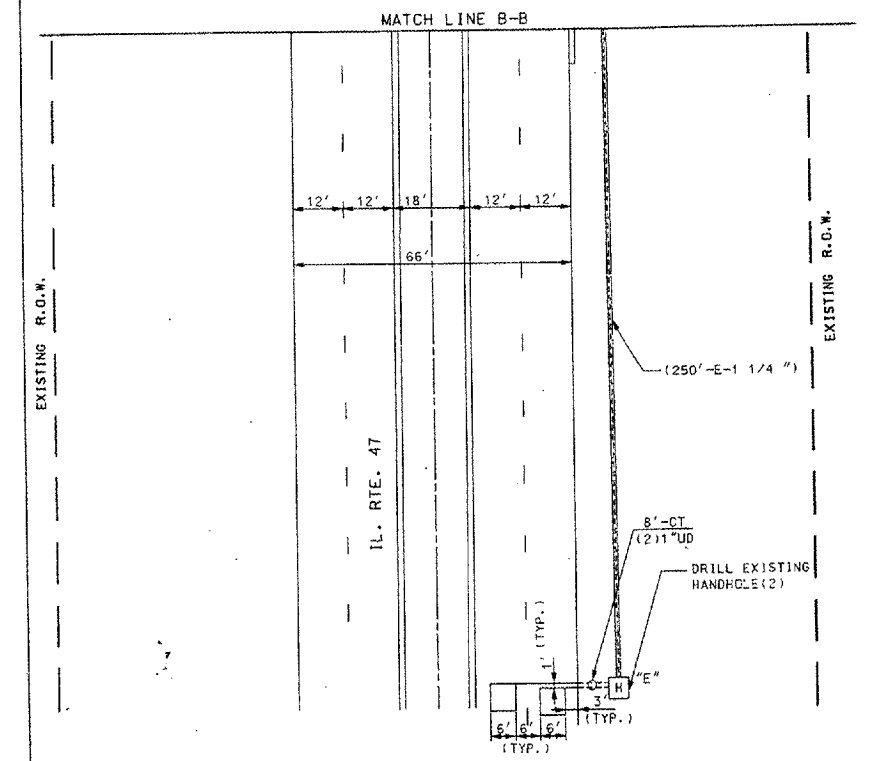
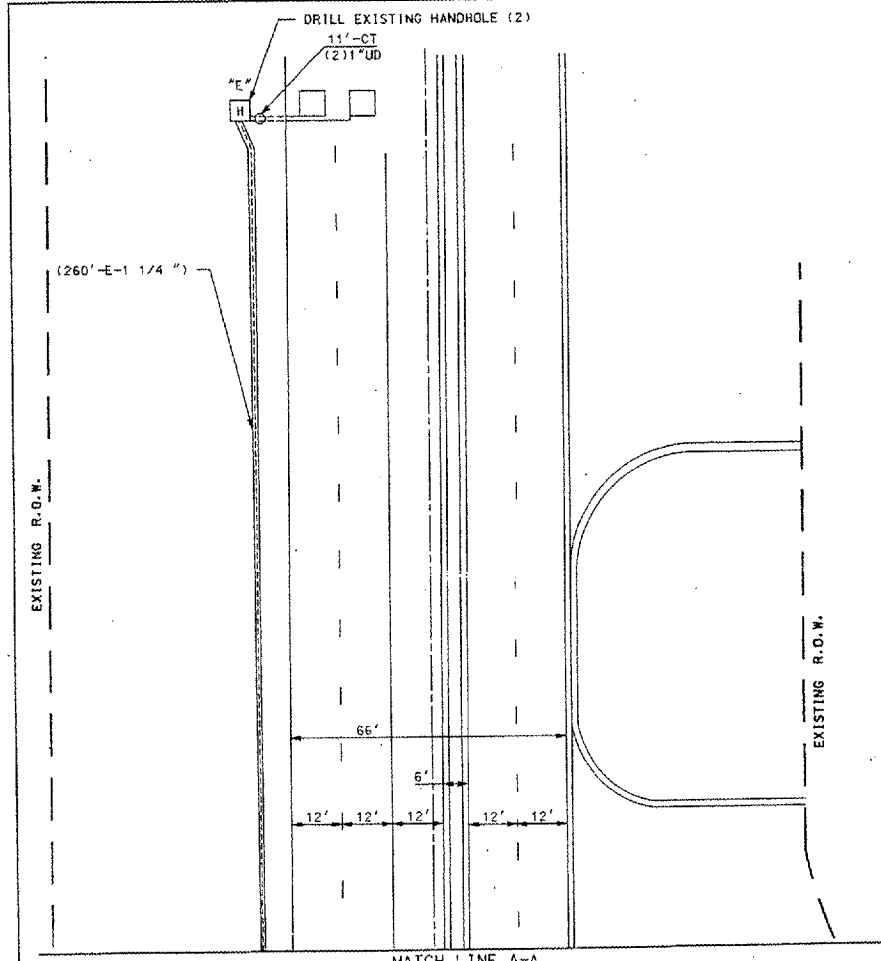
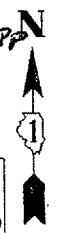

TRAFFIC SIGNAL LEGEND

PROPOSED	EXISTING

THE FOLLOWING EXISTING TRAFFIC SIGNAL EQUIPMENT SHALL BE REMOVED BY THE CONTRACTOR. SHALL REMAIN THE PROPERTY OF THE STATE AND SHALL BE DELIVERED BY THE CONTRACTOR TO THE STATE'S TRAFFIC SIGNAL MAINTENANCE CONTRACTOR'S MAIN FACILITY AS PER THE TRAFFIC SIGNAL SPECIFICATIONS.

- 1 EACH CONTROLLER AND CABINET (COMPLETE)
- THE FOLLOWING ITEMS SHALL BE REMOVED BY THE CONTRACTOR AND SHALL BE DISPOSED OF BY THEM OUT SIDE THE RIGHT-OF-WAY AT THEIR EXPENSE. THE SALVAGE VALUE OF THE REMOVED EQUIPMENT SHALL BE REFLECTED IN THE CONTRACT BID PRICE.
- 2 EACH SIGNAL HEAD, 1-FACE, 3-SECTION
- 1 EACH SIGNAL HEAD, 2-FACE, 1-3 SECTION, 1-5 SECTION
- 1 EACH SIGNAL HEAD, 3-FACE, 2-3 SECTION, 1-5 SECTION

CONSTRUCTION NOTES:

- 1 REMOVE EXISTING CONTROLLER AND CABINET. INSTALL NEW (EAGLE) MASTER CONTROLLER, LOCAL CONTROLLER AND CABINET.
- 2 REMOVE EXISTING SIGNAL HEAD, 1-FACE, 3-SECTION, BRACKET MOUNTED. INSTALL NEW SIGNAL HEAD, 1-FACE, 3-SECTION, BRACKET MOUNTED, RE-USE EXISTING CABLE.
- 3 REMOVE EXISTING SIGNAL HEAD, 3-FACE, 2-3 SECTION, 1-5 SECTION, BRACKET MOUNTED. INSTALL NEW SIGNAL HEAD, 3-FACE, 3-SECTION, BRACKET MOUNTED, RE-USE EXISTING CABLE.
- 4 REMOVE EXISTING SIGNAL HEAD, 2-FACE, 1-3 SECTION, 1-5 SECTION, BRACKET MOUNTED. INSTALL NEW SIGNAL HEAD, 2-FACE, 3-SECTION, BRACKET MOUNTED, RE-USE EXISTING CABLE.
- 5 INSTALL NEW SIGNAL HEAD, 1-FACE, 3-SECTION, BRACKET MOUNTED AND NEW 5/C CABLE.

RESTORATION OF WORK AREA. RESTORATION OF THE TRAFFIC SIGNAL WORK AREA SHALL BE INCIDENTAL TO THE RELATED PAY ITEM SUCH AS FOUNDATION, CONDUIT, HANDHOLE, TRENCH AND BACKFILL, ETC., AND NO EXTRA COMPENSATION SHALL BE ALLOWED. ALL ROADWAY SURFACES SUCH AS SHOULDERS, MEDIAN, SIDEWALKS, PAVEMENT, ETC. SHALL BE REPLACED IN KIND. ALL DAMAGE TO MOWED LAWNS SHALL BE REPLACED WITH AN APPROVED SOD, AND ALL DAMAGE TO UNMOWED FIELDS SHALL BE SEEDED IN ACCORDANCE WITH STANDARD SPECIFICATIONS 252 AND 250 RESPECTIVELY.

NOTE: THE EXISTING AND/OR PROPOSED TRAFFIC SIGNAL EQUIPMENT SHALL BE REPAINTED IN (DULL) MATTE BLACK PAINT IN ACCORDANCE WITH SECTION 851 OF THE STANDARD SPECIFICATIONS. THIS SHALL INCLUDE THE SIGNAL HOUSINGS, SIGNAL POSTS (INCLUDING BRIGHT ALUMINUM POSTS AND MAST ARMS) AND BRACKETS.

**FOR INFORMATION ONLY**

REVISIONS	
NAME	DATE

ILLINOIS DEPARTMENT OF TRANSPORTATION  
 TRAFFIC SIGNAL MODIFICATION PLAN  
 IL. RTE. 47  
 AT GALENA BLVD.  
 SCALE: 1"=20'  
 DATE 05-16-01  
 DRAWN BY N.B.  
 DESIGNED BY D.B.  
 CHECKED BY D.B./W.M.



F.A.R. RTE.	SECTION	COUNTY	TOTAL SHEET NO.
326	*	KANE	17 17
STA.	TO STA.		
FED. ROAD DIST. NO.	ILLINOIS FED. AID PROJECT		

EXISTING INTERSECTION AND PROPOSED SAMPLING (SYSTEM) DETECTORS  
 #2006-D14CRC-PP

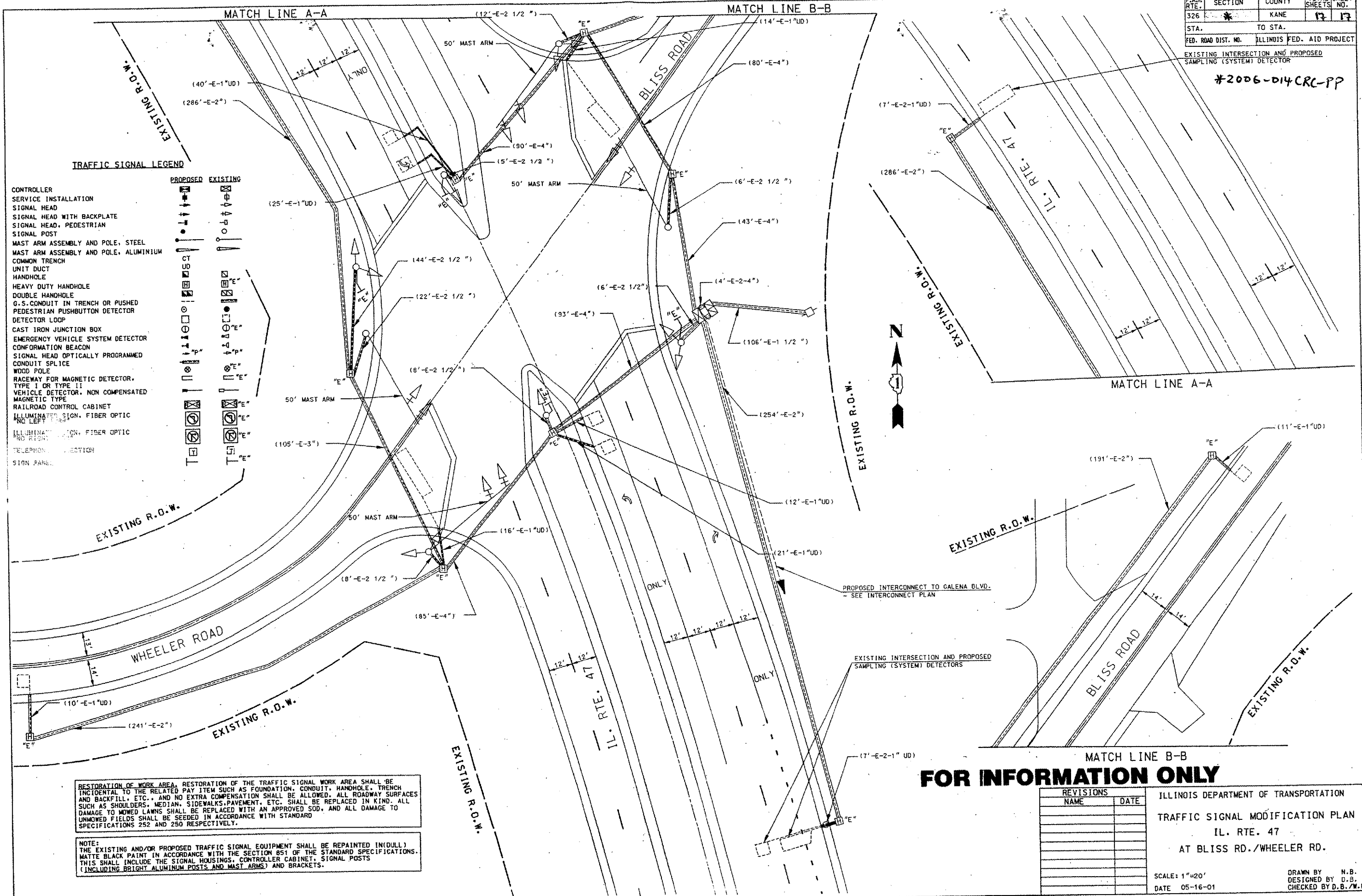

**TRAFFIC SIGNAL LEGEND**

CONTROLLER	PROPOSED	EXISTING
SERVICE INSTALLATION	[Symbol]	[Symbol]
SIGNAL HEAD	[Symbol]	[Symbol]
SIGNAL HEAD WITH BACKPLATE	[Symbol]	[Symbol]
SIGNAL HEAD, PEDESTRIAN	[Symbol]	[Symbol]
SIGNAL POST	[Symbol]	[Symbol]
MAST ARM ASSEMBLY AND POLE, STEEL	[Symbol]	[Symbol]
MAST ARM ASSEMBLY AND POLE, ALUMINIUM	[Symbol]	[Symbol]
COMMON TRENCH	[Symbol]	[Symbol]
UNIT DUCT	[Symbol]	[Symbol]
HANDHOLE	[Symbol]	[Symbol]
HEAVY DUTY HANDHOLE	[Symbol]	[Symbol]
DOUBLE HANDHOLE	[Symbol]	[Symbol]
G.S. CONDUIT IN TRENCH OR PUSHED	[Symbol]	[Symbol]
PEDESTRIAN PUSHBUTTON DETECTOR	[Symbol]	[Symbol]
DETECTOR LOOP	[Symbol]	[Symbol]
CAST IRON JUNCTION BOX	[Symbol]	[Symbol]
EMERGENCY VEHICLE SYSTEM DETECTOR	[Symbol]	[Symbol]
CONFORMATION BEACON	[Symbol]	[Symbol]
SIGNAL HEAD OPTICALLY PROGRAMMED	[Symbol]	[Symbol]
CONDUIT SPLICE	[Symbol]	[Symbol]
WOOD POLE	[Symbol]	[Symbol]
RACEWAY FOR MAGNETIC DETECTOR, TYPE I OR TYPE II	[Symbol]	[Symbol]
VEHICLE DETECTOR, NON COMPENSATED MAGNETIC TYPE	[Symbol]	[Symbol]
RAILROAD CONTROL CABINET	[Symbol]	[Symbol]
ILLUMINATED SIGN, FIBER OPTIC NO LEFT TURN	[Symbol]	[Symbol]
ILLUMINATED SIGN, FIBER OPTIC NO RIGHT TURN	[Symbol]	[Symbol]
TELEPHONE CONNECTION	[Symbol]	[Symbol]
SIGN PANEL	[Symbol]	[Symbol]

RESTORATION OF WORK AREA, RESTORATION OF THE TRAFFIC SIGNAL WORK AREA SHALL BE INCIDENTAL TO THE RELATED PAY ITEM SUCH AS FOUNDATION, CONDUIT, HANDHOLE, TRENCH AND BACKFILL, ETC., AND NO EXTRA COMPENSATION SHALL BE ALLOWED. ALL ROADWAY SURFACES SUCH AS SHOULDERS, MEDIAN, SIDEWALKS, PAVEMENT, ETC. SHALL BE REPLACED IN KIND. ALL DAMAGE TO MOWED LAWNS SHALL BE REPLACED WITH AN APPROVED SOD, AND ALL DAMAGE TO UNMOWED FIELDS SHALL BE SEEDED IN ACCORDANCE WITH STANDARD SPECIFICATIONS 252 AND 250 RESPECTIVELY.

**NOTE:**  
 THE EXISTING AND/OR PROPOSED TRAFFIC SIGNAL EQUIPMENT SHALL BE REPAINTED (IN DULL) MATTE BLACK PAINT IN ACCORDANCE WITH THE SECTION 851 OF THE STANDARD SPECIFICATIONS. THIS SHALL INCLUDE THE SIGNAL HOUSINGS, CONTROLLER CABINET, SIGNAL POSTS (INCLUDING BRIGHT ALUMINIUM POSTS AND MAST ARMS) AND BRACKETS.

**FOR INFORMATION ONLY**

REVISIONS	
NAME	DATE

ILLINOIS DEPARTMENT OF TRANSPORTATION  
 TRAFFIC SIGNAL MODIFICATION PLAN  
 IL. RTE. 47  
 AT BLISS RD./WHEELER RD.

SCALE: 1"=20'  
 DATE 05-16-01

DRAWN BY N.B.  
 DESIGNED BY D.B.  
 CHECKED BY D.B./W.M.