

F.A.I. RTE.	SECTION	COUNTY	TOTAL SHEETS	SHEET NO.
90/94		COOK	588	321
STA. 1506+50.00 TO STA. 1518+00.00				
FED. ROAD DIST. NO. 1 ILLINOIS FED. AID PROJECT				
62303 • (2021-922 PT2 ETC 2324.6-1P) R-11				

NOTES:

- SEE DRAWINGS EI-100 AND EI-101 FOR ELECTRICAL SYMBOLS AND ABBREVIATIONS.
- THE CONTRACTOR SHALL LOCATE THE EXISTING 3" RGS CONDUIT STUB-OUT INSTALLED IN IDOT CONTRACT NO. 62302 AND CONNECT THE PROPOSED CONDUIT.
- EXTEND 3" CNC CONDUIT 5' PAST CURB AND CAP FOR FUTURE USE.
- EXTEND CONDUIT STUB-OUT 2' BEYOND THE SIGN STRUCTURE FOUNDATION. CAP FOR FUTURE USE.
- UNLESS NOTED OTHERWISE, ALL ITEMS AND WORK SHOWN IN HEAVY LINE WEIGHT ON THIS DRAWING ARE PROPOSED NEW ITEMS AND WORK.

P:\040468\elect\NB-cntrs IB & 19\contract 19\STV190362.dwg

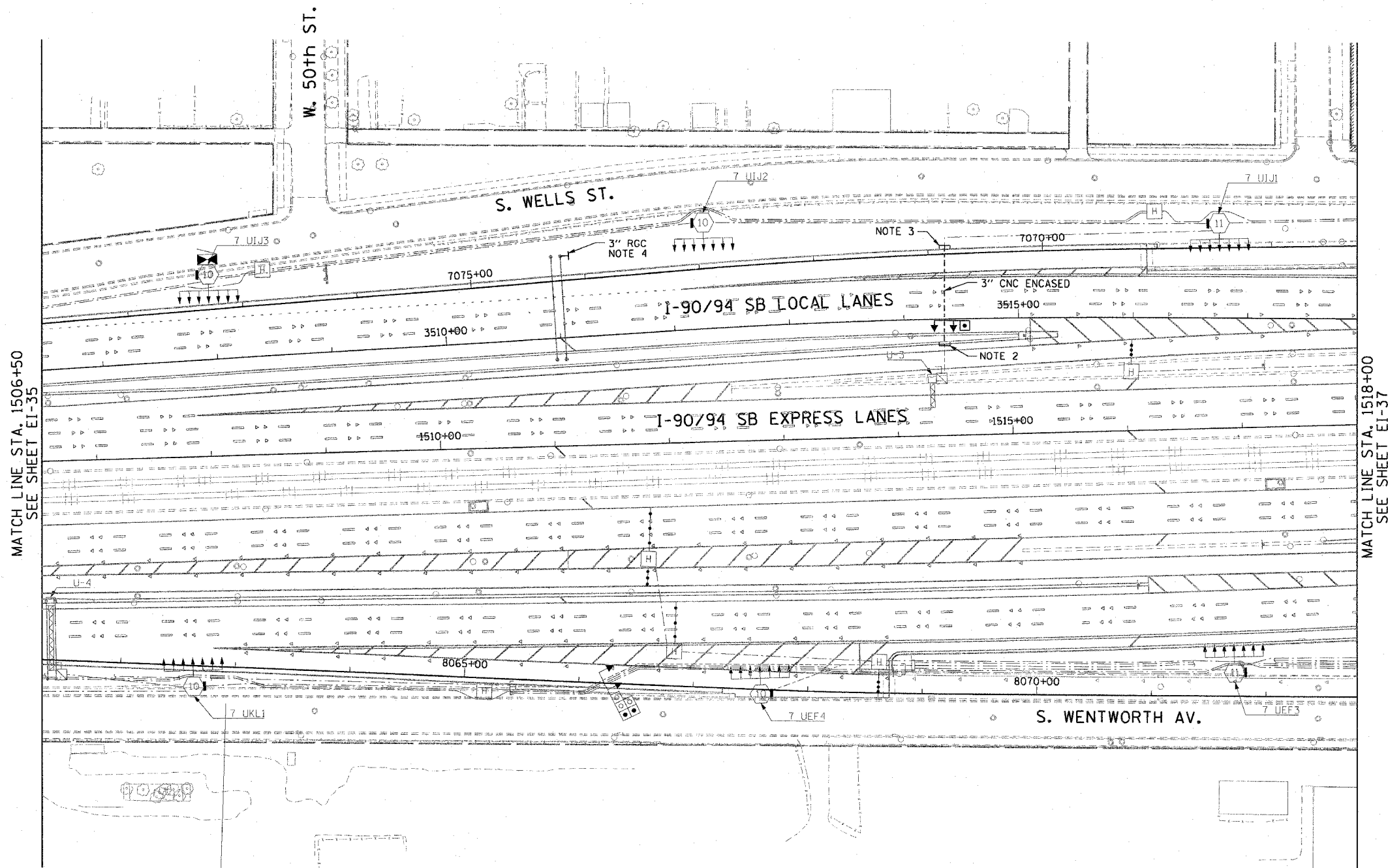
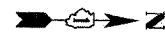

MATCH LINE STA. 1506+50
SEE SHEET EI-35

MATCH LINE STA. 1518+00
SEE SHEET EI-37

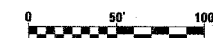

EI-36

REVISIONS	
NAME	DATE

ILLINOIS DEPARTMENT OF TRANSPORTATION
F.A.I. 90/94 (DAN RYAN EXPRESSWAY)
GARFIELD BLVD TO 31ST STREET (SB LOCAL LANES)
ELECTRICAL INFRASTRUCTURE PLAN

SCALE: 1"=50'
DATE: June 9, 2006
DRAWN BY: HAR
CHECKED BY: JPC

CTE | AECOM

06/09/2006 09:55:12 AM