

FOR INDEX OF SHEETS AND HIGHWAY
STANDARDS, SEE SHEET 2.

STATE OF ILLINOIS
DEPARTMENT OF TRANSPORTATION
DIVISION OF HIGHWAYS
**PLANS FOR PROPOSED
CONTRACT MAINTENANCE**
FAP ROUTE 612 (IL 100)
SECTION 112I-2
SCHUYLER COUNTY
C96-007-07 / D96-021-06

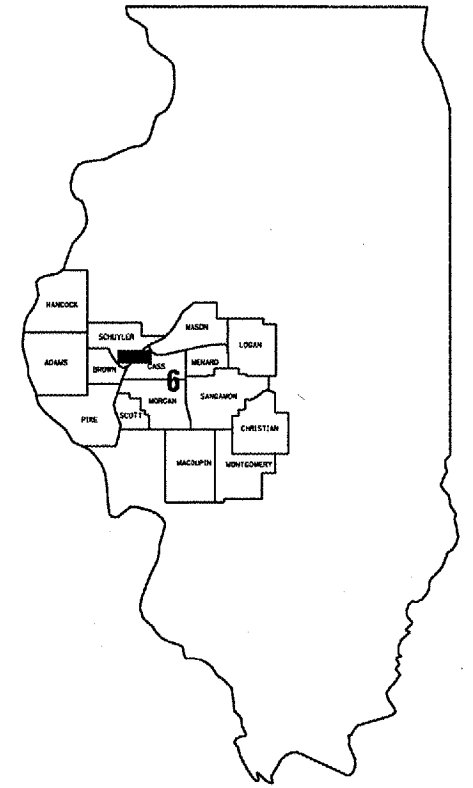

LOCATION OF SECTION INDICATED THUS: ■

PROJECT LOCATION
STA. 205 + 40

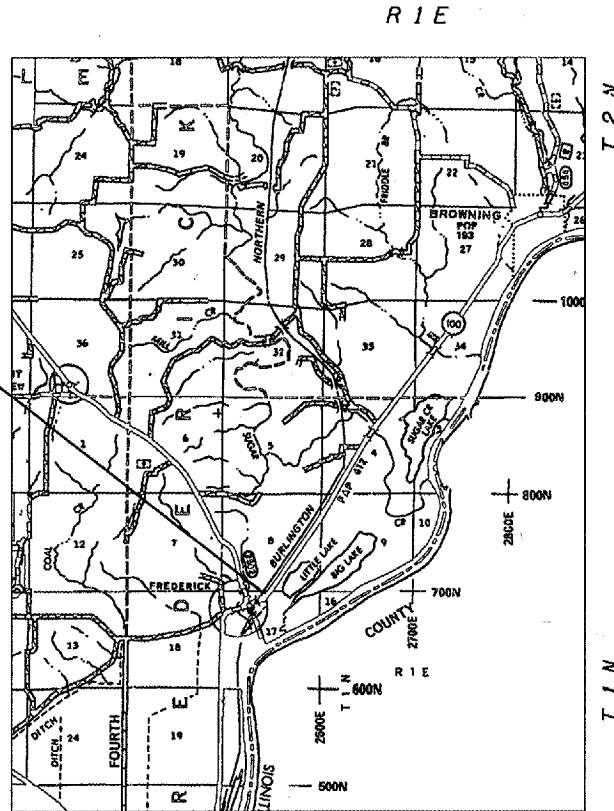

J. U. L. I. E.
JOINT UTILITY LOCATION INFORMATION FOR EXCAVATION
1-800-892-0123

PLANS & CONTRACT TECHNICIAN: TIMOTHY SHARP
PHONE: (217) 782-7743

NET LTH OF SEC

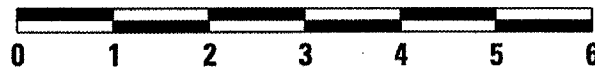

SCALE: 1" = 2 MILES

CONTRACT NO. 72A49

STATE OF ILLINOIS
DEPARTMENT OF TRANSPORTATION
DIVISION OF HIGHWAYS

SUBMITTED JUNE 20 2006
Chris M. Reed
DEPUTY DIRECTOR OF HIGHWAYS, REGION FOUR ENGINEER

August 18, 20 06
Mike Hine
ENGINEER OF DESIGN AND ENVIRONMENT

August 18, 20 06
Milton R. See P.E.
DIRECTOR, DIVISION OF HIGHWAYS