

FAU	SECTION	COUNTY	TOTAL SHEETS	SHEET NO.
2647	99-00142-07-WR	LAKE	256	18
CONTRACT NO: 83815				
FED. ROAD DIST. NO. 1 ILLINOIS FED. AID PROJECT				

Exist. Curve EB1  
 PI Sta. 109+72.10  
 $\Delta = 47^\circ 33' 19''$  (LT)  
 $D = 5^\circ 41' 52''$   
 $T = 443.05'$   
 $R = 1,005.60'$   
 $L = 834.64'$   
 $E = 93.28'$   
 PC Sta. 105+29.04  
 PT Sta. 113+63.69

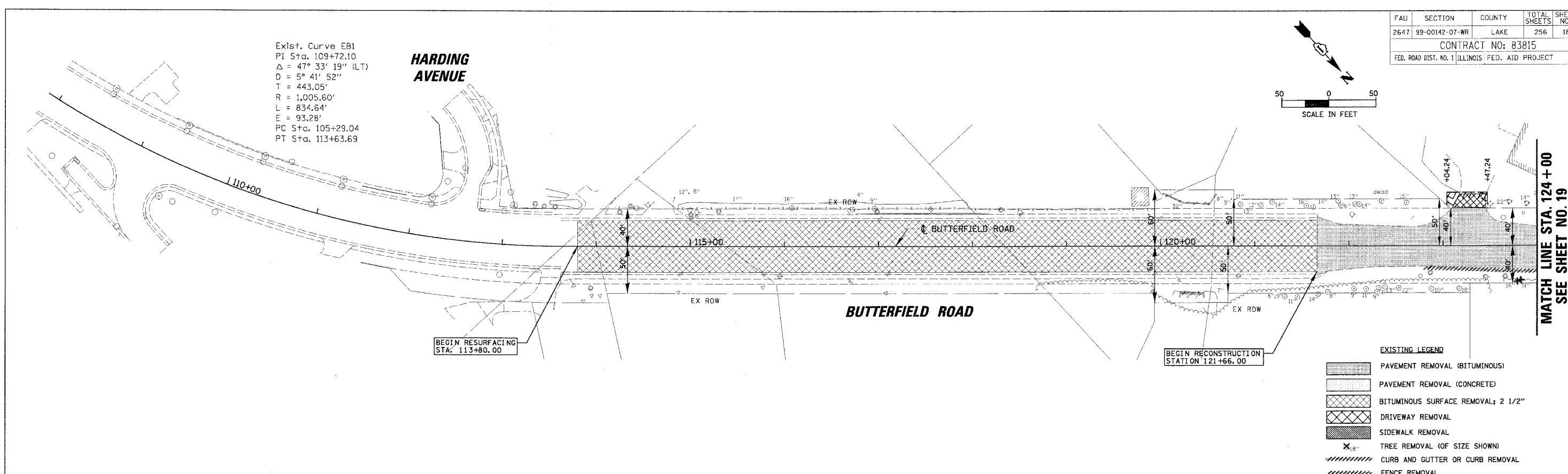
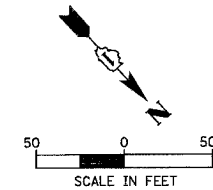

**EXISTING CONDITIONS**

- EXISTING LEGEND**
- PAVEMENT REMOVAL (BITUMINOUS)
  - PAVEMENT REMOVAL (CONCRETE)
  - BITUMINOUS SURFACE REMOVAL; 2 1/2"
  - DRIVEWAY REMOVAL
  - SIDEWALK REMOVAL
  - TREE REMOVAL (OF SIZE SHOWN)
  - CURB AND GUTTER OR CURB REMOVAL
  - FENCE REMOVAL

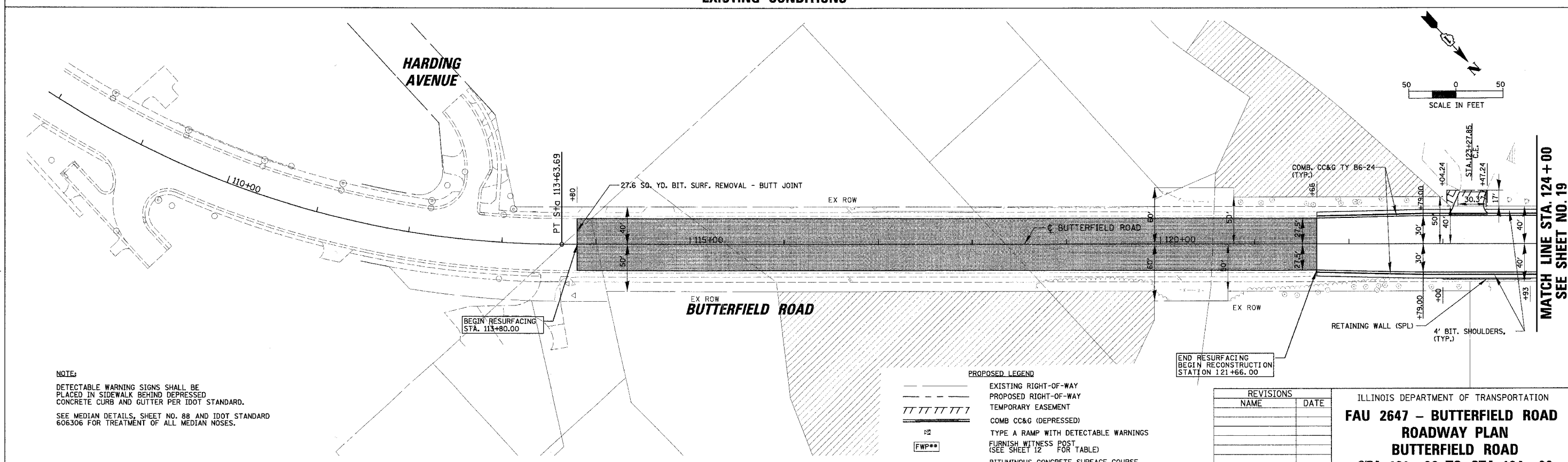

**PROPOSED CONDITIONS**

- PROPOSED LEGEND**
- EXISTING RIGHT-OF-WAY
  - PROPOSED RIGHT-OF-WAY
  - TEMPORARY EASEMENT
  - COMB CC&G (DEPRESSED)
  - TYPE A RAMP WITH DETECTABLE WARNINGS
  - FURNISH WITNESS POST (SEE SHEET 12 FOR TABLE)
  - BITUMINOUS CONCRETE SURFACE COURSE, SUPERPAVE, MIX "D", N70; 1 3/4" POLYMERIZED LEVELING BINDER (MACHINE METHOD), SUPERPAVE, IL-4.75, N50; 1 3/4"

REVISIONS	
NAME	DATE

ILLINOIS DEPARTMENT OF TRANSPORTATION  
**FAU 2647 - BUTTERFIELD ROAD**  
**ROADWAY PLAN**  
**BUTTERFIELD ROAD**  
**STA. 121+66 TO STA. 124+00**  
 SCALE: 1:50  
 DATE: 12/2/2005  
 DRAWN BY: ELA, PMM  
 CHECKED BY: BLL

**NOTE:**  
 DETECTABLE WARNING SIGNS SHALL BE PLACED IN SIDEWALK BEHIND DEPRESSED CONCRETE CURB AND GUTTER PER IDOT STANDARD. SEE MEDIAN DETAILS, SHEET NO. 88 AND IDOT STANDARD 606306 FOR TREATMENT OF ALL MEDIAN NOSES.

N:\LIBERTYVILLE\99-389\CIVIL\99389.TBL  
 N:\LIBERTYVILLE\99-389\CIVIL\99389\_01.plt  
 1150  
 12/2/2005

MATCH LINE STA. 124+00  
 SEE SHEET NO. 19

MATCH LINE STA. 124+00  
 SEE SHEET NO. 19