

STR NO.	STATION	OFFSET	STRUCTURE TYPE	RIM	N INV.	NE INV.	E INV.	SE INV.	S INV.	SW INV.	W INV.	NW INV.
S300	138+00.00	30' RT	CB TA 4 DIA T24F&G	740.79	-	-	736.03	-	-	-	740.50	740.60
S301	138+48.00	36.5' RT	RD MAN 4 DIA T1F CL	744.46	-	-	-	740.40	-	-	-	-
S302	139+50.00	30' RT	CB TC 4 DIA T24F&G	742.79	-	-	740.57	-	-	-	-	-
S303	140+73.00	36.5' RT	RD MAN 4 DIA T1F CL	746.43	-	-	-	742.06	-	-	742.10	-
S304	140+75.00	30' RT	CB TC 4 DIA T24F&G	745.62	-	-	742.13	-	-	-	-	-
S305	143+50.00	30' RT	CB TA 4 DIA T24F&G	746.22	-	-	742.10	-	-	-	-	-
S306	143+52.00	36.5' RT	RD MAN 4 DIA T1F CL	746.82	741.90	-	-	-	-	-	742.03	-
S307	144+52.00	36.5' RT	RD MAN 4 DIA T1F CL	745.71	741.30	-	-	-	741.40	-	-	741.40
S308	144+50.00	30' RT	CB TC 4 DIA T24F&G	745.12	-	-	741.43	-	-	-	-	-
S309	145+52.00	36.5' RT	RD MAN 4 DIA T1F CL	744.51	740.05	-	-	-	740.15	-	-	740.05
S310	145+50.00	30' RT	CB TC 4 DIA T24F&G	743.93	-	-	740.08	-	-	-	-	-
S311	146+52.00	36.5' RT	RD MAN 4 DIA T1F CL	743.32	739.45	-	-	-	739.55	-	-	739.52
S312	146+50.00	30' RT	CB TC 4 DIA T24F&G	742.73	-	-	739.55	-	-	-	-	-
S313	147+52.00	36.5' RT	RD MAN 4 DIA T1F CL	742.25	737.76	-	-	-	739.05	-	-	739.05
S314	147+50.00	30' RT	CB TC 4 DIA T24F&G	741.06	-	-	739.08	-	-	-	-	-
S315	148+15.00	43.18' RT	RD MAN 4 DIA T1F CL	740.28	737.40	-	-	-	737.50	-	-	737.50
S316	148+15.00	30' RT	CB TC 4 DIA T24F&G	741.21	-	-	737.59	-	-	-	-	-
S317	148+90.00	48' RT	RD MAN 5 DIA T1F CL	741.22	736.60	737.15	-	-	737.10	-	-	737.15
S318	148+90.00	40.4' RT	RD CB 4 DIA T24F&G	740.22	-	-	737.19	-	-	-	-	737.25
S319	149+00.00	44' LT	INLETS TA T8G	740.25	-	-	737.59	-	-	-	-	-
S320	149+00.00	59' RT	CB TC T6G	740.34	-	-	-	-	-	737.27	-	-
S321	150+02.00	36.5' RT	RD MAN 4 DIA T1F CL	740.89	736.00	-	-	-	736.05	-	-	736.10
S322	150+00.00	30' RT	RD CB 4 DIA T24F&G	740.04	-	-	736.13	-	-	-	-	736.15
S323	152+42.00	39' LT	INLETS TA T8G	738.20	-	-	738.20	735.46	-	-	-	-
S324	150+00.00	47' LT	INLETS TA T8G	739.00	-	-	736.91	-	-	-	-	-
S325	150+77.00	36.5' RT	RD MAN 4 DIA T1F CL	740.52	735.53	-	-	-	735.62	735.62	-	-
S326	150+75.00	30' RT	RD CB 4 DIA T24F&G	739.92	-	735.65	-	-	-	-	-	-
S327	151+52.00	36.5' RT	RD MAN 4 DIA T1F CL	740.14	735.10	-	-	-	735.15	-	-	735.60
S328	151+50.00	30' RT	RD CB 4 DIA T24F&G	739.73	-	-	735.63	-	-	-	-	-
S329	152+27.00	36.5' RT	MAN TA 4 DIA T1F CL	739.77	734.68	-	-	-	734.72	-	-	734.72
S330	152+25.00	30' RT	RD CB 4 DIA T24F&G	739.53	-	-	734.75	-	-	-	-	734.75

LEGEND

- [R] REMOVAL
- [RI] REMOVAL, BY OTHERS
- [A] ADJUST
- [AI] ADJUST, BY OTHERS
- [AB] ABANDON

NOTE: SEE SHEETS 75 TO 76 FOR DETAILS OF PROPOSED WATER MAIN AND APURTANENCES.

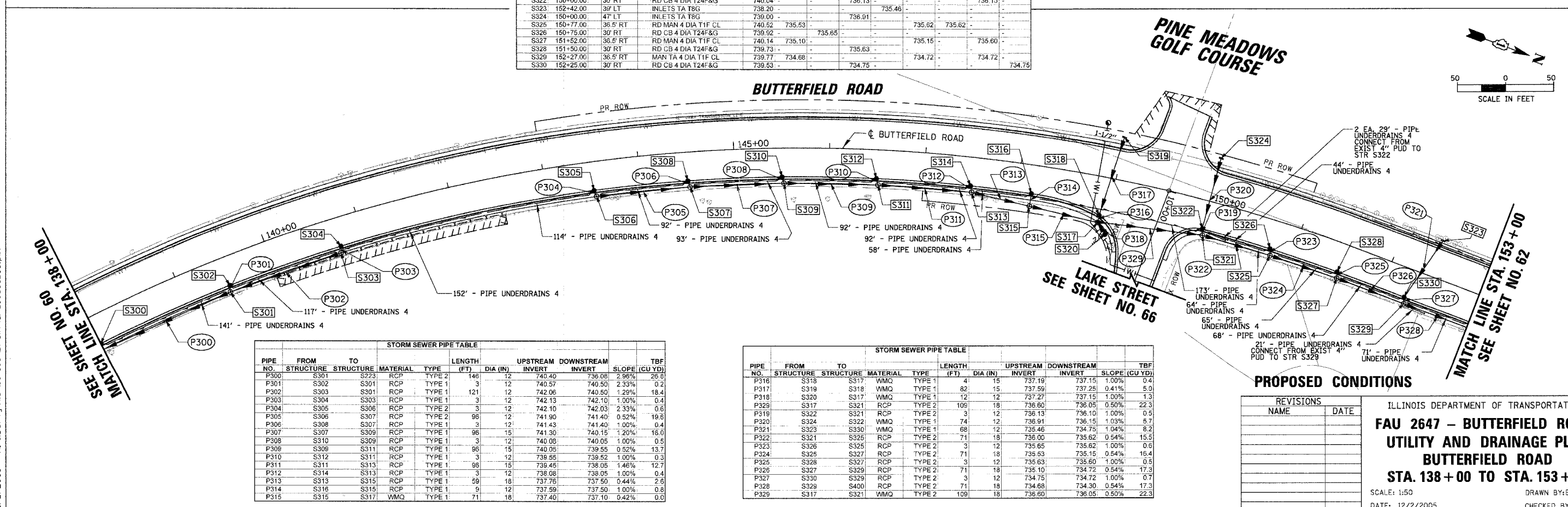

PIPE NO.	FROM STRUCTURE	TO STRUCTURE	MATERIAL	TYPE	LENGTH (FT)	DIA (IN)	UPSTREAM INVERT	DOWNSTREAM INVERT	SLOPE (CU YD)	TBF
P300	S300	S223	RCP	TYPE 2	148	12	740.40	736.08	2.96%	26.9
P301	S302	S301	RCP	TYPE 1	3	12	740.57	740.50	2.33%	0.2
P302	S303	S301	RCP	TYPE 1	121	12	742.06	740.80	2.29%	16.4
P303	S304	S303	RCP	TYPE 1	3	12	742.13	742.10	1.00%	0.4
P304	S305	S306	RCP	TYPE 2	3	12	742.10	742.03	2.33%	0.6
P305	S306	S307	RCP	TYPE 2	96	12	741.90	741.40	0.52%	19.6
P306	S308	S307	RCP	TYPE 1	3	12	741.43	741.40	1.00%	0.4
P307	S307	S309	RCP	TYPE 1	96	15	741.30	740.15	1.20%	16.0
P308	S310	S309	RCP	TYPE 1	3	12	740.08	740.05	1.00%	0.5
P309	S309	S311	RCP	TYPE 1	96	15	740.05	739.55	0.52%	13.7
P310	S312	S311	RCP	TYPE 1	3	12	739.55	739.52	1.00%	0.3
P311	S311	S313	RCP	TYPE 1	96	15	739.48	738.05	1.46%	12.7
P312	S314	S313	RCP	TYPE 1	3	12	738.08	738.05	1.00%	0.4
P313	S313	S315	RCP	TYPE 1	59	18	737.76	737.50	0.44%	2.6
P314	S316	S315	RCP	TYPE 1	9	12	737.59	737.50	1.00%	0.8
P315	S315	S317	VMQ	TYPE 1	71	18	737.40	737.10	0.42%	0.0

PIPE NO.	FROM STRUCTURE	TO STRUCTURE	MATERIAL	TYPE	LENGTH (FT)	DIA (IN)	UPSTREAM INVERT	DOWNSTREAM INVERT	SLOPE (CU YD)	TBF
P316	S318	S317	VMQ	TYPE 1	4	15	737.19	737.15	1.00%	0.4
P317	S319	S318	VMQ	TYPE 1	82	15	737.59	737.25	0.41%	5.0
P318	S320	S317	VMQ	TYPE 1	12	12	737.27	737.15	1.00%	1.3
P329	S317	S321	RCP	TYPE 2	109	18	736.60	736.05	0.50%	22.3
P319	S322	S321	RCP	TYPE 2	3	12	736.13	736.10	1.00%	0.5
P320	S322	S322	VMQ	TYPE 1	74	12	736.91	736.15	1.03%	9.7
P321	S323	S330	VMQ	TYPE 1	68	12	735.46	734.75	1.04%	8.2
P322	S321	S325	RCP	TYPE 2	71	18	736.00	735.62	0.54%	15.5
P323	S326	S325	RCP	TYPE 2	3	12	735.65	735.62	1.00%	0.6
P324	S325	S327	RCP	TYPE 2	71	18	735.53	735.15	0.54%	16.4
P325	S328	S327	RCP	TYPE 2	3	12	735.63	735.60	1.00%	0.5
P326	S327	S329	RCP	TYPE 2	71	18	735.10	734.72	0.54%	17.3
P327	S330	S329	RCP	TYPE 2	3	12	734.75	734.72	1.00%	0.7
P328	S328	S400	RCP	TYPE 2	71	18	734.68	734.30	0.54%	17.3
P329	S317	S321	VMQ	TYPE 2	109	18	736.60	736.05	0.50%	22.3

NAME	DATE

ILLINOIS DEPARTMENT OF TRANSPORTATION
**FAU 2647 - BUTTERFIELD ROAD
 UTILITY AND DRAINAGE PLAN
 BUTTERFIELD ROAD
 STA. 138 + 00 TO STA. 153 + 00**

SCALE: 1:50
 DATE: 12/2/2005
 DRAWN BY: ELA
 CHECKED BY: BLL