

FAU	SECTION	COUNTY	TOTAL SHEETS	SHEET NO.
2647	99-00142-07-WR	LAKE	256	64
CONTRACT NO: 83815				
FED. ROAD DIST. NO. 1 ILLINOIS FED. AID PROJECT				

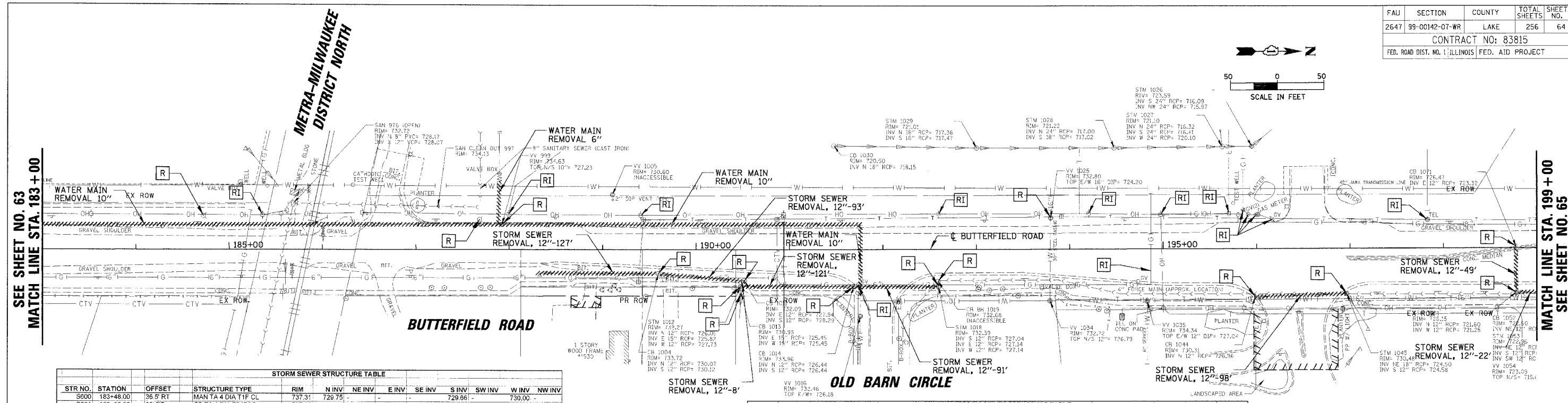

STR NO.	STATION	OFFSET	STRUCTURE TYPE	RIM	N INV	NE INV	E INV	SE INV	S INV	SW INV	W INV	NW INV
S600	183+48.00	36.5 RT	MAN TA 4 DIA T1F CL	737.31	729.75						730.00	
S601	183+50.00	30 RT	CB TA 4 DIA T24F&G	737.03			730.03		729.66			
S602	183+50.00	30 LT	CB TA 4 DIA T24F&G	737.03			730.66				730.10	
S603	184+00.00	48 LT	CB TC T8G	735.40				731.24				730.76
S604	184+40.00	36.5 RT	MAN TA 4 DIA T1F CL	735.96	730.20	730.50			730.20			
S605	184+50.00	41.08 RT	CB TC T8G	734.00						730.58		
S606	185+38.00	36.5 RT	RD MAN 4 DIA T1F CL	735.00				730.70			730.70	
S607	185+40.00	30 RT	RD CB 4 DIA T24F&G	734.73			730.73				730.75	
S608	185+50.00	30 LT	INLETS TA T24F&G	734.65			731.04					
S609	186+00.00	30 RT	INLETS TA T24F&G	734.47						730.56		
S610	186+20.00	30 LT	CB TA 4 DIA T24F&G	734.47								729.94
S611	186+30.00	38 LT	RD MAN 4 DIA T1F CL	734.28	729.71			729.81				
S612	187+00.00	30 RT	INLETS TA T24F&G	734.97						731.51		
S613	186+60.00	30 LT	CB TA 4 DIA T24F&G	734.79		730.85					730.85	
S614	186+97.00	38 LT	RD MAN 4 DIA T1F CL	733.91	728.37			730.75	729.41			
S615	189+00.00	30 RT	CB TA 4 DIA T24F&G	734.97	729.36						729.26	
S616	189+00.00	30 LT	CB TA 4 DIA T24F&G	734.97			728.70					729.26
S617	189+02.00	38 LT	RD MAN 4 DIA T1F CL	732.84	728.44			727.19				
S618	189+50.00	36.5 RT	CB TA 4 DIA T24F&G	734.47				729.82				
S619	190+48.00	36.5 RT	MAN TA 6 DIA T1F CL RES	734.48			725.82			725.82		729.60
S620	190+48.00	46.24 RT	MAN TA R-3303 F&L (SPL)	731.94			725.45			725.45		

STR NO.	STATION	OFFSET	STRUCTURE TYPE	RIM	N INV	NE INV	E INV	SE INV	S INV	SW INV	W INV	NW INV
S621	190+45.00	30 RT	CB TA 4 DIA T24F&G	734.20					729.70			
S622	190+45.00	38 RT	RD MAN 5 DIA T1F CL	732.04	726.75	728.00	725.85		725.95			
S623	190+55.00	27.5 LT	RD MAN 4 DIA T1F CL	734.24						728.15		
S624	191+08.00	38.04 RT	CB TA 4 DIA T24F&G	735.43	728.90						728.87	
S625	192+00.00	30 LT	CB TA 4 DIA T24F&G	733.47			728.50					728.45
S626	191+96.00	38 LT	RD MAN 4 DIA T1F CL	731.59			728.35		727.40			
S627	192+50.00	40 RT	CB TC T8G	731.75				729.29				
S628	194+00.00	37.19 RT	RD CB 4 DIA T24F&G	732.33							727.88	
S629	194+00.00	35.22 LT	CB TA 4 DIA T24F&G	732.37				727.20				727.09
S630	194+02.00	48 LT	RD MAN 4 DIA T1F CL	730.73	726.90				727.00			
S631	195+00.00	47.41 RT	INLETS TB T24F&G	731.62							727.14	
S632	195+00.00	37.44 LT	CB TA 4 DIA T24F&G	731.82			726.50					726.46
S633	195+02.00	48 LT	RD MAN 4 DIA T1F CL	730.87	726.30			726.35			726.30	
S634	196+02.00	48 LT	RD MAN 4 DIA T1F CL	731.46	725.73			727.00			725.73	
S635	196+00.00	38 LT	RD CB 4 DIA T24F&G	731.25						727.06		727.06
S636	198+52.00	48 LT	RD MAN 4 DIA T1F CL	726.05	721.50			721.75		721.55		
S637	198+50.00	38 LT	CB TA 4 DIA T24F&G	726.35							721.85	721.85
S638	195+82.74	49.79 RT	INLETS TA T24F&G	731.14								727.64
S639	198+80.00	40 RT	INLETS TA T24F&G	726.31							722.55	

LEGEND

R REMOVAL

RI REMOVAL, BY OTHERS

A ADJUST

AI ADJUST, BY OTHERS

AB ABANDON

NOTE: SEE SHEETS 75 TO 76 FOR DETAILS OF PROPOSED WATER MAIN AND APURTANCES.

EXISTING CONDITIONS

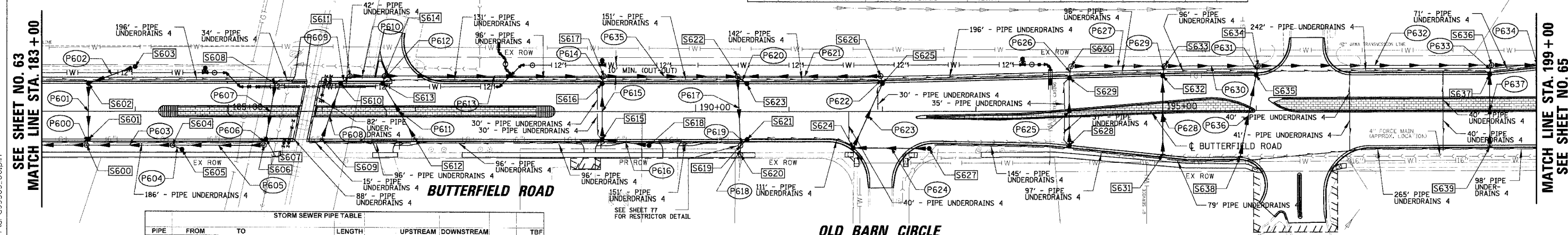
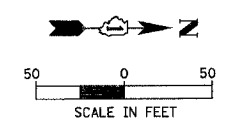

PIPE NO.	FROM STRUCTURE	TO STRUCTURE	MATERIAL	TYPE	LENGTH (FT)	DIA (IN)	UPSTREAM INVERT	DOWNSTREAM INVERT	SLOPE (CU DY)	TBF
P600	S601	S600	RCP	TYPE 2	3	12	730.03	730.00	1.00%	2.1
P601	S602	S601	RCP	TYPE 2	6	12	730.66	730.10	1.00%	35.4
P602	S603	S602	WMQ	TYPE 2	60	12	731.24	730.78	0.96%	13.4
P603	S604	S600	RCP	TYPE 2	88	12	730.20	730.00	0.51%	65.6
P604	S605	S604	RCP	TYPE 2	8	12	730.58	730.50	1.00%	1.5
P605	S606	S604	RCP	TYPE 2	94	12	730.70	730.20	0.53%	23.2
P606	S607	S606	RCP	TYPE 1	3	12	730.73	730.70	1.00%	0.9
P607	S608	S607	RCP	TYPE 1	57	12	731.04	730.75	0.51%	6.9
P608	S609	S610	RCP	TYPE 1	59	12	730.58	730.00	0.95%	9.0
P609	S610	S611	RCP	TYPE 2	9	12	729.94	729.81	1.44%	1.7
P610	S611	S614	WMQ	TYPE 2	33	12	739.71	739.41	0.91%	65.6
P611	S612	S613	RCP	TYPE 1	66	12	731.51	730.85	1.00%	8.0
P612	S613	S614	RCP	TYPE 1	4	12	730.85	730.75	2.50%	0.4
P613	S614	S617	WMQ	TYPE 2	231	12	728.37	727.19	0.51%	69.1
P614	S616	S617	RCP	TYPE 2	4	12	728.60	728.50	2.50%	1.1
P615	S615	S616	RCP	TYPE 2	66	12	729.26	728.70	1.00%	19.1
P616	S618	S615	RCP	TYPE 2	46	12	729.82	729.36	1.00%	11.8
P617	S621	S619	RCP	TYPE 2	70	24	725.95	725.82	0.19%	54.9
P618	S619	S620	RCP	TYPE 2	6	15	725.82	725.45	6.17%	4.9
P619	S621	S619	RCP	TYPE 2	5	12	729.70	729.60	2.00%	1.0
P620	S623	S622	RCP	TYPE 2	11	12	728.15	728.00	1.36%	2.7

PIPE NO.	FROM STRUCTURE	TO STRUCTURE	MATERIAL	TYPE	LENGTH (FT)	DIA (IN)	UPSTREAM INVERT	DOWNSTREAM INVERT	SLOPE (CU DY)	TBF
P621	S626	S622	WMQ	TYPE 2	149	12	727.40	726.75	0.44%	32.0
P622	S625	S626	RCP	TYPE 1	4	12	728.45	728.35	2.50%	0.6
P623	S624	S625	RCP	TYPE 2	72	12	728.87	728.50	0.51%	15.5
P624	S627	S624	RCP	TYPE 1	78	12	729.29	728.90	0.50%	8.6
P625	S628	S629	RCP	TYPE 2	68	12	727.88	727.20	1.00%	15.3
P626	S629	S630	RCP	TYPE 2	9	12	727.09	727.00	1.00%	1.7
P627	S630	S633	RCP	TYPE 2	96	12	726.90	726.30	0.83%	15.6
P628	S631	S632	RCP	TYPE 2	81	12	727.14	726.50	0.79%	19.1
P629	S632	S633	RCP	TYPE 2	7	12	726.46	726.35	1.57%	1.7
P630	S633	S634	RCP	TYPE 2	96	12	726.30	725.73	0.59%	24.7
P631	S635	S634	RCP	TYPE 2	6	12	727.06	727.00	1.00%	1.0
P632	S634	S636	RCP	TYPE 2	246	12	725.73	721.55	1.70%	63.2
P633	S637	S636	RCP	TYPE 2	6	12	721.85	721.75	1.67%	1.1
P634	S636	S706	RCP	TYPE 1	89	15	721.50	720.10	2.03%	8.0
P635	S617	S622	WMQ	TYPE 2	139	18	726.44	725.95	0.36%	55.0
P636	S638	S635	RCP	TYPE 1	85	12	727.64	727.06	0.68%	10.8
P637	S639	S637	RCP	TYPE 1	70	12	722.55	721.85	1.00%	10.6

PROPOSED CONDITIONS

REVISIONS	NAME	DATE

ILLINOIS DEPARTMENT OF TRANSPORTATION
**FAU 2647 - BUTTERFIELD ROAD
UTILITY AND DRAINAGE PLAN
BUTTERFIELD ROAD
STA. 183+00 TO STA. 199+00**
SCALE: 1:50
DATE: 7/19/2006
DRAWN BY: ELA
CHECKED BY: BLL

150
7/19/2006
N: LIBERTYVILLE 99-389 CIVI 99389.TBL
n: Niber tyville 99-389 UR-ain vdr-a99389-06.dgn