

FAU	SECTION	COUNTY	TOTAL SHEETS	SHEET NO.
2647	99-00142-07-WR	LAKE	256	66
CONTRACT NO: 83815				
FED. ROAD DIST. NO. 1 ILLINOIS FED. AID PROJECT				

SEE SHEET NO. 61
BUTTERFIELD ROAD

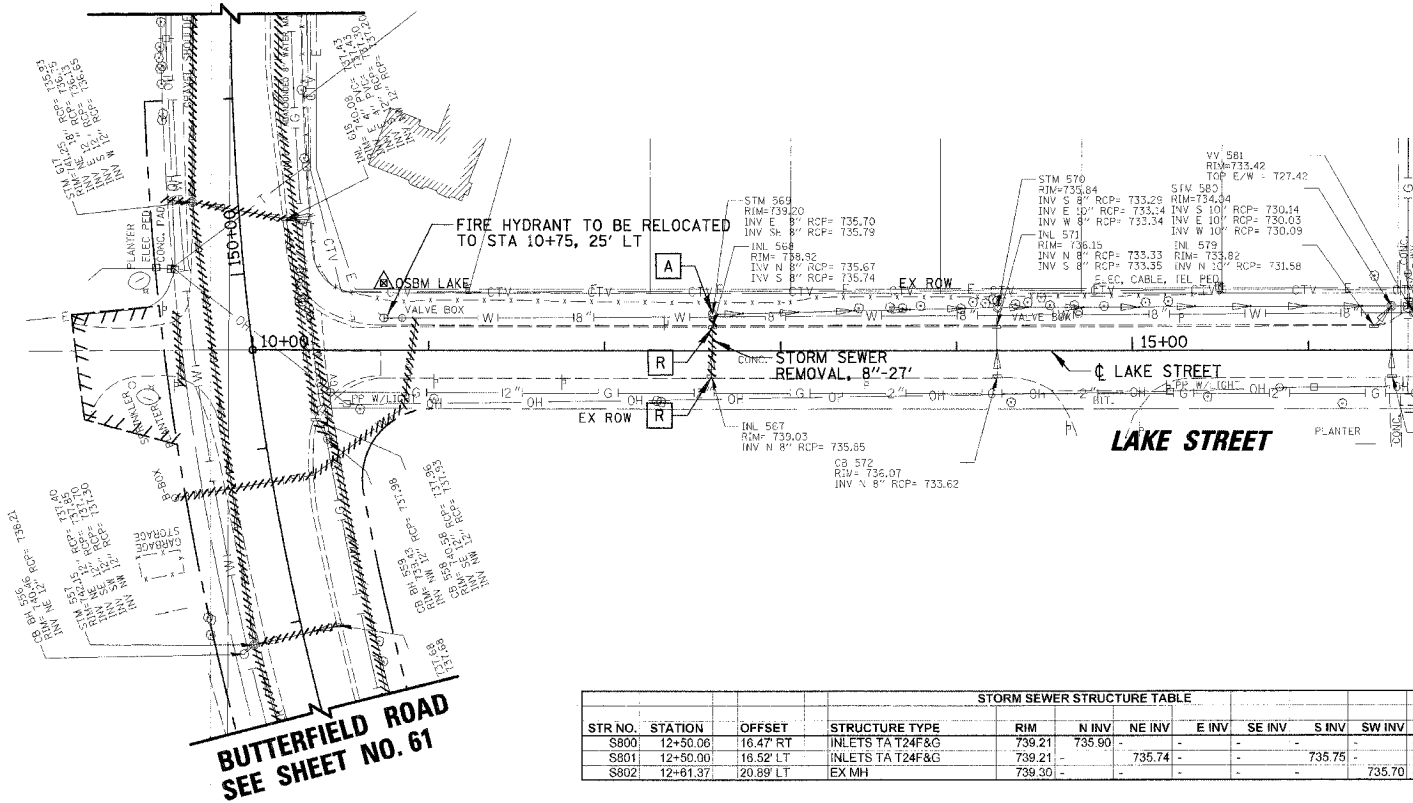

STR NO.	STATION	OFFSET	STRUCTURE TYPE	RIM	N INV	NE INV	E INV	SE INV	S INV	SW INV	W INV	NW INV
S800	12+50.06	16.47 RT	INLETS TA T24F&G	739.21	735.90	-	-	-	-	-	-	-
S801	12+50.00	16.52 LT	INLETS TA T24F&G	739.21	-	735.74	-	-	735.75	-	-	-
S802	12+91.37	20.89 LT	EX MN	739.30	-	-	-	-	-	735.70	-	-

- LEGEND**
- R REMOVAL
 - RI REMOVAL, BY OTHERS
 - A ADJUST
 - AI ADJUST, BY OTHERS
 - AB ABANDON

NOTE: SEE SHEETS 75 TO 76 FOR DETAILS OF PROPOSED WATER MAIN AND APURTANENCES.

EXISTING CONDITIONS

SEE SHEET NO. 61
BUTTERFIELD ROAD

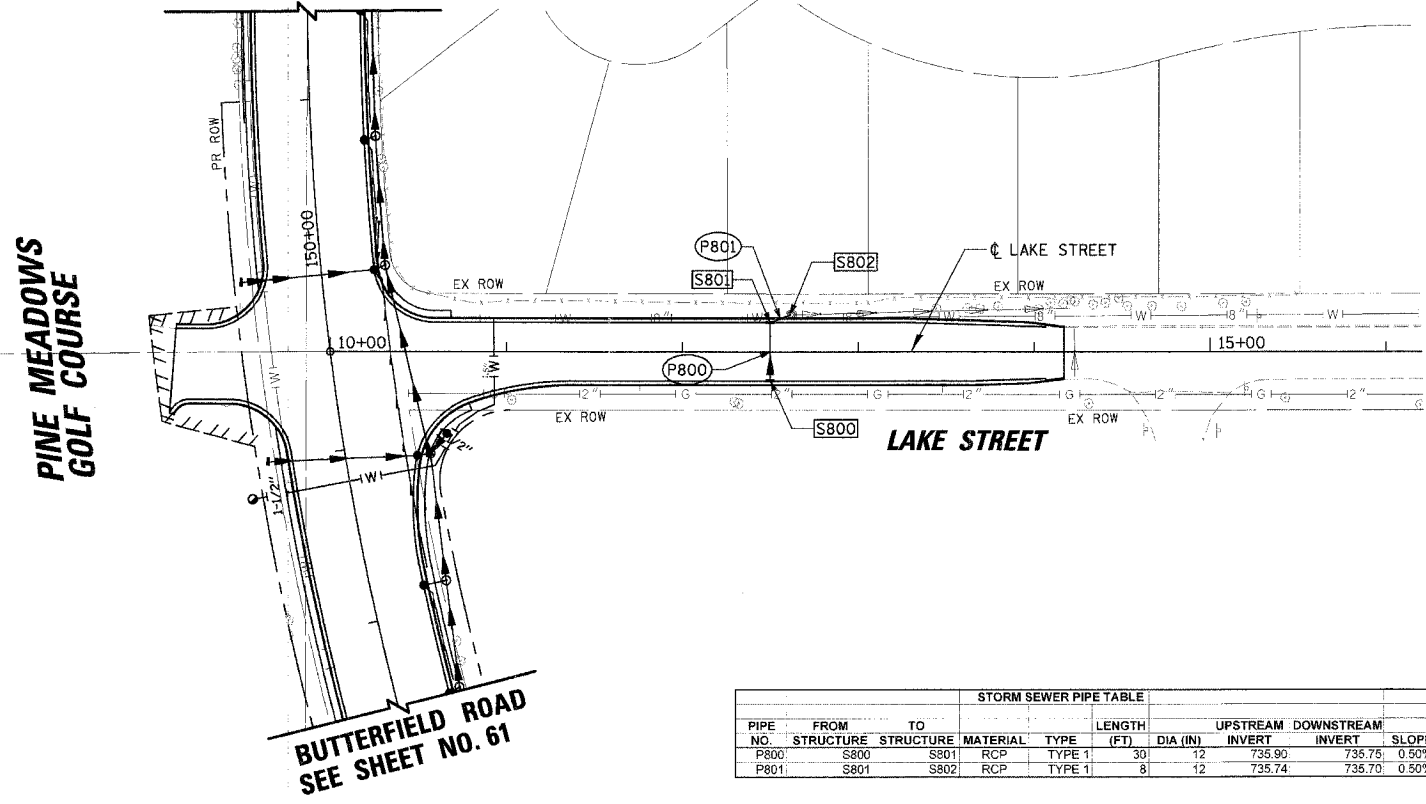

PIPE NO.	FROM STRUCTURE	TO STRUCTURE	MATERIAL	TYPE	LENGTH (FT)	DIA (IN)	UPSTREAM INVERT	DOWNSTREAM INVERT	SLOPE (CU YD)	TBF
P800	S800	S801	RCP	TYPE 1	30	12	735.90	735.75	0.50%	3.0
P801	S801	S802	RCP	TYPE 1	8	12	735.74	735.70	0.50%	0.8

PROPOSED CONDITIONS

NAME	DATE

ILLINOIS DEPARTMENT OF TRANSPORTATION
**FAU 2647 – BUTTERFIELD ROAD
 UTILITY AND DRAINAGE PLAN
 LAKE STREET
 STA. 10+00 TO 14+17**
 SCALE: 1:50.0001
 DATE: 12/2/2005
 DRAWN BY: ELA
 CHECKED BY: BLL