

FAU	SECTION	COUNTY	TOTAL SHEETS	SHEET NO.
2647	99-00142-07-WR	LAKE	256	67
CONTRACT NO: 83815				
FED. ROAD DIST. NO. 1 ILLINOIS FED. AID PROJECT				

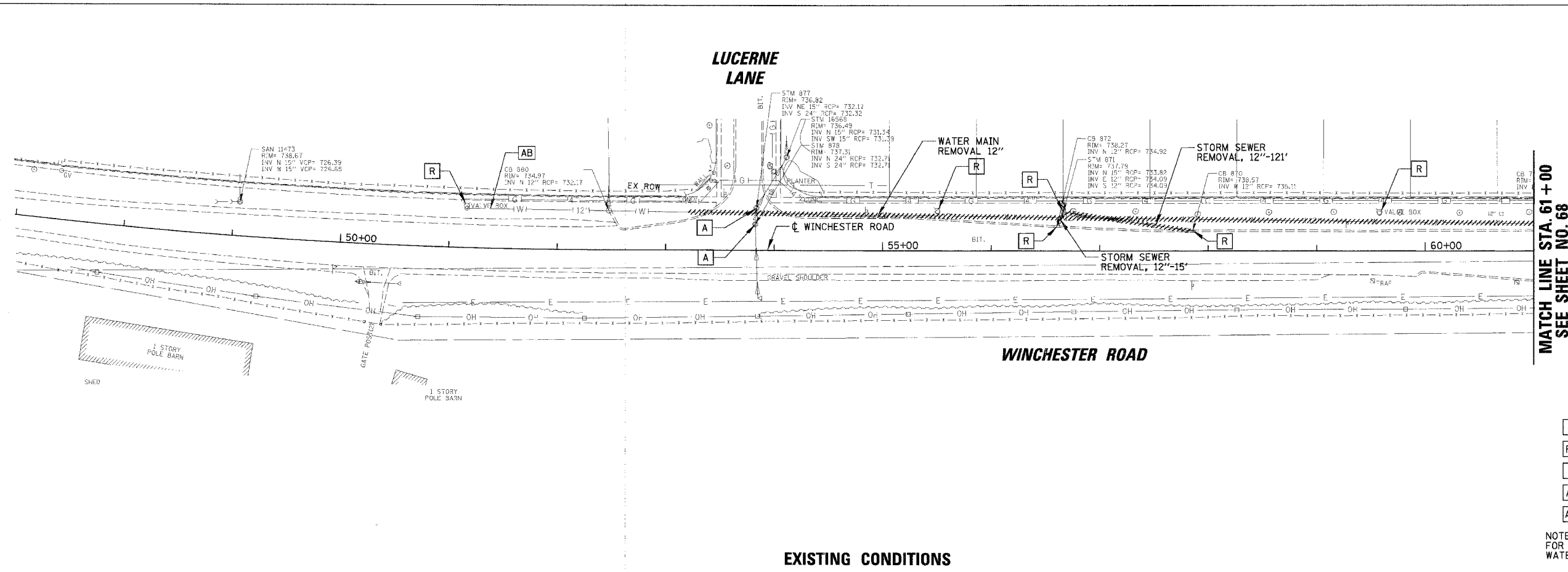
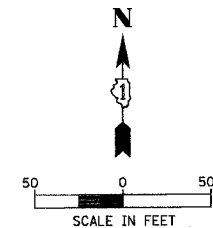

MATCH LINE STA. 61 + 00
SEE SHEET NO. 68

- LEGEND**
- R REMOVAL
 - RI REMOVAL, BY OTHERS
 - A ADJUST
 - AI ADJUST, BY OTHERS
 - AB ABANDON

NOTE: SEE SHEETS 75 TO 76 FOR DETAILS OF PROPOSED WATER MAIN AND APURTANENCES.

EXISTING CONDITIONS

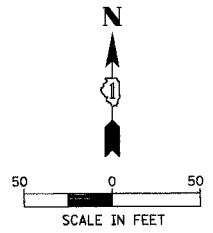
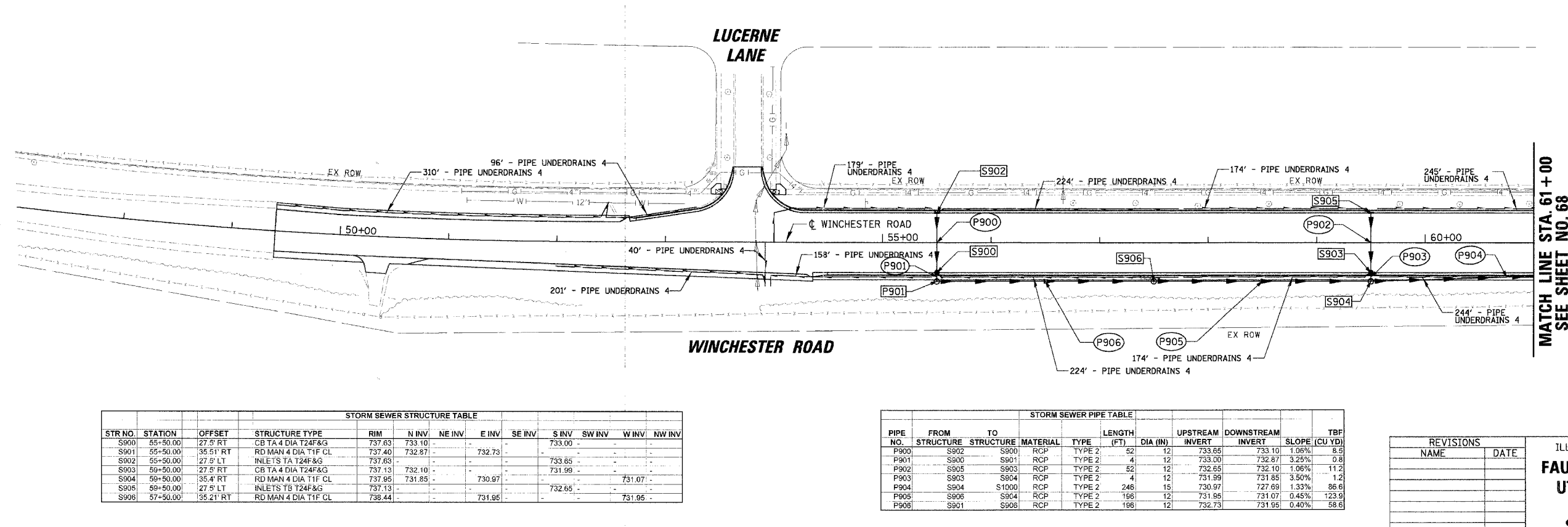

MATCH LINE STA. 61 + 00
SEE SHEET NO. 68

STR NO.	STATION	OFFSET	STRUCTURE TYPE	RIM	N INV	NE INV	E INV	SE INV	S INV	SW INV	W INV	NW INV
S900	55+50.00	27.5' RT	CB TA 4 DIA T24F&G	737.63	733.10	-	-	-	733.00	-	-	-
S901	55+50.00	35.51' RT	RD MAN 4 DIA T1F CL	737.40	732.87	-	732.73	-	-	-	-	-
S902	55+50.00	27.5' LT	INLETS TA T24F&G	737.63	-	-	-	-	733.65	-	-	-
S903	59+50.00	27.5' RT	CB TA 4 DIA T24F&G	737.13	732.10	-	-	-	731.99	-	-	-
S904	59+50.00	35.4' RT	RD MAN 4 DIA T1F CL	737.95	731.85	-	730.97	-	-	-	731.07	-
S905	59+50.00	27.5' LT	INLETS TB T24F&G	737.13	-	-	-	-	732.65	-	-	-
S906	57+50.00	35.21' RT	RD MAN 4 DIA T1F CL	738.44	-	-	731.95	-	-	-	731.95	-

PIPE NO.	FROM STRUCTURE	TO STRUCTURE	MATERIAL	TYPE	LENGTH (FT)	DIA (IN)	UPSTREAM INVERT	DOWNSTREAM INVERT	SLOPE (CU YD)	TBF
P900	S902	S900	RCP	TYPE 2	52	12	733.65	733.10	1.06%	8.5
P901	S900	S901	RCP	TYPE 2	4	12	733.00	732.87	3.25%	0.8
P902	S905	S903	RCP	TYPE 2	52	12	732.65	732.10	1.06%	11.2
P903	S903	S904	RCP	TYPE 2	4	12	731.99	731.85	3.50%	1.2
P904	S904	S1000	RCP	TYPE 2	246	15	730.97	727.69	1.33%	86.6
P905	S905	S904	RCP	TYPE 2	196	12	731.95	731.07	0.45%	123.9
P906	S901	S906	RCP	TYPE 2	196	12	732.73	731.95	0.40%	58.6

NAME	DATE

ILLINOIS DEPARTMENT OF TRANSPORTATION
**FAU 2647 - BUTTERFIELD ROAD
 UTILITY AND DRAINAGE PLAN
 WINCHESTER ROAD
 STA. 49 + 40 TO STA. 61 + 00**
 SCALE: 1:50
 DATE: 12/2/2005
 DRAWN BY: ELA
 CHECKED BY: BLL

PROPOSED CONDITIONS

N:\LIBERTYVILLE\99-389\Civil\99389.TBL
 n:\libertyville\99-389\Drawn\dr\99389_09.ph
 1:50
 12/2/2005