

FAU	SECTION	COUNTY	TOTAL SHEETS	SHEET NO.
2647	99-00142-07-WR	LAKE	256	69
CONTRACT NO: 83815				
FED. ROAD DIST. NO. 1 ILLINOIS FED. AID PROJECT				

* 42" JAWA TRANSMISSION LINE PROFILE IS BASED OFF THE CAMP DRESSER & MCKEE INC. 1990 CONTRACT 90-05 PLAN SET. CONTRACTOR TO COORDINATE ALL ACTIVITIES NEAR THE UTILITY WITH THE JAWA REPRESENTATIVE AND PRIOR TO ANY EXCAVATION IN THE AREA OF THE UTILITY.

PLAN	SUPPLIER	DATE
NOTE BOOK	ALIGNED CHECKED	
NO.	DATE	

PROFILE	DATE
NOTE BOOK	
NO.	

150.0004
2/2/2005
N:\LIBERTYVILLE 99-389\CV\1\99389.TBL
n:\libertyville 99-389\civil\99389_01.dwg

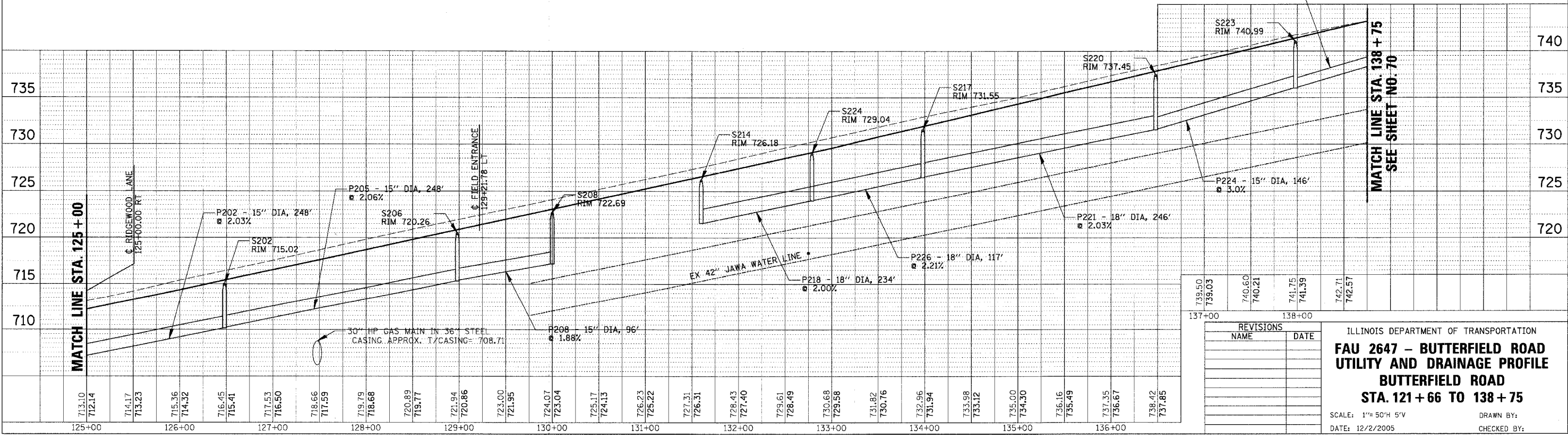
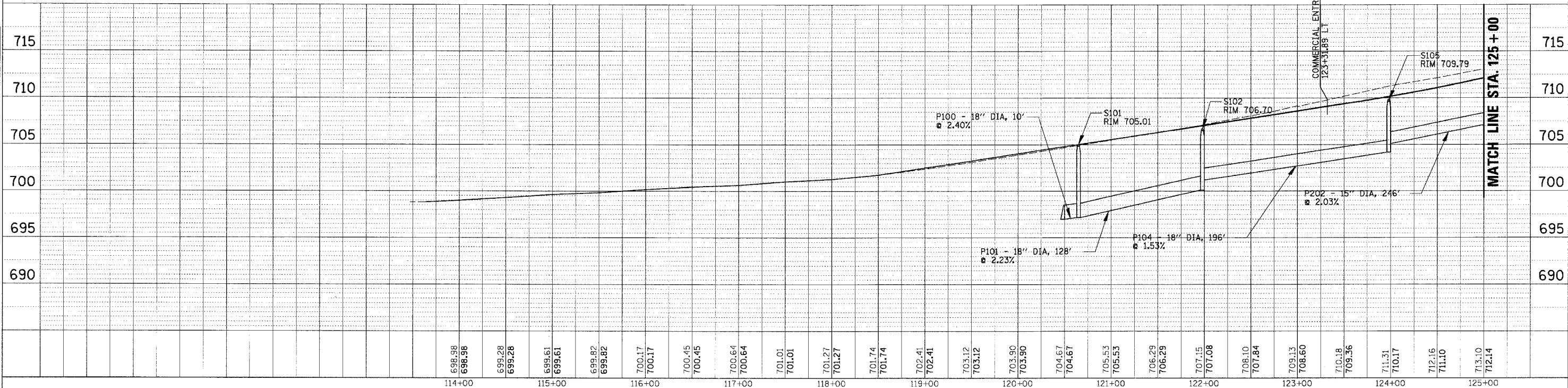

739.50	740.60	741.75	742.71
739.03	740.21	741.39	742.57

REVISIONS	
NAME	DATE

ILLINOIS DEPARTMENT OF TRANSPORTATION
**FAU 2647 - BUTTERFIELD ROAD
 UTILITY AND DRAINAGE PROFILE
 BUTTERFIELD ROAD
 STA. 121+66 TO 138+75**
 SCALE: 1"= 50' H 5' V
 DATE: 12/2/2005
 DRAWN BY:
 CHECKED BY: