

FAU	SECTION	COUNTY	TOTAL SHEETS	SHEET NO.
2647	99-00142-07-WR	LAKE	256	84
CONTRACT NO: 83815				
FED. ROAD DIST. NO. 1 ILLINOIS FED. AID PROJECT				

**PINE MEADOWS GOLF COURSE**

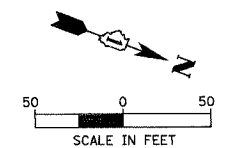
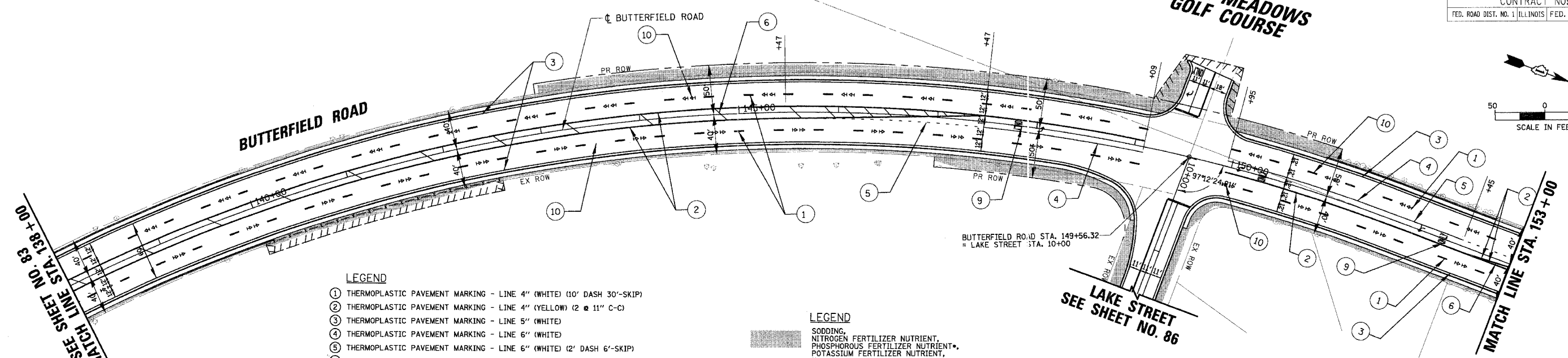

- LEGEND**
- ① THERMOPLASTIC PAVEMENT MARKING - LINE 4" (WHITE) (10' DASH 30'-SKIP)
  - ② THERMOPLASTIC PAVEMENT MARKING - LINE 4" (YELLOW) (2 @ 11" C-C)
  - ③ THERMOPLASTIC PAVEMENT MARKING - LINE 5" (WHITE)
  - ④ THERMOPLASTIC PAVEMENT MARKING - LINE 6" (WHITE)
  - ⑤ THERMOPLASTIC PAVEMENT MARKING - LINE 6" (WHITE) (2' DASH 6'-SKIP)
  - ⑥ THERMOPLASTIC PAVEMENT MARKING - LINE 12" (YELLOW) (45° DIAGONAL @ 20' C-C)
  - ⑦ THERMOPLASTIC PAVEMENT MARKING - LINE 12" (WHITE)
  - ⑧ THERMOPLASTIC PAVEMENT MARKING - LINE 24" (WHITE)
  - ⑨ THERMOPLASTIC PAVEMENT MARKING - LETTERS AND SYMBOLS (WHITE)
  - ⑩ RPM (PER LCDOT STANDARD. SEE ROADWAY CONSTRUCTION DETAILS, SHEET 153 )
  - ⑪ RPM (PER IDOT DISTRICT 1 STANDARD TC11. SEE SHEET 132 )
  - ⑫ THERMOPLASTIC PAVEMENT MARKING - LINE 4" (YELLOW)
  - ⑬ THERMOPLASTIC PAVEMENT MARKING - LINE 12" (WHITE) (45° DIAGONALS @ 20' C-C)
  - ⑭ THERMOPLASTIC PAVEMENT MARKING - LINE 4" (WHITE)

- LEGEND**
- SODDING, NITROGEN FERTILIZER NUTRIENT, PHOSPHOROUS FERTILIZER NUTRIENT\*, POTASSIUM FERTILIZER NUTRIENT, TOPSOIL FURNISH AND PLACE, 4"
  - PROPOSED SIGN BASE (SIGN TO BE INSTALLED BY OTHERS-LCDOT)
  - SEE DETENTION POND GRADING PLAN SEE SHEET 80
- \* STA. 200+00 TO STA. 201+73.50  
 STA. 693+88.40 TO STA. 707+13.75
- \* FOR PARKWAY AND MEDIAN PLANTER TREE LIST SEE SHEET 89.

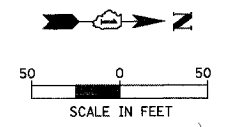
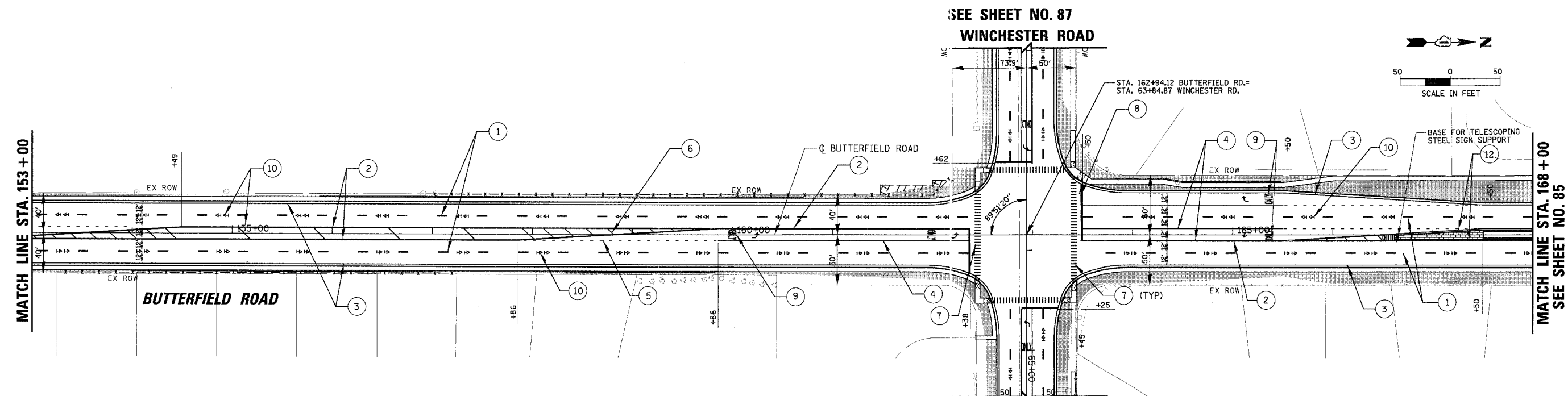

REVISIONS	
NAME	DATE

ILLINOIS DEPARTMENT OF TRANSPORTATION

**FAU 2647 - BUTTERFIELD ROAD  
 PAVEMENT MARKING AND  
 LANDSCAPING - BUTTERFIELD ROAD  
 STA. 138+00 TO STA. 168+00**

SCALE: 1:50  
 DATE: 7/19/2006

DRAWN BY: PMM,ELA  
 CHECKED BY: BLL

N:\LIBERTYVILLE\99-389\CIVIL\99389\_02.dwg  
 7/19/2006 1:50