

ORIGINAL	DATE
SUBMITTER	BY
PLOTTED	DATE
NOTE BOOK	NO.
AS DESIGNED	

CHRISTOPHER B. BURKE ENGINEERING LTD.
 9575 West Higgins Road, Suite 600
 Rosemont, Illinois 60018
 (847) 823-0500

DATE	BY
NO.	
AS DESIGNED	
AS CHECKED	
AS PLOTTED	
AS SUBMITTED	

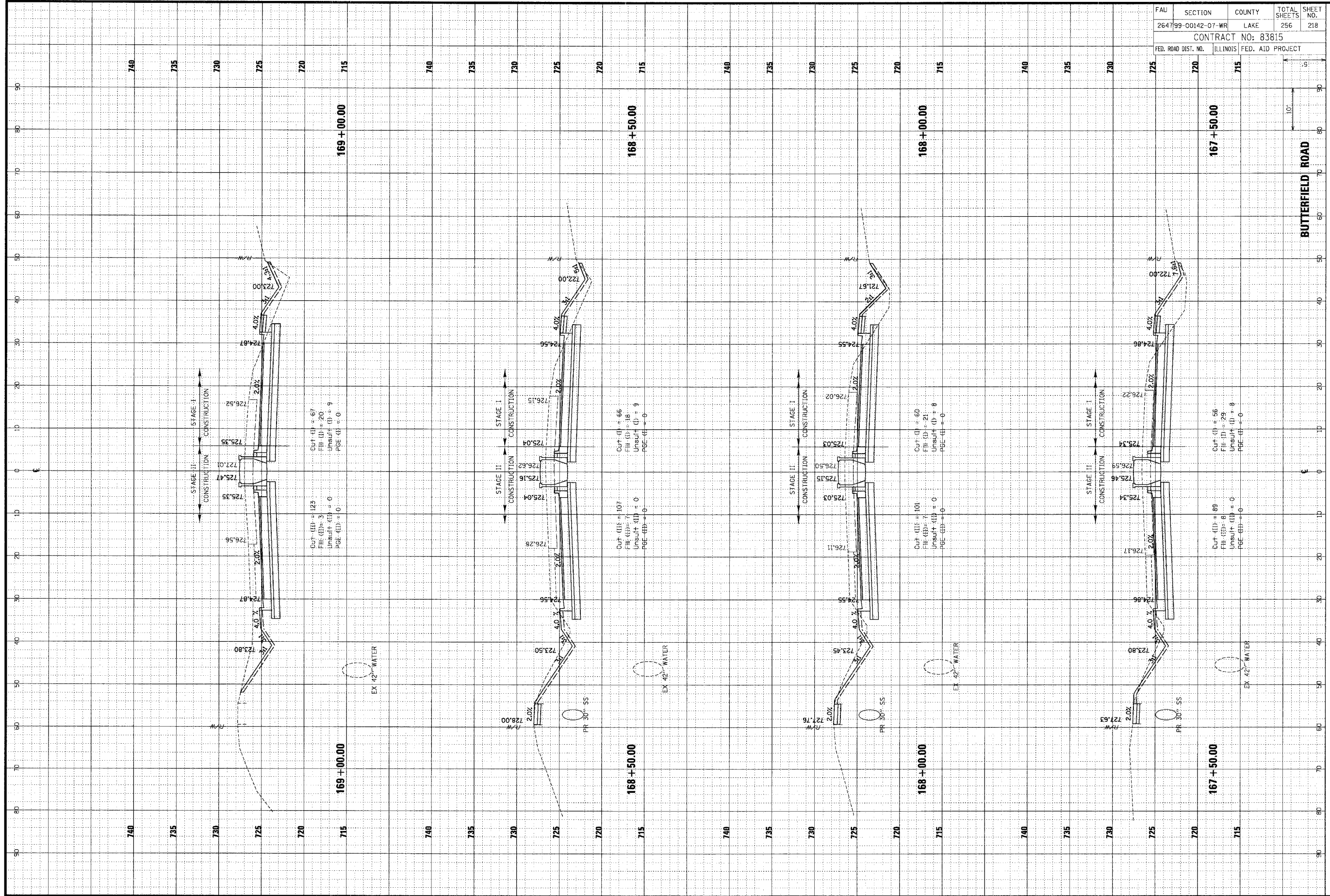

FAU	SECTION	COUNTY	TOTAL SHEETS	SHEET NO.
264799-00142-07-WR	LAKE	ILLINOIS	256	218
CONTRACT NO: 83815				
FED. ROAD DIST. NO.	FED. AID PROJECT			