

ORIGINAL SURVEY PLOTTED
NOTE BOOK TEMP. AT
NO. AREAS CHECKED

CHRISTOPHER B. BURKE ENGINEERING LTD.
9575 West Higgins Road, Suite 600
Rosemont, Illinois 60018
(847) 823-0500

FINAL SURVEY PLOTTED
NOTE BOOK TEMP. AT
NO. AREAS CHECKED

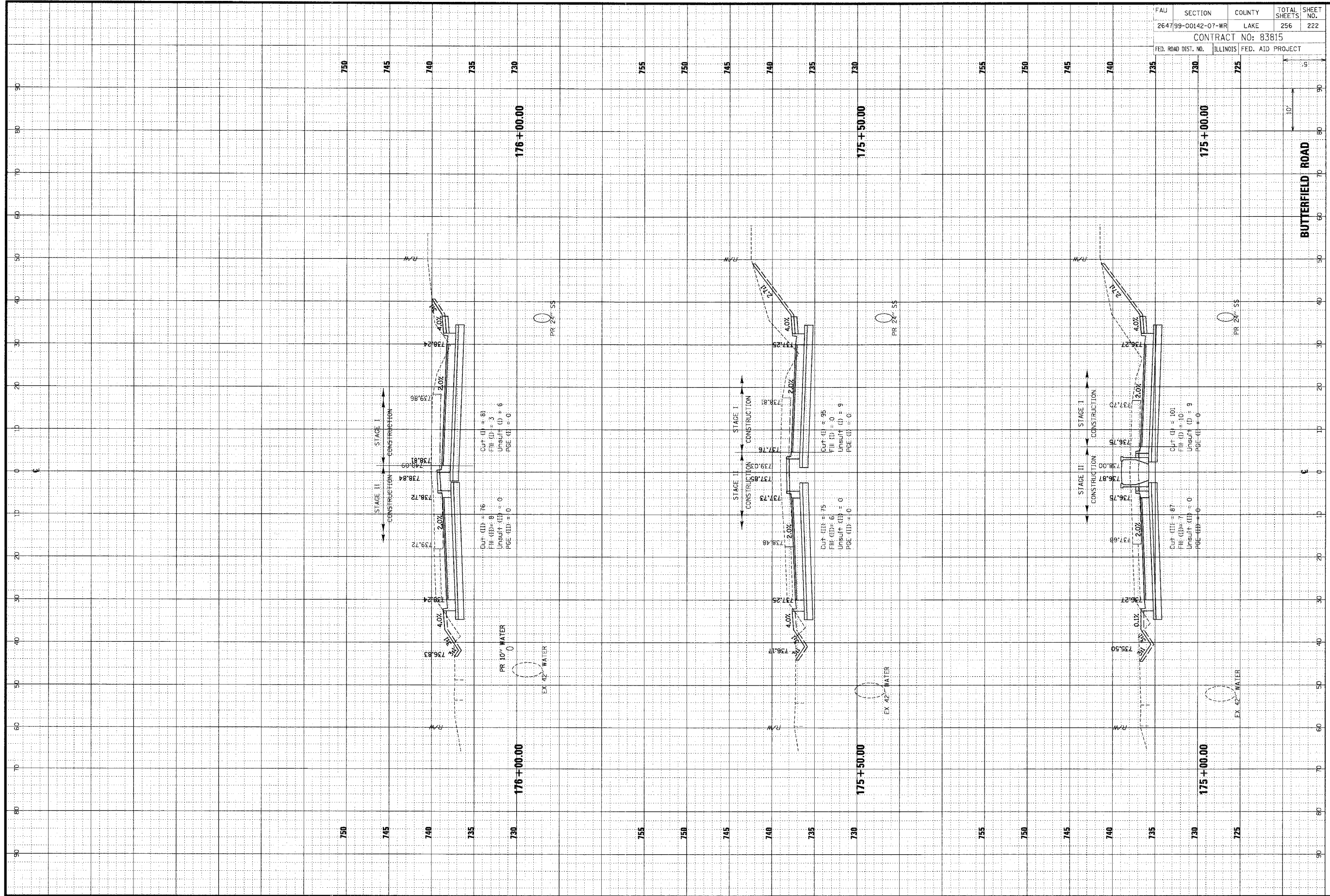

FAU	SECTION	COUNTY	TOTAL SHEETS	SHEET NO.
264799-00142-07-WR	LAKE	ILLINOIS	256	222
CONTRACT NO: 83815				
FED. ROAD DIST. NO.	ILLINOIS	FED. AID PROJECT		