

STATE OF ILLINOIS
DEPARTMENT OF TRANSPORTATION

NOTE "A"
Existing Light fixture and conduit to be removed and stored prior to doing any repair work. After the repair work is completed reattach light fixture and conduit in the same locations. Cost Included with Structural Repair of Concrete (Depth Equal To or Less Than 5 Inches)

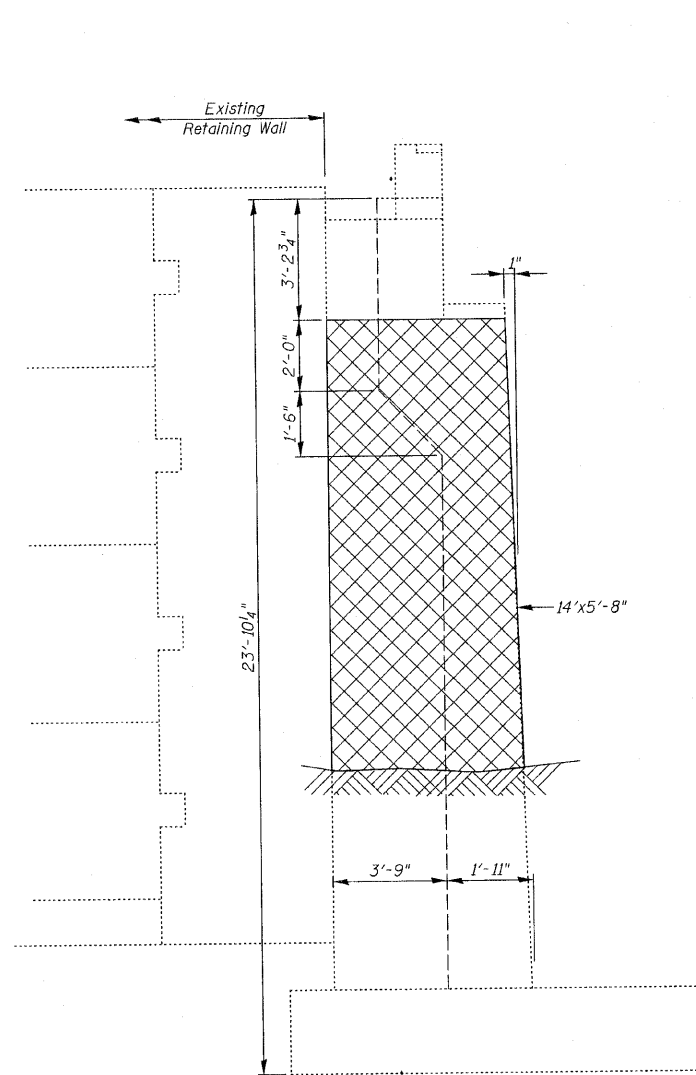

SIDE VIEW
(Looking West)

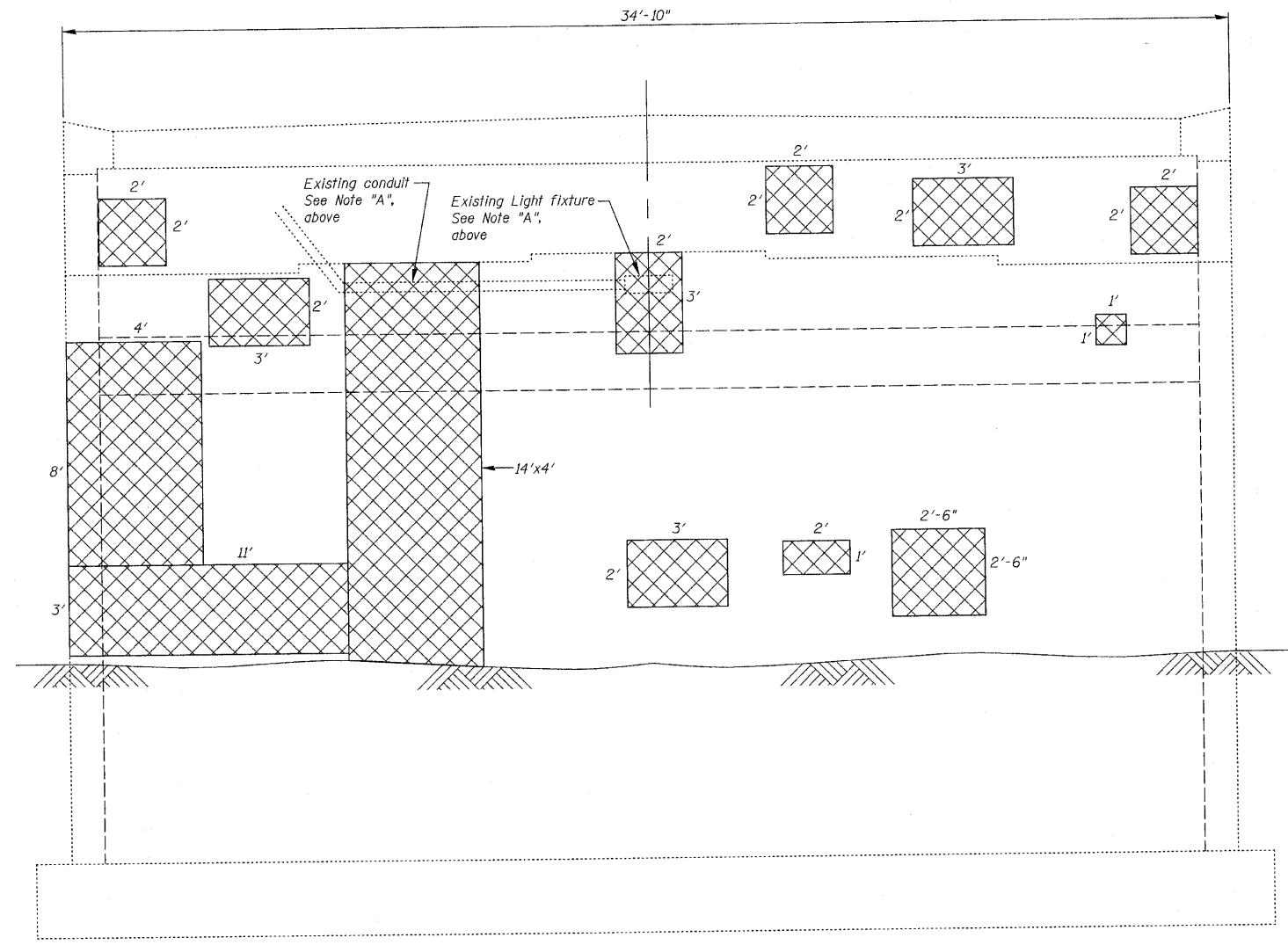

ELEVATION-NORTH ABUTMENT
(Looking North)

LEGEND:
[Cross-hatched box] Structural Repair of Concrete
(Depth Equal To or Less Than 5 Inches)

BILL OF MATERIAL

ITEM	UNIT	QUANTITY
Structural Repair of Concrete (Depth Equal To or Less Than 5 Inches)	Sq Ft	242

NORTH ABUTMENT REPAIRS
IL. RTE. 251 OVER IL. RTE. 38
C&NW R.R. AND B.N. R.R.
F.A.P. RTE. 740 (IL. RTE. 251)
SECTION (108HV)M
OGLE COUNTY
STA. 856+44.00
STRUCTURE NO. 071-0066

DESIGNED -	2010
CHECKED -	EXAMINED
DRAWN -	ENGINEER OF BRIDGE DESIGN
CHECKED -	PASSED
	ENGINEER OF BRIDGES AND STRUCTURES

CR & A
CHRISTIAN-ROGE & ASSOCIATES, INC.
ENGINEERS-PLANNERS-SURVEYORS
211 WEST WACKER DRIVE
CHICAGO, ILLINOIS 60606
PHONE: (312)372-2023 FAX: (312)372-5274

SHEET NO. S31	F.A.P. RTE.	SECTION	COUNTY	TOTAL SHEETS	SHEET NO.
	740	(108HV)M	OGLE	55	38
S43 SHEETS	CONTRACT NO. 64G24			ILLINOIS FED. AID PROJECT	