

STATE OF ILLINOIS  
DEPARTMENT OF TRANSPORTATION

F.A.S. RTE.	SECTION	COUNTY	TOTAL SHEETS	SHEET NO.
1909	22B-4	UNION	37	1
		ILLINOIS	CONTRACT NO. 78505	

FOR INDEX OF SHEETS, SEE SHEET NO. 3  
FOR SUMMARY OF QUANTITIES, SEE SHEET NO. 6-9

**PROPOSED  
HIGHWAY PLANS**

FAS ROUTE 1909 (IL 127)  
SECTION 22B-4  
PROJECT STP-HA9P(855)  
STRUCTURE REMOVAL AND NEW RAMP  
UNION COUNTY

C-99-004-16

**TRAFFIC DATA**

CH 8/CHESTNUT ST			
	2010	2018	2038
PV =	440	475	580
SU =	40	45	55
MU =	20	20	25
ADT =	500	540	660

**TOWNSHIPS**

ALTO PASS

DESIGN DESIGNATION : 57(20) MINOR COLLECTOR 3.2(HMA-20)  
COORDINATE SYSTEM : NAD 1983 STATEPLANE ILLINOIS WEST  
POSTED SPEED : 55 MPH (IL 127)/25 MPH (CH-8/CHESTNUT ST.)

J.U.L.I.E.  
JOINT UTILITY LOCATION INFORMATION FOR EXCAVATION  
1-800-892-0123  
OR 811

PROJECT ENGINEER: VALERIE ROLLA  
PROJECT DESIGNER: MELISSA COLE

CONTRACT NO. 78505

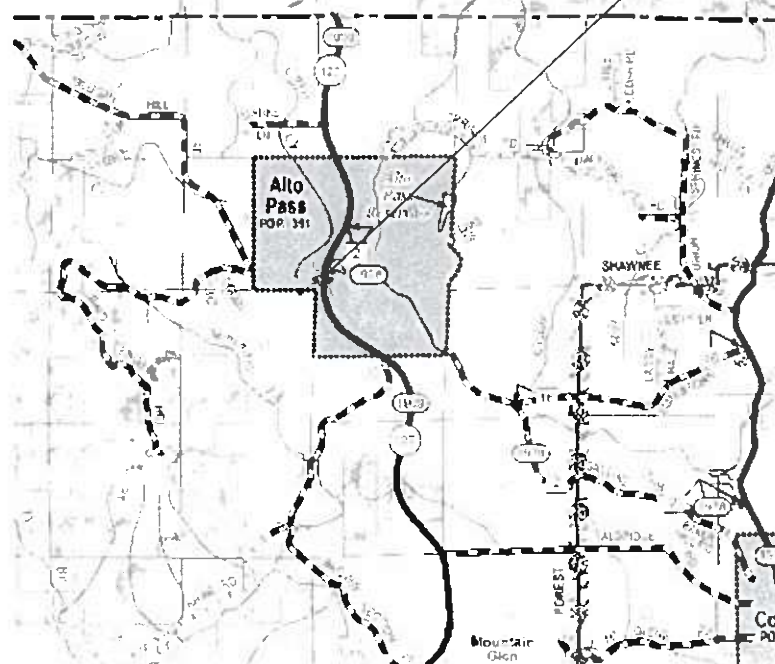

GROSS LENGTH = 568.88 FT. = 0.11 MILES  
NET LENGTH = 568.88 FT. = 0.11 MILES



STATE OF ILLINOIS  
DEPARTMENT OF TRANSPORTATION

SUBMITTED 08-21-20  
[Signature]  
REGION FIVE ENGINEER

October 2, 2020  
[Signature]  
ENGINEER OF DESIGN AND ENVIRONMENT

October 2, 2020  
[Signature]  
DIRECTOR OF HIGHWAYS PROJECT IMPLEMENTATION

PRINTED BY THE AUTHORITY  
OF THE STATE OF ILLINOIS



# INDEX OF SHEETS

SHEET NO	DESCRIPTION
1	COVER SHEET
2	SIGNATURE SHEET
3	INDEX OF SHEETS, HIGHWAY STANDARDS,
4	GENERAL NOTES, COMMITMENTS
5	MIX DESIGN
6-9	SUMMARY OF QUANTITIES
10	TYPICAL SECTIONS
11	GEOPAK REFERENCE SHEET
12	ALIGNMENT, TIE AND BENCHMARK SHEET
13	SEEDING SCHEDULE
14	EXCAVATION, PAVEMENT AND PAVEMENT MARKI
15	PLAN SHEET
16-17	PROFILE SHEETS
18	TREE REMOVAL SHEET
19	RIGHT OF WAY PLANS
20	DETAILS: ROAD CLOSURE
21	DETAILS: TEMPORARY DITCH CHECKS SEEDING AND MULCH
22-25	SOIL BORING LOGS
26-37	CROSS SECTION SHEETS

## HIGHWAY STANDARDS

000001-07	_STANDARDSYMBOLSABBREVIATIONS&PATTERNS
001006	_DECIMALOFINCH&FOOT
280001-07	_TEMPEROSIONCNTRLSYSTEMS
631011-10	_TRAFBARTERMYPE2
666001-01	_ROWMRKRS
701001-02	_OFFRDOP-2L2W-15FTMINFROMEOP
701006-05	_OFFRDOP-2L2W-15FTTOEOP
701306-04	_LNCLOSURE2L2W-SLOWMOVEOPDAYONLY45MPHORMORE
701311-03	_LNCLOSURE2L2W-MOVINGOPDAYONLY
701326-04	_LNCLOSURE2L2W-PVMTWIDENING45MPHORMORE
701901-08	_TRAFCNTRLDEVICES
720001-01	_SIGNPANELMOUNTDETAILS
720006-04	_SIGNPANELERECTDETAILS
720011-01	_METALPOSTSFORSIGNSMRKRS&DELINEATORS
729001-01	_APPOFTYPESA&BPOSTS
780001-05	_TYPICALPVMTMRKINGS
BLR21-9	_TYPAPPTRAFCNTRLDEVICES-CONSTRONRURALLOCALHWYS

MODEL: Default  
 FILE: Model: C:\pub\harcross\dat\illinois\gov\PI\DOT\Documents\DOT\_Offices\District\_9\Projects\78505\CAD\Drawings\9778505-Std-Index

USER NAME = colemm	DESIGNED -	REVISED -
	DRAWN -	REVISED -
PLOT SCALE = 100.0000 ' / in.	CHECKED -	REVISED -
PLOT DATE = 8/26/2020	DATE -	REVISED -

**STATE OF ILLINOIS  
DEPARTMENT OF TRANSPORTATION**

**INDEX OF SHEETS  
HIGHWAY STANDARDS**

SCALE: SHEET OF SHEETS STA. TO STA.

F.A.S. RTE.	SECTION	COUNTY	TOTAL SHEETS	SHEET NO.
1909	22B-4	UNION	37	3
CONTRACT NO. 78505				
		ILLINOIS	FED. AID PROJECT	

# GENERAL NOTES

FACTORS USED FOR ESTIMATING PLAN QUANTITIES ARE AS FOLLOWS AND SHALL NOT BE USED FOR THE BASIS OF FINAL QUANTITIES:

ALL HOT MIX ASPHALT 2.016 TONS/CU. YD.

ALL AGGREGATE 2.05 TONS/CU. YD.

THE QUANTITY OF SHORT TERM PAVEMENT MARKING SHOWN IN THE PLANS IS BASED ON ONE APPLICATION FOR THE HMA SURFACE COURSE.

AT ALL LOCATIONS WHERE THE PROPOSED HOT MIX ASPHALT OR CONCRETE PAVEMENT JOINS AN EXISTING HOT MIX ASPHALT OR CONCRETE PAVEMENT, A FULL DEPTH SAWED JOINT SHALL BE CONSTRUCTED. THE COST OF THIS JOINT WILL BE INCLUDED IN THE COST OF THE TYPE OF PAVEMENT BEING CONSTRUCTED.

THE CONTRACTOR SHALL STAMP STATIONING IN THE PROPOSED HOT MIX ASPHALT SURFACE AT 300 FT INTERVALS ON ALTERNATING SIDES OF THE PAVEMENT AND AS DIRECTED BY THE ENGINEER. THE STATION SYMBOL STAMPS USED SHALL BE FURNISHED BY THE CONTRACTOR. THEY SHALL BE 5 1/2 IN. TALL, OF A DESIGN APPROVED BY THE ENGINEER, AND SHALL REMAIN THE PROPERTY OF THE CONTRACTOR.

PLACEMENT AND LOCATION OF PERMANENT SURVEY MARKERS SHALL BE DETERMINED BY THE ENGINEER IN COORDINATION WITH THE DISTRICT 9 SURVEYS UNIT. IN ADDITION TO THE REQUIREMENTS OF STANDARD 667101, BACKFILL USED IN CONJUNCTION WITH PRECAST MARKERS SHALL BE QUICK-MIX CONCRETE OR SIMILAR MATERIAL APPROVED BY THE ENGINEER.

REMOVAL OF ABANDONED UTILITIES SHALL BE INCLUDED IN THE COST OF EARTH EXCAVATION

COMMITMENTS: TREE CLEARING WILL NOT BE ALLOWED FROM APRIL 1 TO SEPTEMBER 30

MODEL: Default  
 FILE: Model: 2014planroom.dwg  
 I:\InRoads\pwr\I\DOT\Documents\DOT\_Offices\District 9\Projects\78505\CAAD\Drawings\DOT\78505-Shut-Cur\_Seg\_Index

	USER NAME = colemm PLOT SCALE = 100.0000' / in. PLOT DATE = 8/26/2020	DESIGNED - DRAWN - CHECKED - DATE -	REVISED - REVISED - REVISED - REVISED -	<b>STATE OF ILLINOIS DEPARTMENT OF TRANSPORTATION</b>	<b>GENERAL NOTES</b>	SCALE:      SHEET      OF      SHEETS      STA.      TO STA.	<table border="1" style="width: 100%; border-collapse: collapse;"> <tr> <th style="font-size: small;">F.A.S. RTE.</th> <th style="font-size: small;">SECTION</th> <th style="font-size: small;">COUNTY</th> <th style="font-size: small;">TOTAL SHEETS</th> <th style="font-size: small;">SHEET NO.</th> </tr> <tr> <td style="text-align: center;">1909</td> <td style="text-align: center;">22B-4</td> <td style="text-align: center;">UNION</td> <td style="text-align: center;">37</td> <td style="text-align: center;">4</td> </tr> <tr> <td colspan="5" style="text-align: center; font-size: x-small;">CONTRACT NO. 78505</td> </tr> <tr> <td colspan="5" style="text-align: center; font-size: x-small;">ILLINOIS FED. AID PROJECT</td> </tr> </table>	F.A.S. RTE.	SECTION	COUNTY	TOTAL SHEETS	SHEET NO.	1909	22B-4	UNION	37	4	CONTRACT NO. 78505					ILLINOIS FED. AID PROJECT				
F.A.S. RTE.	SECTION	COUNTY	TOTAL SHEETS	SHEET NO.																							
1909	22B-4	UNION	37	4																							
CONTRACT NO. 78505																											
ILLINOIS FED. AID PROJECT																											



## SUMMARY OF QUANTITIES

COUNTY:	UNION CO
ROUTE:	IL 127
FUNDING:	80% FED / 20% STATE
LOCATION:	RURAL
TOTAL QUANTITY	ROADWAY 0001

CODE NUMBER	ITEM DESCRIPTION	UNIT	TOTAL QUANTITY	ROADWAY 0001
20100500	TREE REMOVAL, ACRES	ACRE	2.4	2.4
20200100	EARTH EXCAVATION	CU YD	30,308	30,308
20200200	ROCK EXCAVATION	CU YD	344	344
25000200	SEEDING, CLASS 2	ACRE	2.2	2.2
25000350	SEEDING, CLASS 7	ACRE	2.2	2.2
25000400	NITROGEN FERTILIZER NUTRIENT	POUND	19,043	19,043
25000500	PHOSPHORUS FERTILIZER NUTRIENT	POUND	9,522	9,522
25000600	POTASSIUM FERTILIZER NUTRIENT	POUND	9,522	9,522
25000700	AGRICULTURAL GROUND LIMESTONE	TON	4.3	4.3
25100115	MULCH, METHOD 2	ACRE	4.3	4.3
28000250	TEMPORARY EROSION CONTROL SEEDING	POUND	424	424

MODEL: Default  
 FILE: Model: P:\pub\harcam\dat\illinois.gov\RWIDOT\Documents\DOT\_Offices\District\_9\Projects\78505\CADD\Drawings\78505-Shot-Cy\_Seq\_Index

USER NAME = colemm PLOT SCALE = 100,0000' / in. PLOT DATE = 8/26/2020	DESIGNED - DRAWN - CHECKED - DATE -	REVISED - REVISED - REVISED - REVISED -	<b>STATE OF ILLINOIS DEPARTMENT OF TRANSPORTATION</b>	<b>SUMMARY OF QUANTITIES</b>	F.A.S. RTE. 1909	SECTION 22B-4	COUNTY UNION	TOTAL SHEETS 37	SHEET NO. 6
SCALE:      SHEET      OF      SHEETS      STA.      TO      STA.					ILLINOIS FED. AID PROJECT      CONTRACT NO. 78505				

# SUMMARY OF QUANTITIES - CONT

COUNTY:	UNION CO
ROUTE:	IL 127
FUNDING:	80% FED / 20% STATE
LOCATION:	RURAL
TOTAL QUANTITY	ROADWAY 0001

CODE NUMBER	ITEM DESCRIPTION	UNIT	TOTAL QUANTITY	ROADWAY 0001
28000305	TEMPORARY DITCH CHECKS	FOOT	382	382
28000500	INLET AND PIPE PROTECTION	EACH	2	2
28001100	TEMPORARY EROSION CONTROL BLANKET	SQ YD	1,262	1,262
31101000	SUBBASE GRANULAR MATERIAL, TYPE B	TON	26	26
35101400	AGGREGATE BASE COURSE, TYPE B	TON	1,058	1,058
40600290	BITUMINOUS MATERIALS (TACK COAT)	POUND	3,592	3,592
40600982	HOT-MIX ASPHALT SURFACE REMOVAL - BUTT JOINT	SQ YD	200	200
40600990	TEMPORARY RAMP	SQ YD	35	35
40604052	HOT-MIX ASPHALT SURFACE COURSE, IL-9.5, MIX "C", N70	TON	302	302
44000100	PAVEMENT REMOVAL	SQ YD	469	469
48101200	AGGREGATE SHOULDERS, TYPE B	TON	170	170

MODEL: Default  
 FILE: h:\mhc\p\pub\harcam\dat\illinois\gov\pww\DOT\Documents\DOT\_Offices\Default\_9\Projects\78505\CADD\Drawings\DOT\_78505-Shot-Cur\_Seg\_Index

USER NAME = colemm	DESIGNED -	REVISED -
	DRAWN -	REVISED -
PLOT SCALE = 100.0000' / in.	CHECKED -	REVISED -
PLOT DATE = 8/26/2020	DATE -	REVISED -

**STATE OF ILLINOIS  
DEPARTMENT OF TRANSPORTATION**

**SUMMARY OF QUANTITIES**

SCALE: SHEET OF SHEETS STA. TO STA.

F.A.S. RTE.	SECTION	COUNTY	TOTAL SHEETS	SHEET NO.
1909	22B-4	UNION	37	7
CONTRACT NO. 78505				
ILLINOIS FED. AID PROJECT				

# SUMMARY OF QUANTITIES - CONT

COUNTY:	UNION CO
ROUTE:	IL 127
FUNDING:	80% FED / 20% STATE
LOCATION:	RURAL
TOTAL QUANTITY	ROADWAY 0001

CODE NUMBER	ITEM DESCRIPTION	UNIT	TOTAL QUANTITY	ROADWAY
50100100	REMOVAL OF EXISTING STRUCTURES	EACH	1	1
50105220	PIPE CULVERT REMOVAL	FOOT	65	65
* 63100045	TRAFFIC BARRIER TERMINAL, TYPE 2	EACH	4	4
63200310	GUARDRAIL REMOVAL	FOOT	376	376
66600105	FURNISHING AND ERECTING RIGHT OF WAY MARKERS	EACH	4	4
67100100	MOBILIZATION	L SUM	1	1
70100500	TRAFFIC CONTROL AND PROTECTION, STANDARD 701326	L SUM	1	1
70107025	CHANGEABLE MESSAGE SIGN	CAL DA	56	56
70300100	SHORT TERM PAVEMENT MARKING	FOOT	52	52
70300150	SHORT TERM PAVEMENT MARKING REMOVAL	SQ FT	18	18
70300220	TEMPORARY PAVEMENT MARKING - LINE 4"	FOOT	1,281	1,281

\* SPECIALTY ITEM

MODEL: Default  
 FILE: Model: P:\pub\harron.mxd  
 PROJECT: 78505\CADD\Drawings\DOT - Office\Drawings\9\Projects\78505\CADD\Drawings\9\78505-Sub-Cy\_Seq\_Index



## SUMMARY OF QUANTITIES - CONT

COUNTY:	UNION CO
ROUTE:	IL 127
FUNDING:	80% FED / 20% STATE
LOCATION:	RURAL
TOTAL QUANTITY	ROADWAY 0001

CODE NUMBER	ITEM DESCRIPTION	UNIT	TOTAL QUANTITY	ROADWAY 0001
70300280	TEMPORARY PAVEMENT MARKING - LINE 24"	FOOT	30	30
* 72000100	SIGN PANEL - TYPE 1	SQ FT	31	31
* 72900100	METAL POST - TYPE A	FOOT	96	96
* 78001110	PAINT PAVEMENT MARKING - LINE 4"	FOOT	1,281	1,281
* 78001180	PAINT PAVEMENT MARKING - LINE 24"	FOOT	30	30
X0327979	PAVEMENT MARKING REMOVAL - GRINDING	SQ FT	559	559
X7011800	TRAFFIC CONTROL AND PROTECTION, STANDARD BLR 21	L SUM	1	1
Z0007601	BUILDING REMOVAL NO. 1	L SUM	1	1

\* SPECIALTY ITEM

MODEL: Default  
 FILE: \\blm1c1.pw.us\blm1c1\pww\DOT\Documents\DOT\_Offices\blm1c1\9\Projects\78505\CADD\Drawings\DOT\78505-Sub-C\78505-Sub-C.dwg

MODEL: Default  
 FILE: \\blm1c1.pw.usp.ibm.com\data\illinois.gov\PWIDOT\Documents\DOT\_Offices\District 9\Projects\78505\CADD\Drawings\78505-SHB-Typ\_Sch\_The\_GeopakElements

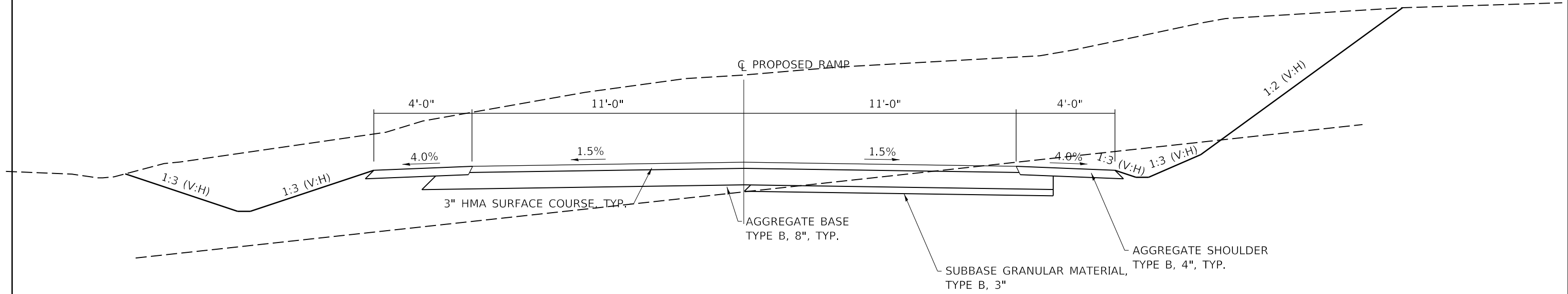

**PROPOSED TYPICAL SECTION**

TO BE USED:  
RAMP

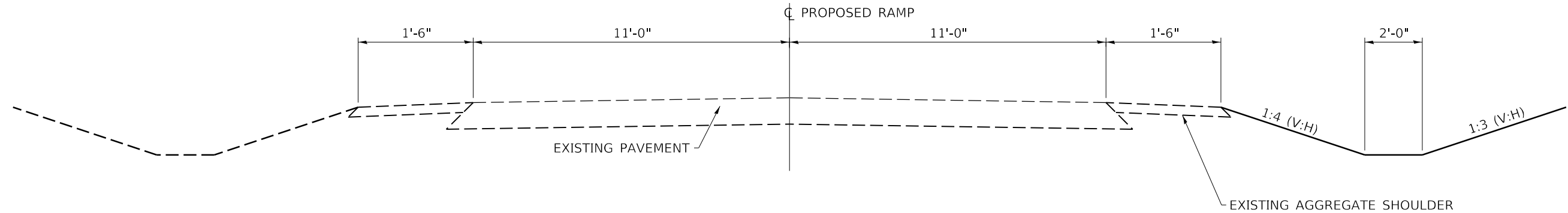

**PROPOSED TYPICAL SECTION**

TO BE USED:  
IL 127

USER NAME = colemm	DESIGNED -	REVISED -
	DRAWN -	REVISED -
PLOT SCALE = 100.0000' / in.	CHECKED -	REVISED -
PLOT DATE = 8/26/2020	DATE -	REVISED -

**STATE OF ILLINOIS  
DEPARTMENT OF TRANSPORTATION**

<b>TYPICAL SECTION</b>	
SCALE:	SHEET OF SHEETS STA. TO STA.

F.A.S. RTE.	SECTION	COUNTY	TOTAL SHEETS	SHEET NO.
1909	22B-4	UNION	37	10
CONTRACT NO. 78505				
ILLINOIS FED. AID PROJECT				





### SEEDING SCHEDULE

LOCATION STATION TO STATION			SEEDING CL 2	SEEDING CL 7	NITROGEN FERTILIZER NUTRIENT	PHOSPHOROUS FERTILIZER NUTRIENT	POTASSIUM FERTILIZER NUTRIENT	AGRICULTURAL GROUND LIMESTONE	MULCH METHOD 2	TEMPORARY DITCH CHECKS	EROSION CONTROL BLANKET	TEMPORARY EROSION CONTROL SEEDING
IL 127			ACRE	ACRE	POUND	POUND	POUND	TON	ACRE	FOOT	SQ YD	POUND
343+00.	TO	343+50.	0.04	0.04	335.7	167.9	167.9	0.07	0.07	0		7.5
343+50.	TO	344+00.	0.07	0.07	647.7	323.9	323.9	0.14	0.14	9	50	14.4
344+00.	TO	344+50.	0.07	0.07	594.0	297.0	297.0	0.13	0.13	9	50	13.2
344+50.	TO	345+00.	0.04	0.04	384.8	192.4	192.4	0.09	0.09	9	50	8.6
345+00.	TO	345+50.	0.01	0.01	134.3	67.1	67.1	0.03	0.03	0	50	3.0
345+50.	TO	346+00.	0.01	0.01	108.0	54.0	54.0	0.02	0.02	0	50	2.4
346+00.	TO	346+50.	0.03	0.03	263.4	131.7	131.7	0.06	0.06	9	50	5.9
346+50.	TO	347+00.	0.05	0.05	429.8	214.9	214.9	0.10	0.10	9	50	9.6
347+00.	TO	347+50.	0.06	0.06	583.2	291.6	291.6	0.13	0.13	9	50	13.0
347+50.	TO	348+00.	0.07	0.07	646.2	323.1	323.1	0.14	0.14	9	50	14.4
348+00.	TO	348+50.	0.08	0.08	747.9	374.0	374.0	0.17	0.17	9	50	16.6
348+50.	TO	349+00.	0.09	0.09	819.2	409.6	409.6	0.18	0.18	9	50	18.2
349+00.	TO	349+50.	0.08	0.08	711.3	355.6	355.6	0.16	0.16	9	50	15.8
349+50.	TO	350+00.	0.04	0.04	375.5	187.8	187.8	0.08	0.08	9	50	8.3
350+00.	TO	350+50.	0.02	0.02	179.2	89.6	89.6	0.04	0.04	9	50	4.0
350+50.	TO	351+00.	0.03	0.03	235.0	117.5	117.5	0.05	0.05	18	50	5.2
<b>TOTALS</b>			<b>0.8</b>	<b>0.8</b>	<b>7,196</b>	<b>3,598</b>	<b>3,598</b>	<b>1.6</b>	<b>1.6</b>	<b>126</b>	<b>750</b>	<b>160</b>

### SEEDING SCHEDULE

LOCATION STATION TO STATION			SEEDING CL 2	SEEDING CL 7	NITROGEN FERTILIZER NUTRIENT	PHOSPHOROUS FERTILIZER NUTRIENT	POTASSIUM FERTILIZER NUTRIENT	AGRICULTURAL GROUND LIMESTONE	MULCH METHOD 2	TEMPORARY DITCH CHECKS	EROSION CONTROL BLANKET	TEMPORARY EROSION CONTROL SEEDING
CHESTNUT ST.			ACRE	ACRE	POUND	POUND	POUND	TON	ACRE	FOOT	SQ YD	POUND
100+00.	TO	100+50.	0.04	0.04	370.4	185.2	185.2	0.08	0.08	8	45	8.2
100+50.	TO	101+00.	0.11	0.11	960.2	480.1	480.1	0.21	0.21	8	45	21.3
101+00.	TO	101+50.	0.15	0.15	1308.4	654.2	654.2	0.29	0.29	16	45	29.1
101+50.	TO	102+00.	0.16	0.16	1416.8	708.4	708.4	0.31	0.31	32	45	31.5
102+00.	TO	102+50.	0.15	0.15	1362.6	681.3	681.3	0.30	0.30	24	45	30.3
102+50.	TO	103+00.	0.15	0.15	1337.3	668.6	668.6	0.30	0.30	32	45	29.7
103+00.	TO	103+50.	0.15	0.15	1385.3	692.7	692.7	0.31	0.31	24	45	30.8
103+50.	TO	104+00.	0.14	0.14	1235.0	617.5	617.5	0.27	0.27	32	45	27.4
104+00.	TO	104+50.	0.11	0.11	947.3	473.7	473.7	0.21	0.21	24	45	21.1
104+50.	TO	105+00.	0.09	0.09	768.1	384.0	384.0	0.17	0.17	24	45	17.1
105+00.	TO	105+50.	0.08	0.08	755.2	377.6	377.6	0.17	0.17	32	45	16.8
105+50.	TO	105+68.88	0.00	0.00	0.0	0.0	0.0	0.00	0.00		17	0.0
<b>TOTALS</b>			<b>1.4</b>	<b>1.4</b>	<b>11,847</b>	<b>5,924</b>	<b>5,924</b>	<b>2.7</b>	<b>2.7</b>	<b>256</b>	<b>512</b>	<b>264</b>

MODEL: Default  
 FILE: Model: P:\pub\baronm.dwg  
 PROJECT: 78505\CADD\Drawings\DOT - Office\Drawings\78505-SubB-Typ\_Sch\_The\_CepeatElements

USER NAME = colemm	DESIGNED -	REVISED -
	DRAWN -	REVISED -
PLOT SCALE = 100,0000' / in.	CHECKED -	REVISED -
PLOT DATE = 8/26/2020	DATE -	REVISED -

**STATE OF ILLINOIS  
DEPARTMENT OF TRANSPORTATION**

**SEEDING SCHEDULE**

SCALE: SHEET OF SHEETS STA. TO STA.

F.A.S. RTE.	SECTION	COUNTY	TOTAL SHEETS	SHEET NO.
1909	22B-4	UNION	37	13
CONTRACT NO. 78505				
ILLINOIS FED. AID PROJECT				

### EXCAVATION SCHEDULE

LOCATION STATION TO STATION	EARTH EXCAVATION CU YD	FOR INFORMATION ONLY			
		AVERAGE SHRINKAGE FACTOR %	EARTH EXCAVATION (ADJUSTED) CU YD	EMBANKMENT CU YD	EARTHWORK BALANCE WASTE(+) SHORTAGE(-) CU YD
		IL 127			
343+00 TO 351+00	3,492	0.0	3492	0	3,492
<b>TOTALS</b>	<b>3,492</b>				

### EXCAVATION SCHEDULE

LOCATION STATION TO STATION	EARTH EXCAVATION CU YD	FOR INFORMATION ONLY				ROCK EXCAVATION CU YD
		AVERAGE SHRINKAGE FACTOR %	EARTH EXCAVATION (ADJUSTED) CU YD	EMBANKMENT CU YD	EARTHWORK BALANCE WASTE(+) SHORTAGE(-) CU YD	
		CHESTNUT ST.				
100+00 TO 105+68.88	26,816	27.8	19369	157	19,212	344
<b>TOTALS</b>	<b>26,816</b>					<b>344</b>

### PAVEMENT SCHEDULE

LOCATION	HMA SURFACE COURSE, MIX C, N70	AGGREGATE SHOULDERS , TYPE B, 4"	AGGREGATE BASE COURSE, TYPE B, 8"	SUBBASE GRANULAR MATERIAL, TYPE B, 3"	PAVEMENT REMOVAL	BITUMINOUS MATERIALS (TACK COAT)	HMA SURFACE REMOVAL - BUTT JOINT	TEMPORARY RAMP
STATION TO STATION	TON	TON	TON	TON	SQ YD	POUND	SQ YD	SQ YD
<b>CHESTNUT ST. RAMP</b>								
100+00.00 TO 101+00.00	66.2	29.87	208.96			605.0	73.3	13
101+00.00 TO 105+68.89	218.8	140.04	770.23	25.39	243.7	2836.8	126.7	22
<b>CHESTNUT ST.</b>								
7+04.00 TO 8+13.00	16.3		78.61			149.9		
9+23.00 TO 9+40.00					167.6			
10+57.00 TO 10+76.00					57.7			
<b>TOTALS</b>	<b>302</b>	<b>170</b>	<b>1058</b>	<b>26</b>	<b>469</b>	<b>3592</b>	<b>200</b>	<b>35</b>

### PAVEMENT MARKING SCHEDULE

LOCATION	TEMPORARY PAVEMENT MARKING LINE-4"	TEMPORARY PAVEMENT MARKING LINE-24"	PAVEMENT MARKING REMOVAL -GRINDING	PAINT PAVEMENT MARKING LINE-4"	PAINT PAVEMENT MARKING LINE-24"	SHORT TERM PAVEMENT MARKING	SHORT TERM PAVEMENT MARKING REMOVAL
STATION TO STATION	FOOT	FOOT	SQ FT	FOOT	FOOT	FOOT	SQ FT
<b>CHESTNUT ST. RAMP</b>							
100+00. TO 105+68.89	1,281	30	487	1,281	30	52	18
<b>IL 127</b>							
345+33 TO 346+05			72				
<b>TOTALS</b>	<b>1,281</b>	<b>30</b>	<b>559</b>	<b>1,281</b>	<b>30</b>	<b>52</b>	<b>18</b>

MODEL: Default  
 FILE: h:\mfc\_2010\pub\harron.mxd  
 PROJECT: 78505\CAAD\Drawings\DOT - Office\Drawings\9\Projects\78505\CAAD\Drawings\DOT - Office\Drawings\9\Projects\78505\SHB-Tra\_Sch\_The\_GeopakElements

USER NAME = colemm	DESIGNED -	REVISED -
	DRAWN -	REVISED -
PLOT SCALE = 100.0000' / in.	CHECKED -	REVISED -
PLOT DATE = 8/26/2020	DATE -	REVISED -

**STATE OF ILLINOIS  
 DEPARTMENT OF TRANSPORTATION**

<b>EXCAVATION, PAVEMENT &amp;                  PAVEMENT MARKING SCHEDULE</b>			
SCALE:	SHEET	OF	SHEETS
	STA.	TO	STA.

F.A.S. RTE.	SECTION	COUNTY	TOTAL SHEETS	SHEET NO.
1909	22B-4	UNION	37	14
CONTRACT NO. 78505				
ILLINOIS FED. AID PROJECT				

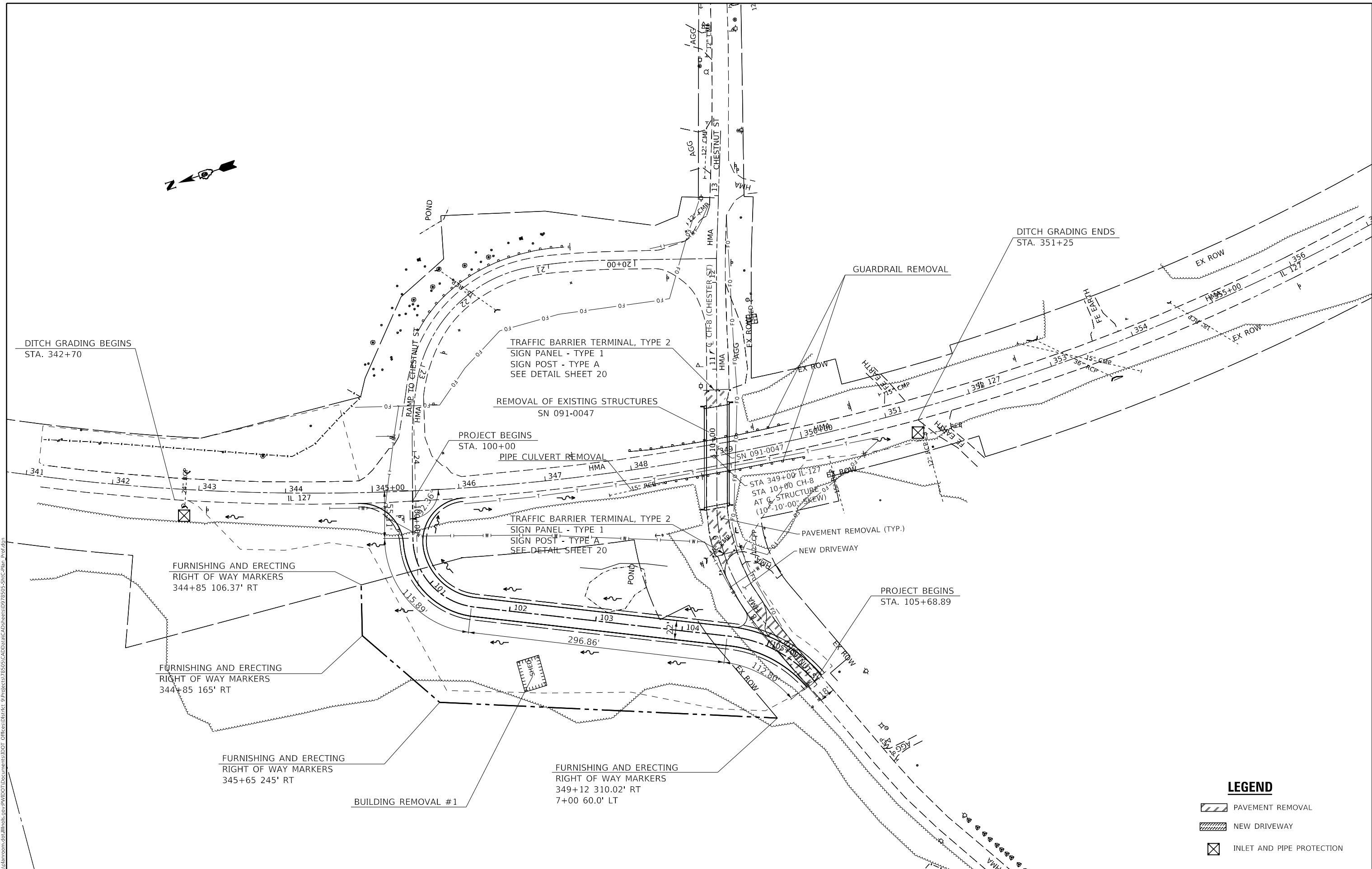

**LEGEND**

- PAVEMENT REMOVAL
- NEW DRIVEWAY
- INLET AND PIPE PROTECTION

MODEL: Default  
 FILE: \\bls01c:\pub\baronm.dwg  
 PROJECT: 78505\CADD\Drawings\DOT\Office\Drawings\9\Projects\78505\CADD\Drawings\9\Projects\78505-Sht-C-Plan\_Plan.dwg

USER NAME = colemm	DESIGNED -	REVISED -
	DRAWN -	REVISED -
PLOT SCALE = 100,0000' / in.	CHECKED -	REVISED -
PLOT DATE = 8/26/2020	DATE -	REVISED -

**STATE OF ILLINOIS  
DEPARTMENT OF TRANSPORTATION**

SCALE:		SHEET OF SHEETS		STA.	TO STA.

**PLAN SHEET**

F.A.S. RTE.	SECTION	COUNTY	TOTAL SHEETS	SHEET NO.
1909	22B-4	UNION	37	15
CONTRACT NO. 78505				
ILLINOIS FED. AID PROJECT				





















# SOIL BORING LOG

Date 7/2/20

ROUTE IL 127 DESCRIPTION Rock Survey for Chestnut St Relocation LOGGED BY L. Estel  
 SECTION 22B-4 LOCATION Int. of Chestnut St and IL 127 (Alto Pass), SEC. 10, TWP. 11S, RNG. 2W, 3 PM  
 COUNTY Union DRILLING METHOD Hollow stem auger (8" O.D., 3.25" I.D.) HAMMER TYPE Auto SPT 140 lb

STRUCT. NO.	DEPTH	BLOW	UCS	MOIST	Surface Water Elev.	DEPTH	BLOW	UCS	MOIST
Station	(ft)	(tsf)	(%)	ft	(ft)	(tsf)	(%)	ft	(ft)
4-RS	104+80								
	14.0ft Lt								
	Ground Surface Elev. 774.2								
Augered to bedrock					Bottom of hole @ 14.9 ft				
					Elevation referenced to Ground Shot at Survey Point L21; Elev. 775.45				
					To convert "N" values to "N60", multiply by 1.5; Hammer efficiency = 88.9%				
					No groundwater encountered				
					-5				
					-10				
					-15				
					-20				
					-25				
					-30				
					-35				
					-40				
Hard Grey, Dry Weathered CLAY SHALE					759.70				
Hard Brown and Tan, Dry SANDSTONE					759.40				
					60/4.75"				
					then 50/0"				

The Unconfined Compressive Strength (UCS) Failure Mode is indicated by (B-Bulge, S-Shear, P-Penetrometer, E-Estimated) Abbreviations W.O.H - Sampler Advanced By Weight of Hammer, W.O.P - Advanced by Weight of Pipe, B.S. - Before Seating The SPT (N value) is the sum of the last two blow values in each sampling zone (AASHTO T206) BBS, from 137 (Rev. 8-99)



# SOIL BORING LOG

Date 7/14/20

ROUTE IL 127 DESCRIPTION Rock Survey for Chestnut St Relocation LOGGED BY L. Estel  
 SECTION 22B-4 LOCATION Int. of Chestnut St and IL 127 (Alto Pass), SEC. 10, TWP. 11S, RNG. 2W, 3 PM  
 COUNTY Union DRILLING METHOD Hollow stem auger (8" O.D., 3.25" I.D.) HAMMER TYPE Auto SPT 140 lb

STRUCT. NO.	DEPTH	BLOW	UCS	MOIST	Surface Water Elev.	DEPTH	BLOW	UCS	MOIST
Station	(ft)	(tsf)	(%)	ft	(ft)	(tsf)	(%)	ft	(ft)
5-RS	103+85								
	67.0ft Rt								
	Ground Surface Elev. 788.8								
Augered to bedrock					Augered to bedrock (continued)				
					766.80				
					100/2"				
					Hard Grey and Brown, Dry CLAY SHALE with SANDSTONE				
					(Borehole continued with rock coring.)				
					-5				
					-10				
					-15				
					-20				
					-25				
					-30				
					-35				
					-40				
					Bottom of hole @ 30.2 ft				
					Elevation referenced to Ground Shot at Survey Point L12; Elev. 788.75				
					To convert "N" values to "N60", multiply by 1.5; Hammer efficiency = 88.9%				
					Polymer drilling fluid used for rock coring				
					No groundwater encountered				

The Unconfined Compressive Strength (UCS) Failure Mode is indicated by (B-Bulge, S-Shear, P-Penetrometer, E-Estimated) Abbreviations W.O.H - Sampler Advanced By Weight of Hammer, W.O.P - Advanced by Weight of Pipe, B.S. - Before Seating The SPT (N value) is the sum of the last two blow values in each sampling zone (AASHTO T206) BBS, from 137 (Rev. 8-99)

File Name: S:\MATERIALS GEOTECHNICAL\UNIT\GINT\PROJECTS\PROJECTS\FILE\UNION\ROADWAY\ROADWAY BORING LOGS\ROCK SURVEY\CHESTNUT STALTO PASS\SC020.GPJ Data Template: D6TEMP1.T.GDT Date Printed: 7/17/20

File Name: S:\MATERIALS GEOTECHNICAL\UNIT\GINT\PROJECTS\PROJECTS\FILE\UNION\ROADWAY\ROADWAY BORING LOGS\ROCK SURVEY\CHESTNUT STALTO PASS\SC020.GPJ Data Template: D6TEMP1.T.GDT Date Printed: 7/17/20

MODEL: Default  
FILE: Model\_Plot.dwg  
PLOT DATE: 8/26/2020

USER NAME = colemm	DESIGNED -	REVISED -
	DRAWN -	REVISED -
PLOT SCALE = 100,0000' / in.	CHECKED -	REVISED -
PLOT DATE = 8/26/2020	DATE -	REVISED -

STATE OF ILLINOIS  
DEPARTMENT OF TRANSPORTATION

SCALE:		SHEET	OF	SHEETS	STA.	TO	STA.
--------	--	-------	----	--------	------	----	------

SOIL BORING LOG

F.A.S. RTE.	SECTION	COUNTY	TOTAL SHEETS	SHEET NO.
1909	22B-4	UNION	37	24
CONTRACT NO. 78505				
ILLINOIS FED. AID PROJECT				





# ROCK CORE LOG

Date 7/14/20

ROUTE IL 127 DESCRIPTION Rock Survey for Chestnut St Relocation LOGGED BY L. Estel

SECTION 22B-4 LOCATION Int. of Chestnut St and IL 127 (Alto Pass), SEC. 10, TWP. 11S, RNG. 2W, 3 PM

COUNTY Union CORING METHOD Conventional rotary with water

STRUCT. NO. \_\_\_\_\_ CORING BARREL TYPE & SIZE NV3 5FT NWJ  
 Station \_\_\_\_\_  
 BORING NO. 5-RS Core Diameter 1.78 in  
 Station 103+85 Top of Rock Elev. 766.80 ft  
 Offset 67.0ft Rt Begin Core Elev. 766.64 ft  
 Ground Surface Elev. 788.8 ft

DEPTH (ft)	CORE (#)	RECOVERY (%)	R.Q.D. (%)	CORE TIME (min/ft)	STRENGTH (tsf)
0	1	33	0	8	
25					
30	2	47	0	12	
30.2					
35					
40					

Hard Grey and Brown, Dry CLAY SHALE with SANDSTONE

Bottom of hole @ 30.2 ft  
 Elevation referenced to Ground Shot at Survey Point L12; Elev. 788.75  
 Polymer drilling fluid used for rock coring

Color pictures of the cores Yes, attached  
 Cores will be stored for examination until Const. complete  
 The "Strength" column represents the uniaxial compressive strength of the core sample (ASTM D-2938)  
 RQD is the ratio of the total length of sound core specimens >4" to total length of core run BBS, form 138 (Rev. 8-99)



# SOIL BORING LOG

Date 7/14/20

ROUTE IL 127 DESCRIPTION Rock Survey for Chestnut St Relocation LOGGED BY L. Estel

SECTION 22B-4 LOCATION Int. of Chestnut St and IL 127 (Alto Pass), SEC. 10, TWP. 11S, RNG. 2W, 3 PM

COUNTY Union DRILLING METHOD Hollow stem auger (8" O.D., 3.25" I.D.) HAMMER TYPE Auto SPT 140 lb

STRUCT. NO. \_\_\_\_\_  
 Station \_\_\_\_\_  
 BORING NO. 6-RS  
 Station 101+50  
 Offset 90.0ft Rt  
 Ground Surface Elev. 787.2 ft

Surface Water Elev. \_\_\_\_\_ ft  
 Stream Bed Elev. \_\_\_\_\_ ft  
 Groundwater Elev.:  
 First Encounter 766.5 ft  
 Upon Completion \_\_\_\_\_ ft  
 After \_\_\_\_\_ Hrs. \_\_\_\_\_ ft

DEPTH (ft)	BLOWS	UCS (tsf)	MOIST (%)	DEPTH (ft)	BLOWS	UCS (tsf)	MOIST (%)
0				0			
21.0				21.0			
25				25			
30				30			
35				35			
40				40			

Augered to bedrock

Augered to bedrock (continued) 766.45  
 Hard Brown, Dry SANDSTONE 100/2.5"

Bottom of hole @ 21.0 ft  
 Elevation referenced to Ground Shot at Survey Point L16; Elev. 787.15  
 To convert "N" values to "N60", multiply by 1.5; Hammer efficiency = 88.9%

The Unconfined Compressive Strength (UCS) Failure Mode is indicated by (B-Bulge, S-Shear, P-Penetrometer, E-Estimated)  
 Abbreviations W.O.H - Sampler Advanced By Weight of Hammer, W.O.P - Advanced by Weight of Pipe, B.S. - Before Seating  
 The SPT (N value) is the sum of the last two blow values in each sampling zone (AASHTO T206) BBS, from 137 (Rev. 8-99)

MODEL: Default  
 FILE: \\hpc101\pub\baronm.d\at\illinois.gov\PROJECTS\2020\GPJ\Documents\DOT\_Offices\District 9\Projects\78505\CADD\Drawings\978505-Sht-02a1.dgn  
 ROCK CORE ROCKSURVEYCHESTNUTSTALTOPASS2020.GPJ D:\TEMP\T.GDT 7/17/20

FILE Name: S:\MATERIALS GEOTECHNICAL UNIT\GINT\PROJECTS\PROJECTS\FILE\UNION\ROADWAY\ROADWAY BORING LOGS\ROCKSURVEYCHESTNUTSTALTOPASS2020.GPJ Data Template: D6\TEMP\T.GDT Date Printed: 7/17/20  
 Latitude: 34.16.77 Longitude: -88.19.28.57 Datum: NAD83 Job Number:

USER NAME = colemm	DESIGNED -	REVISED -
DRAWN -	REVISED -	
PLOT SCALE = 100,0000' / in.	CHECKED -	REVISED -
PLOT DATE = 8/26/2020	DATE -	REVISED -

STATE OF ILLINOIS  
 DEPARTMENT OF TRANSPORTATION

SOIL BORING LOG

SCALE: SHEET OF SHEETS STA. TO STA.

F.A.S. RTE.	SECTION	COUNTY	TOTAL SHEETS	SHEET NO.
1909	22B-4	UNION	37	25
CONTRACT NO. 78505			ILLINOIS FED. AID PROJECT	

FINAL SURVEY	SURVEYED	DATE
NOTE BOOK	PLOTTED	BY
NO.	TEMPLATE	
	AREAS CHECKED	
	AREAS CHECKED	

ORIGINAL SURVEY	SURVEYED	DATE
NOTE BOOK	PLOTTED	BY
NO.	TEMPLATE	
	AREAS CHECKED	
	AREAS CHECKED	

MODEL: Default  
 FILE NAME: D:\v\lham\com.d\all\mils.gov\PWIDOT\Documents\DOT\_Offices\District\_9\Project\78505\CAD\Drawings\DWG\78505-Stru-X\Section.dwg

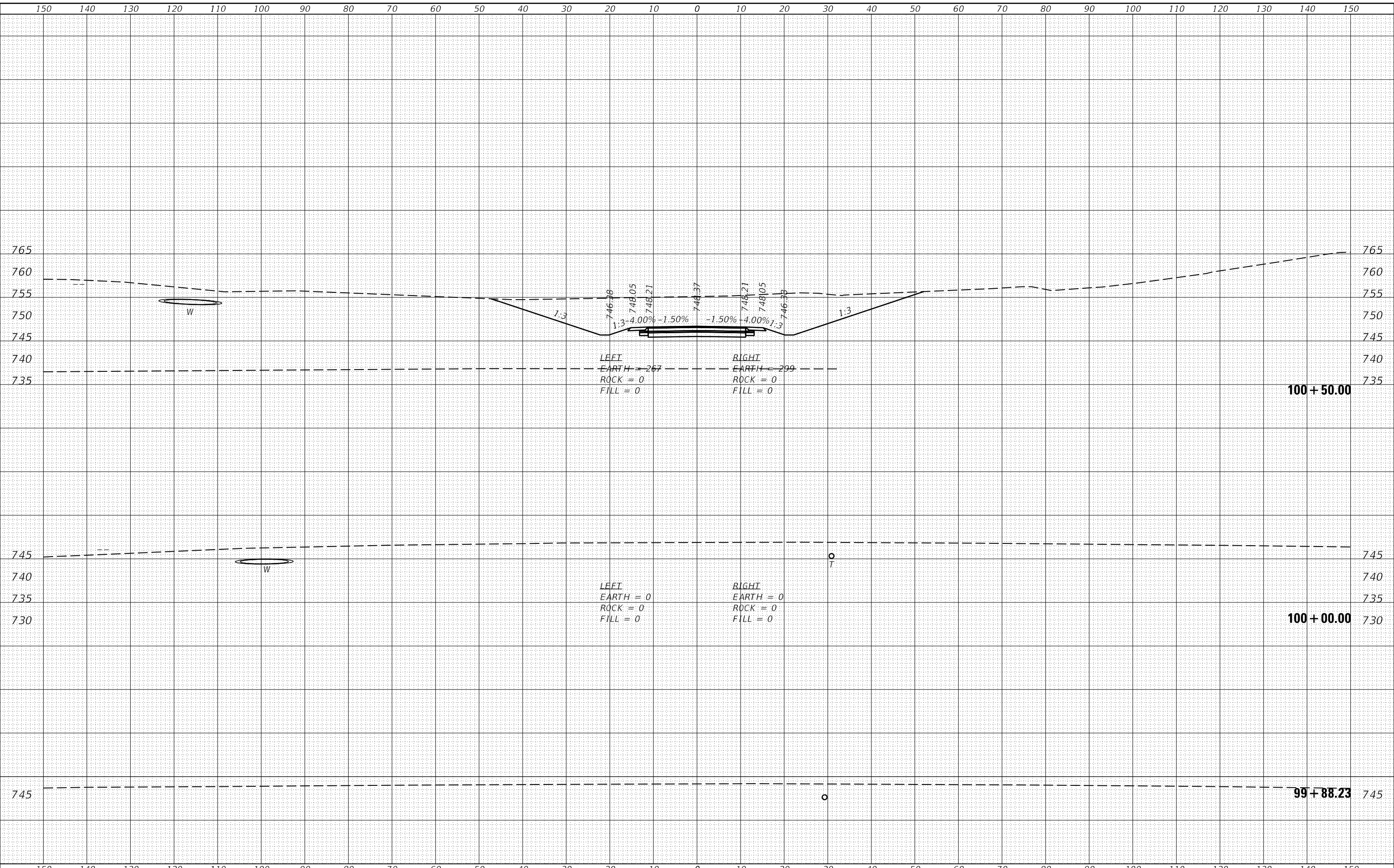

USER NAME = colemm	DESIGNED -	REVISD -
	DRAWN -	REVISD -
PLOT SCALE = 20.0000' / in.	CHECKED -	REVISD -
PLOT DATE = 8/26/2020	DATE -	REVISD -

**STATE OF ILLINOIS  
 DEPARTMENT OF TRANSPORTATION**

<b>CROSS SECTIONS</b>	
<b>RAMP</b>	
SCALE:	SHEET OF SHEETS
STA. 99+88.23 TO STA. 100+50.00	

F.A.S. RTE.	SECTION	COUNTY	TOTAL SHEETS	SHEET NO.
1909	22B-4	UNION	37	26
				CONTRACT NO. 78505
		ILLINOIS	FED. AID PROJECT	

FINAL SURVEY NO.	SURVEYED	DATE
NOTE BOOK	PLOTTED	
AREAS CHECKED	TEMPLATE	
	AREAS CHECKED	

ORIGINAL SURVEY NO.	SURVEYED	DATE
NOTE BOOK	PLOTTED	
AREAS CHECKED	TEMPLATE	
	AREAS CHECKED	

MODEL: Default  
 FILE NAME: D:\vll\m\com\ad\illinois\p\p\w\DOT Documents\DOT - Office\District 9\Projects\78505\CAD\Drawings\DW 78505-Stru-X\Section.dgn

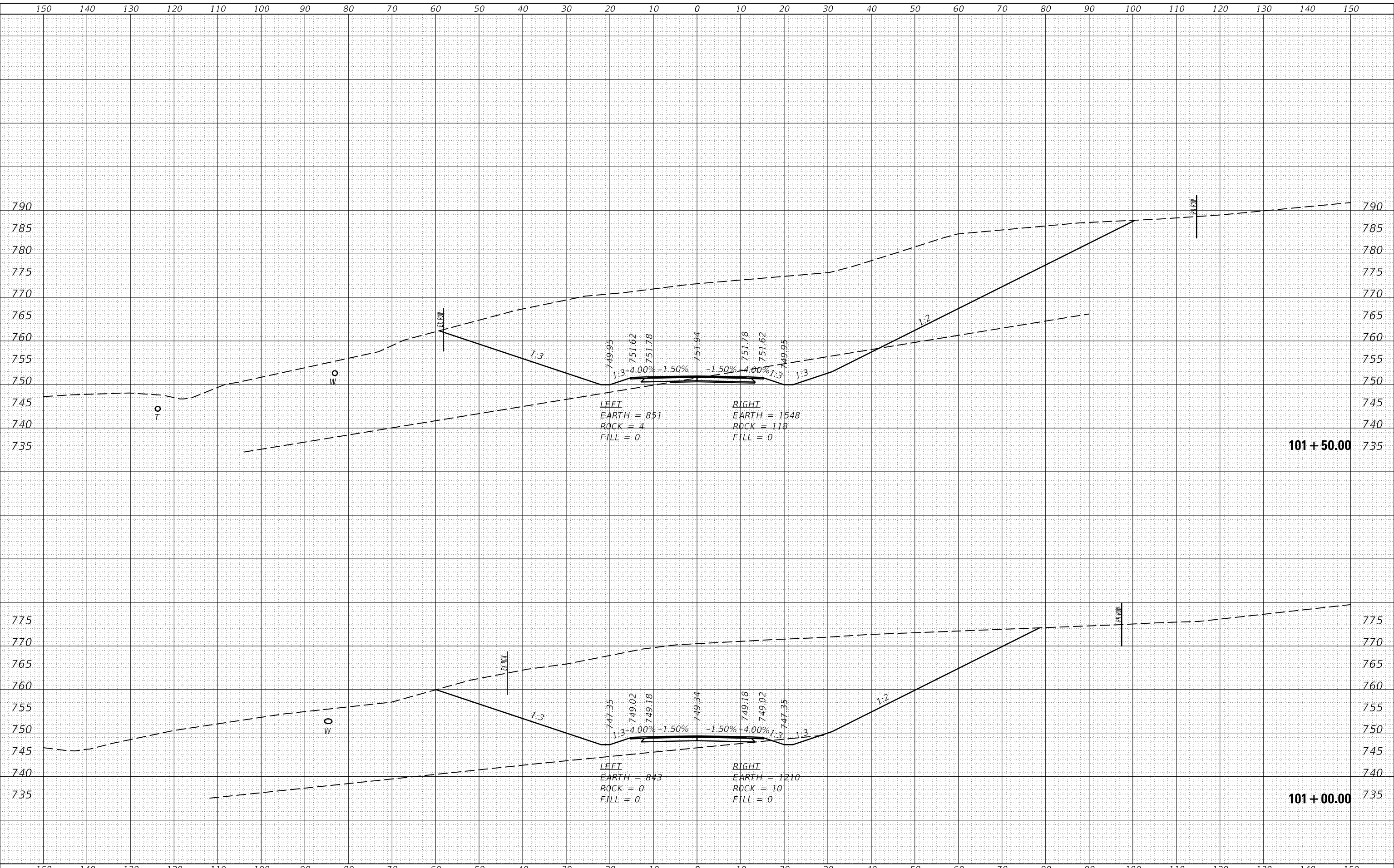

USER NAME = colemm	DESIGNED -	REVISD -
	DRAWN -	REVISD -
PLOT SCALE = 20.0000' / in.	CHECKED -	REVISD -
PLOT DATE = 8/26/2020	DATE -	REVISD -

**STATE OF ILLINOIS  
 DEPARTMENT OF TRANSPORTATION**

<b>CROSS SECTIONS</b>	
<b>RAMP</b>	
SCALE:	SHEET OF SHEETS
STA. 101+00.00 TO STA. 101+50.00	

F.A.S. RTE. 1909	SECTION 22B-4	COUNTY UNION	TOTAL SHEETS 37	SHEET NO. 27
CONTRACT NO. 78505				
ILLINOIS FED. AID PROJECT				

DATE	
BY	
FINAL SURVEY	SURVEYED
NOTE BOOK	PLOTTED
NO.	TEMPLATE
	AREAS CHECKED

DATE	
BY	
ORIGINAL SURVEY	SURVEYED
NOTE BOOK	PLOTTED
NO.	TEMPLATE
	AREAS CHECKED

MODEL: Default  
 FILE NAME: D:\vbl\m\com\ad\illinois\p\p\WIDOT\Documents\DOT\_Offices\District\_9\Projects\78505\CAD\Drawings\DOT\_78505-Sht-LX-Section.dgn

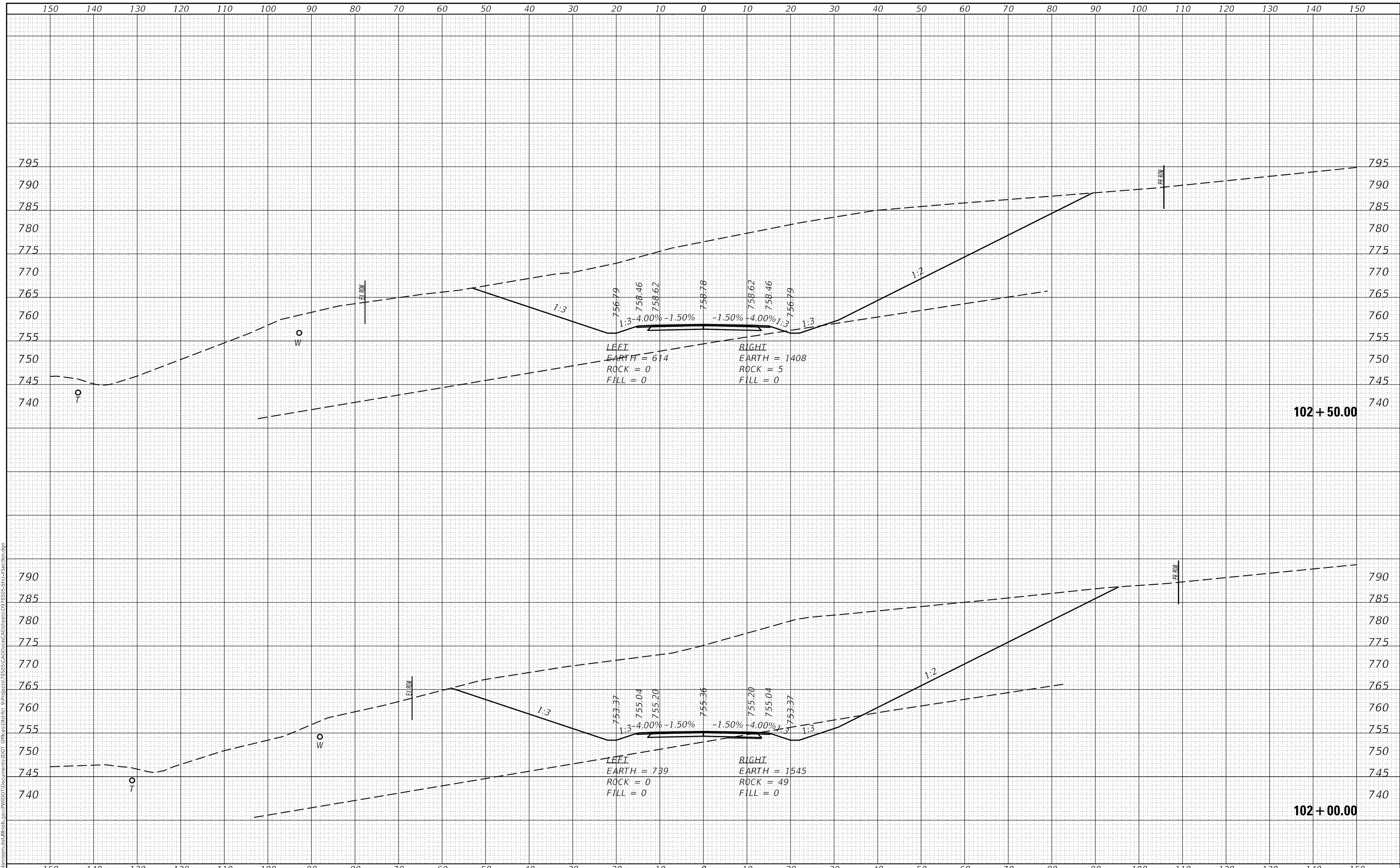

USER NAME = colemm	DESIGNED -	REVISD -
	DRAWN -	REVISD -
PLOT SCALE = 20.0000 ' / in.	CHECKED -	REVISD -
PLOT DATE = 8/26/2020	DATE -	REVISD -

**STATE OF ILLINOIS  
 DEPARTMENT OF TRANSPORTATION**

<b>CROSS SECTIONS</b>	
<b>RAMP</b>	
SCALE:	SHEET OF SHEETS
STA. 102+00.00 TO STA. 102+50.00	

F.A.S. RTE.	SECTION	COUNTY	TOTAL SHEETS	SHEET NO.
1909	22B-4	UNION	37	28
CONTRACT NO. 78505				
ILLINOIS FED. AID PROJECT				

DATE	
BY	
FINAL SURVEY	SURVEYED
NOTE BOOK	PLOTTED
NO.	TEMPLATE
	AREAS CHECKED

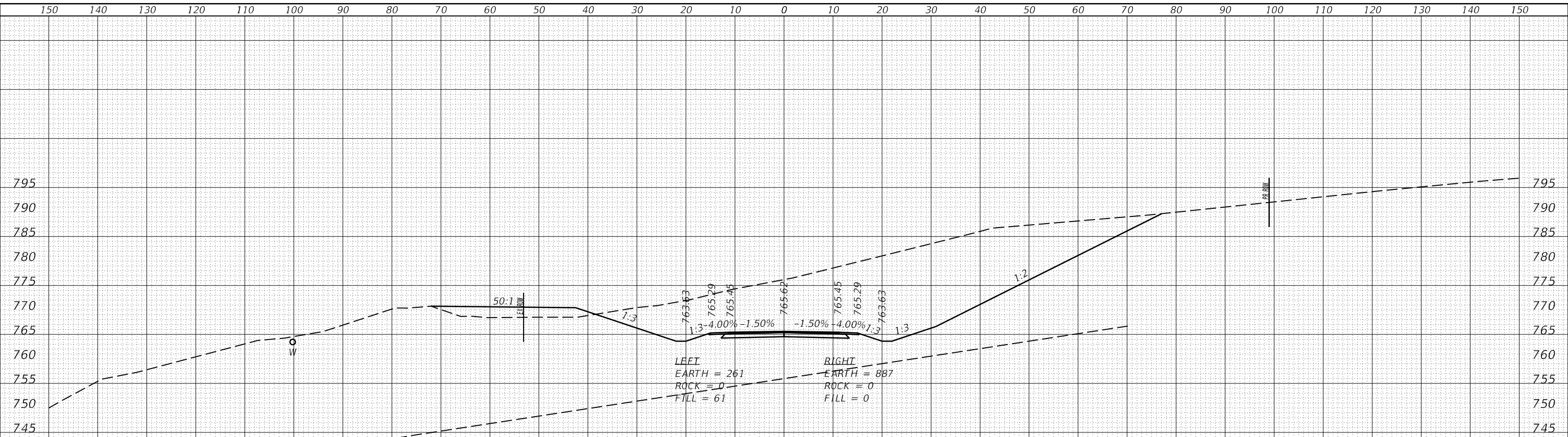

**103 + 50.00**

DATE	
BY	
ORIGINAL SURVEY	SURVEYED
NOTE BOOK	PLOTTED
NO.	TEMPLATE
	AREAS CHECKED

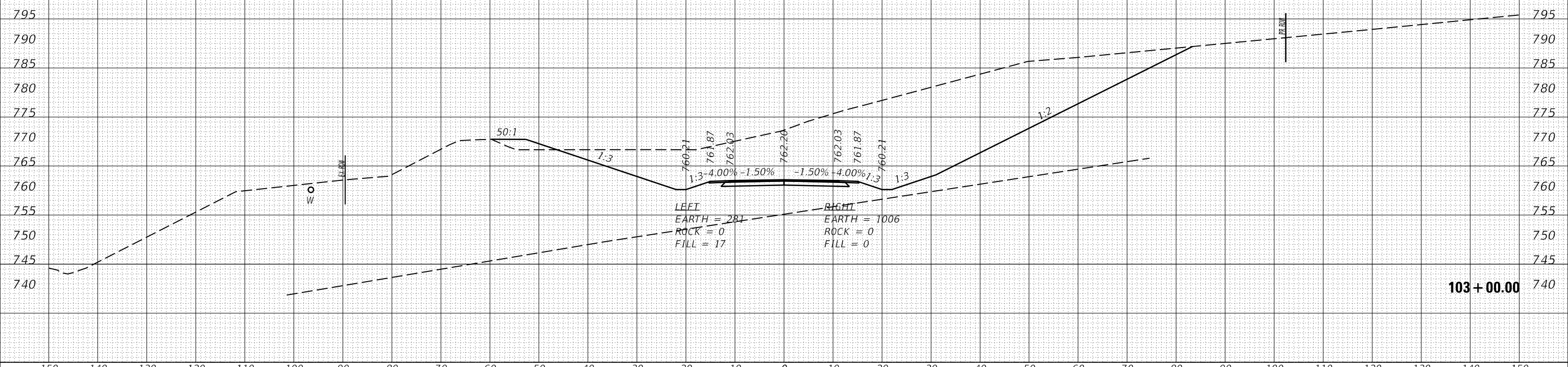

**103 + 00.00**

USER NAME = colemm	DESIGNED -	REVISIED -
	DRAWN -	REVISIED -
PLOT SCALE = 20.0000' / in.	CHECKED -	REVISIED -
PLOT DATE = 8/26/2020	DATE -	REVISIED -

**STATE OF ILLINOIS  
DEPARTMENT OF TRANSPORTATION**

<b>CROSS SECTIONS</b>	
<b>RAMP</b>	
SCALE:	SHEET OF SHEETS
STA. 103+00.00 TO STA. 103+50.00	

F.A.S. RTE.	SECTION	COUNTY	TOTAL SHEETS	SHEET NO.
1909	22B-4	UNION	37	29
CONTRACT NO. 78505				
ILLINOIS FED. AID PROJECT				

MODEL: Default  
FILE NAME: D:\vbl\m\com\ad\illinois\p\p\w\DOT\Documents\DOT\_Offices\District\_9\Projects\78505\CAD\Drawings\DOT\_78505-Stru-X\Section.dgn

FINAL SURVEY NO.	SURVEYED	DATE
NOTE BOOK	PLOTTED	BY
AREAS CHECKED	TEMPLATE	
	AREAS CHECKED	

ORIGINAL SURVEY NO.	SURVEYED	DATE
NOTE BOOK	PLOTTED	BY
AREAS CHECKED	TEMPLATE	
	AREAS CHECKED	

MODEL: Default  
 FILE NAME: D:\v\blm\com\ad\illinois\p\p\1010\Documents\DOT Office\District 9\Projects\78505\CAD\Drawings\DW 78505-Stru-X\Section.dgn

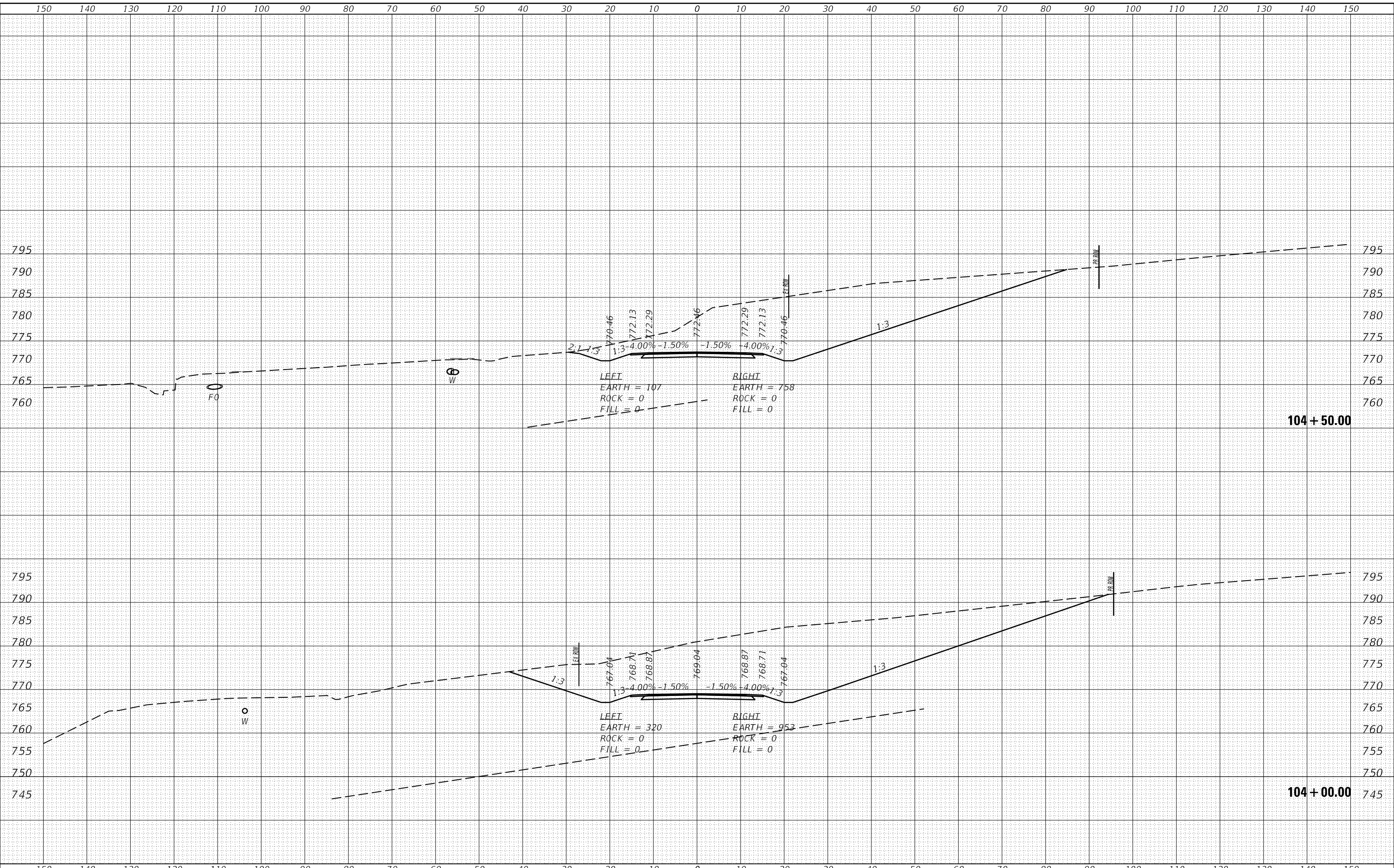

USER NAME = colemm	DESIGNED -	REVISIED -
	DRAWN -	REVISIED -
PLOT SCALE = 20.0000' / in.	CHECKED -	REVISIED -
PLOT DATE = 8/26/2020	DATE -	REVISIED -

**STATE OF ILLINOIS  
 DEPARTMENT OF TRANSPORTATION**

<b>CROSS SECTIONS</b>	
<b>RAMP</b>	
SCALE:	SHEET OF SHEETS
STA. 104+00.00 TO STA. 104+50.00	

F.A.S. RTE. 1909	SECTION 22B-4	COUNTY UNION	TOTAL SHEETS 37	SHEET NO. 30
CONTRACT NO. 78505				
ILLINOIS FED. AID PROJECT				

DATE	
BY	
FINAL SURVEY	SURVEYED
NOTE BOOK	PLOTTED
NO.	TEMPLATE
	AREAS CHECKED

DATE	
BY	
ORIGINAL SURVEY	SURVEYED
NOTE BOOK	PLOTTED
NO.	TEMPLATE
	AREAS CHECKED

MODEL: Default  
 FILE NAME: D:\v\l\m\com\ad\illinois\p\p\w\DOT\Documents\DOT\_Offices\District\_9\Projects\78505\CAD\Drawings\Section\78505-Stru-X\Section.dgn

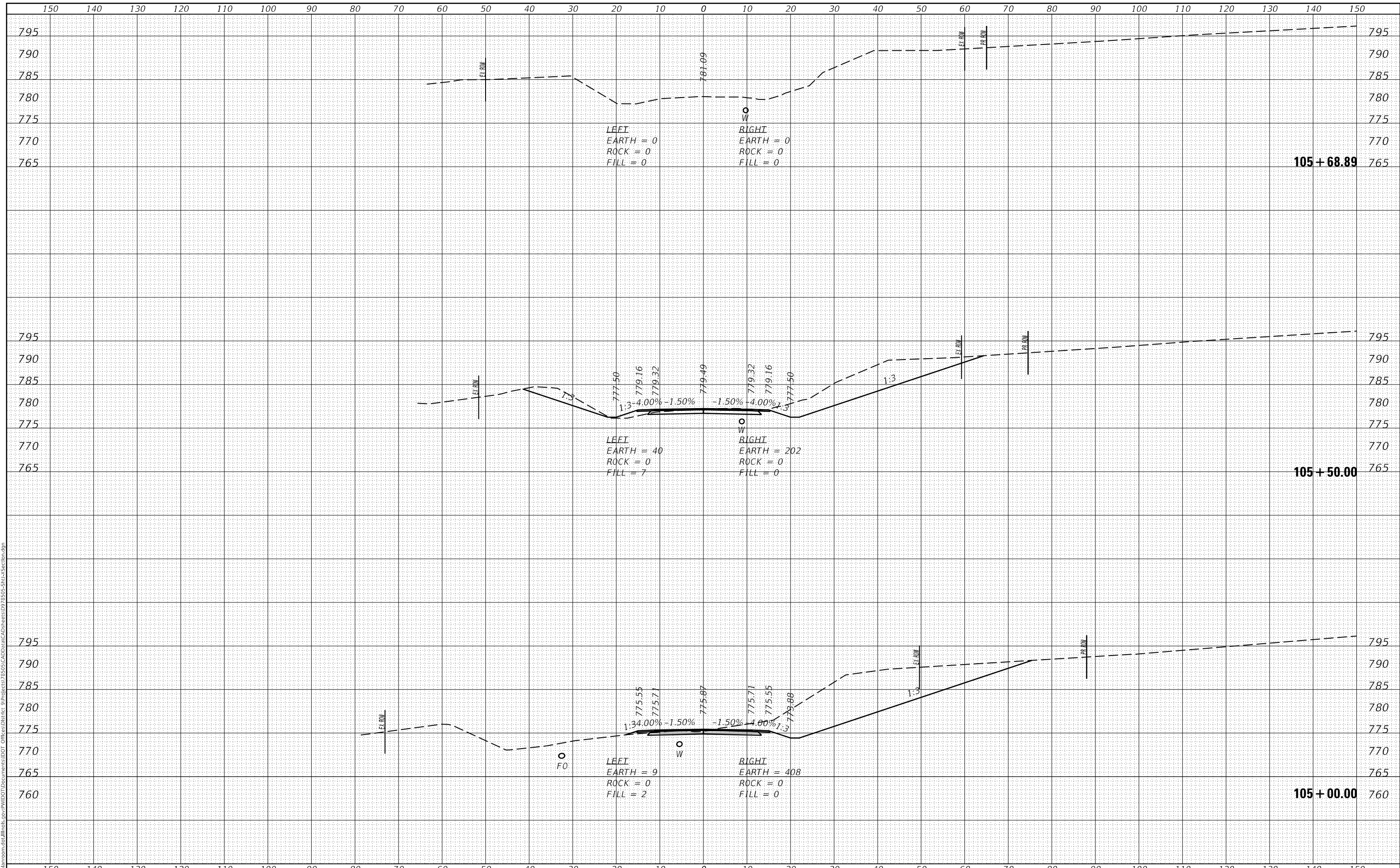

USER NAME = colemm	DESIGNED -	REVISED -
	DRAWN -	REVISED -
PLOT SCALE = 20.0000' / in.	CHECKED -	REVISED -
PLOT DATE = 8/26/2020	DATE -	REVISED -

**STATE OF ILLINOIS  
 DEPARTMENT OF TRANSPORTATION**

<b>CROSS SECTIONS RAMP</b>	
SCALE:	SHEET OF SHEETS
STA. 105+00.00 TO STA. 105+68.89	

F.A.S. RTE.	SECTION	COUNTY	TOTAL SHEETS	SHEET NO.
1909	22B-4	UNION	37	31
CONTRACT NO. 78505				
ILLINOIS FED. AID PROJECT				

DATE	
BY	
FINAL SURVEY NO.	
SURVEYED PLOTTED AREAS CHECKED	
TEMPLATE	
NOTE BOOK	
AREAS CHECKED	

DATE	
BY	
ORIGINAL SURVEY NO.	
SURVEYED PLOTTED AREAS CHECKED	
TEMPLATE	
NOTE BOOK	
AREAS CHECKED	

MODEL: Default  
 FILE NAME: D:\v\l\m\room\ad\illinois\p\p\w\DOT\Documents\DOT - Office\District 9\Projects\78505\CAD\Drawings\DOT\78505-Str\X-Section.dgn

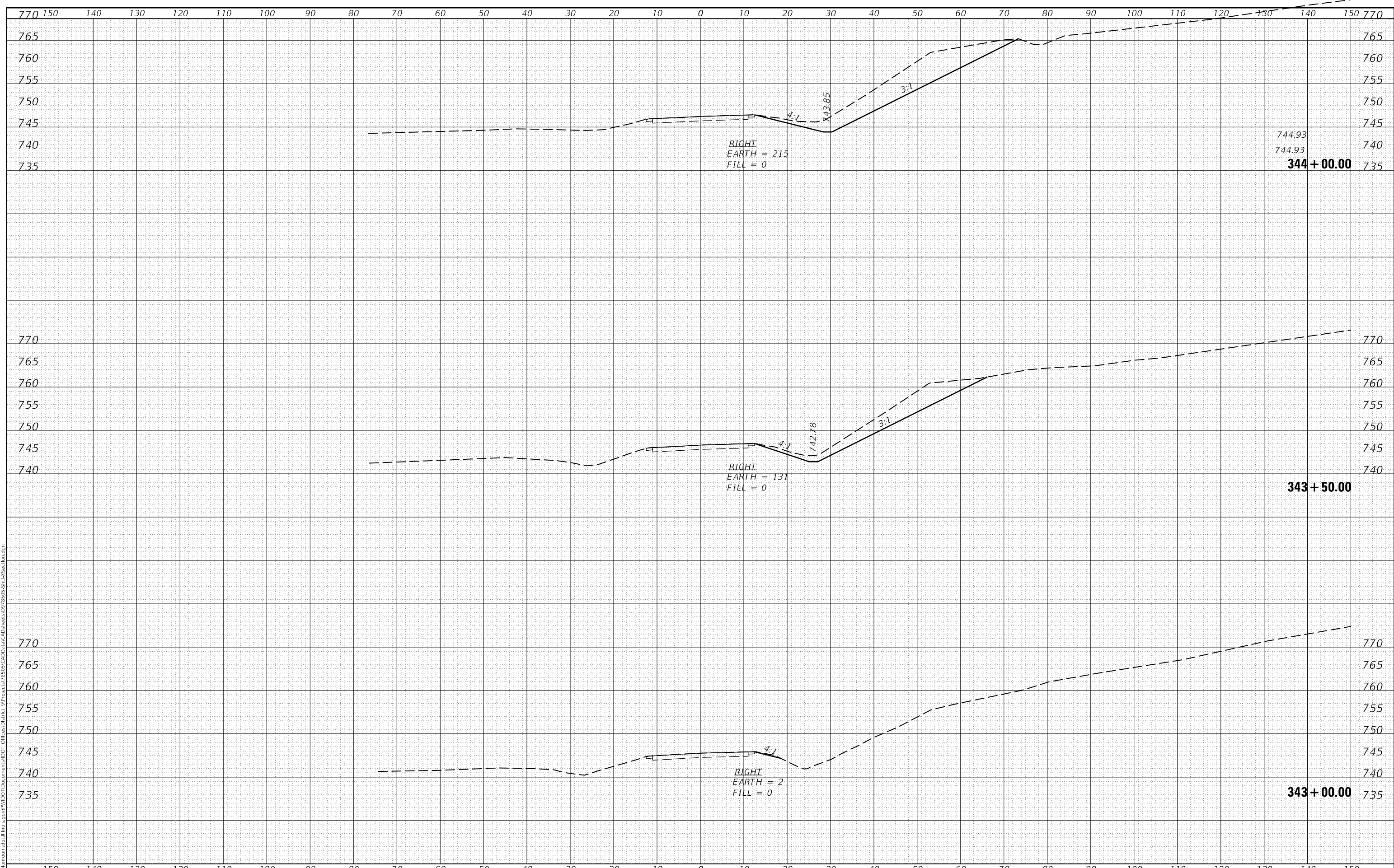

USER NAME = colemm	DESIGNED -	REVISD -
	DRAWN -	REVISD -
PLOT SCALE = 20.0000 ' / in.	CHECKED -	REVISD -
PLOT DATE = 8/26/2020	DATE -	REVISD -

**STATE OF ILLINOIS  
 DEPARTMENT OF TRANSPORTATION**

<b>CROSS SECTIONS</b>	
<b>IL 127</b>	
SCALE:	SHEET OF SHEETS
STA. 343+00.00 TO STA. 344+00.00	

F.A.S. RTE.	SECTION	COUNTY	TOTAL SHEETS	SHEET NO.
1909	22B-4	UNION	37	32
CONTRACT NO. 78505				
ILLINOIS FED. AID PROJECT				



DATE	
BY	
FINAL SURVEY NO.	
SURVEYED PLOTTED AREAS CHECKED	
NOTE BOOK NO.	
TEMPLATE AREAS CHECKED	

DATE	
BY	
ORIGINAL SURVEY NO.	
SURVEYED PLOTTED AREAS CHECKED	
NOTE BOOK NO.	
TEMPLATE AREAS CHECKED	

MODEL: Default  
 FILE NAME: D:\vllm\com\ad\illinois\p\p\w\DOT\Documents\DOT - Office\District 9\Projects\78505\CAD\Drawings\DOT\78505-Str\XSection.dgn



USER NAME = colemm	DESIGNED -	REVISED -
	DRAWN -	REVISED -
PLOT SCALE = 20.0000 ' / in.	CHECKED -	REVISED -
PLOT DATE = 8/26/2020	DATE -	REVISED -

**STATE OF ILLINOIS  
 DEPARTMENT OF TRANSPORTATION**

SCALE:		SHEET	OF	SHEETS	STA. 344+50.00	TO STA. 346+00.00
--------	--	-------	----	--------	----------------	-------------------

**CROSS SECTIONS  
 IL 127**

F.A.S. RTE.	SECTION	COUNTY	TOTAL SHEETS	SHEET NO.
1909	22B-4	UNION	37	33
CONTRACT NO. 78505				
ILLINOIS FED. AID PROJECT				

DATE	
BY	
SURVEYED	
PLOTTED	
TEMPLATE	
AREAS CHECKED	
FINAL SURVEY NO.	
NOTE BOOK NO.	
AREAS CHECKED	

DATE	
BY	
SURVEYED	
PLOTTED	
TEMPLATE	
AREAS CHECKED	
ORIGINAL SURVEY NO.	
NOTE BOOK NO.	
AREAS CHECKED	

MODEL: Default  
 FILE NAME: D:\vbl\m\room\ad\illinois\p\PROJECTS\78505\CAD\DATA\CAD\Sheet\07\78505-Str\X-Section.dgn

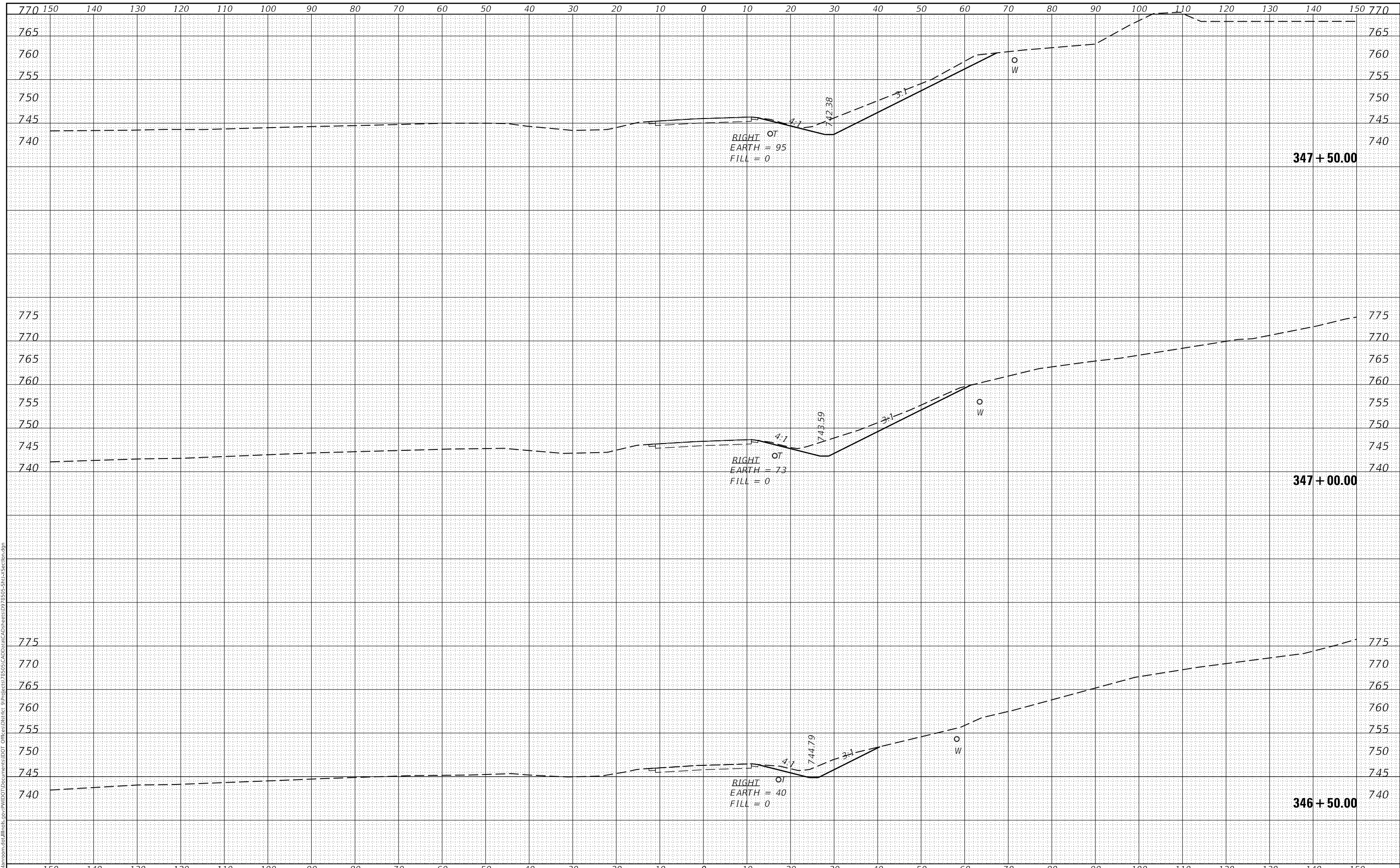

USER NAME = colemm	DESIGNED -	REVISED -
	DRAWN -	REVISED -
PLOT SCALE = 20.0000' / in.	CHECKED -	REVISED -
PLOT DATE = 8/26/2020	DATE -	REVISED -

**STATE OF ILLINOIS  
DEPARTMENT OF TRANSPORTATION**

<b>CROSS SECTIONS IL 127</b>	
SCALE:	SHEET OF SHEETS
STA. 346+50.00 TO STA. 347+50.00	

F.A.S. RTE.	SECTION	COUNTY	TOTAL SHEETS	SHEET NO.
1909	22B-4	UNION	37	34
CONTRACT NO. 78505				
ILLINOIS FED. AID PROJECT				

DATE	
BY	
FINAL SURVEY	SURVEYED
NOTE BOOK	PLOTTED
NO.	TEMPLATE
	AREAS CHECKED

DATE	
BY	
ORIGINAL SURVEY	SURVEYED
NOTE BOOK	PLOTTED
NO.	TEMPLATE
	AREAS CHECKED

MODEL: Default  
 FILE NAME: D:\v\blm\room\ad\illinois\p\p\WIDOT\Documents\DOT\_Offices\District\_9\Projects\78505\CAD\Drawings\DW\78505-Stru-X\Section.dgn

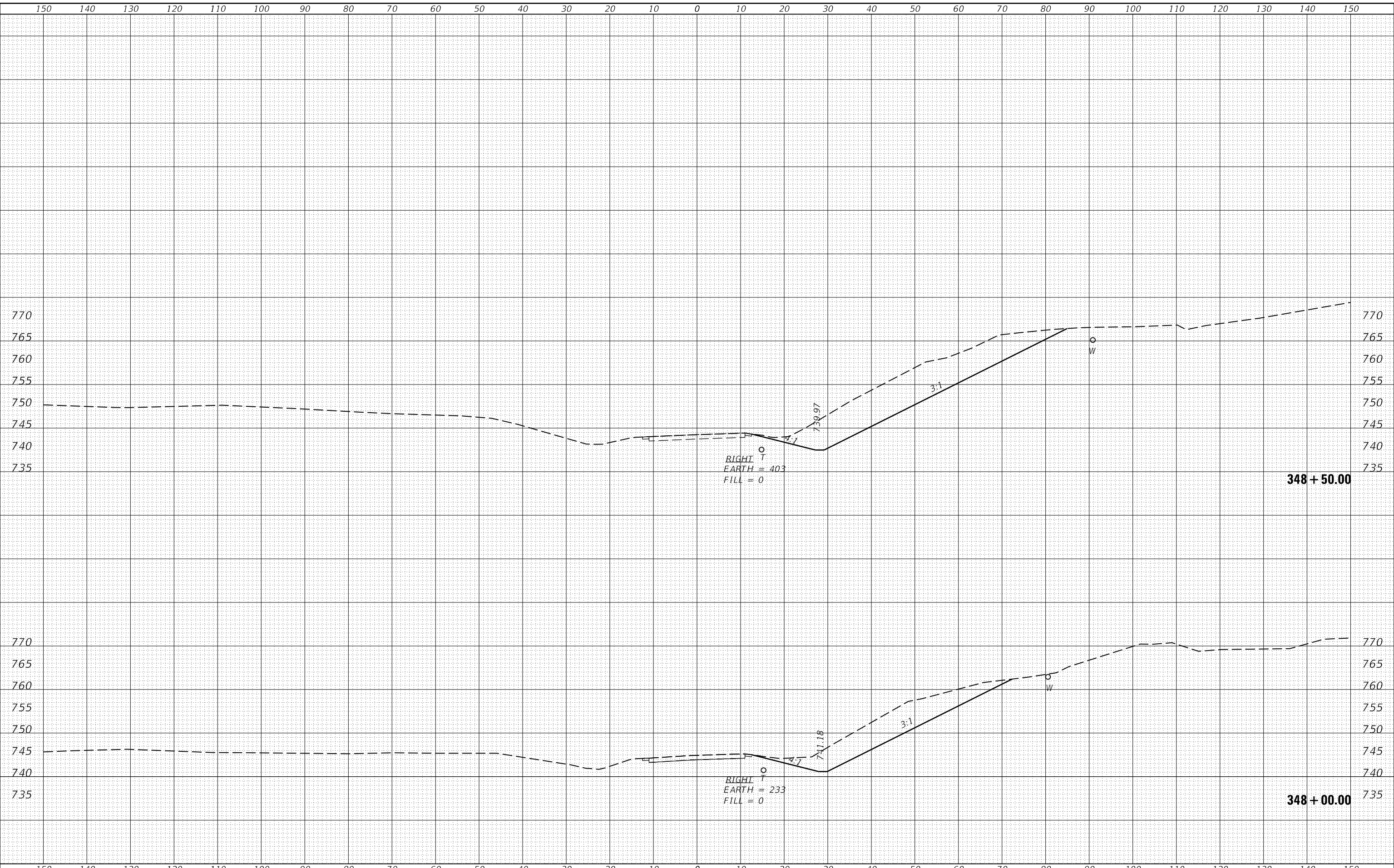

USER NAME = colemm	DESIGNED -	REVISED -
	DRAWN -	REVISED -
PLOT SCALE = 20.0000' / in.	CHECKED -	REVISED -
PLOT DATE = 8/26/2020	DATE -	REVISED -

**STATE OF ILLINOIS  
 DEPARTMENT OF TRANSPORTATION**

SCALE:		SHEET	OF	SHEETS	STA. 348+00.00	TO STA. 348+50.00
--------	--	-------	----	--------	----------------	-------------------

**CROSS SECTIONS  
 IL 127**

F.A.S. RTE.	SECTION	COUNTY	TOTAL SHEETS	SHEET NO.
1909	22B-4	UNION	37	35
CONTRACT NO. 78505				
ILLINOIS FED. AID PROJECT				

DATE	
BY	
FINAL SURVEY	SURVEYED
NOTE BOOK	PLOTTED
NO.	TEMPLATE
	AREAS CHECKED

DATE	
BY	
ORIGINAL SURVEY	SURVEYED
NOTE BOOK	PLOTTED
NO.	TEMPLATE
	AREAS CHECKED

MODEL: Default  
 FILE NAME: D:\vllm\com\ad\illinois\p\p\WIDOT\Documents\DOT\_Office\District\_9\Projects\78505\CAD\Drawings\DW\78505-Stru-X\Section.dgn

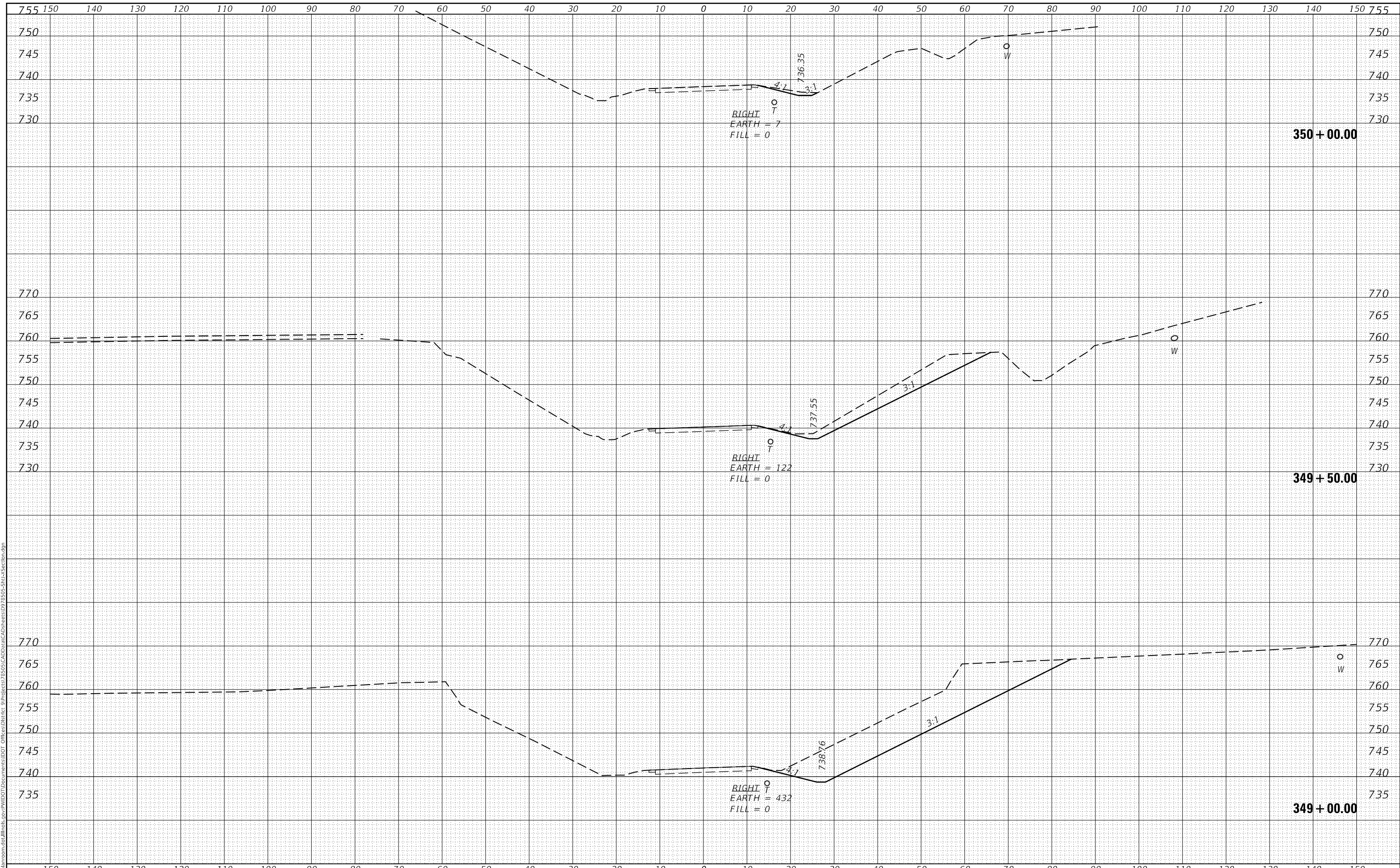

USER NAME = colemm	DESIGNED -	REVISD -
	DRAWN -	REVISD -
PLOT SCALE = 20.0000 ' / in.	CHECKED -	REVISD -
PLOT DATE = 8/26/2020	DATE -	REVISD -

**STATE OF ILLINOIS  
DEPARTMENT OF TRANSPORTATION**

<b>CROSS SECTIONS</b>			
<b>IL 127</b>			
SCALE:	SHEET	OF	SHEETS
			STA. 349+00.00 TO STA. 350+00.00

F.A.S. RTE.	SECTION	COUNTY	TOTAL SHEETS	SHEET NO.
1909	22B-4	UNION	37	36
CONTRACT NO. 78505				
ILLINOIS FED. AID PROJECT				

FINAL SURVEY NO.	SURVEYED	DATE
NOTE BOOK	PLOTTED	
	TEMPLATE	
	AREAS CHECKED	

ORIGINAL SURVEY NO.	SURVEYED	DATE
NOTE BOOK	PLOTTED	
	TEMPLATE	
	AREAS CHECKED	

MODEL: Default  
 FILE NAME: D:\vbl\m\com\ad\illinois\p\p\WIDOT\Documents\DOT\_Offices\District\_9\Projects\78505\CAD\Drawings\DOT\_78505-Stru-X\Section.dgn

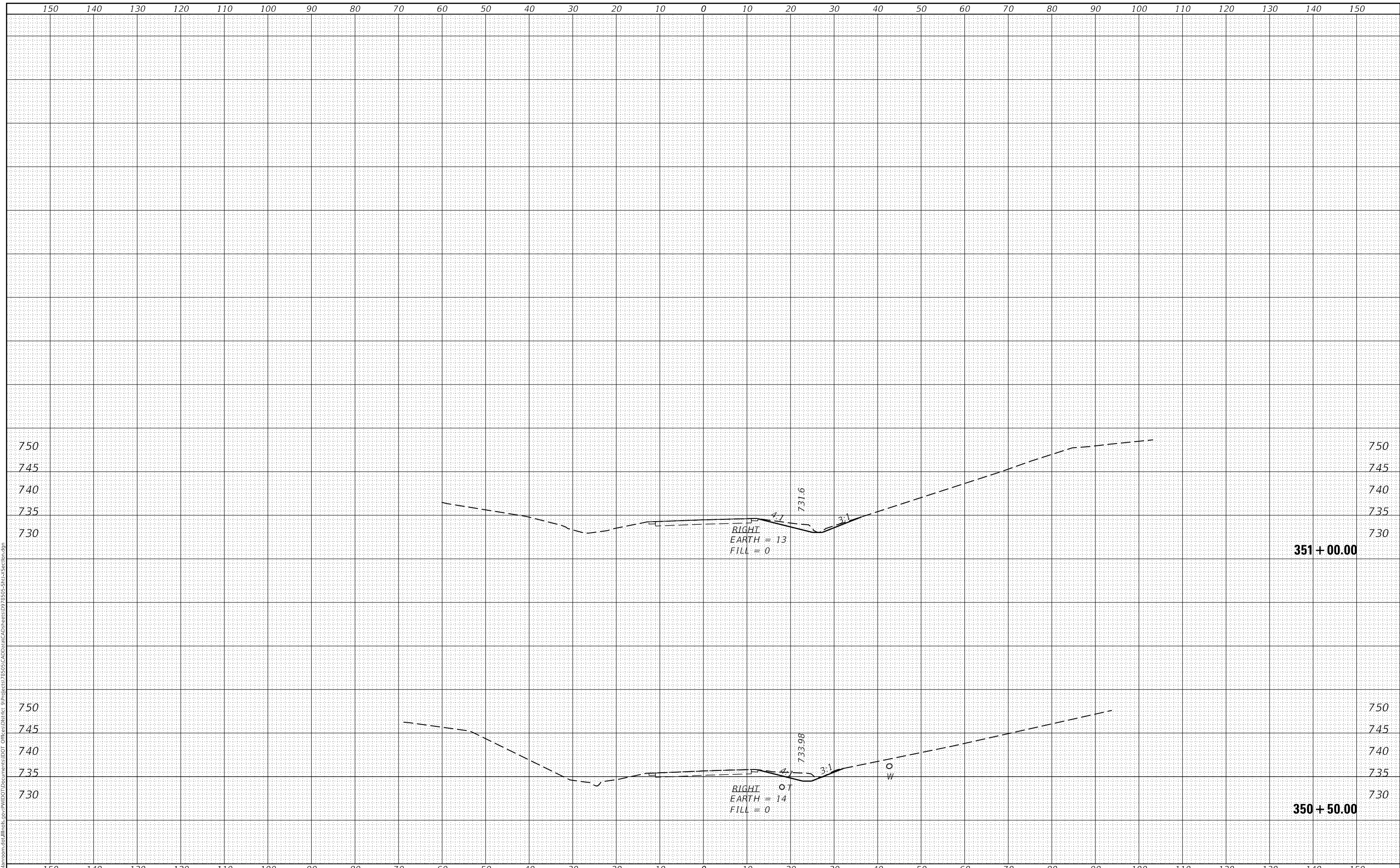

USER NAME = colemm	DESIGNED -	REVISED -
	DRAWN -	REVISED -
PLOT SCALE = 20.0000 ' / in.	CHECKED -	REVISED -
PLOT DATE = 8/26/2020	DATE -	REVISED -

**STATE OF ILLINOIS  
 DEPARTMENT OF TRANSPORTATION**

**CROSS SECTIONS  
 IL 127**  
 SCALE: SHEET OF SHEETS STA. 350+50.00 TO STA. 351+00.00

F.A.S. RTE.	SECTION	COUNTY	TOTAL SHEETS	SHEET NO.
1909	22B-4	UNION	37	37
CONTRACT NO. 78505				
ILLINOIS FED. AID PROJECT				