

**SCHEDULE OF QUANTITIES**

LOCATION OF WORK				BUTTERFIELD ROAD								IL ROUTE 137 & BUTTERFIELD SQUARE DRIVE	INTERCONNECT	CONSTRUCTION CODE	
SUMMARY OF QUANTITIES				ALLANSON ROAD/GREGG'S PARKWAY	HUNTINGTON ROAD	GOLF ROAD	CRANE BOULEVARD	IL ROUTE 176/PARK DRIVE	WINCHESTER ROAD	VIRGINIA AVENUE/ST WILLIAM DRIVE	IL ROUTE 137/BUCKLEY ROAD/PETERSON RD			TRAFFIC SIGNALS	TRAINEES
CODE NO.	ITEM	UNIT	TOTAL									80% FED	20% LOCAL	0021	0042
				URBAN	URBAN										
X032002I	MODIFY EXISTING TYPE 'D' FOUNDATION	EACH	1					1					1		
X0324085	EMERGENCY VEHICLE PRIORITY SYSTEM LINE SENSOR CABLE, NO. 20 3/C	FOOT	2,750	670	277	264	220	445	569	305			2,750		
X0324599	ROD AND CLEAN EXISTING CONDUIT	FOOT	3,889	437	310	420	286	1,012	462	185	464	313	3,889		
X0326309	RELOCATE EXISTING REMOTE - CONTROLLED VIDEO SYSTEM (SPECIAL)	EACH	8	1		1	1	1	2	2			8		
X03272II	RELOCATE SWITCH	EACH	7	1	1	1	1	1	1	1			7		
X0327406	RELOCATE EXISTING VIDEO ENCODER, SPECIAL	EACH	8	1		1	1	1	2	2			8		
X0327698	LED INTERNALLY ILLUMINATED STREET NAME SIGN	EACH	16	4	4	4	4						16		
XI40008I	FULL-ACTUATED CONTROLLER AND TYPE SUPER P CABINET (SPECIAL)	EACH	1					1					1		
XI400102	OUTDOOR RATED NETWORK CABLE	FOOT	831	341	73	75	77	265					831		
XI400150	SERVICE INSTALLATION, GROUND MOUNTED, METERED	EACH	1					1					1		
XI40020I	RADAR VEHICLE DETECTION SYSTEM, SINGLE APPROACH, STOP BAR	EACH	1					1				1	1		
XI400216	LAYER II (DATALINK) SWITCH	EACH	8	1	1	1	1	1	1	1		1	8		
XI400217	TERMINATE FIBER IN CABINET	EACH	16									16	16		
XI400319	TRAFFIC SIGNAL POST, 10 FOOT, (SPECIAL)	EACH	3			1				2			3		
XI400320	TRAFFIC SIGNAL POST, 16 FOOT, (SPECIAL)	EACH	11	4	2	1	4						11		
XI400373	RADAR VEHICLE DETECTION SYSTEM, SINGLE APPROACH, STOP BAR AND FAR BACK	EACH	10					4			4	2	10		
XI400378	PEDESTRIAN SIGNAL POST, 5 FT.	EACH	3					3					3		

X DENOTES SPECIALTY ITEM

<b>AECOM</b> <small>345 EAST ASH AVENUE, SUITE B                  DECATUR, IL 62520-6311                  PHONE: (217) 875-4800 FAX: (217) 875-3517</small>	USER NAME = petrisk.jordan	DESIGNED - NCB	REVISED - 10/02/2020	<b>STATE OF ILLINOIS                  DEPARTMENT OF TRANSPORTATION</b>	<b>SUMMARY OF QUANTITIES</b>			F.A. RTE. 2647	SECTION 16-00142-08-TL	COUNTY LAKE	TOTAL SHEETS 77	SHEET NO. 7	
	PLOT SCALE = 2.0000' / 1" =	DRAWN - CAM	REVISIONS -		SCALE: N.T.S.	SHEET 4 OF 6 SHEETS	STA. TO STA.	CONTRACT NO. 61669					
	PLOT DATE = 10/1/2020	CHECKED - MJL	REVISIONS -		ILLINOIS FED. AID PROJECT								
		DATE - 8-31-2020	REVISIONS -										

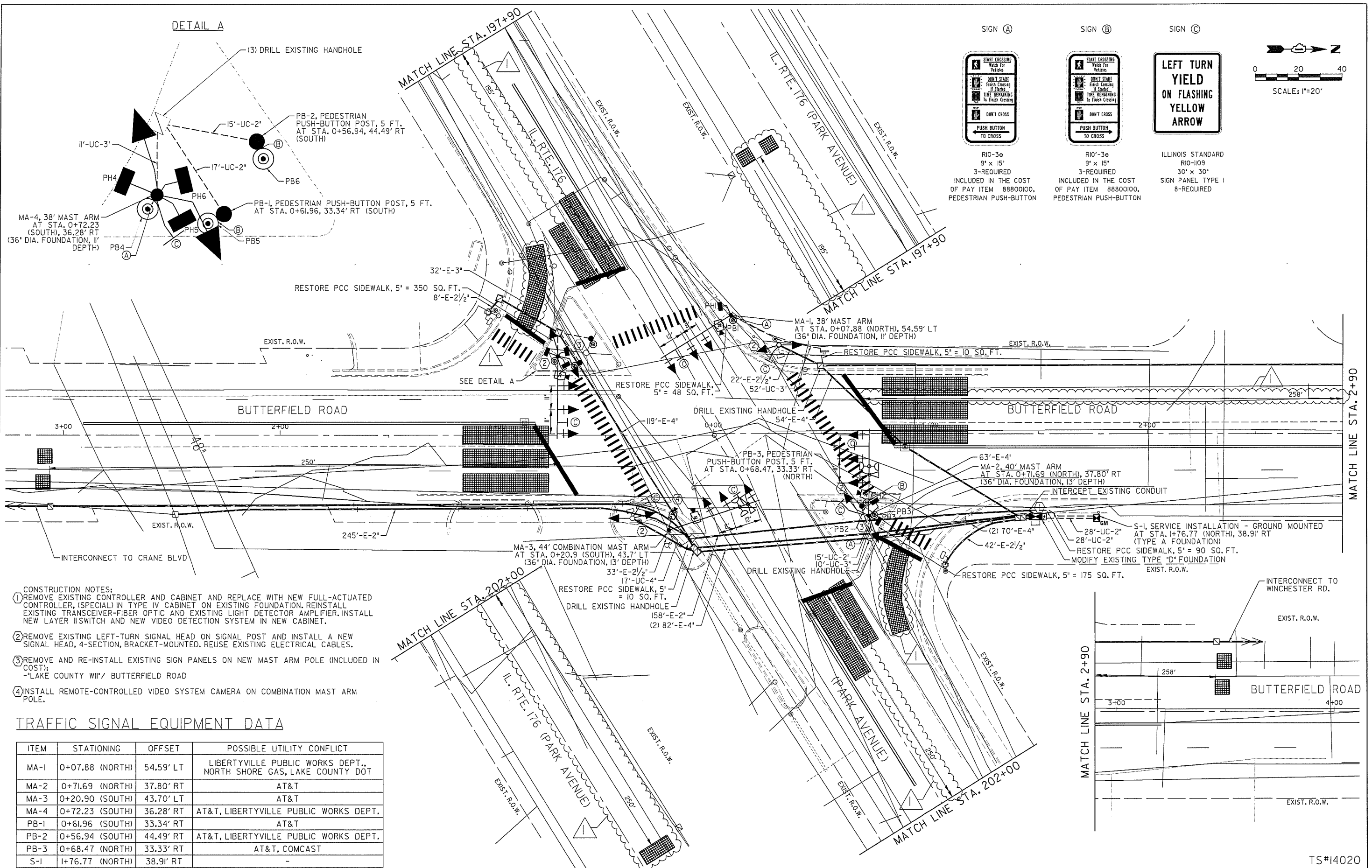

SIGN (A) SIGN (B) SIGN (C)

START CROSSING  
Wait for  
Vehicles

DON'T START  
Finish Crossing  
If Starting  
TIME REMAINING  
To Finish Crossing

DON'T CROSS

PUSH BUTTON  
TO CROSS

START CROSSING  
Wait for  
Vehicles

DON'T START  
Finish Crossing  
If Starting  
TIME REMAINING  
To Finish Crossing

DON'T CROSS

PUSH BUTTON  
TO CROSS

**LEFT TURN  
YIELD  
ON FLASHING  
YELLOW  
ARROW**

RI0-3e  
9' x 15"  
3-REQUIRED  
INCLUDED IN THE COST  
OF PAY ITEM 88800100,  
PEDESTRIAN PUSH-BUTTON

RI0-3e  
9' x 15"  
3-REQUIRED  
INCLUDED IN THE COST  
OF PAY ITEM 88800100,  
PEDESTRIAN PUSH-BUTTON

ILLINOIS STANDARD  
RI0-1109  
30' x 30'  
SIGN PANEL TYPE I  
8-REQUIRED

SCALE: 1"=20'

- CONSTRUCTION NOTES:**
- REMOVE EXISTING CONTROLLER AND CABINET AND REPLACE WITH NEW FULL-ACTUATED CONTROLLER, (SPECIAL) IN TYPE IV CABINET ON EXISTING FOUNDATION. REINSTALL EXISTING TRANSMITTER-FIBER OPTIC AND EXISTING LIGHT DETECTOR AMPLIFIER. INSTALL NEW LAYER II SWITCH AND NEW VIDEO DETECTION SYSTEM IN NEW CABINET.
  - REMOVE EXISTING LEFT-TURN SIGNAL HEAD ON SIGNAL POST AND INSTALL A NEW SIGNAL HEAD, 4-SECTION, BRACKET-MOUNTED. REUSE EXISTING ELECTRICAL CABLES.
  - REMOVE AND RE-INSTALL EXISTING SIGN PANELS ON NEW MAST ARM POLE (INCLUDED IN COST):  
-LAKE COUNTY III/ BUTTERFIELD ROAD
  - INSTALL REMOTE-CONTROLLED VIDEO SYSTEM CAMERA ON COMBINATION MAST ARM POLE.

**TRAFFIC SIGNAL EQUIPMENT DATA**

ITEM	STATIONING	OFFSET	POSSIBLE UTILITY CONFLICT
MA-1	0+07.88 (NORTH)	54.59' LT	LIBERTYVILLE PUBLIC WORKS DEPT., NORTH SHORE GAS, LAKE COUNTY DOT
MA-2	0+71.69 (NORTH)	37.80' RT	AT&T
MA-3	0+20.90 (SOUTH)	43.70' LT	AT&T
MA-4	0+72.23 (SOUTH)	36.28' RT	AT&T, LIBERTYVILLE PUBLIC WORKS DEPT.
PB-1	0+61.96 (SOUTH)	33.34' RT	AT&T
PB-2	0+56.94 (SOUTH)	44.49' RT	AT&T, LIBERTYVILLE PUBLIC WORKS DEPT.
PB-3	0+68.47 (NORTH)	33.33' RT	AT&T, COMCAST
S-1	1+76.77 (NORTH)	38.91' RT	-

**SIGN PANEL - TYPE 1 & TYPE 2**  
ALL DIMENSIONS ARE IN INCHES UNLESS NOTED OTHERWISE

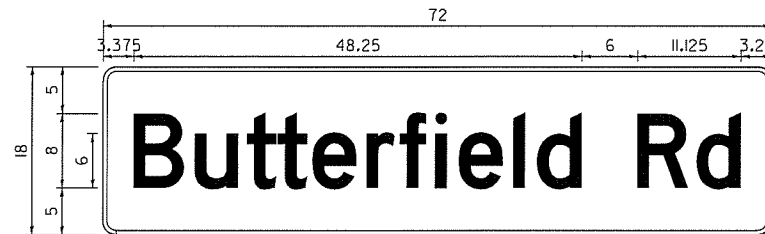

DESIGN SERIES	AREA (SQ FT)	SIGN PANEL TYPE	SHEETING TYPE	QTY REQUIRED
D	9	TYPE 1	ZZ	2

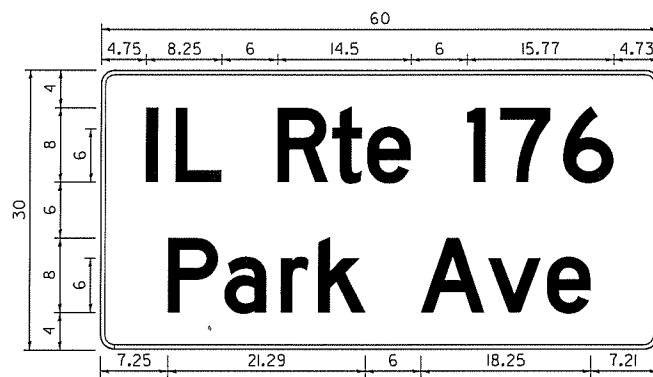

DESIGN SERIES	AREA (SQ FT)	SIGN PANEL TYPE	SHEETING TYPE	QTY REQUIRED
D	12.5	TYPE 2	ZZ	2

NOTES:  
1. FOR ADDITIONAL DESIGN AND INSTALLATION INFORMATION PLEASE SEE DISTRICT ONE MAST ARM MOUNTED STREET NAME SIGN DETAIL.

**SCHEDULE OF QUANTITIES**

ITEM DESCRIPTION	UNITS	TOTAL QTY.
SIGN PANEL - TYPE 1	SQ FT	68
SIGN PANEL - TYPE 2	SQ FT	25
UNDERGROUND CONDUIT, GALVANIZED STEEL, 2" DIA.	FOOT	138
UNDERGROUND CONDUIT, GALVANIZED STEEL, 3" DIA.	FOOT	73
UNDERGROUND CONDUIT, GALVANIZED STEEL, 4" DIA.	FOOT	17
ELECTRIC CABLE IN CONDUIT, SIGNAL NO.14 2C	FOOT	1,540
ELECTRIC CABLE IN CONDUIT, SIGNAL NO.14 3C	FOOT	2,011
ELECTRIC CABLE IN CONDUIT, SIGNAL NO.14 5C	FOOT	2,073
ELECTRIC CABLE IN CONDUIT, SIGNAL NO.14 7C	FOOT	2,634
ELECTRIC CABLE IN CONDUIT, SERVICE, NO. 4 2 C	FOOT	495
ELECTRIC CABLE IN CONDUIT, EQUIPMENT GROUNDING CONDUCTOR, NO. 6 IC	FOOT	707
STEEL MAST ARM ASSEMBLY AND POLE, 38 FT.	EACH	2
STEEL MAST ARM ASSEMBLY AND POLE, 40 FT.	EACH	1
STEEL COMBINATION MAST ARM ASSEMBLY AND POLE 44 FT.	EACH	1
CONCRETE FOUNDATION, TYPE A	FOOT	4
CONCRETE FOUNDATION, TYPE E 36-INCH DIAMETER	FOOT	48
DRILL EXISTING HANDHOLE	EACH	8
SIGNAL HEAD, LED, I-FACE, 3-SECTION, MAST-ARM MOUNTED	EACH	6
SIGNAL HEAD, LED, I-FACE, 3-SECTION, BRACKET MOUNTED	EACH	2
SIGNAL HEAD, LED, I-FACE, 4-SECTION, BRACKET MOUNTED	EACH	4
SIGNAL HEAD, LED, I-FACE, 4-SECTION, MAST ARM MOUNTED	EACH	4
SIGNAL HEAD, LED, I-FACE, 5-SECTION, BRACKET MOUNTED	EACH	2
SIGNAL HEAD, LED, I-FACE, 5-SECTION, MAST-ARM MOUNTED	EACH	2
PEDESTRIAN SIGNAL HEAD, LED, I-FACE, BRACKET MOUNTED WITH COUNTDOWN TIMER	EACH	6
TRAFFIC SIGNAL BACKPLATE, LOUVERED, FORMED PLASTIC	EACH	12
PEDESTRIAN PUSH-BUTTON	EACH	6
TEMPORARY TRAFFIC SIGNAL INSTALLATION	EACH	1
RELOCATE EXISTING EMERGENCY VEHICLE PRIORITY SYSTEM, DETECTOR UNIT	EACH	2
RELOCATE EXISTING EMERGENCY VEHICLE PRIORITY SYSTEM, PHASING UNIT	EACH	1
REMOVE ELECTRIC CABLE FROM CONDUIT	FOOT	9,643
REMOVE EXISTING TRAFFIC SIGNAL EQUIPMENT	EACH	1
REMOVE EXISTING CONCRETE FOUNDATION	EACH	4
MODIFY EXISTING TYPE 'D' FOUNDATION	EACH	1
EMERGENCY VEHICLE PRIORITY SYSTEM LINE SENSOR CABLE, NO. 20 3/C	FOOT	445
ROD AND CLEAN EXISTING CONDUIT	FOOT	1,012
RELOCATE EXISTING REMOTE - CONTROLLED VIDEO SYSTEM (SPECIAL)	EACH	1
RELOCATE SWITCH	EACH	1
RELOCATE EXISTING VIDEO ENCODER, SPECIAL	EACH	1
FULL-ACTUATED CONTROLLER AND TYPE SUPER P CABINET (SPECIAL)	EACH	1
OUTDOOR RATED NETWORK CABLE	FOOT	265
SERVICE INSTALLATION, GROUND MOUNTED, METERED	EACH	1
LAYER II (DATALINK) SWITCH	EACH	1
RADAR VEHICLE DETECTION SYSTEM, SINGLE APPROACH, STOP BAR AND FAR BACK	EACH	4
PEDESTRIAN SIGNAL POST, 5 FT.	EACH	3
INTERCEPT EXISTING CONDUIT	EACH	1
UNINTERRUPTABLE POWER SUPPLY, SPECIAL	EACH	1
CONCRETE FOUNDATION, TYPE A 10-INCH DIAMETER	FOOT	12
TEMPORARY TRAFFIC SIGNAL TIMING	EACH	1
REMOTE CONTROLLED VIDEO SYSTEM	EACH	1

• 100% COST TO THE VILLAGE OF LIBERTYVILLE.

FILE NAME  
SMT\_20\_F1176



USER NAME = petrick,jordan	DESIGNED - NCB	REVISED - 10/02/2020
PLOT SCALE = 40,0000 ' / in.	DRAWN - CAM	REVISED -
PLOT DATE = 10/11/2020	CHECKED - MJL	REVISED -
	DATE - 8-31-2020	REVISED -

STATE OF ILLINOIS  
DEPARTMENT OF TRANSPORTATION

MAST ARM MOUNTED STREET NAME SIGNS  
AND SCHEDULE OF QUANTITIES  
BUTTERFIELD ROAD AND IL RTE 176

F.A. RTE. 2647	SECTION 16-00142-08-TL	COUNTY LAKE	TOTAL SHEETS 77	SHEET NO. 39
SCALE: N.T.S.			SHEET 5 OF 5 SHEETS STA. TO STA.	
ILLINOIS FED. AID PROJECT CONTRACT NO. 6IG69				

TS#14020