

ARLINGTON HEIGHTS ROAD
MATCH LINE STA. 17+15
(SEE SHEET NO. 21)

CONTRACT NO. 63055	
F.A.U. RTE. 1346 & 2626	SECTION 05-00050-00-CH
COUNTY COOK/DUPAGE	TOTAL SHEETS 94
STA. 60+00	TO STA. 65+50
FED. ROAD DIST. NO. 7 ILLINOIS FED. AID PROJECT M-80031569	

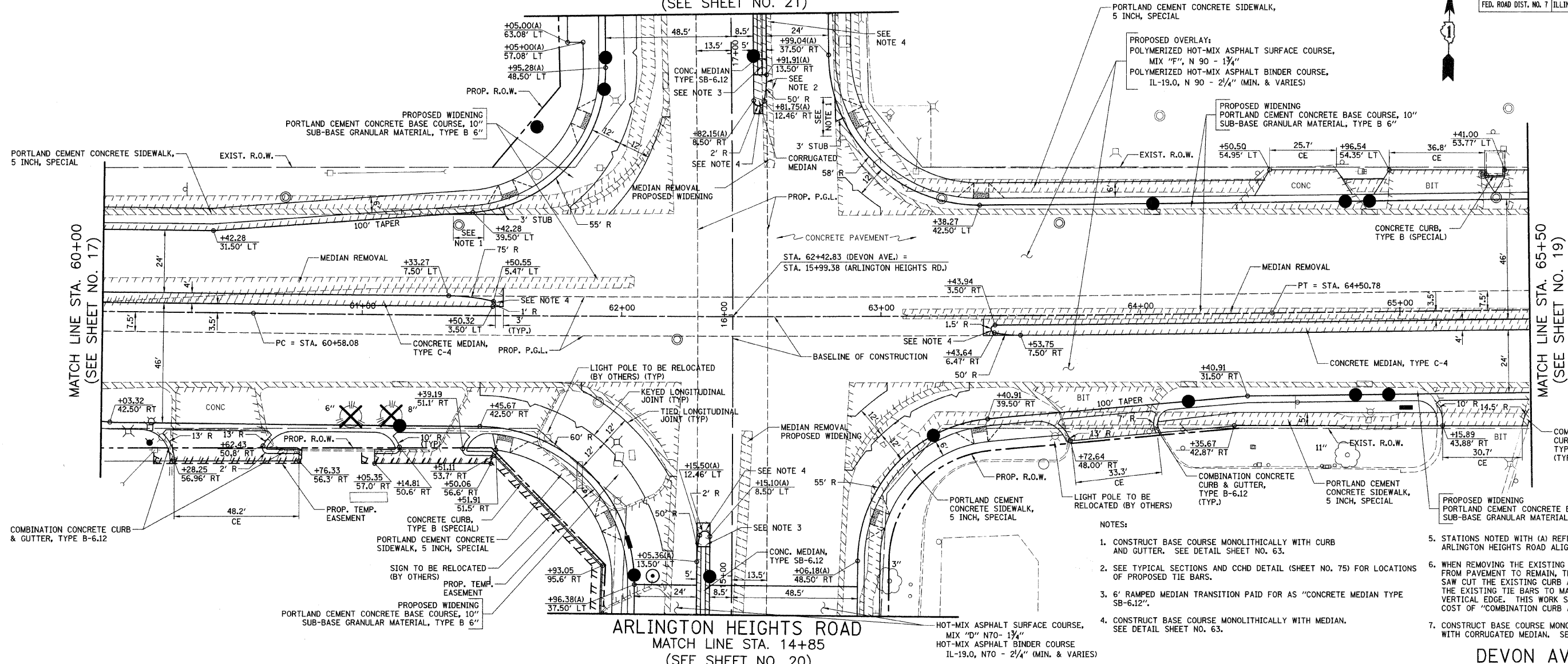

- NOTES:
1. CONSTRUCT BASE COURSE MONOLITHICALLY WITH CURB AND GUTTER. SEE DETAIL SHEET NO. 63.
 2. SEE TYPICAL SECTIONS AND CCHD DETAIL (SHEET NO. 75) FOR LOCATIONS OF PROPOSED TIE BARS.
 3. 6" RAMPED MEDIAN TRANSITION PAID FOR AS "CONCRETE MEDIAN TYPE SB-6.12".
 4. CONSTRUCT BASE COURSE MONOLITHICALLY WITH MEDIAN. SEE DETAIL SHEET NO. 63.
 5. STATIONS NOTED WITH (A) REFERENCE THE ARLINGTON HEIGHTS ROAD ALIGNMENT.
 6. WHEN REMOVING THE EXISTING CURB AND GUTTER FROM PAVEMENT TO REMAIN, THE CONTRACTOR SHALL SAW CUT THE EXISTING CURB AND GUTTER TO SEVER THE EXISTING TIE BARS TO MAINTAIN A CLEAN, VERTICAL EDGE. THIS WORK SHALL BE INCLUDED IN THE COST OF "COMBINATION CURB AND GUTTER REMOVAL".
 7. CONSTRUCT BASE COURSE MONOLITHICALLY WITH CORRUGATED MEDIAN. SEE DETAIL SHEET NO. 63.

ARLINGTON HEIGHTS ROAD
MATCH LINE STA. 14+85
(SEE SHEET NO. 20)

DEVON AVENUE

STATION	ELEVATION	PROF. P.G.L. ELEVATION	WESTBOUND P.G.L. NOTATION	EASTBOUND P.G.L. NOTATION	PROF. P.G.L. ELEVATION	STATION	ELEVATION
690						690	
685						685	
680						680	
675						675	
670						670	
665						665	
60+00	686.27	686.95			686.27	60+00	686.27
+25	686.37	687.04			686.37	+25	686.37
+50	686.46	687.13			686.46	+50	686.46
+75	687.21	687.22			687.21	+75	687.21
61+00	687.30	687.30			687.30	61+00	687.30
+25	686.69	687.39			686.69	+25	686.69
+50	686.76	687.48			686.76	+50	686.76
+75	687.77	687.55			687.77	+75	687.77
62+00	687.58	687.58			687.58	62+00	687.58
+25	686.80	687.56			686.80	+25	686.80
+50	686.78	687.51			686.78	+50	686.78
+75	686.67	687.42			686.67	+75	686.67
63+00	686.57	687.29			686.57	63+00	686.57
+25	686.46	687.15			686.46	+25	686.46
+50	686.55	687.01			686.55	+50	686.55
+75	686.49	686.88			686.49	+75	686.49
64+00	686.34	686.74			686.34	64+00	686.34
+25	686.29	686.62			686.29	+25	686.29
+50	686.19	686.54			686.19	+50	686.19
+75	686.16	686.50			686.16	+75	686.16
65+00	686.01	686.51			686.01	65+00	686.01

ILLINOIS DEPARTMENT OF TRANSPORTATION
PROPOSED PLAN AND PROFILE
DEVON AVENUE
STA. 60+00 TO STA. 65+50

HORIZ.: 20
VERT.: 5
SCALE IN FEET

DATE: 5/27/08
DESIGNED BY: KRK
CHECKED BY: DJK