

F.A.U. RTE.	SECTION	COUNTY	TOTAL SHEETS	SHEET NO.
1346 & 2626	05-00050-00-CH	COOK/DUPAGE	94	32
STA. 60+00		TO STA. 65+50		
FED. ROAD DIST. NO. 7 ILLINOIS FED. AID PROJECT M-8003(569)				

ARLINGTON HEIGHTS ROAD
MATCH LINE STA. 17+15
(SEE SHEET NO. 35)

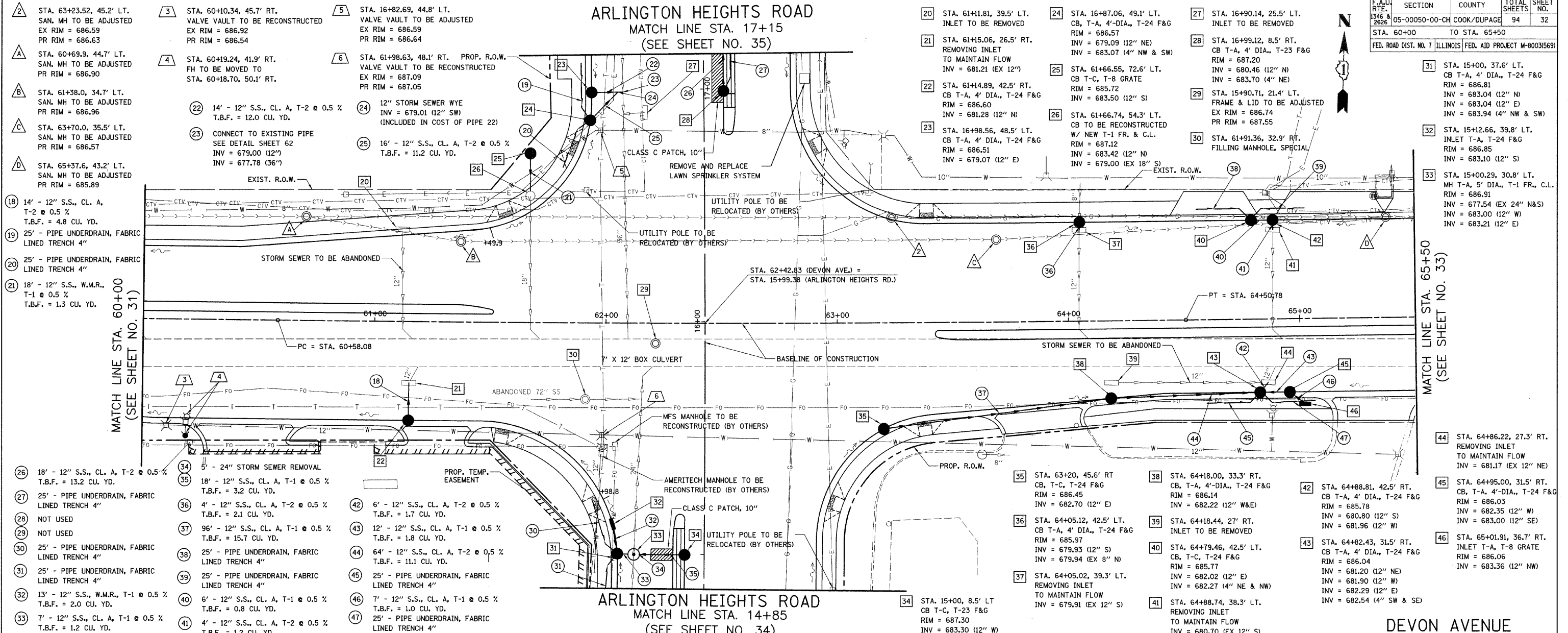

- 2 STA. 63+23.52, 45.2' LT. SAN. MH TO BE ADJUSTED EX RIM = 686.59 PR RIM = 686.63
- 3 STA. 60+10.34, 45.7' RT. VALVE VAULT TO BE RECONSTRUCTED EX RIM = 686.92 PR RIM = 686.54
- 4 STA. 60+19.24, 41.9' RT. FH TO BE MOVED TO STA. 60+18.70, 50.1' RT.
- 5 STA. 16+82.69, 44.8' LT. VALVE VAULT TO BE ADJUSTED EX RIM = 686.59 PR RIM = 686.64
- 6 STA. 61+98.63, 48.1' RT. PROP. R.O.W. VALVE VAULT TO BE RECONSTRUCTED EX RIM = 687.09 PR RIM = 687.05
- 7 - 12" S.S., CL. A, T-1 @ 0.5% T.B.F. = 1.2 CU. YD.
- 8 - 12" S.S., CL. A, T-2 @ 0.5% T.B.F. = 1.2 CU. YD.
- 9 - 12" S.S., CL. A, T-2 @ 0.5% T.B.F. = 1.2 CU. YD.
- 10 - 12" S.S., CL. A, T-2 @ 0.5% T.B.F. = 1.2 CU. YD.
- 11 - 12" S.S., CL. A, T-2 @ 0.5% T.B.F. = 1.2 CU. YD.
- 12 - 12" S.S., CL. A, T-2 @ 0.5% T.B.F. = 1.2 CU. YD.
- 13 - 12" S.S., W.M.R., T-1 @ 0.5% T.B.F. = 2.0 CU. YD.
- 14 - 12" S.S., CL. A, T-2 @ 0.5% T.B.F. = 4.8 CU. YD.
- 15 - 12" S.S., CL. A, T-2 @ 0.5% T.B.F. = 4.8 CU. YD.
- 16 - 12" S.S., W.M.R., T-1 @ 0.5% T.B.F. = 1.3 CU. YD.
- 17 - 12" S.S., CL. A, T-2 @ 0.5% T.B.F. = 1.3 CU. YD.
- 18 - 12" S.S., CL. A, T-2 @ 0.5% T.B.F. = 13.2 CU. YD.
- 19 - PIPE UNDERDRAIN, FABRIC LINED TRENCH 4"
- 20 - PIPE UNDERDRAIN, FABRIC LINED TRENCH 4"
- 21 - PIPE UNDERDRAIN, FABRIC LINED TRENCH 4"
- 22 - PIPE UNDERDRAIN, FABRIC LINED TRENCH 4"
- 23 - PIPE UNDERDRAIN, FABRIC LINED TRENCH 4"
- 24 - PIPE UNDERDRAIN, FABRIC LINED TRENCH 4"
- 25 - PIPE UNDERDRAIN, FABRIC LINED TRENCH 4"
- 26 - PIPE UNDERDRAIN, FABRIC LINED TRENCH 4"
- 27 - PIPE UNDERDRAIN, FABRIC LINED TRENCH 4"
- 28 - PIPE UNDERDRAIN, FABRIC LINED TRENCH 4"
- 29 - PIPE UNDERDRAIN, FABRIC LINED TRENCH 4"
- 30 - PIPE UNDERDRAIN, FABRIC LINED TRENCH 4"
- 31 - PIPE UNDERDRAIN, FABRIC LINED TRENCH 4"
- 32 - PIPE UNDERDRAIN, FABRIC LINED TRENCH 4"
- 33 - PIPE UNDERDRAIN, FABRIC LINED TRENCH 4"
- 34 - PIPE UNDERDRAIN, FABRIC LINED TRENCH 4"
- 35 - PIPE UNDERDRAIN, FABRIC LINED TRENCH 4"
- 36 - PIPE UNDERDRAIN, FABRIC LINED TRENCH 4"
- 37 - PIPE UNDERDRAIN, FABRIC LINED TRENCH 4"
- 38 - PIPE UNDERDRAIN, FABRIC LINED TRENCH 4"
- 39 - PIPE UNDERDRAIN, FABRIC LINED TRENCH 4"
- 40 - PIPE UNDERDRAIN, FABRIC LINED TRENCH 4"
- 41 - PIPE UNDERDRAIN, FABRIC LINED TRENCH 4"
- 42 - PIPE UNDERDRAIN, FABRIC LINED TRENCH 4"
- 43 - PIPE UNDERDRAIN, FABRIC LINED TRENCH 4"
- 44 - PIPE UNDERDRAIN, FABRIC LINED TRENCH 4"
- 45 - PIPE UNDERDRAIN, FABRIC LINED TRENCH 4"
- 46 - PIPE UNDERDRAIN, FABRIC LINED TRENCH 4"
- 47 - PIPE UNDERDRAIN, FABRIC LINED TRENCH 4"

- 20 STA. 61+11.81, 39.5' LT. INLET TO BE REMOVED
- 21 STA. 61+15.06, 26.5' RT. REMOVING INLET TO MAINTAIN FLOW INV = 681.21 (EX 12")
- 22 STA. 61+14.89, 42.5' RT. CB T-A, 4' DIA., T-24 F&G RIM = 686.60 INV = 681.28 (12" N)
- 23 STA. 16+98.56, 48.5' LT. CB T-A, 4' DIA., T-24 F&G RIM = 686.51 INV = 679.07 (12" E)
- 24 STA. 16+87.06, 49.1' LT. CB, T-A, 4'-DIA., T-24 F&G RIM = 686.57 INV = 679.09 (12" NE) INV = 683.07 (4" NW & SW)
- 25 STA. 61+66.55, 72.6' LT. CB T-C, T-8 GRATE RIM = 685.72 INV = 683.50 (12" S)
- 26 STA. 61+66.74, 54.3' LT. CB TO BE RECONSTRUCTED W/ NEW T-1 FR. & C.L. RIM = 687.12 INV = 683.42 (12" N) INV = 679.00 (EX 18" S)
- 27 STA. 16+90.14, 25.5' LT. INLET TO BE REMOVED
- 28 STA. 16+99.12, 8.5' RT. CB T-A, 4' DIA., T-23 F&G RIM = 687.20 INV = 680.46 (12" N) INV = 683.70 (4" NE)
- 29 STA. 15+90.71, 21.4' LT. FRAME & LID TO BE ADJUSTED EX RIM = 686.74 PR RIM = 687.55
- 30 STA. 61+91.36, 32.9' RT. FILLING MANHOLE, SPECIAL
- 31 STA. 15+00, 37.6' LT. CB T-A, 4' DIA., T-24 F&G RIM = 686.81 INV = 683.04 (12" N) INV = 683.04 (12" E) INV = 683.94 (4" NW & SW)
- 32 STA. 15+12.66, 39.8' LT. INLET T-A, T-24 F&G RIM = 686.85 INV = 683.10 (12" S)
- 33 STA. 15+00.29, 30.8' LT. MH T-A, 5' DIA., T-1 FR., C.L. RIM = 686.91 INV = 677.54 (EX 24" N&S) INV = 683.00 (12" W) INV = 683.21 (12" E)
- 34 STA. 15+00, 8.5' LT. CB T-C, T-23 F&G RIM = 687.30 INV = 683.30 (12" W)
- 35 STA. 63+20, 45.6' RT. CB, T-C, T-24 F&G RIM = 686.45 INV = 682.70 (12" E)
- 36 STA. 64+05.12, 42.5' LT. CB T-A, 4' DIA., T-24 F&G RIM = 685.97 INV = 679.93 (12" S) INV = 679.94 (EX 8" N)
- 37 STA. 64+05.02, 39.3' LT. REMOVING INLET TO MAINTAIN FLOW INV = 679.91 (EX 12" S)
- 38 STA. 64+18.00, 33.3' RT. CB, T-A, 4'-DIA., T-24 F&G RIM = 686.14 INV = 682.22 (12" W&E)
- 39 STA. 64+18.44, 27' RT. INLET TO BE REMOVED
- 40 STA. 64+79.46, 42.5' LT. CB, T-C, T-24 F&G RIM = 685.77 INV = 682.02 (12" E) INV = 682.27 (4" NE & NW)
- 41 STA. 64+88.74, 38.3' LT. REMOVING INLET TO MAINTAIN FLOW INV = 680.70 (EX 12" S)
- 42 STA. 64+88.81, 42.5' RT. CB T-A, 4' DIA., T-24 F&G RIM = 685.78 INV = 680.80 (12" S) INV = 681.96 (12" W)
- 43 STA. 64+82.43, 31.5' RT. CB T-A, 4' DIA., T-24 F&G RIM = 686.04 INV = 681.20 (12" NE) INV = 681.90 (12" W) INV = 682.29 (12" E) INV = 682.54 (4" SW & SE)
- 44 STA. 64+86.22, 27.3' RT. REMOVING INLET TO MAINTAIN FLOW INV = 681.17 (EX 12" NE)
- 45 STA. 64+95.00, 31.5' RT. CB, T-A, 4'-DIA., T-24 F&G RIM = 686.03 INV = 682.35 (12" W) INV = 683.00 (12" SE)
- 46 STA. 65+01.91, 36.7' RT. INLET T-A, T-8 GRATE RIM = 686.06 INV = 683.36 (12" NW)

STATION	EXIST. ELEVATION ALONG BASELINE	PROP. P.G.L. ELEVATION - EB/WB	PROP. P.G.L. ELEVATION - WESTBOUND	PROP. P.G.L. ELEVATION - EASTBOUND	EXIST. ELEVATION ALONG BASELINE
60+00	686.27	686.95/686.95			686.27
+25	686.37	687.04/687.04			686.37
+50	686.46	687.13/687.13			686.46
+75	686.54	687.21/687.22			686.54
61+00	686.62	687.30/687.30			686.62
+25	686.69	687.39/687.39			686.69
+50	686.76	687.48/687.48			686.76
+75	686.77	687.55/687.55			686.77
62+00	686.76	687.58/687.58			686.76
+25	686.80	687.56/687.56			686.80
+50	686.78	687.51/687.51			686.78
+75	686.67	687.42/687.42			686.67
63+00	686.57	687.29/687.29			686.57
+25	686.46	687.15/687.15			686.46
+50	686.55	687.01/687.01			686.55
+75	686.49	686.88/686.88			686.49
64+00	686.34	686.74/686.74			686.34
+25	686.29	686.62/686.63			686.29
+50	686.19	686.54/686.55			686.19
+75	686.16	686.50/686.52			686.16
65+00	686.01	686.51/686.54			686.01

ILLINOIS DEPARTMENT OF TRANSPORTATION
DRAINAGE AND UTILITIES
DEVON AVENUE
STA. 60+00 TO STA. 65+50

HORIZ.: 20
VERT.: 5
SCALE IN FEET

DATE: 5/27/08
DESIGNED BY: KRK
CHECKED BY: DJK