

F.A.U. RTE.	SECTION	COUNTY	TOTAL SHEETS	SHEET NO.
1346 & 2626	05-00050-00-CH	COOK/DUPAGE	94	39
SIGNING & LANDSCAPING PLAN				
FED. ROAD DIST. NO. 7 ILLINOIS FED. AID PROJECT M-8003(569)				

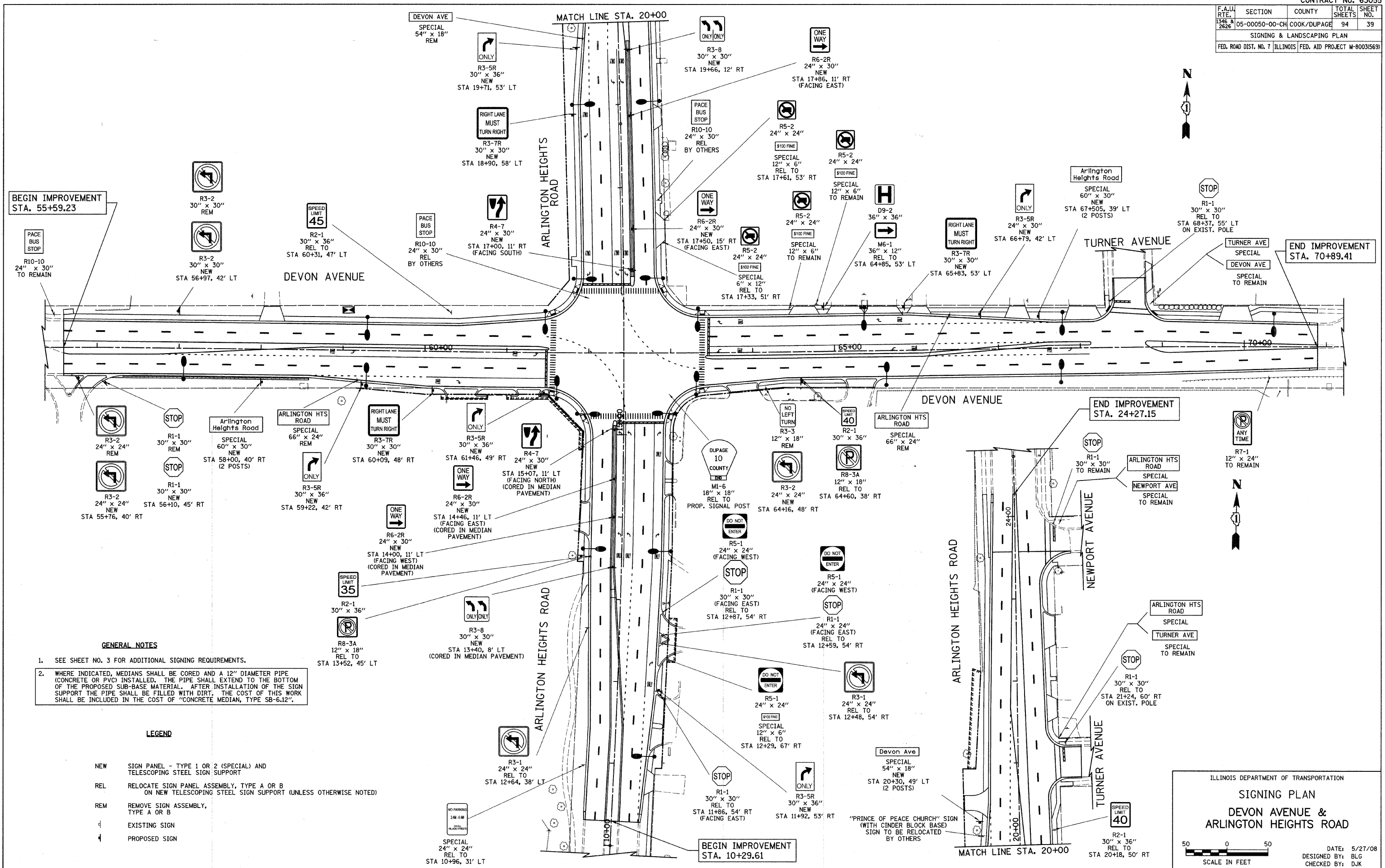

BEGIN IMPROVEMENT STA. 55+59.23

END IMPROVEMENT STA. 70+89.41

END IMPROVEMENT STA. 24+27.15

BEGIN IMPROVEMENT STA. 10+29.61

MATCH LINE STA. 20+00

**GENERAL NOTES**

- SEE SHEET NO. 3 FOR ADDITIONAL SIGNING REQUIREMENTS.
- WHERE INDICATED, MEDIANS SHALL BE CORED AND A 12" DIAMETER PIPE (CONCRETE OR PVC) INSTALLED. THE PIPE SHALL EXTEND TO THE BOTTOM OF THE PROPOSED SUB-BASE MATERIAL. AFTER INSTALLATION OF THE SIGN SUPPORT THE PIPE SHALL BE FILLED WITH DIRT. THE COST OF THIS WORK SHALL BE INCLUDED IN THE COST OF "CONCRETE MEDIAN, TYPE SB-6.12".

**LEGEND**

- NEW SIGN PANEL - TYPE 1 OR 2 (SPECIAL) AND TELESCOPING STEEL SIGN SUPPORT
- REL RELOCATE SIGN PANEL ASSEMBLY, TYPE A OR B ON NEW TELESCOPING STEEL SIGN SUPPORT (UNLESS OTHERWISE NOTED)
- REM REMOVE SIGN ASSEMBLY, TYPE A OR B
- EXISTING SIGN
- PROPOSED SIGN

ILLINOIS DEPARTMENT OF TRANSPORTATION

**SIGNING PLAN**

**DEVON AVENUE & ARLINGTON HEIGHTS ROAD**

DATE: 5/27/08  
DESIGNED BY: BLG  
CHECKED BY: DJK

