

FAP RTE.	SECTION	COUNTY	TOTAL SHEETS	SHEET NO.
816	BRS-1 & (6BR)BR	DOUGLAS	176	60
STA. 285+00		TO STA. 300+00		
FED. ROAD DIST. NO. 7		ILLINOIS	FED. AID PROJECT	
CONTRACT NO. 90711				

S.E. 1/4, SEC. 1, T15N, R6E, 3RD. P.M., MOULTRIE COUNTY

ROW SHEET 14 OF 18

5612038

SEE SHEET # 59

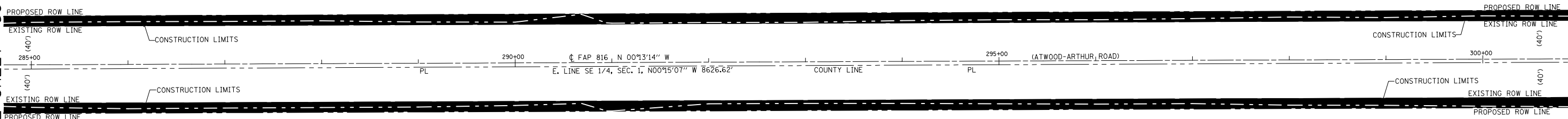

SEE SHEET # 61

5612039

S.W. FR. 1/4, SEC. 6, T15N, R7E, 3RD. P.M., DOUGLAS COUNTY

* AREA OF REMAINING IS AN ESTIMATED AREA

- LEGEND**
- ⊠ R.O.W. MARKER FOUND
 - - - EXISTING FENCE
 - () RECORD DATA
 - IRON PIN/PIPE FOUND
 - SET COTTON SPINDLE
 - PL PROPERTY LINE
 - ▲ SET PK NAIL
 - ▲ FOUND PK NAIL
 - ⊕ FOUND CROSS IN CONCRETE
 - FOUND STONE OR VAULT
- BEARINGS BASED ON IL STATE PLANE COORDINATES, NAD 83, EAST ZONE.

PARCEL NO.	OWNER	AREA OF WHOLE	AREA TAKEN	PREV. DED OR USE	AREA * REMAINING	TEMPORARY EASEMENT	EASEMENT PURPOSE
5612038	UNIVERSITY OF ILLINOIS	161.7 AC.±	3.303 AC.±	2.692 AC.±	158.4 AC.±		
5612039	WILLOUGHBY TRUST, et al	215.18 AC.±	2.104 AC.±	1.633 AC.±	213.08 AC.±		

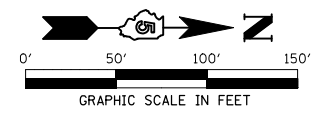

REVISIONS	
NAME	DATE

ILLINOIS DEPARTMENT OF TRANSPORTATION
RIGHT OF WAY PLAN
 ROUTE FAP 816 (ATWOOD-ARTHUR ROAD)
 SECTION 6RS-1 & (6BR)BR
 COUNTY MOULTRIE & DOUGLAS
 JOB NO. R-95-061-02
 SECTION 1, T.15N., R.6E., 3RD P.M.
 SECTION 6, T.15N., R.7E., 3RD P.M.
 STA. 285+00 STA. 300+00
 DRAWN TFG
 SCALE: 1"= 50'

CHECKED PDN/BRM