

# F.A.P. 816 (ATWOOD - ARTHUR RD.) & U.S. 36 LIGHTING MODERNIZATION

F.A.P. RTE.	SECTION	COUNTY	TOTAL SHEETS	SHEET NO.
816	6RS-1&6BRIBR	DOUGLAS	176	65
STA.	TO STA.			
FED. ROAD DIST. NO.	ILLINOIS	FED. AID PROJECT		
CONTRACT NO. 90711				

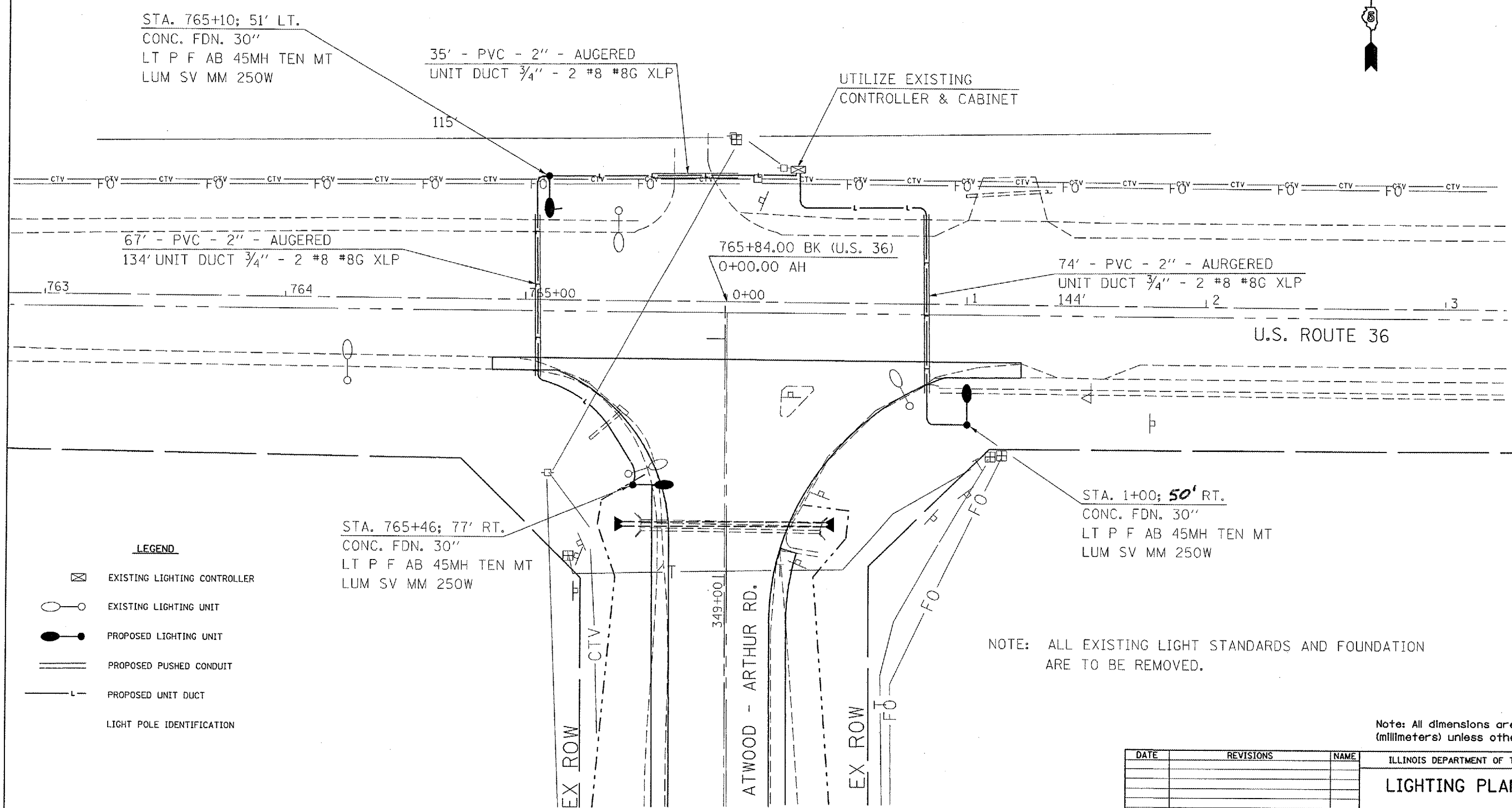

**LEGEND**

- EXISTING LIGHTING CONTROLLER
- EXISTING LIGHTING UNIT
- PROPOSED LIGHTING UNIT
- PROPOSED PUSHED CONDUIT
- PROPOSED UNIT DUCT
- LIGHT POLE IDENTIFICATION

NOTE: ALL EXISTING LIGHT STANDARDS AND FOUNDATION ARE TO BE REMOVED.

Note: All dimensions are in INCHES (millimeters) unless otherwise shown.

DATE	REVISIONS	NAME

ILLINOIS DEPARTMENT OF TRANSPORTATION  
**LIGHTING PLAN SHEET**

PLOT DATE = 8/21/2008  
 FILE NAME = c:\peters\proj\816\816.dwg  
 USER = jk  
 PLOTTER = HPGL

Rev