

PAVEMENT MARKING LEGEND

- | | | | | | |
|---|---|------|---|------|----------------------------|
| ① | EXISTING PAVEMENT MARKING | 4SW | 4" SOLID WHITE | 8SW | 8" SOLID WHITE |
| ② | PAVEMENT MARKING FROM PREVIOUS STAGE | 4SY | 4" SOLID YELLOW | 12SW | 12" SOLID WHITE |
| ③ | PROPOSED PAVEMENT MARKING IN PLACE (SEE PROPOSED PAVEMENT MARKING PLAN) | 4SYY | 4" SOLID DOUBLE YELLOW (11" C-C) | 20 | 20' SPACING |
| T | PAVEMENT MARKING TAPE, TYPE III | 4KW | 4" SKIP-DASH WHITE (30' SKIP, 10' DASH) | 12SY | 12" SOLID YELLOW |
| P | POLYUREA PAVEMENT MARKING TYPE II | 4DW | 4" DOTTED WHITE (9' SKIP, 3' DASH) | 24SW | 24" SOLID WHITE STOP BAR |
| | | | | LSW | LETTERS AND SYMBOLS, WHITE |

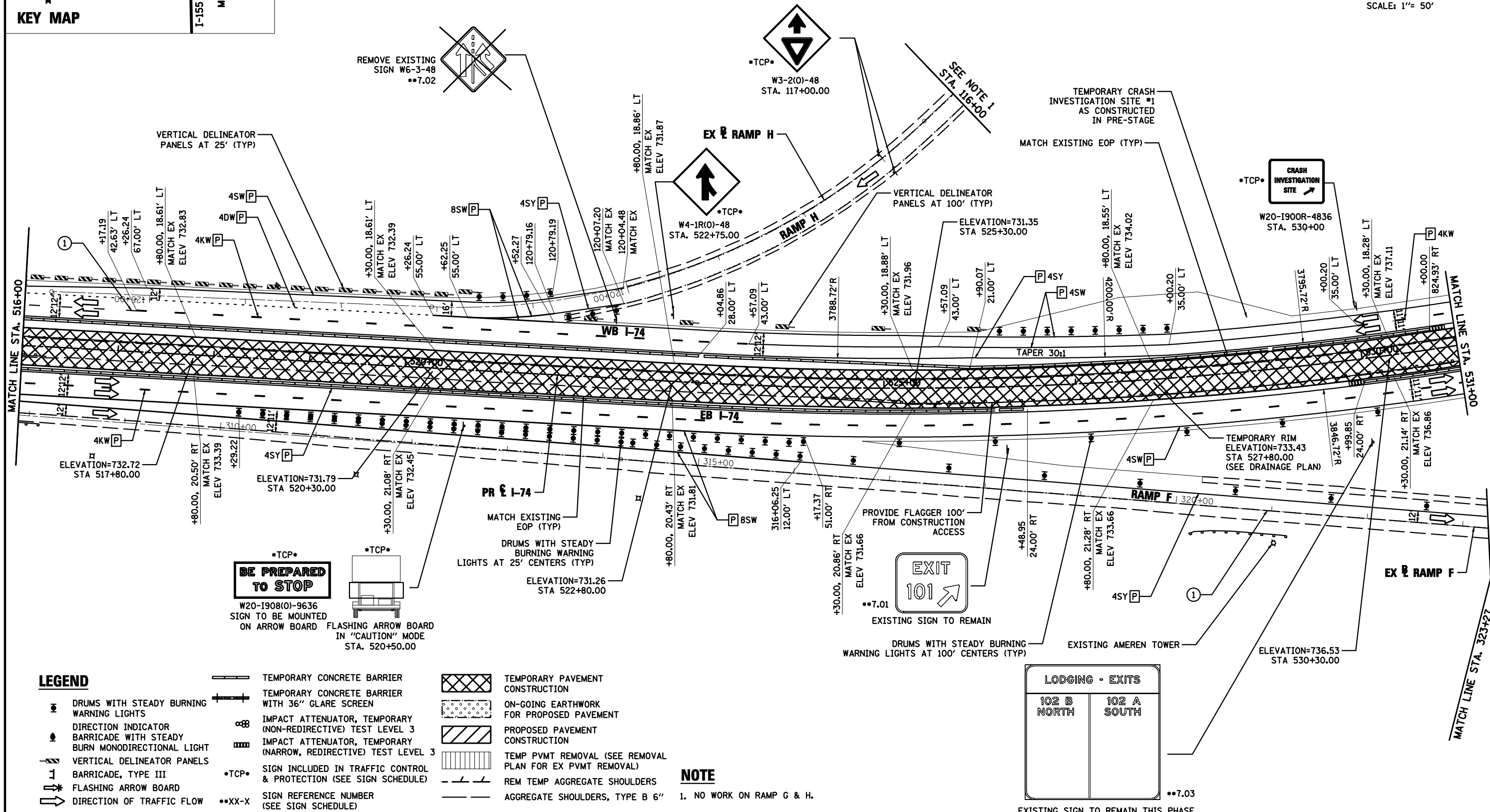
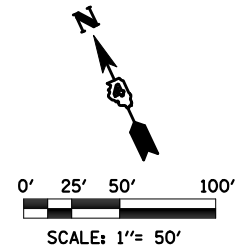

LEGEND

- | | | | |
|--|--|--|---|
| | DRUMS WITH STEADY BURNING WARNING LIGHTS | | TEMPORARY CONCRETE BARRIER WITH 36" GLARE SCREEN |
| | DIRECTION INDICATOR BARRICADE WITH STEADY BURN MONODIRECTIONAL LIGHT | | IMPACT ATTENUATOR, TEMPORARY (NON-REDIRECTIVE) TEST LEVEL 3 |
| | VERTICAL DELINEATOR PANELS BARRICADE, TYPE III | | IMPACT ATTENUATOR, TEMPORARY (NARROW, REDIRECTIVE) TEST LEVEL 3 |
| | FLASHING ARROW BOARD | | SIGN INCLUDED IN TRAFFIC CONTROL & PROTECTION (SEE SIGN SCHEDULE) |
| | DIRECTION OF TRAFFIC FLOW | | SIGN REFERENCE NUMBER (SEE SIGN SCHEDULE) |
| | TEMPORARY CONCRETE BARRIER | | ON-GOING EARTHWORK FOR PROPOSED PAVEMENT |
| | TEMPORARY PAVEMENT CONSTRUCTION | | PROPOSED PAVEMENT CONSTRUCTION |
| | TEMP PVT REMOVAL (SEE REMOVAL PLAN FOR EX PVT REMOVAL) | | REM TEMP AGGREGATE SHOULDERS |
| | AGGREGATE SHOULDERS, TYPE B 6" | | |

NOTE

- NO WORK ON RAMP G & H.

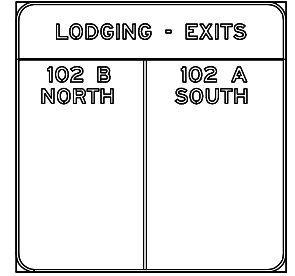

FILE NAME = D468620-shr-staging07_174-01.dgn	DESIGNED - HTL	REVISED -		STATE OF ILLINOIS DEPARTMENT OF TRANSPORTATION	MAINTENANCE OF TRAFFIC STAGE 1		F.A.I. RTE. = 90-[14R(14HB-4,14,14HB)/BR]	SECTION = TAZEWELL	COUNTY =	TOTAL SHEETS = 2433	SHEET NO. = 342	
USER NAME = TERRA	DRAWN - JPS	REVISED -					SCALE: SHEET NO. 19 OF 52 SHEETS STA. 516+00 TO STA. 531+00		CONTRACT NO. 68620		ILLINOIS FED. AID PROJECT	
PLOT DATE = 7/16/2012	CHECKED - DA/LVA	REVISED -										
	DATE - 7/20/2012	REVISED -										