

MESSAGE BOARD SHALL READ:
"DETOUR AHEAD I-74 WEST"

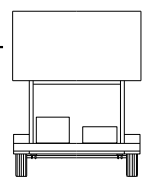

STA. 39+00.00

WORK ZONE W2-1115(0)-3618
•TCP•
SPEED LIMIT 45
R2-1-3648
•TCP•
BEGINS W2-1113(0)-3612
•TCP•
R2-1106-3618
•TCP•
\$375 FINE
MINIMUM
STA. 41+00.00

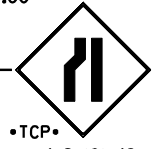

•TCP•
W4-2L(0)-48
STA. 42+00.00



•TCP•
W3-2(0)-48
STA. 45+00



•TCP•
W20-1103(0)-48
STA. 49+41



EXISTING SIGN
TO REMAIN

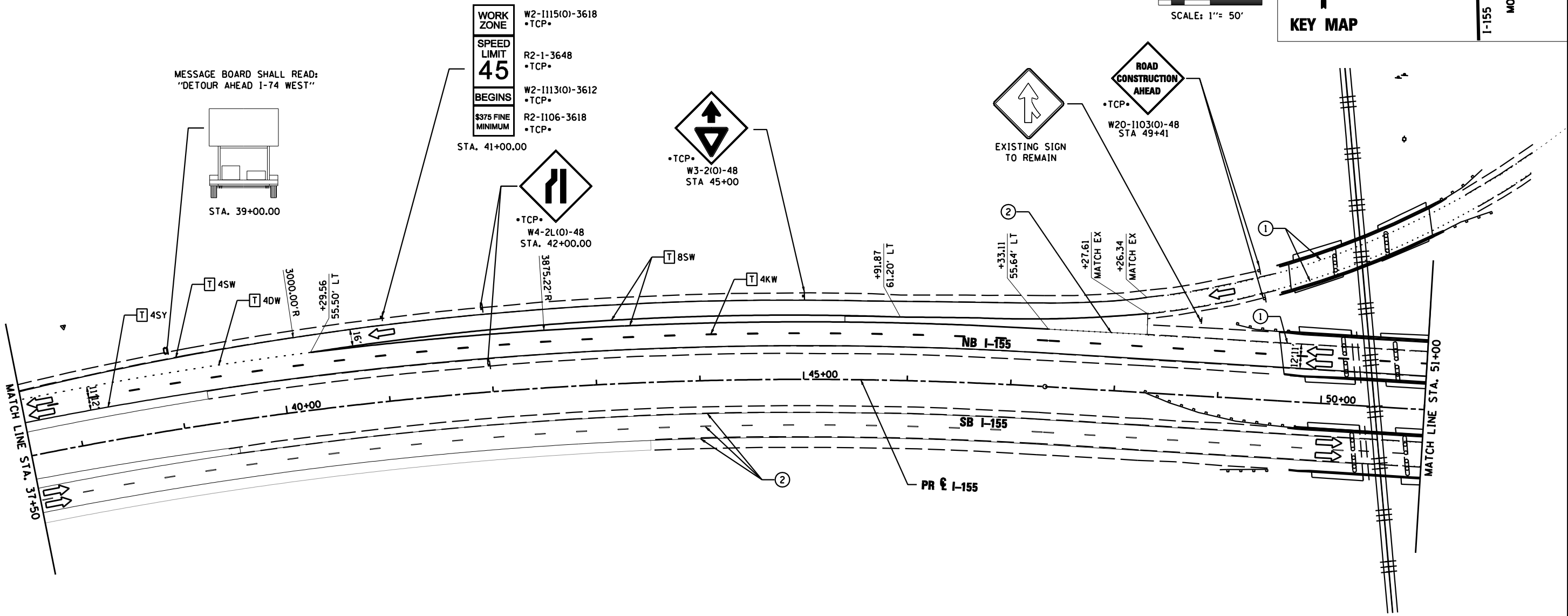

PAVEMENT MARKING LEGEND

①	EXISTING PAVEMENT MARKING	4SW	4" SOLID WHITE	8SW	8" SOLID WHITE
②	PAVEMENT MARKING FROM PREVIOUS STAGE	4SY	4" SOLID YELLOW	12SW	12" SOLID WHITE @ 20' SPACING
③	PROPOSED PAVEMENT MARKING IN PLACE (SEE PROPOSED PAVEMENT MARKING PLAN)	4SYY	4" SOLID DOUBLE YELLOW (11" C-C)	12SY	12" SOLID YELLOW @ 20' SPACING
T	PAVEMENT MARKING TAPE, TYPE III	4KW	4" SKIP-DASH WHITE (30' SKIP, 10' DASH)	24SW	24" SOLID WHITE STOP BAR
P	POLYUREA PAVEMENT MARKING TYPE II	4DW	4" DOTTED WHITE (9' SKIP, 3' DASH)	LSW	LETTERS AND SYMBOLS, WHITE

LEGEND

	DRUMS WITH STEADY BURNING WARNING LIGHTS		ON-GOING EARTHWORK FOR PROPOSED PAVEMENT
	DIRECTION INDICATOR BARRICADE WITH STEADY BURN MONODIRECTIONAL LIGHT		PROPOSED PAVEMENT CONSTRUCTION
	VERTICAL DELINEATOR PANELS BARRICADE, TYPE III		TEMP PVMT REMOVAL (SEE REMOVAL PLAN FOR EX PVMT REMOVAL)
	FLASHING ARROW BOARD		REM TEMP AGGREGATE SHOULDERS AGGREGATE SHOULDERS, TYPE B 6"
	DIRECTION OF TRAFFIC FLOW		TEMPORARY CONCRETE BARRIER
	IMPACT ATTENUATOR, TEMPORARY (NON-REDIRECTIVE)		TEMPORARY CONCRETE BARRIER WITH 36" GLARE SCREEN
	IMPACT ATTENUATOR, TEMPORARY (NARROW, REDIRECTIVE)		SIGN REFERENCE NUMBER (SEE SIGN SCHEDULE)
•TCP•	SIGN INCLUDED IN TRAFFIC CONTROL & PROTECTION (SEE SIGN SCHEDULE)		

FILE NAME = D468620-sh1-staging23 1155-09.dgn	DESIGNED - HTL	REVISIONS		STATE OF ILLINOIS DEPARTMENT OF TRANSPORTATION	MAINTENANCE OF TRAFFIC STAGE 9	F.A.I. RTE. = 90-[14R(14HB-4,14,14HB)BR]	SECTION = TAZEWELL	COUNTY =	TOTAL SHEETS = 2433	SHEET NO. = 963	
USER NAME = TERRA	DRAWN - JPS	REVISIONS				SCALE: 1" = 50'	SHEET NO. 14 OF 15 SHEETS	STA. 37+50 TO STA. 51+00	CONTRACT NO. 68620		ILLINOIS FED. AID PROJECT
PLOT DATE = 7/16/2012	CHECKED - DA/LVA	REVISIONS									
	DATE = 7/20/2012	REVISIONS								• 74 & 155	