

WORK ZONE	W21-1115(0)-3618 •TCP•
SPEED LIMIT	R2-1-3648 •TCP•
45	
BEGINS	W21-1113(0)-3612 •TCP•
\$375 FINE MINIMUM	R2-1106-3618 •TCP•
	STA. 41+00.00

MESSAGE BOARD SHALL READ:
"DETOUR AHEAD I-74 WEST"

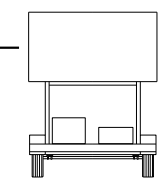

STA. 39+00.00

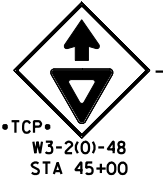

•TCP•
W3-2(0)-48
STA 45+00



EXISTING SIGN
TO REMAIN

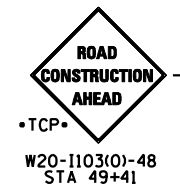

•TCP•
W20-1103(0)-48
STA 49+41

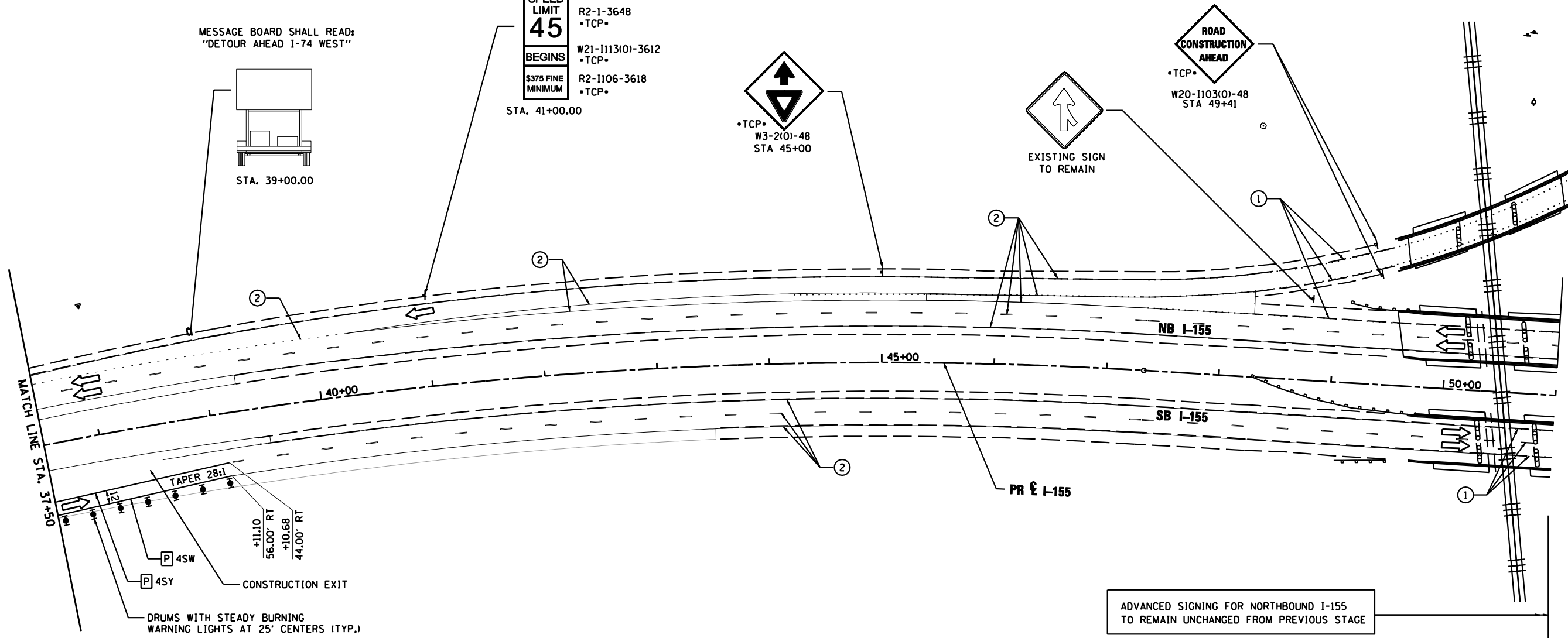

ADVANCED SIGNING FOR NORTHBOUND I-155
TO REMAIN UNCHANGED FROM PREVIOUS STAGE

LEGEND

- DRUMS WITH STEADY BURNING WARNING LIGHTS
- DIRECTION INDICATOR BARRICADE WITH STEADY BURN MONODIRECTIONAL LIGHT
- VERTICAL DELINEATOR PANELS
- BARRICADE, TYPE III
- FLASHING ARROW BOARD
- DIRECTION OF TRAFFIC FLOW
- IMPACT ATTENUATOR, TEMPORARY (NON-REDIRECTIVE)
- IMPACT ATTENUATOR, TEMPORARY (NARROW, REDIRECTIVE)
- TCP• SIGN INCLUDED IN TRAFFIC CONTROL & PROTECTION (SEE SIGN SCHEDULE)

- X•X•X TEMPORARY PAVEMENT CONSTRUCTION
- ON-GOING EARTHWORK FOR PROPOSED PAVEMENT
- PROPOSED PAVEMENT CONSTRUCTION
- TEMP PVMT REMOVAL (SEE REMOVAL PLAN FOR EX PVMT REMOVAL)
- REM TEMP AGGREGATE SHOULDERS
- AGGREGATE SHOULDERS, TYPE B 6"
- TEMPORARY CONCRETE BARRIER
- TEMPORARY CONCRETE BARRIER WITH 36" GLARE SCREEN
- XX-X SIGN REFERENCE NUMBER (SEE SIGN SCHEDULE)

PAVEMENT MARKING LEGEND

- ① EXISTING PAVEMENT MARKING
 - ② TEMPORARY PAVEMENT MARKING FROM PREVIOUS STAGE
 - ③ PROPOSED PAVEMENT MARKING IN PLACE (SEE PROPOSED PAVEMENT MARKING PLAN)
 - T PAVEMENT MARKING TAPE, TYPE III
 - P POLYUREA PAVEMENT MARKING TYPE II
- | | | | |
|-----|---|------|--------------------------------|
| 4SW | 4" SOLID WHITE | 8SW | 8" SOLID WHITE |
| 4SY | 4" SOLID YELLOW | 12SW | 12" SOLID WHITE @ 20' SPACING |
| 4SY | 4" SOLID DOUBLE YELLOW (11" C-C) | 12SY | 12" SOLID YELLOW @ 20' SPACING |
| 4KW | 4" SKIP-DASH WHITE (30' SKIP, 10' DASH) | 24SW | 24" SOLID WHITE STOP BAR |
| 4DW | 4" DOTTED WHITE (9' SKIP, 3' DASH) | LSW | LETTERS & SYMBOLS, WHITE |

FILE NAME =	DESIGNED - HTL	REVISED -
D468620-shr-staging23 1155-11.dgn	DRAWN - JPS	REVISED -
USER NAME = TERRA	CHECKED - DA/LVA	REVISED -
PLOT DATE = 7/16/2012	DATE - 7/20/2012	REVISED -



STATE OF ILLINOIS
DEPARTMENT OF TRANSPORTATION

MAINTENANCE OF TRAFFIC STAGE 11	
SCALE:	SHEET NO. 13 OF 13 SHEETS STA. 37+50 TO STA. 51+00

F.A.I. RTE.	SECTION	COUNTY	TOTAL SHEETS	SHEET NO.
•	90-[14R(14HB-4,14,14HB)BR]	TAZEWELL	2433	1032
CONTRACT NO. 68620			ILLINOIS FED. AID PROJECT	