

- NOTES:
1. INLET FILTERS SHALL BE PROVIDED AT ALL EXISTING STORM SEWER STRUCTURE LOCATIONS.
 2. SEE STORM WATER POLLUTION PREVENTION PLAN AND PROVISIONS OF THE NPDES PERMIT ILR10 FOR DUST CONTROL CLEANING OF PAVEMENT REQUIREMENTS.

LEGEND
INLET FILTERS 

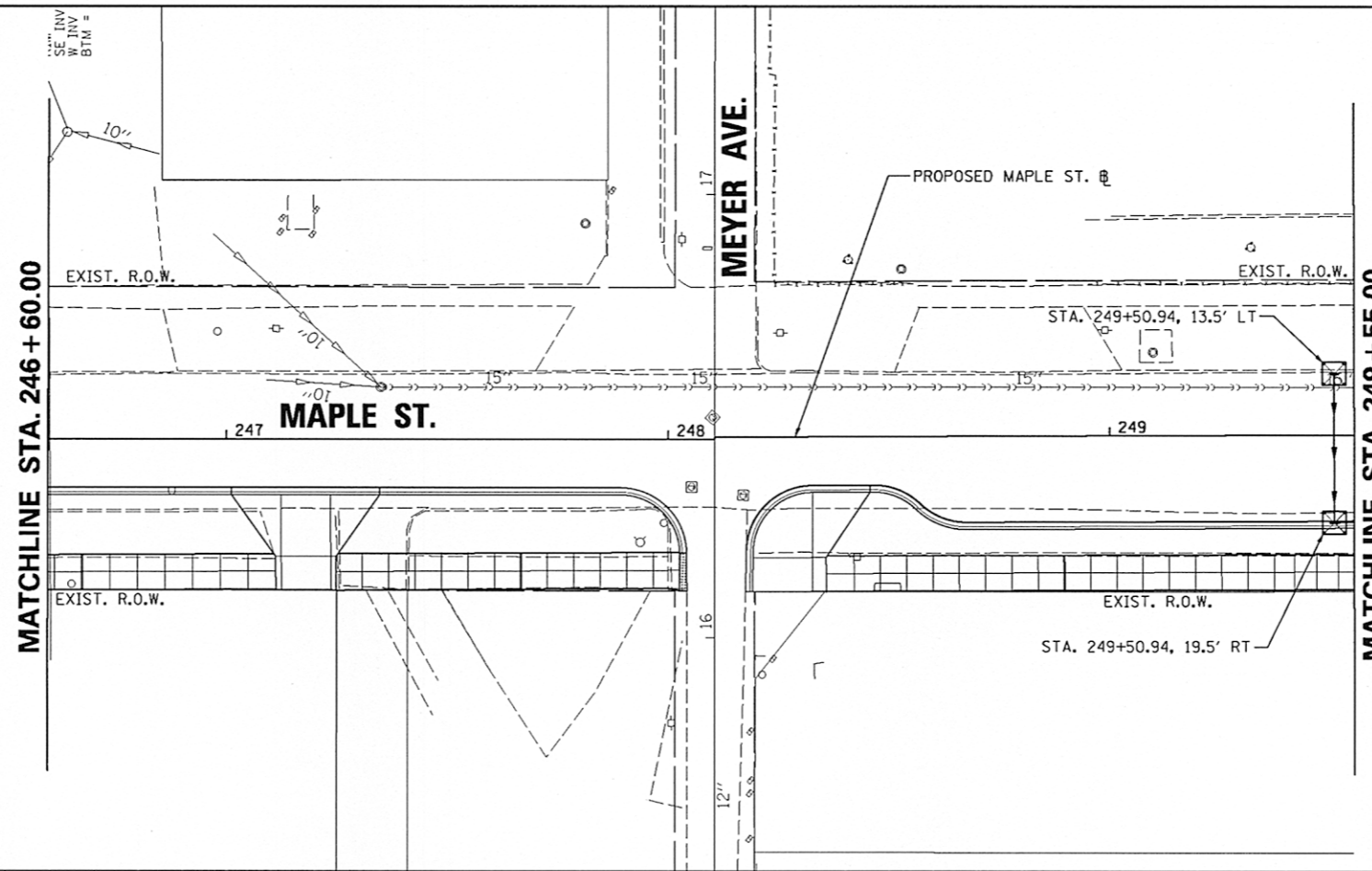
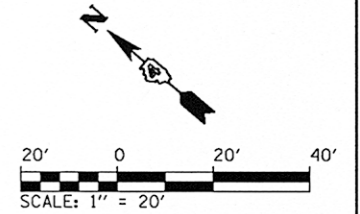

© Copyright CMT, Inc.
CMT
CRAWFORD, MURPHY & TILLY, INC.
CONSULTING ENGINEERS
License No. 184-000613

PLAN	DATE
BY	
SAVED	
ALIGNED	
CHECKED	
BY	
NO.	
FILE NAME	

PROFILE	DATE
BY	
SAVED	
ALIGNED	
CHECKED	
BY	
NO.	
FILE NAME	

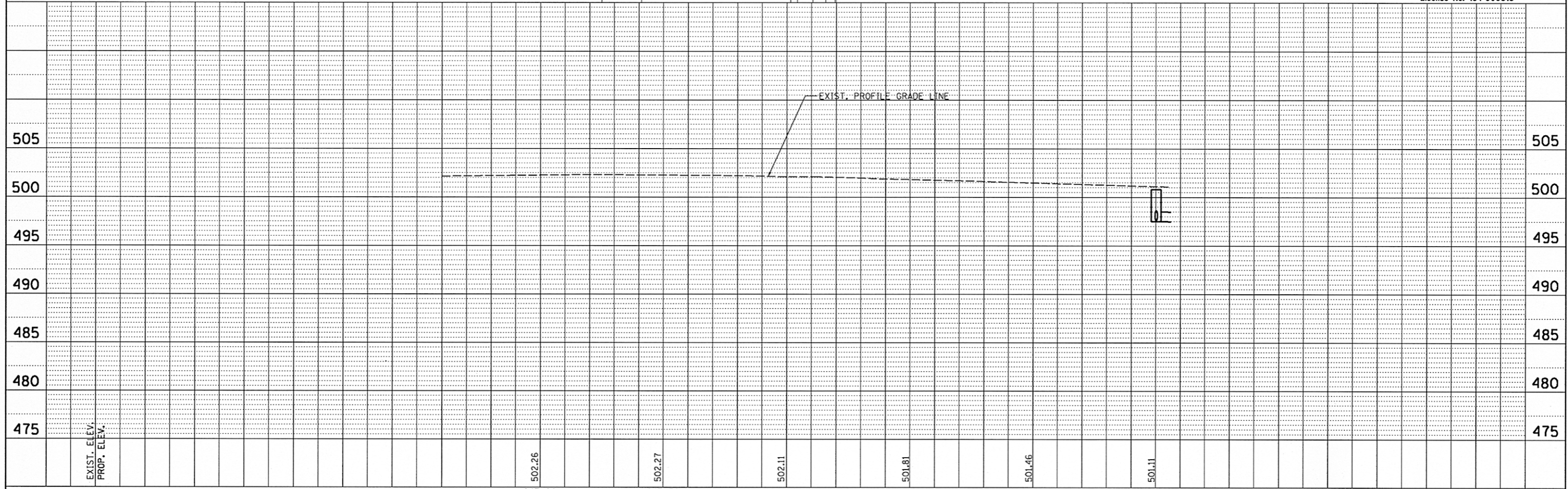

FILE NAME =	USER NAME = kovan01511	DESIGNED - RMM	REVISED -
o:\pwise_work\do_not_delete\dms73328\041010155-shs-erosal@4.dgn		DRAWN - RJE	REVISED -
	PLOT SCALE = 39.9999' / 1"	CHECKED - E.J.H.	REVISED -
	PLOT DATE = 07\23\2012	DATE - 7/18/12	REVISED -

STATE OF ILLINOIS
DEPARTMENT OF TRANSPORTATION

MAPLE STREET
EROSION CONTROL PLAN

SCALE: 1" = 20' SHEET NO. OF SHEETS STA. 246+60.00 TO STA. 249+55.00

F.A.U. RTE. 12	SECTION 12-00356-01-PV	COUNTY PEORIA	TOTAL SHEETS 519	SHEET NO. 200
		CONTRACT NO. 89626		
[ILLINOIS] FED. AID PROJECT TIG-5093(15B)				