

PLAN	SURVEYED	BY	DATE
	ALIGNED		
	CHECKED		
	RT. OF WAY		
	CADD FILE NAME		
	NO.		

PROFILE	SURVEYED	BY	DATE
	GRADES		
	CHECKED		
	B.M. NOTED		
	STRUCTURE NOTATIONS		
	CRD		
	NO.		

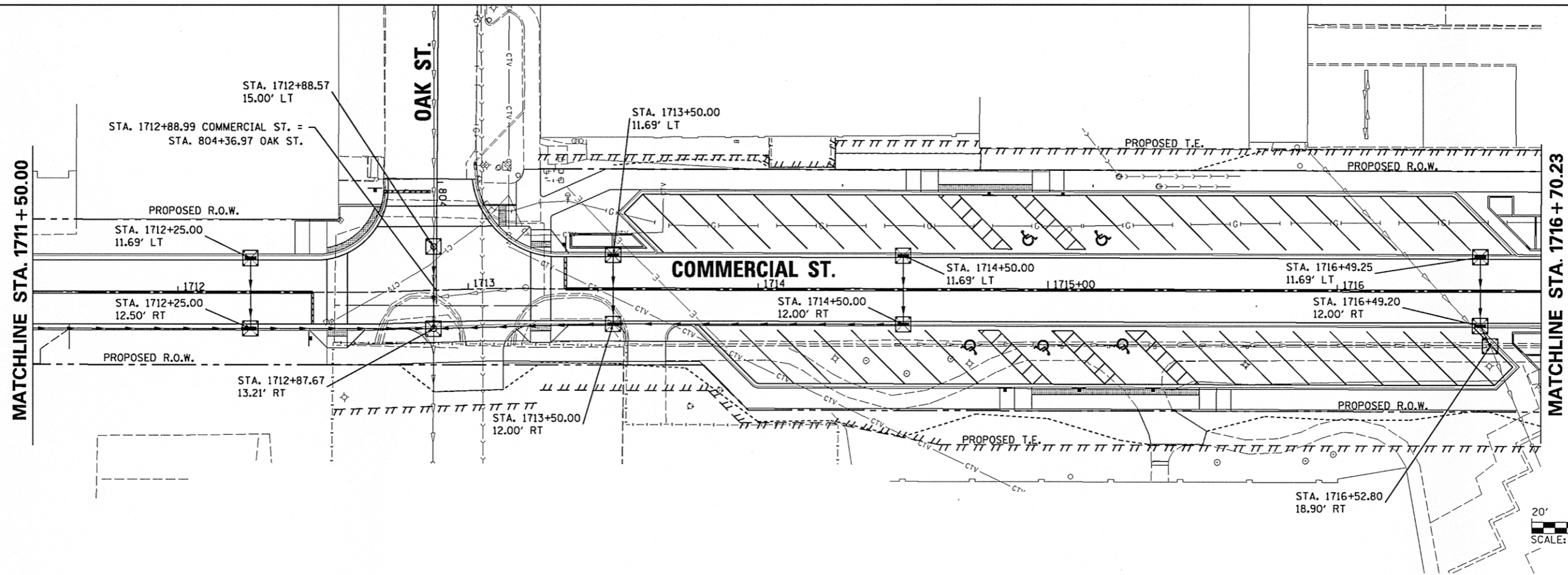

SEE STATE STREET  
EROSION CONTROL  
PLAN

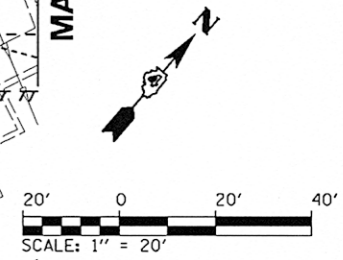

**LEGEND**

INLET FILTERS

- NOTES:**
1. INLET FILTERS SHALL BE PROVIDED AT ALL EXISTING STORM SEWER STRUCTURE LOCATIONS.
  2. SEE STORM WATER POLLUTION PREVENTION PLAN AND PROVISIONS OF THE NPDES PERMIT ILR10 FOR DUST CONTROL CLEANING OF PAVEMENT REQUIREMENTS.

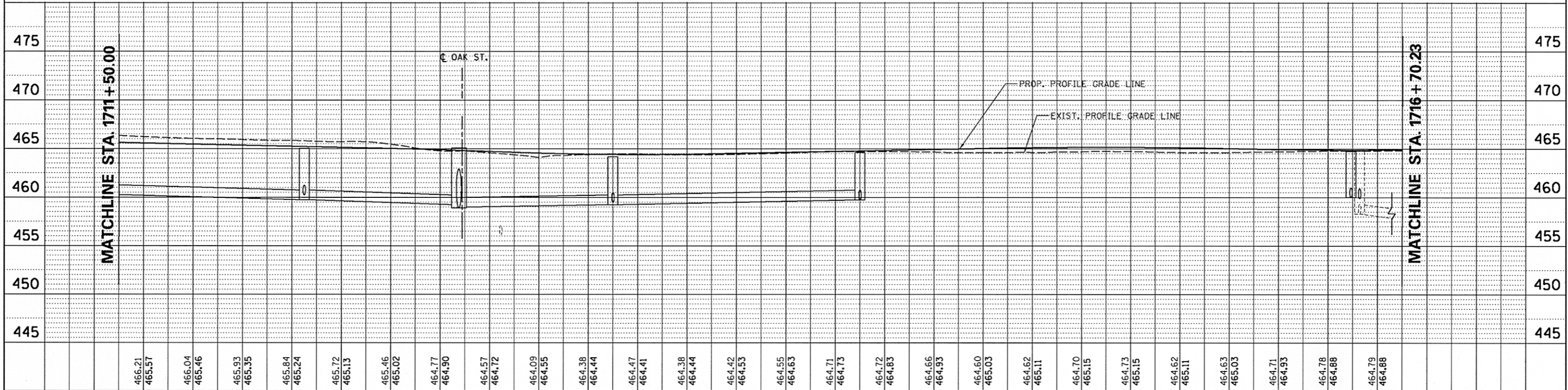

FILE NAME =	USER NAME = kovan01511	DESIGNED - LNF	REVISED -	<b>STATE OF ILLINOIS DEPARTMENT OF TRANSPORTATION</b>	<b>COMMERCIAL STREET EROSION CONTROL PLAN</b>	F.A.U. RTE.	SECTION	COUNTY	TOTAL SHEETS	SHEET NO.
0:\p\150-work\do-not-delete\dms75322\0418	0155-ahc-eros-304.dgn	DRAWN - LNF	REVISED -			12-00356-01-PV	PEORIA	519	207	
	PLOT SCALE = 39.9999 ' / in.	CHECKED - MCH	REVISED -			CONTRACT NO.89626		ILLINOIS FED. AID PROJECT TIG-5093(158)		
	PLOT DATE = 07\23\2012	DATE - 7/18/12	REVISED -			SCALE: 1"=20'	SHEET NO. OF SHEETS	STA. 1711+50 TO STA. 1716+70.23		