

- 292 STA. 699+36.31, 14.8' RT.
INLET TY B,
RIM = 491.07
INV (NE) = 487.56
INV (S) = 486.97 (EX.)
- 541 STA. 701+46.05, 13.6' RT.
INLET TY D-1
RIM = 479.39
INV (NE) = 475.96
INV (S) = 475.81
- 542 STA. 701+45.96, 13.9' LT.
INLET TY C-1
RIM = 479.48
INV = 476.48
- 815 STA. 699+29.62, 10.0' LT.
INLET TY C-1
RIM = 491.21
INV = 488.21
- 816 STA. 699+36.00, 10.0' RT.
INLET TY C-1
RIM = 490.61
INV (NE) = 487.71
INV (SW) = 487.61
- 818 STA. 699+90.72, 10.0' RT.
INLET TY C-1
RIM = 488.65
INV (E) = 484.74
INV (N) = 484.64
- 819 STA. 699+99.65, 10.0' LT.
INLET TY C-1
RIM = 488.16
INV = 485.16
- 293A STA. 699+71.68, 0.4' LT.
EX. MH, 4' DIA., TY-1 F, CL
RIM = 489.22
INV (NW) = 481.22 (EX.)
INV (N) = 483.02 (EX.)
INV (SW) = 481.12 (EX.)
INV (WSW) = 485.87 (EX.)
INV (S) = 484.26

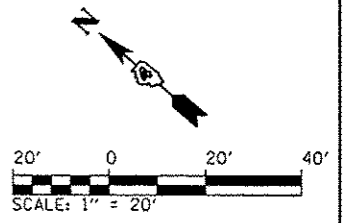
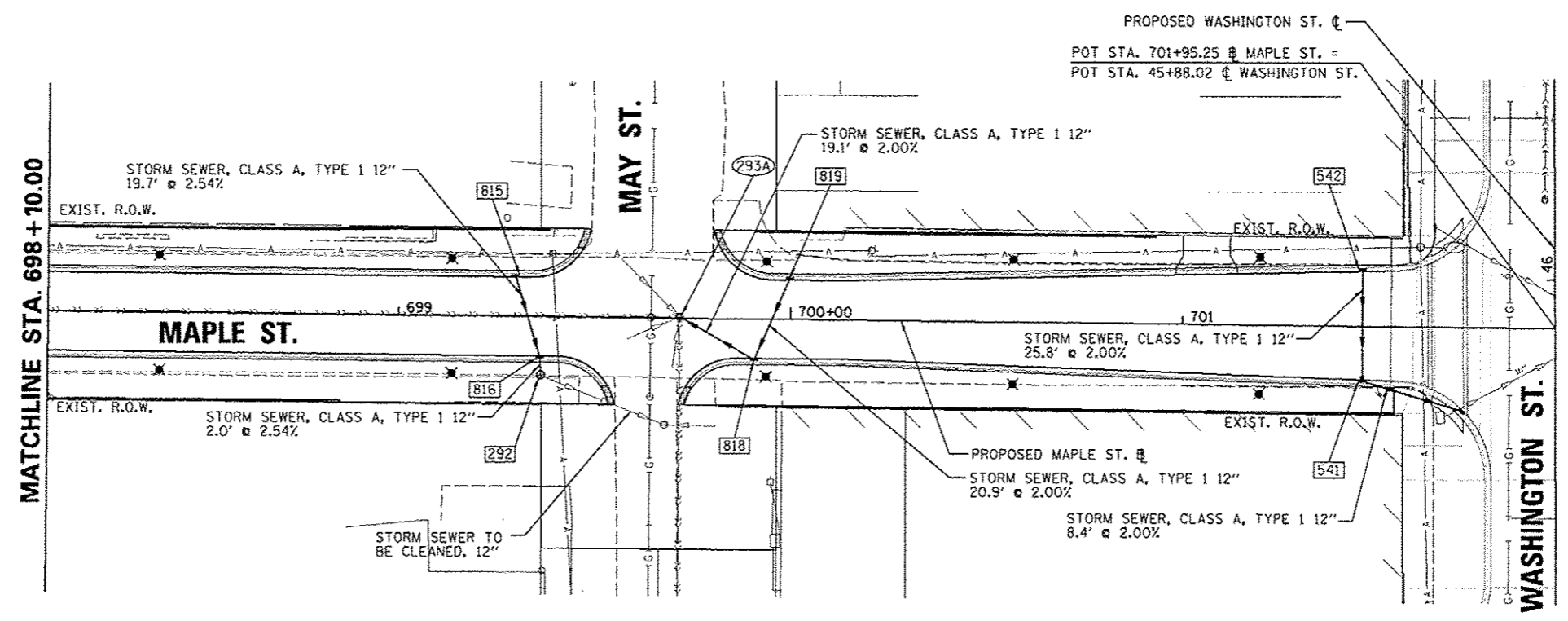

DATE	
BY	
REVISIONS	
NO.	
DESCRIPTION	
DATE	
BY	

DATE	
BY	
REVISIONS	
NO.	
DESCRIPTION	
DATE	
BY	

CMT
CRAWFORD, MURPHY & TILLY, INC.
CONSULTING ENGINEERS
License No. 184-000613

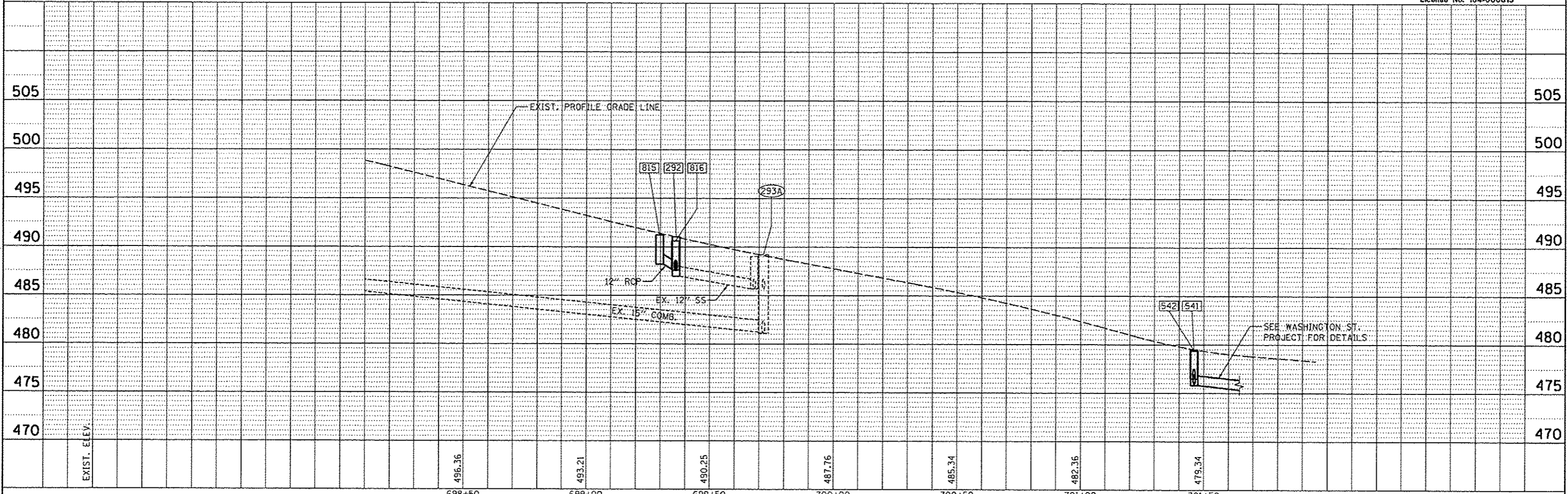

FILE NAME *	USER NAME = kaven0101	DESIGNED - RMM	REVISED -	STATE OF ILLINOIS DEPARTMENT OF TRANSPORTATION	MAPLE STREET DRAINAGE PLAN AND PROFILE				F.A.U. RTE.	SECTION	COUNTY	TOTAL SHEETS	SHEET NO.
0:\peise\work\do_not_delete\dms73472\0410	0155-sh1-d-ein-pnpl85.dgn	DRAWN - RJE	REVISED -		12-00356-01-PV	PEORIA	519	230					
	PLOT SCALE = 3/4" = 1' in.	CHECKED - EJA	REVISED -		SCALE: 1" = 20'				SHEET NO. OF SHEETS STA. 698+10.00 TO STA. 701+54.14				
	PLOT DATE = 07/23/2012	DATE - 7/18/12	REVISED -		CONTRACT NO. 89626				ILLINOIS FED. AID PROJECT TIG-5093158				