

JOINTING LEGEND	
	TOOLED JOINT
	EXPANSION JOINT

- JOINTING NOTES:**
1. EXPANSION AND CONTRACTION JOINTS SHALL BE PROVIDED IN ACCORDANCE WITH THE STANDARD SPECIFICATIONS, SPECIAL PROVISIONS, AND PLAN DETAILS. JOINT LOCATIONS SHOWN ON THIS SHEET ARE SHOWN FOR INFORMATION AND TYPICAL LAYOUT PATTERN. EXACT FIELD CONDITIONS AND CONTRACTOR'S POURING SEQUENCE MAY REQUIRE SOME JOINT LOCATION FIELD ADJUSTMENT.
 2. CONTRACTOR SHALL VERIFY ALL FIELD ADJUSTMENTS WITH FIELD ENGINEER FOR APPROVAL PRIOR TO CONSTRUCTION.
 3. SEE SPECIAL PROVISION SECTION, POROUS PORTLAND CEMENT CONCRETE SIDEWALK 4 INCH, (SPECIAL) FOR FINISH AND EXPANSION JOINT REQUIREMENTS.
 4. SEE SPECIAL PROVISION SECTION, PORTLAND CEMENT CONCRETE SIDEWALK 4 INCH, SPECIAL, FOR FINISH AND EXPANSION JOINT REQUIREMENTS.
 5. SEE ARTICLES 423.06 AND 423.07 OF THE ILLINOIS DEPARTMENT OF TRANSPORTATION STANDARD SPECIFICATIONS FOR ROAD AND BRIDGE CONSTRUCTION MANUAL, FOR DRIVEWAY FINISH JOINT REQUIREMENTS.

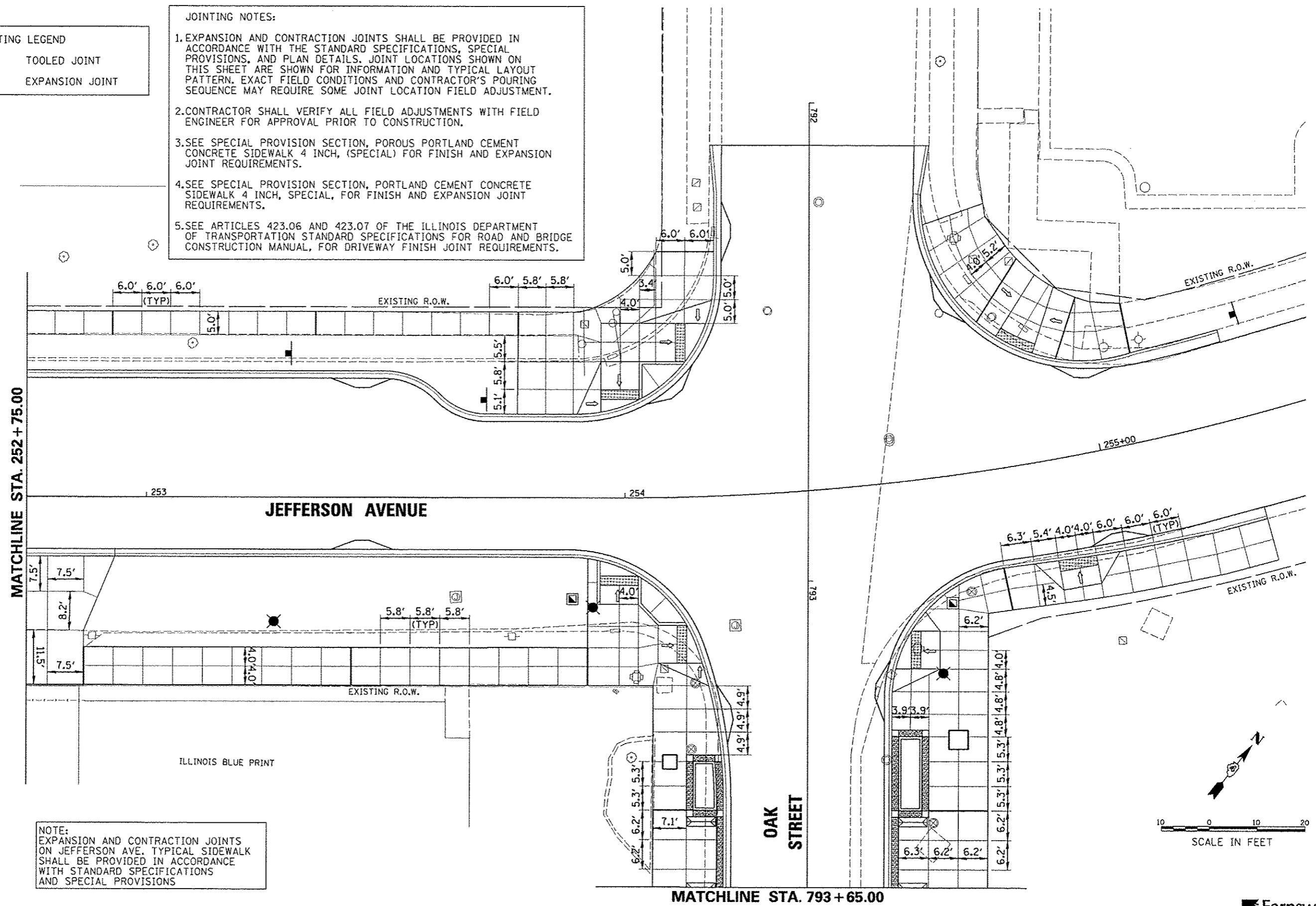

MATCHLINE STA. 252 + 75.00

MATCHLINE STA. 793 + 65.00

NOTE:
EXPANSION AND CONTRACTION JOINTS ON JEFFERSON AVE. TYPICAL SIDEWALK SHALL BE PROVIDED IN ACCORDANCE WITH STANDARD SPECIFICATIONS AND SPECIAL PROVISIONS

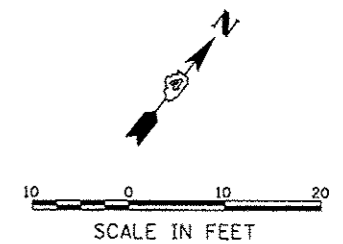

FILE NAME * c:\p1100_work\do_not_delete\dma73427\04	USER NAME * monak.01298	DESIGNED - STH	REVISED - -
BL0155-shr\Indep\joint026.dgn		DRAWN - STH	REVISED - -
PLOT SCALE * 20.0000' / 1in.		CHECKED - BAB	REVISED - -
PLOT DATE * 07/23/2012		DATE - 7/18/12	REVISED - -

**STATE OF ILLINOIS
DEPARTMENT OF TRANSPORTATION**

**JEFFERSON AVENUE
STREETSCAPE PAVEMENT JOINTING PLAN**

SCALE: 1"=10'
SHEET NO. OF SHEETS STA. 252+75.00 TO STA. 255+44.00

F.A.U. RTE.	SECTION	COUNTY	TOTAL SHEETS	SHEET NO.
12	12-00356-01-PV	PEORIA	519	299
CONTRACT NO. 09626			ILLINOIS REG. AID PROJECT TIC-50931561	

Farnsworth GROUP
7707 N. KNOXVILLE AVE. SUITE 100
PEORIA, ILLINOIS 61614
(309) 699-8888 / (309) 699-0620 Fax
www.far.com