

JOINTING NOTES:

1. EXPANSION AND CONTRACTION JOINTS SHALL BE PROVIDED IN ACCORDANCE WITH THE STANDARD SPECIFICATIONS, SPECIAL PROVISIONS, AND PLAN DETAILS. JOINT LOCATIONS SHOWN ON THIS SHEET ARE SHOWN FOR INFORMATION AND TYPICAL LAYOUT PATTERN. EXACT FIELD CONDITIONS AND CONTRACTOR'S POURING SEQUENCE MAY REQUIRE SOME JOINT LOCATION FIELD ADJUSTMENT.
2. CONTRACTOR SHALL VERIFY ALL FIELD ADJUSTMENTS WITH FIELD ENGINEER FOR APPROVAL PRIOR TO CONSTRUCTION.
3. SEE SPECIAL PROVISION SECTION, POROUS PORTLAND CEMENT CONCRETE SIDEWALK 4 INCH. (SPECIAL) FOR FINISH AND EXPANSION JOINT REQUIREMENTS.
4. SEE SPECIAL PROVISION SECTION, PORTLAND CEMENT CONCRETE SIDEWALK 4 INCH. SPECIAL, FOR FINISH AND EXPANSION JOINT REQUIREMENTS.
5. SEE ARTICLES 423.06 AND 423.07 OF THE ILLINOIS DEPARTMENT OF TRANSPORTATION STANDARD SPECIFICATIONS FOR ROAD AND BRIDGE CONSTRUCTION MANUAL, FOR DRIVEWAY FINISH JOINT REQUIREMENTS.

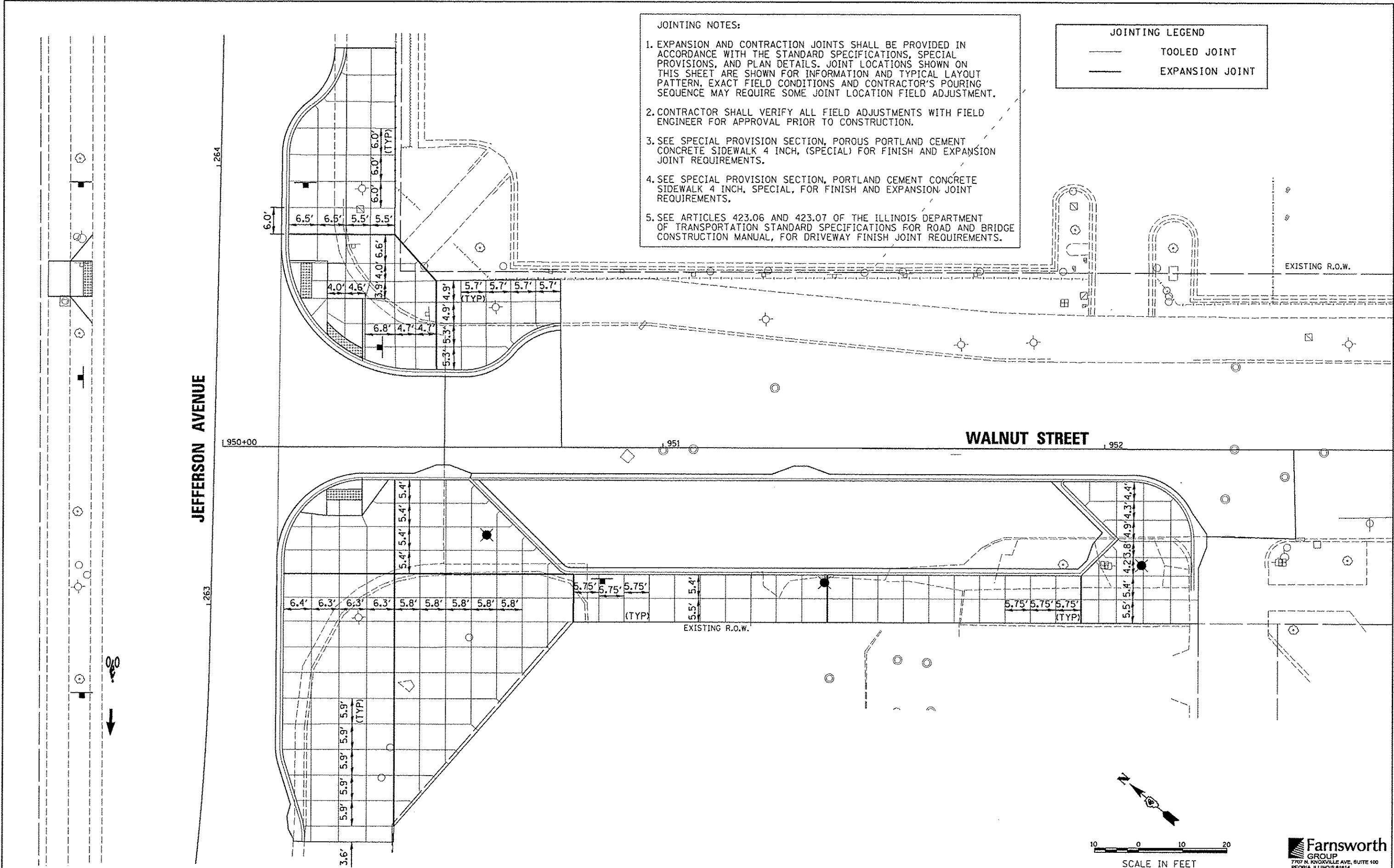
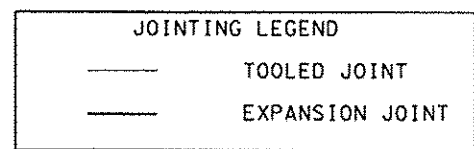

FILE NAME *	USER NAME *	DESIGNED -	REVISED -	STATE OF ILLINOIS DEPARTMENT OF TRANSPORTATION	WALNUT STREET STREETSCAPE PAVEMENT JOINTING PLAN	F.A.U. RTE.	SECTION	COUNTY	TOTAL SHEETS	SHEET NO.
o:\piso\work\do_no_delete\dms73427\04\BLR559-ah-Indsap\joint018.dgn	monsk01310	DRAWN -	REVISED -			12-00356-01-PV	PEORIA	519	307	
PLT SCALE = 20.0000' / in.		CHECKED -	REVISED -			CONTRACT NO. 89626				
PLT DATE = 07/23/2012		DATE -	REVISED -			ILLINOIS FED. AID PROJECT TIC-5093(158)				
					SCALE: 1"=10'	SHEET NO. OF SHEETS		STA. 950+00.00 TO STA. 952+50.00		