

ALL KEYED NOTES APPLY TO THIS SHEET ONLY.

KEYED NOTES:

1. PORTLAND CEMENT CONCRETE 81400100 - HANDHOLE IDOT STANDARD 814001-02. GROUND HANDHOLE PER IDOT STANDARD 873001-02.
2. 2" CONDUIT, 2*6 AND 1*6 GND FOR CIRCUIT LC6-2 AND 2*6 AND 1*6 GND FOR CIRCUIT LC6-4.
3. REMOVE COBRA HEAD LIGHT FIXTURE FROM POLE AND REPLACE WITH NEW TYPE F3 FIXTURE.
4. 2" CONDUIT, 2*6 AND 1*6 GND FOR CIRCUIT LC6-4.
5. 2" CONDUIT, 2*6 AND 1*6 GND FOR CIRCUIT LC6-2.
6. 2" CONDUIT, 2*6 AND 1*6 GND FOR CIRCUIT LC6-1.

NOTES:

1. STATIONS AND OFFSETS SHOWN ON THIS SHEET ARE TO THE CENTER OF HANDHOLE AND LIGHT POLE FOUNDATIONS.
2. COORDINATE INSTALLATION OF UNDERGROUND CONDUIT AND LIGHT FIXTURES WITH ALL EXISTING UNDERGROUND SYSTEMS AND PROPOSED LANDSCAPE FEATURES AND PLANTINGS.
3. SEE IRRIGATION PLANS FOR UNDERGROUND CONDUIT AND PIPING. COORDINATE INSTALLATION OF UNDERGROUND FACILITIES.
4. 'F' DESIGNATIONS OF LIGHT FIXTURES SHOWN ON LIGHTING DETAILS SHEET.

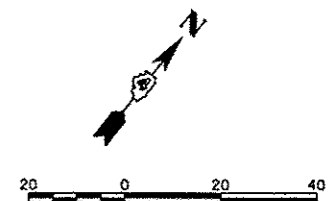
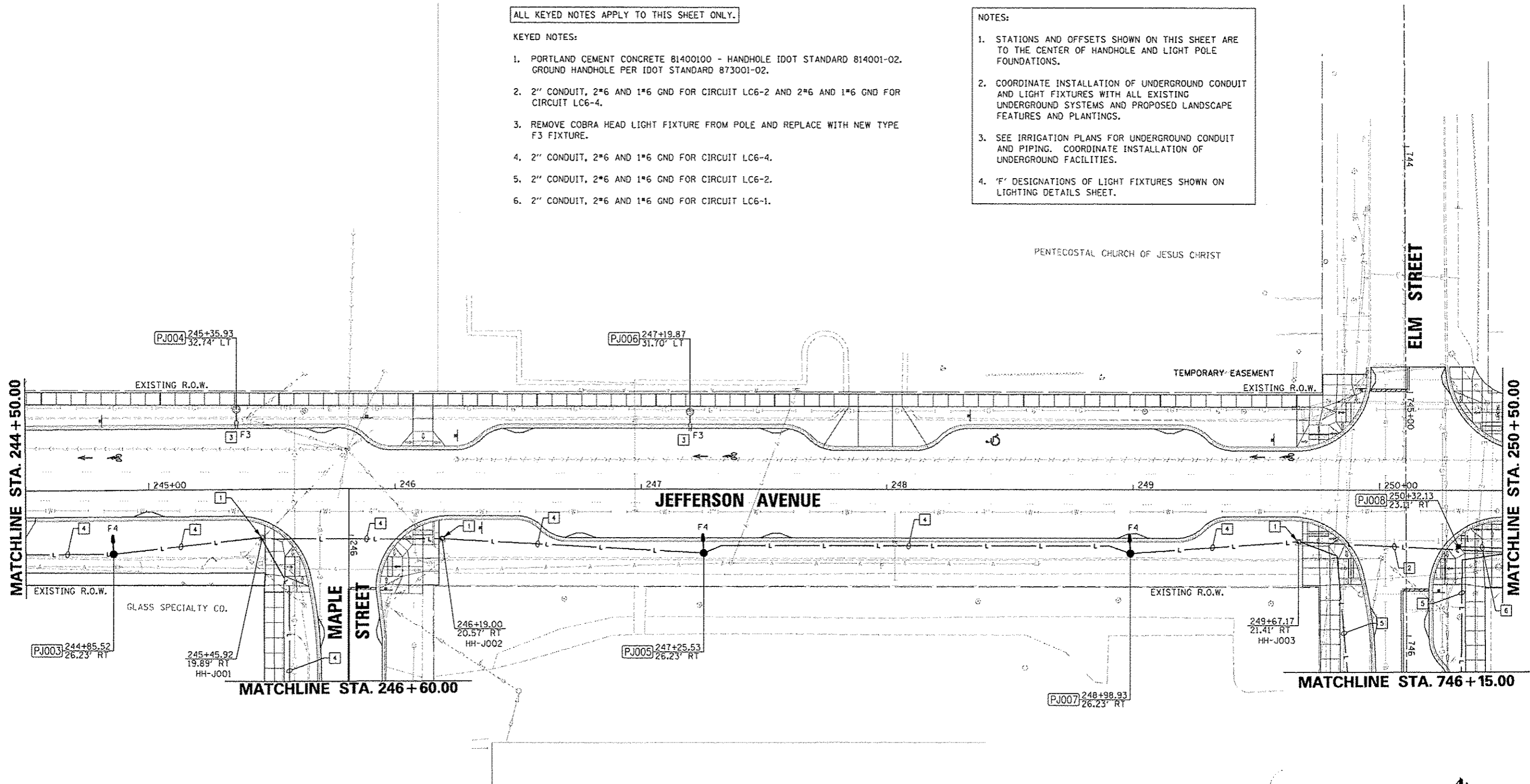

FILE NAME =	USER NAME = manak01398	DESIGNED - JOE	REVISED -	STATE OF ILLINOIS DEPARTMENT OF TRANSPORTATION	JEFFERSON AVENUE LIGHTING PLAN	F.A.U. RTE.	SECTION	COUNTY	TOTAL SHEETS	SHEET NO.
ca:\pwise_work\do_not_delete\dms73318\041	LB0155-ehs-light826.dgn	DRAWN - TMT	REVISED -			12-00356-01-PV	PEORIA	519	360	
	PLOT SCALE = 3/4" = 1' - 0"	CHECKED - BMS	REVISED -			CONTRACT NO. 89626				
	PLOT DATE = 07/25/2012	DATE - 7/18/12	REVISED -			ILLINOIS FED. AID PROJECT TIG-50931(58)				
				SCALE: 1"=20'		SHEET NO. OF SHEETS		STA. 244+50.00 TO STA. 250+50.00		

Farnsworth GROUP
 7707 N. KNOXVILLE AVE, SUITE 100
 PEORIA, ILLINOIS 61614
 (309) 693-9683 / (309) 699-9820 Fax
 www.f-w.com