

F.A. RTE.	SECTION	COUNTY	TOTAL SHEETS	SHEET NO.
852	18B-5-R-2	WILL	66	66

STA.	TO STA.
FED. ROAD DIST. NO.	ILLINOIS FED. AID PROJECT

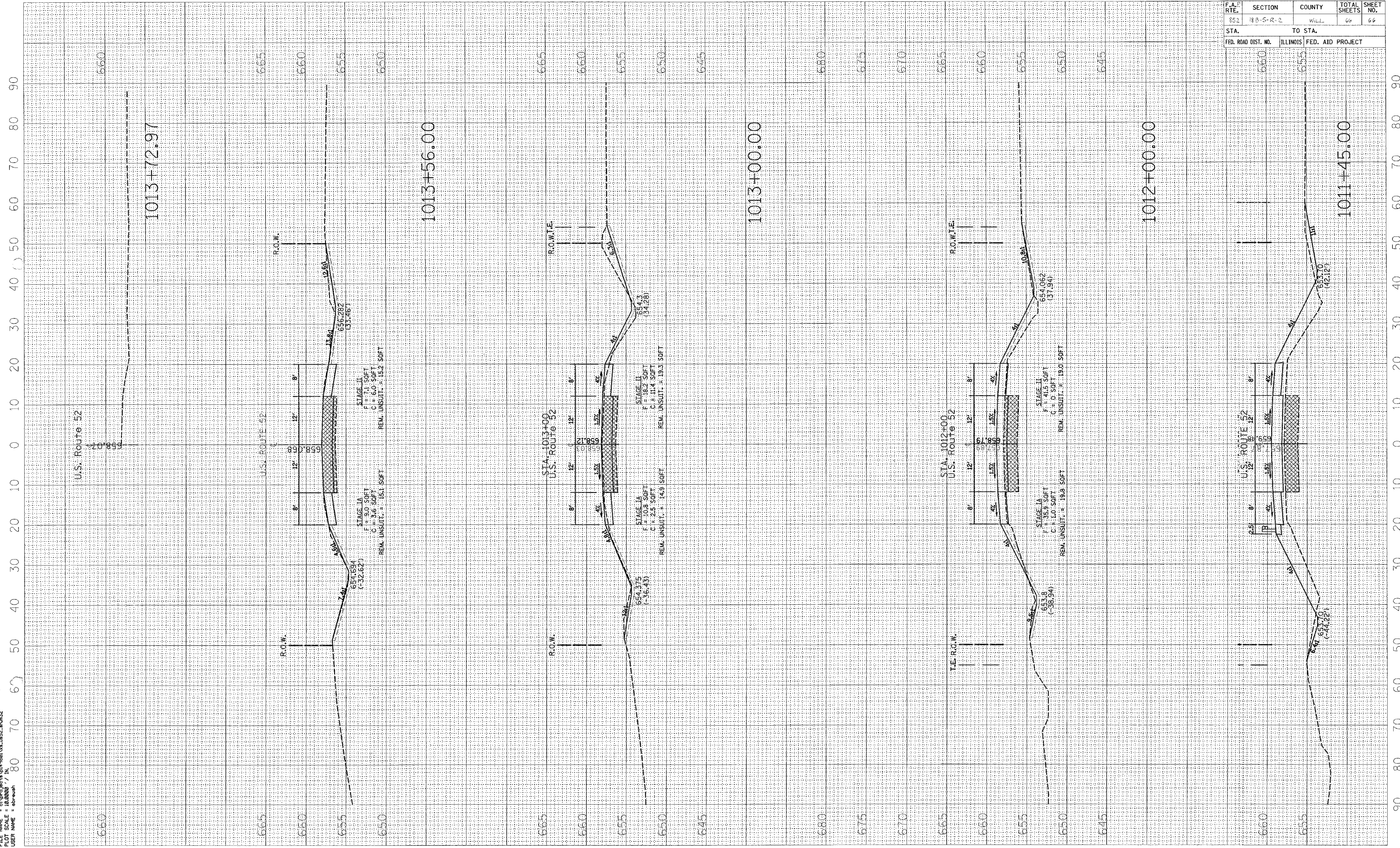

U.S. ROUTE 52

1013+72.97

U.S. ROUTE 52

1013+56.00

STA 1013+00
U.S. ROUTE 52

1013+00.00

STA 1012+00
U.S. ROUTE 52

1012+00.00

U.S. ROUTE 52

1011+45.00

R.O.W.

R.O.W.

R.O.W.

R.O.W.

R.O.W.

T.E.R.O.W.

R.O.W.

R.O.W.

STAGE IA
 F = 9.0 SOFT
 C = 3.6 SOFT
 REM. UNSUIT. = 15.1 SOFT

STAGE II
 F = 7.1 SOFT
 C = 6.0 SOFT
 REM. UNSUIT. = 15.2 SOFT

STAGE IA
 F = 10.8 SOFT
 C = 2.5 SOFT
 REM. UNSUIT. = 14.9 SOFT

STAGE II
 F = 18.2 SOFT
 C = 11.4 SOFT
 REM. UNSUIT. = 19.3 SOFT

STAGE IA
 F = 19.9 SOFT
 C = 1.0 SOFT
 REM. UNSUIT. = 19.8 SOFT

STAGE II
 F = 18.2 SOFT
 C = 8.0 SOFT
 REM. UNSUIT. = 19.0 SOFT

STAGE IA
 F = 10.8 SOFT
 C = 2.5 SOFT
 REM. UNSUIT. = 14.9 SOFT

STAGE II
 F = 18.2 SOFT
 C = 11.4 SOFT
 REM. UNSUIT. = 19.3 SOFT

656.282
(33.767)

654.654
(-32.62)

654.375
(-36.43)

654.375
(-36.43)

654.062
(-31.94)

653.8
(-38.94)

654.0
(-42.12)

654.0
(-42.12)