

F.A. RTE.	SECTION	COUNTY	TOTAL SHEETS	SHEET NO.
681	114 BR	LIVINGSTON	43	10
STA.	TO STA.			
FED. ROAD DIST. NO.	ILLINOIS	FED. AID PROJECT		

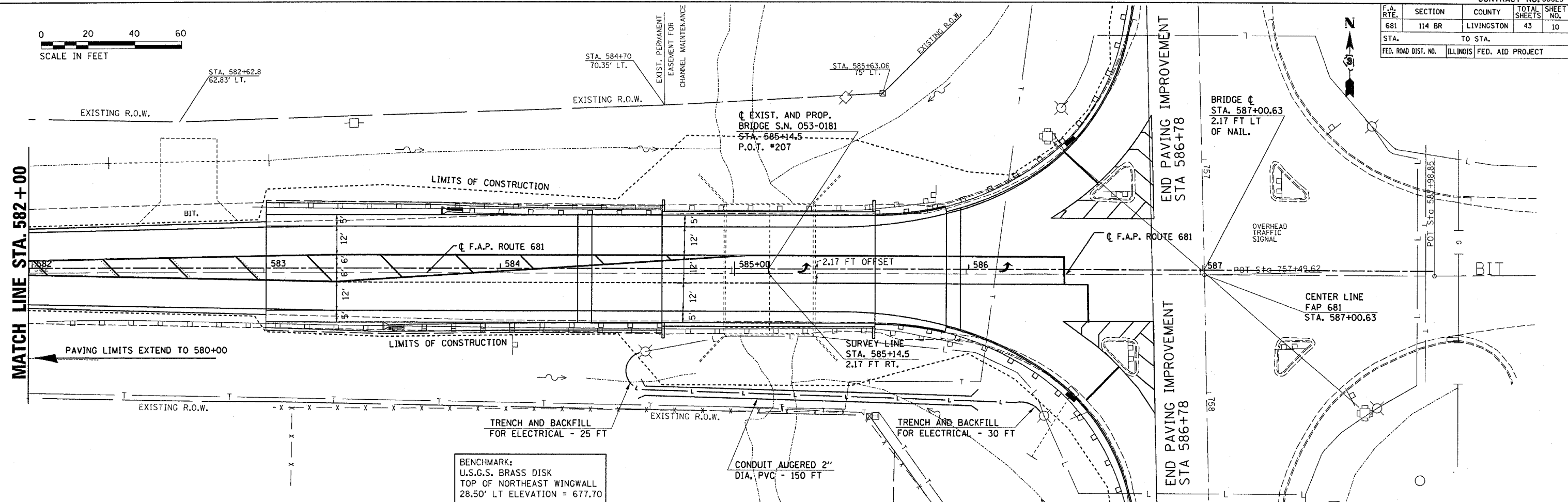
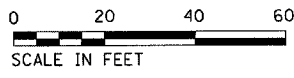

DATE	
BY	
PLANNED	
DESIGNED	
CHECKED	
NOTED	
FILED	
NO.	

DATE	
BY	
PROFILING	
DESIGNED	
CHECKED	
NOTED	
FILED	
NO.	

PLOT DATE = Aug 23, 2007 - 04:07:11 PM
 FILE NAME = c:\p\projects\66625\66625.dgn
 PLOT SCALE = 1" = 20'-0" / IN.
 USER NAME = Ferguson

