

F.A.I. RTE.	SECTION	COUNTY	TOTAL SHEETS	SHEET NO.
74	•	CHAMPAIGN	122	24
STA.		TO STA.		
FED. ROAD DIST. NO.		ILLINOIS FED. AID PROJECT		
		•(10-92-8)(HB-1,HB-4)BR		
		CONTRACT NO. 70001		
SHEET B				

TRAFFIC CONTROL AND PROTECTION (DETOUR 1)
SHEET 2 OF 4

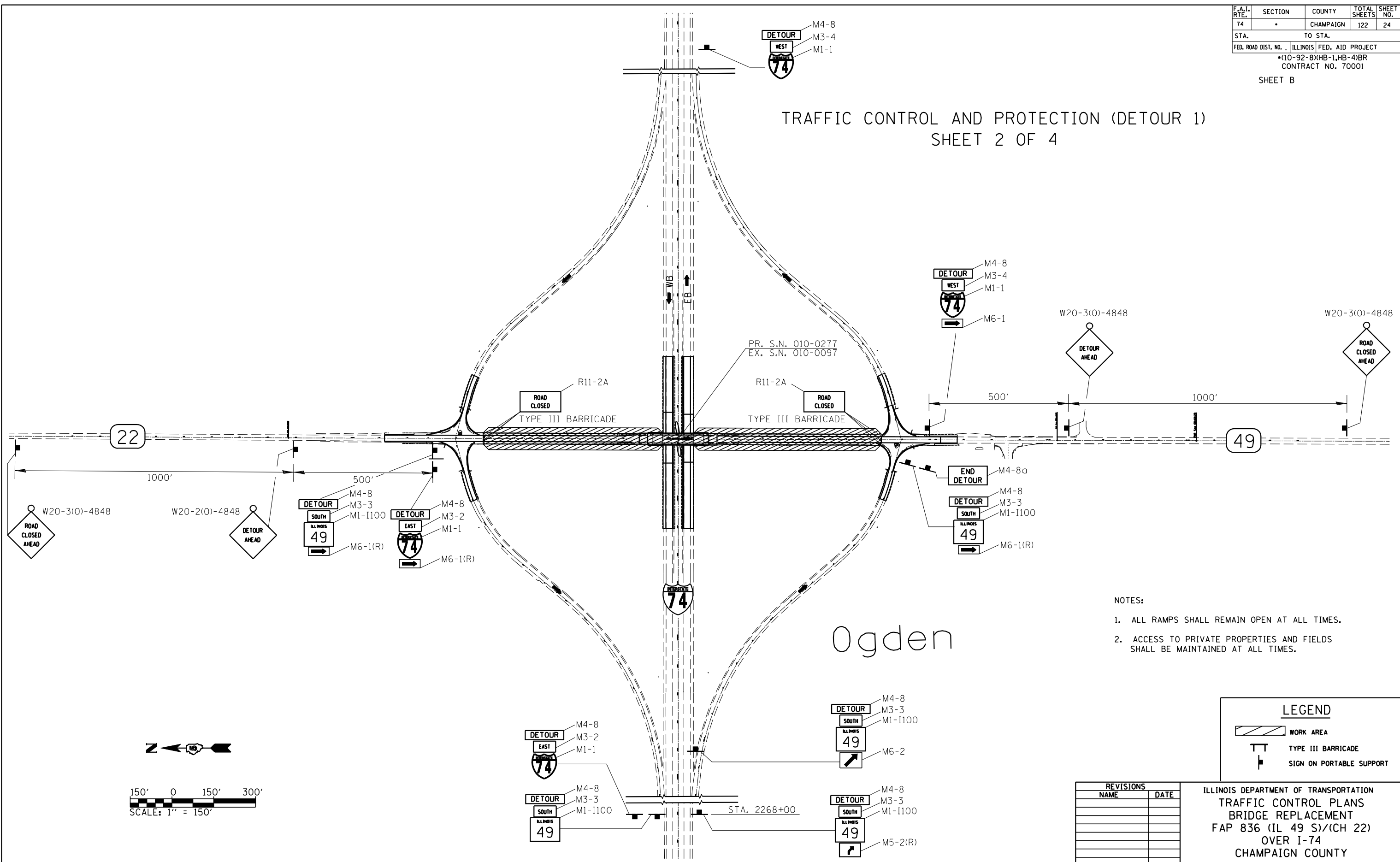

- NOTES:
1. ALL RAMPs SHALL REMAIN OPEN AT ALL TIMES.
 2. ACCESS TO PRIVATE PROPERTIES AND FIELDS SHALL BE MAINTAINED AT ALL TIMES.

LEGEND	
	WORK AREA
	TYPE III BARRICADE
	SIGN ON PORTABLE SUPPORT

REVISIONS	
NAME	DATE

ILLINOIS DEPARTMENT OF TRANSPORTATION
TRAFFIC CONTROL PLANS
BRIDGE REPLACEMENT
FAP 836 (IL 49 S)/(CH 22)
OVER I-74
CHAMPAIGN COUNTY

SCALE: 1" = 150'
DATE: 06/2003

DRAWN BY: WJX
CHECKED BY: JH

