

SEC 8, TWP. 19 N, R 14W, 2 P.M.

SEC 9, TWP. 19 N, R 14W, 2 P.M.

F.A.I. RTE.	SECTION	COUNTY	TOTAL SHEETS	SHEET NO.
74	*	CHAMPAIGN	122	42

STA. TO STA.
FED. ROAD DIST. NO. ILLINOIS FED. AID PROJECT
*(10-92-8)HB-1, HB-4)BR
CONTRACT NO. 70001

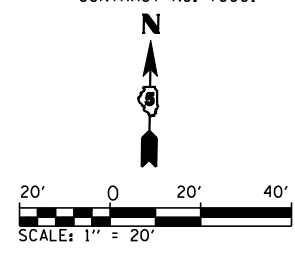

EXIST. CURVE 36
PI STA. = 500+13.18
 $\Delta = 35^\circ 28' 03''$ (RT)
 $D = 10^\circ 22' 31''$
 $R = 552.23'$
 $T = 176.60'$
 $L = 341.85'$
 $E = 27.55'$
P.C. STA. = 498+36.58
P.T. STA. = 501+78.43

NOTE:
SEE SHEET 48 OF 122
FOR INTERSECTION DETAIL

EXIST. CURVE 21
PI STA. = 101+64.07
 $\Delta = 34^\circ 02' 41''$ (RT)
 $D = 10^\circ 20' 21''$
 $R = 554.16'$
 $T = 169.66'$
 $L = 329.28'$
 $E = 25.39'$
P.C. STA. = 99+94.41
P.T. STA. = 103+23.69

PLAN	DATE
SURVEYED	
PLOTTED	
CHECKED	
BY	
NO.	

PROFILE	DATE
SURVEYED	
PLOTTED	
CHECKED	
BY	
NO.	

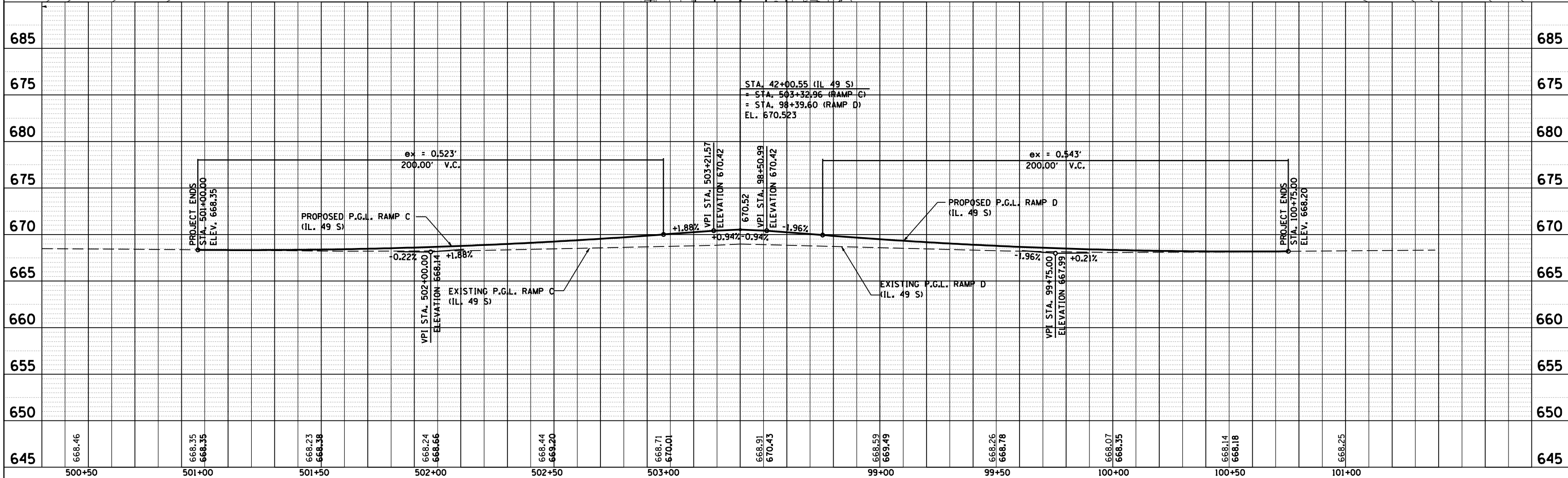
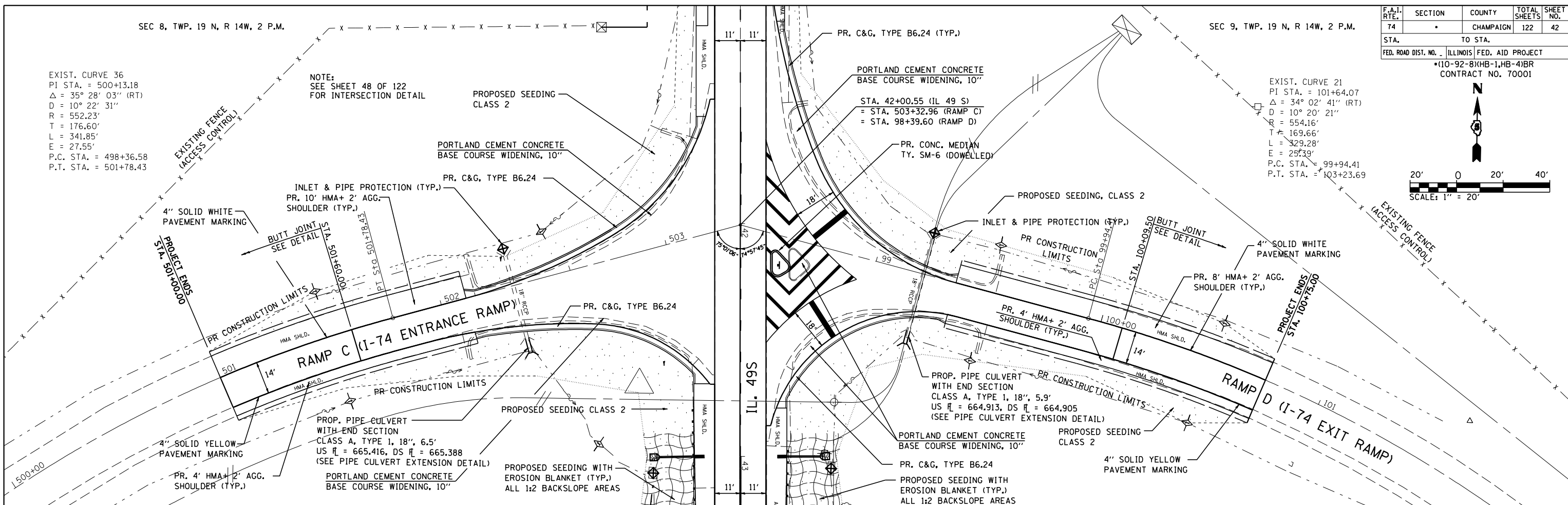

IL 49S RAMPS C & D